

- Notes**
1. Tree size varies- see specification; Tree planted at nursery line depth
 2. Good quality topsoil
 3. Tree rootball
 4. Subsoil - sides of pit to be roughened
 5. Bark mulch
 6. Gravel drainage layer
 7. Round stake 1.8m long, 75m diameter
 8. Crossbar - securely fixed to stakes
 9. Adjustable tree tie - securely fixed to crossbar

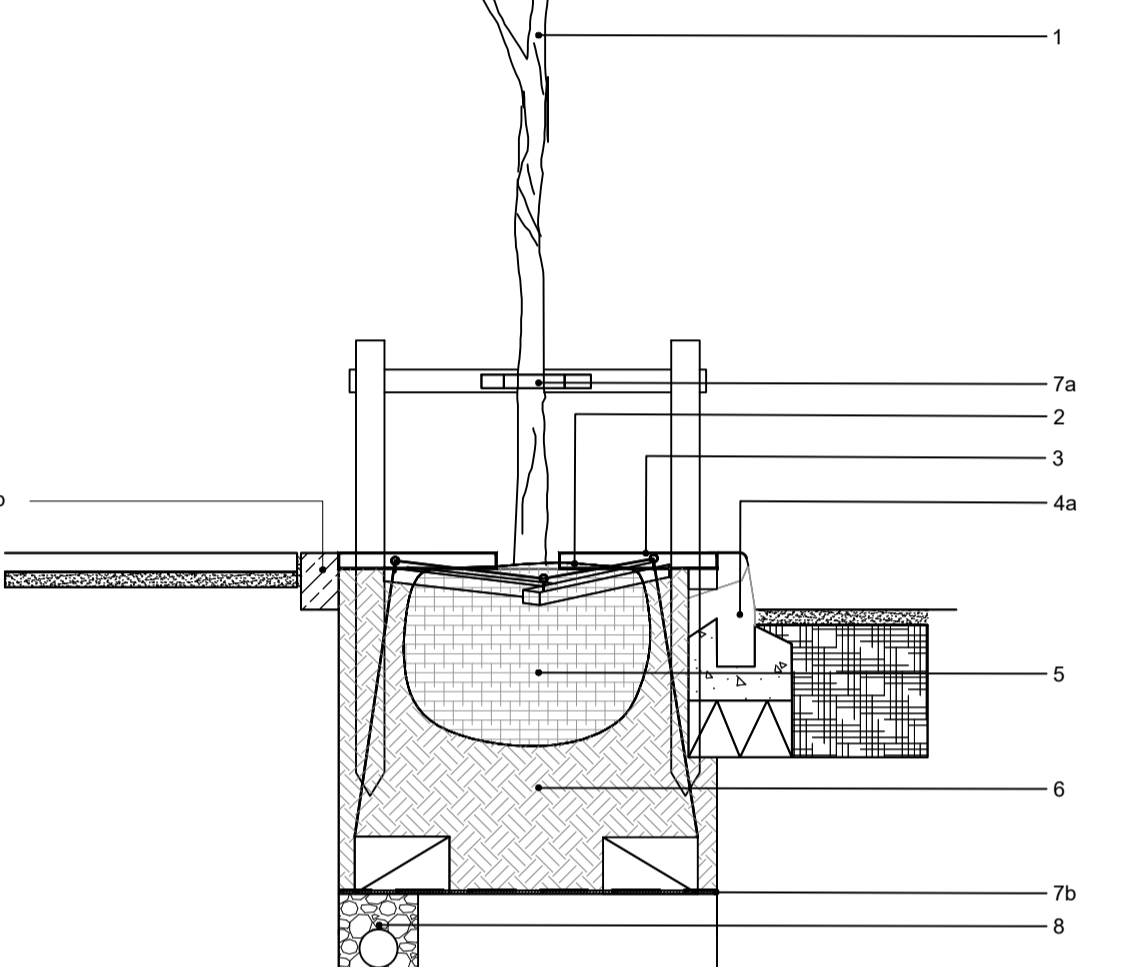

- Notes**
1. Tree size varies- see specification;
 2. Tree planted at nursery line depth;
 3. Tree Grille & Frame, Cast Ductile Iron, Self Finish, dim. 1000x1000mm, 450mm inner Ø, 2 pieces, Galvanised steel support 30mm frame;
 4. a. Road kerb to Engineer's Detail/ Side entry gully, min. length 600mm; b. Selt edge 100 x 100 x 80mm;
 5. Tree Rootball;
 6. Structural Soil as per Planning Scheme requirement to be agreed with Planning Authority. Subsoil loosened around sides and bottom of pit;
 7. a. Stake System: Round Timber Stake 75mm in diameter; b. Steel cable with adjusters attached to deadman anchors;
 8. Drainage to Engineer's detail; pipe to be wrapped with permeable root barrier;
 9. Deadman Anchoring System for all trees with Double stake & crossbar installed for first season to enhance support of the tree in initial establishment period;
 10. 100mm Ø perforated ventilation pipe with AJ cover - 1 per tree pit;
 11. Compacted Hardcore of Footpath;
 12. 500mm structural soil - Blend to be formed from 150mm clean stone with soil complying with Multi-Purpose Topsoil to BS3682:2015

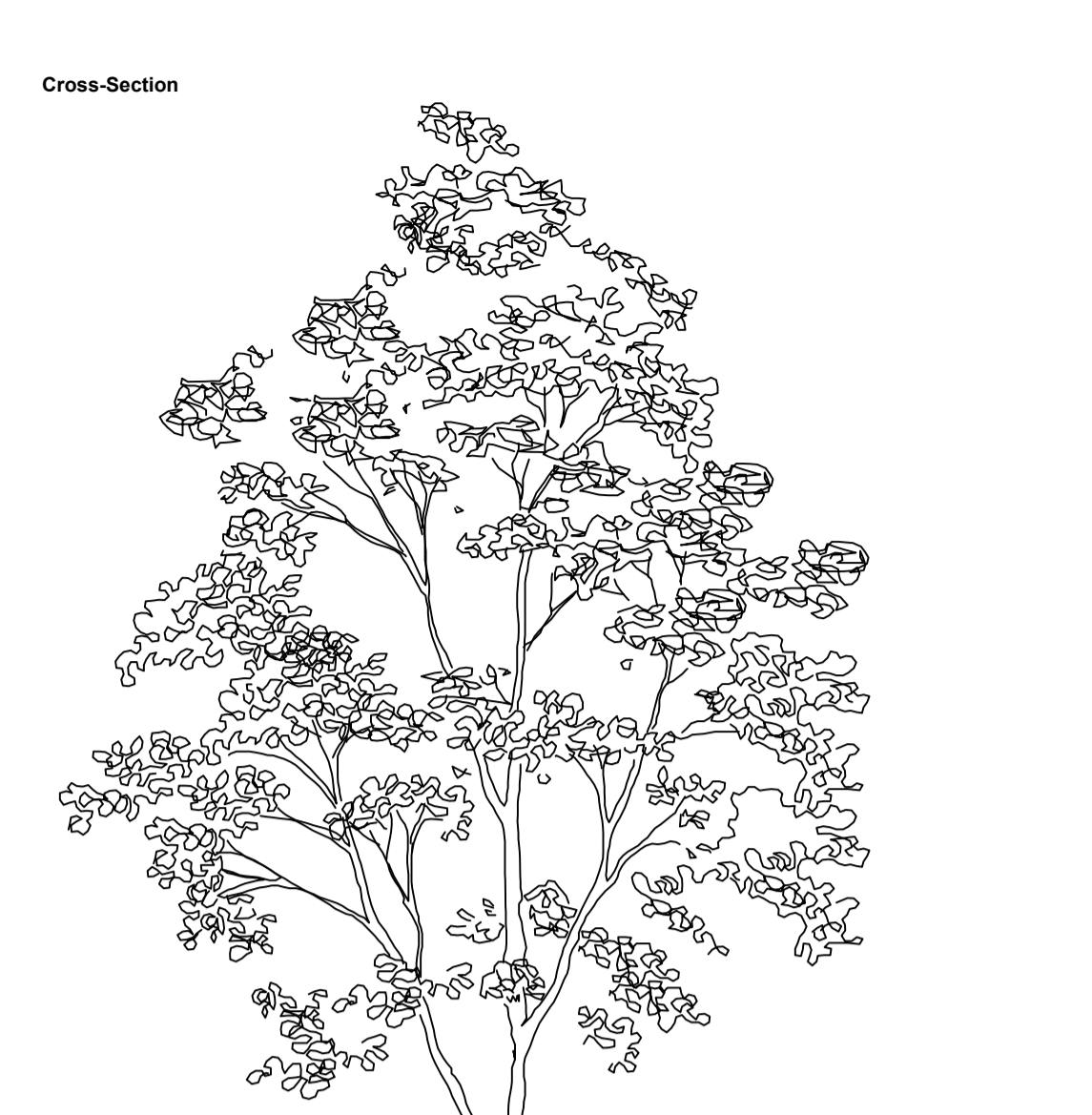
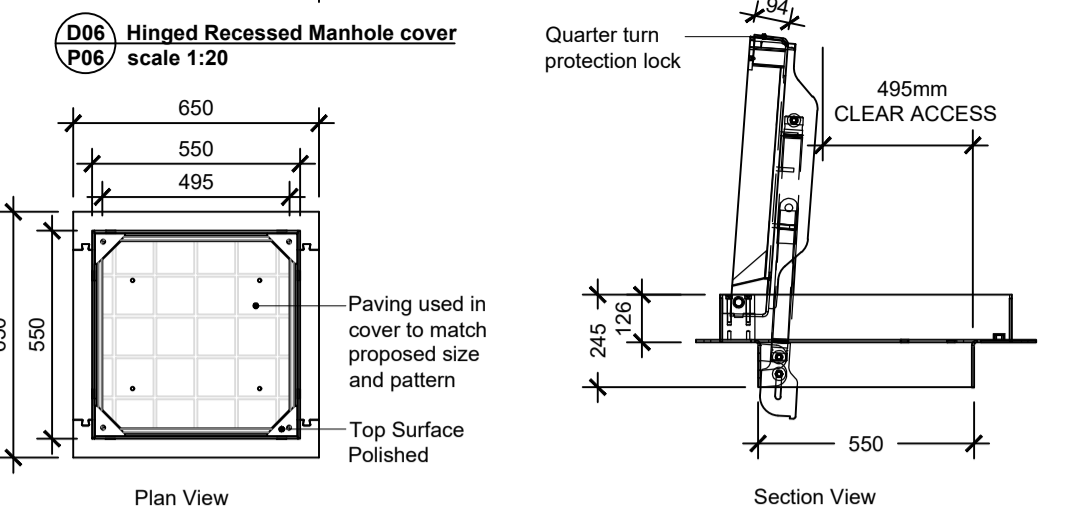

- Notes:**
- Lift assisted recessed access cover
 - 400 kN frame and cover load resistance
 - 84mm deep recessed cover
 - One man operation - lifting effort less than 25kg
 - Mechanical spring compression stainless steel struts
 - No internal gases or seals to fail
 - Demountable stainless steel hinges on maintenance free plain bearings
 - Security quarter turn bolts to prevent unwanted access
 - No loose bolts
 - Empty weight - 120 kg
 - Hand operated staybar

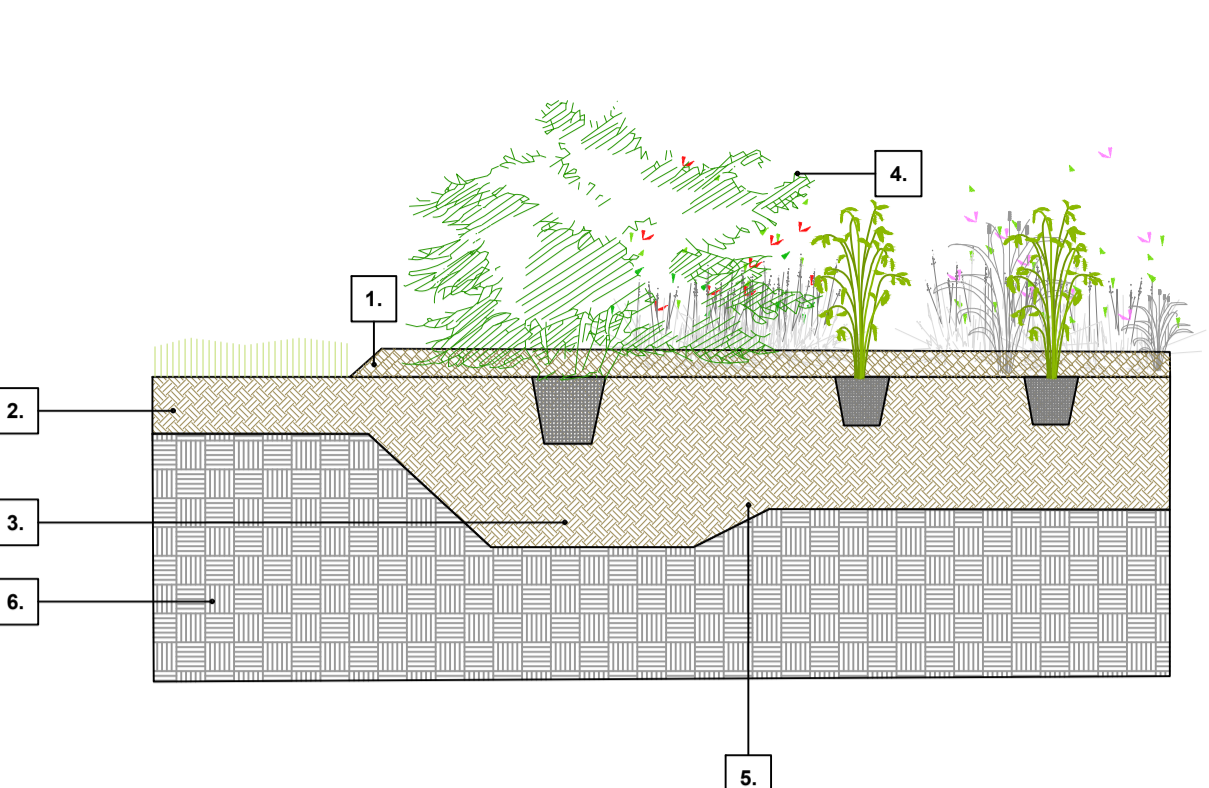

1. Bark mulch to 75mm depth
2. Amenity grass: 150mm minimum depth.
3. Shrub/Hedge planting: 425mm minimum depth.
4. Perennial planting: 350mm minimum depth.
5. Loosened subsoil, base and sides broken up;
6. Subsoil.

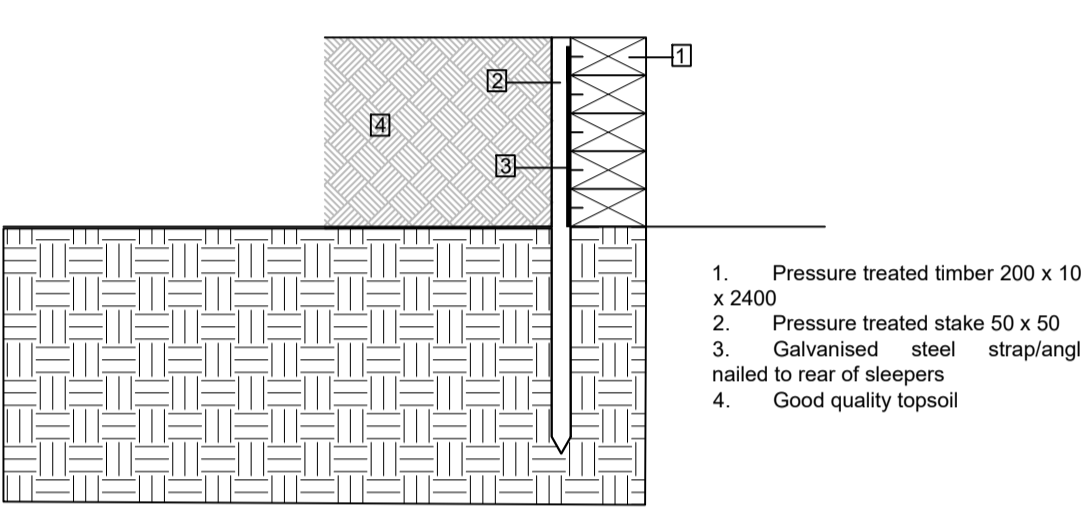

1. Pressure treated timber 200 x 100 x 2400
2. Pressure treated stake 50 x 50
3. Galvanised steel strap/angle nailed to rear of sleepers
4. Good quality topsoil

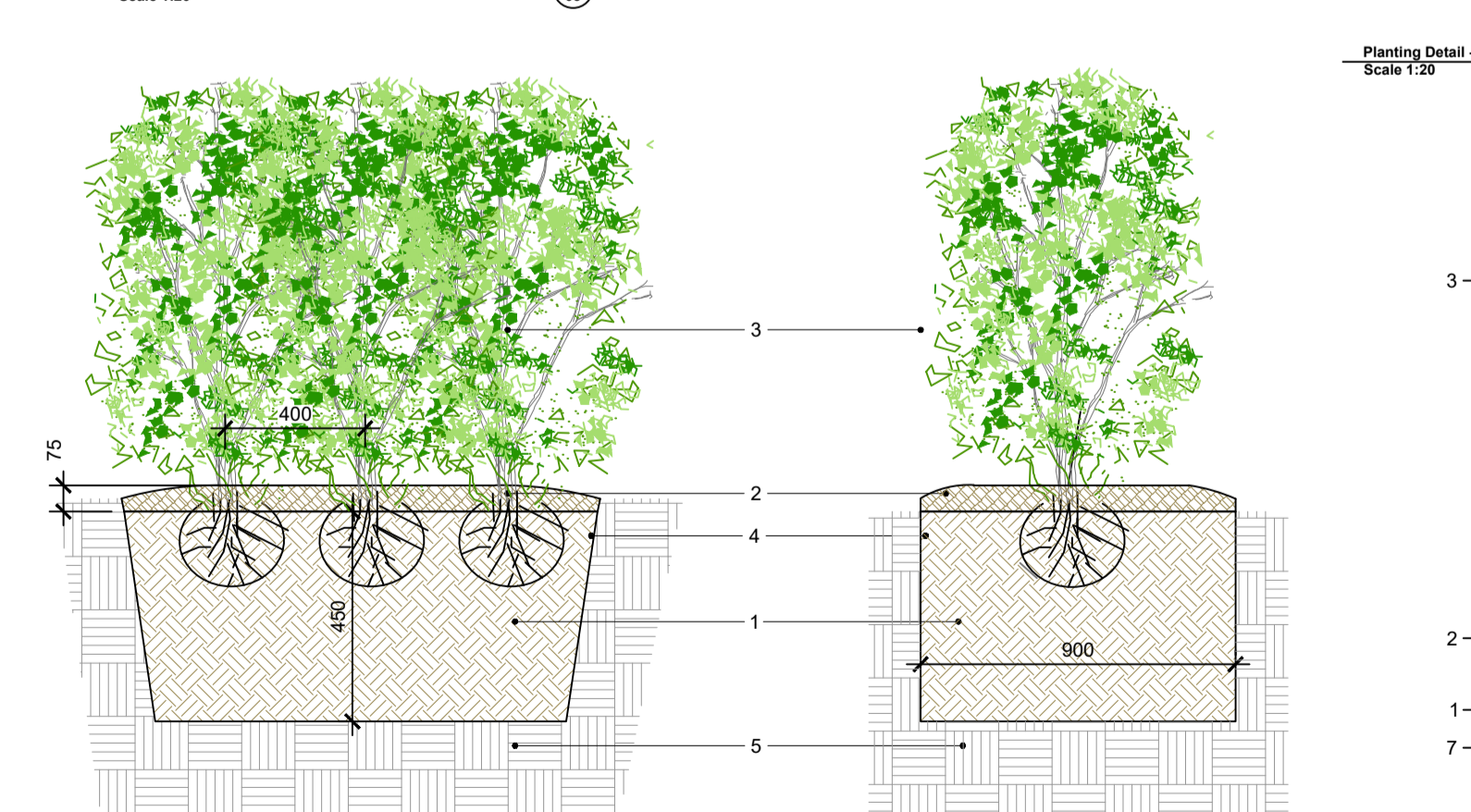

- SECTION**
1. Good quality multi-purpose topsoil to depths as shown and in accordance with BS 3882 (shrubs min.450mm); top of soil level to be 75mm below top of kerb to contain bark mulch (e.g. Sierrablén Flora or similar and approved);
 2. Bark mulch to 75mm;
 3. Proposed hedge planting - single staggered row at 400mm centres;
 4. Loosened subsoil, base and sides broken up;
 5. Subsoil
- CROSS SECTION**

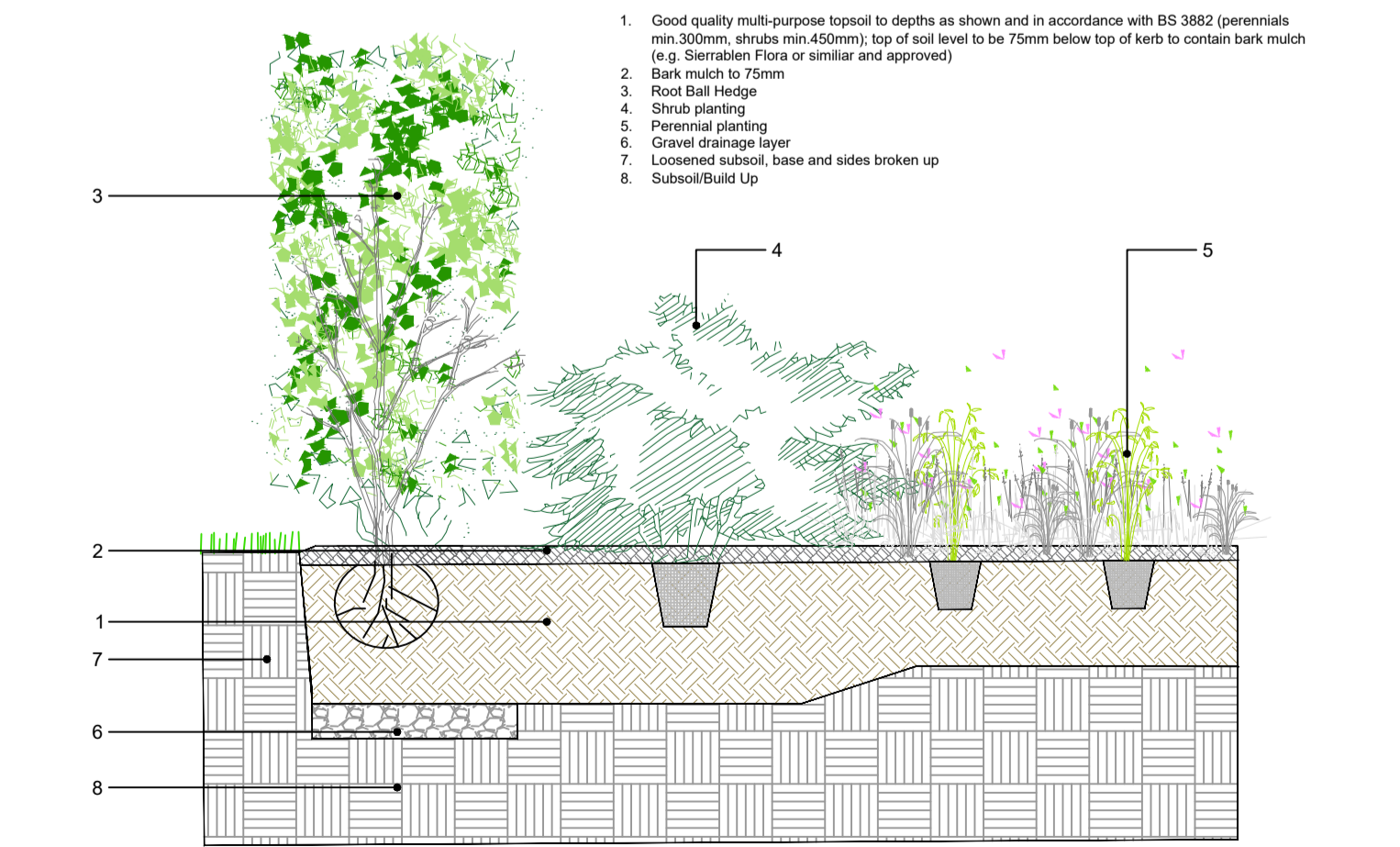

- Notes:**
1. Good quality multi-purpose topsoil to depths as shown and in accordance with BS 3882 (perennials min. 300mm, shrubs min.450mm); top of soil level to be 75mm below top of kerb to contain bark mulch (e.g. Sierrablén Flora or similar and approved)
 2. Bark mulch to 75mm
 3. Root Ball Hedge
 4. Shrub planting
 5. Perennial planting
 6. Gravel drainage layer
 7. Loosened subsoil, base and sides broken up
 8. Subsoil/Bulk Up

This drawing is intended to show landscape architectural proposals only. Please refer to Architects and Engineers drawings for relevant details of buildings, structures, roads, parking etc.
The copyright of this drawing is vested with Murray & Associates. This drawing may not be copied or reproduced without written consent.
All materials referred to on this drawing - including plant species - are indicative and subject to change following detailed site investigation. Significant changes, if any are required, will be referred to the relevant authority for agreement.
This drawing is not suitable for use for construction purposes.
Discrepancies to be referred to Murray & Associates for clarification.

murray & associates
landscape architecture

18 The Salspore Building, mail@murray-associates.com
44-45 Clontarf Road, www.murray-associates.com
Dublin 3, D03 R9N3 +353 (0)1 854 0090

REV	DATE	REVISION	DRAWN	CHECKED
A	12/12/22	Planning	IV/CA	CA
0	22/08/22	Sketch	IV	MB

CLIENT
Cairn Homes Properties Ltd.

PROJECT TITLE
Clonburris Urban Core

SHEET TITLE
Construction Details

SHEET NO.	SHEET SIZE
1868_SK_D_03	A1

SCALE	REVISION
As shown	A

STAGE	DATE
Planning	12/12/22

Copyright Murray and Associates, 2022