

Proposed Ground Floor Landscape Plan @ 1:500

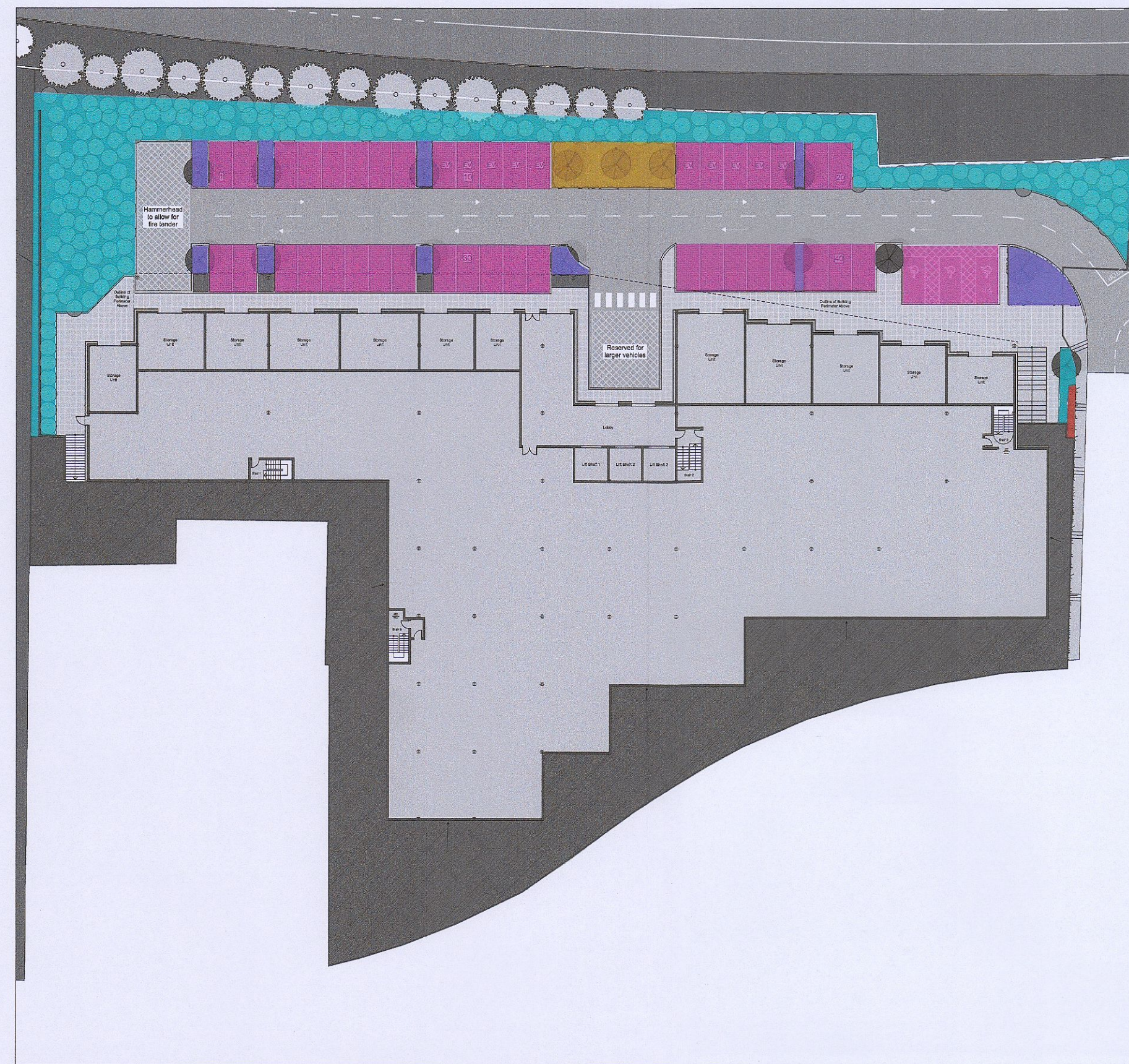

Proposed Basement Landscape Plan @ 1:500

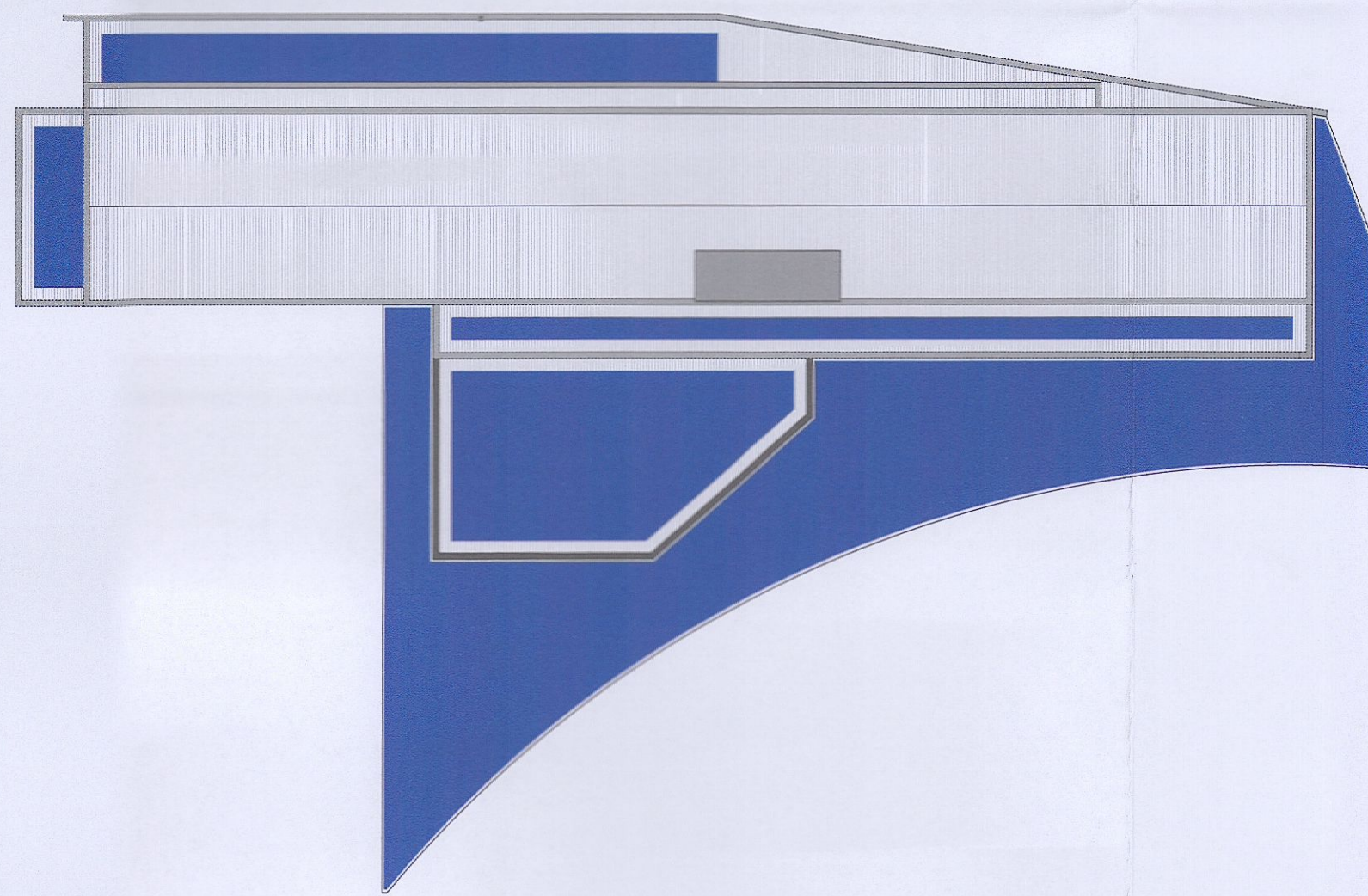

Proposed Roof Landscape Plan @ 1:500

### Green Space Factor Calculations

- 1. Short Lawn -  $0.3 \times 142\text{m}^2 = 42.6\text{s}$
- 2. Tall Lawn -  $0.5 \times 961\text{m}^2 = 480.5$
- 3. Permeable Paving -  $0.3 \times 686\text{m}^2 = 205.8$
- 4a. Shrubs, height below 3m -  $0.4 \times 127\text{m}^2 = 50.8$
- 4b. Shrubs/Hedgerow, height above 3m -  $0.5 \times 77\text{m}^2 = 38.5$
- 4d. Preserved Hedgerow -  $1.2 \times 22.7\text{m}^2 = 27.24$
- 5a. New Trees -  $0.6 \times 2932\text{m}^2 = 1759.2$
- 26 (Quantity) x 12 (Girth in cm) = 312m<sup>2</sup>
- $786 \text{ m}^2 \text{ (Area)} / 1.5 \text{ (Tree spacing)} = 524\text{m}^2$   
 $524 \times 5 \text{ (girth in cm)} = \underline{2,620\text{m}^2}$
- $2,620 + 312 = \underline{\text{Total } 2,932\text{m}^2}$
- 5b. Preserved Trees -  $1.2 \times 402\text{m}^2 = 482.4$
- 9b. Green Roof, substrate >200mm -  $0.6 \times 1576\text{m}^2 = 945.6$

User input indicated by Orange fields

User Input	
Zoning lookup	Minimum GI Score
MRC	0.5

1. Enter Development Site Area m <sup>2</sup> HERE ▶		7200	
Surface Type (see tab for detailed descriptions)	Factor	Proposed Surface Area m <sup>2</sup>	Factor Values
1. Short Lawn	0.3	142	42.6
2. Tall Lawn (wild, not mown)	0.5	961	480.5
Permeable Paving	0.3	686	205.8
Vegetation		0	0
4a. Vegetation-Shrub below 3m	0.4	127	50.8
4b. Vegetation-Shrub / Hedgerow above 3m	0.5	77	38.5
4c. Vegetation-Pollinator friendly perennial planting	0.5	0	0
4d. Vegetation-Preserved hedgerow	1.2	22.7	27.24
Trees		0	0
5a. New trees	0.6	2932	1759.2
5b. Preserved trees	1.2	402	482.4
7. SuDS intervention (rain garden, bioswale)	0.6	0	0
Green Roof		0	0
9a. Green Roofs - Intensive green roof (substrate is 200-1200mm in depth)	0.7	0	0
9b. Green Roofs - Extensive green roof (substrate is 80-200mm in depth)	0.6	1576	945.6
10. Green wall	0.4	0	0
11. Retained Open Water	2	0	0
12. New open water	1.5	0	0
<b>Total Equivalent Surface Area of Greening Factors</b>		<b>6,925.70</b>	

**Green Factor Numerator** 4032.64

Minimum Required GI score	Final GI score	Result
0.5	0.56	Pass

Green Space Score

Green Space Factor Calculations - 1:200

REV.	DATE	DESCRIPTION	BK
			CHK BY
<b>FOR ADDITIONAL INFORMATION</b>			
Drawing number			22/04/226-
Project	U Store-It Unit, Liffey Valley, Dublin 22		
Client	Seamus Lonergan		
Drawing	Green Space Factor Calculations		
Scale	1:500 @ A1		
Date	13/01/2023		
Drawn by	AM		
<b>Carew Kelly Architects</b>			
21/22 Grafton Street, Dublin 2			
Tel. 01 - 6333 000 Fax. 01 - 6333 001			
E-mail : design@carewkelly.ie			
Copyright exists in this drawing. Said copyright and any works executed from it remains the property of Carew Kelly Architects Ltd. M.A.R.I.A.I., Chartered Architects			

