

LEGEND:

- SITE BOUNDARY
- EXISTING STORM DRAIN
- PROPOSED SURFACE WATER DRAIN
- PROPOSED TREE PIT
- PROPOSED OVERFLOW FROM TREE PIT
- EXISTING SURFACE WATER GULLY
- PROPOSED SURFACE WATER GULLY
- PROPOSED SURFACE WATER ACO CHANNEL OR SIMILAR APPROVED
- EXISTING SURFACE GRADIENTS
- PROPOSED WATER BUTTS
- INDICATES CONNECTION FROM ACO CHANNEL TO TREE PIT DIFFUSER BOX
- PROPOSED SW INSPECTION CHAMBER
- PROPOSED STANDARD KERB AT NEW LANDSCAPE GREEN/SUDS AREAS
- PROPOSED HIT AND MISS KERB AT NEW LANDSCAPE GREEN/SUDS AREAS

INTERCEPTION STORAGE: (FIRST 5mm OF RAINFALL)
INTERCEPTION REQUIRED BY BIO-RETENTION AND TREE PITS
 $44.5m^2 \times 0.005m = 222m^3$

INTERCEPTION PROVIDED BY BIO-RETENTION AND TREE PITS
 TOTAL AREA OF BIO-RETENTION/TREE PITS = $275m^2$
 ALLOW FOR A POOLING DEPTH OF 80mm FOR EVAPOTRANSPIRATION
 $275m^2 \times 0.08m = 22m^3$

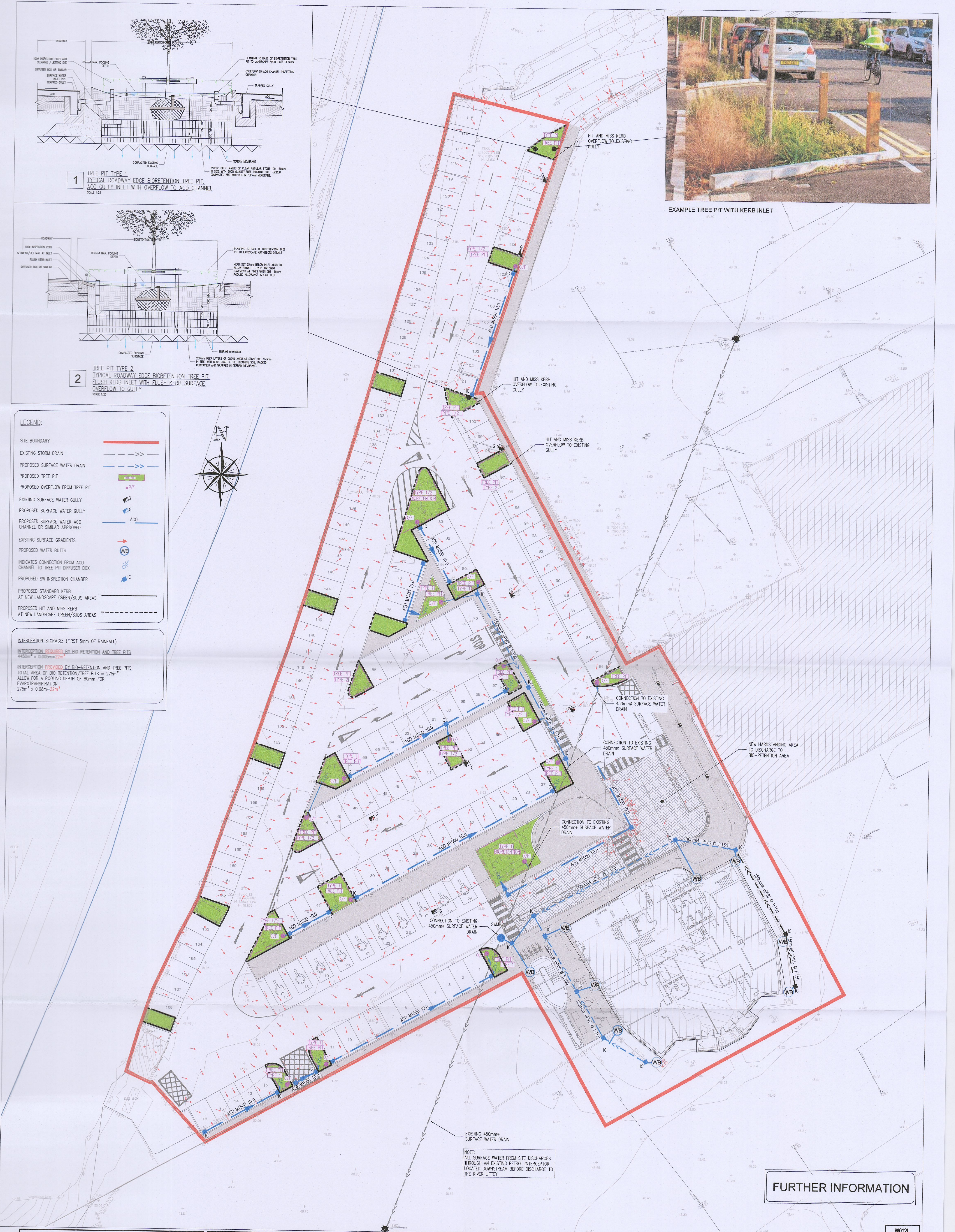

NOTE:
ALL SURFACE WATER FROM SITE DISCHARGES THROUGH AN EXISTING PETROL INTERCEPTOR LOCATED DOWNSTREAM BEFORE DISCHARGE TO THE RIVER LIFFEY

FURTHER INFORMATION

- NOTES**
- For setting out refer to Architect's drawings
 - This drawing to be read in conjunction with all other Architectural and Engineering drawings and all other relevant drawings and Specifications.
 - DO NOT SCALE THIS DRAWING. Use figured dimensions only.
 - No part of this document may be reproduced or transmitted in any form or stored in any retrieval system of any nature without the written permission as copyright holder except as agreed for use on the project for which the document was originally issued.
 - Ordnance Survey Ireland Licence Number EN 0074022

Rev. No.	Date	REVISION NOTE	Des. By	Chkd. By
P01	21.12.2022	ADDITIONAL INFORMATION FOR PLANNING APPLICATION REG. REF: S022A0345	DD	OS

Architect	NBK Architects Ltd
Project	Proposed Extension to Terminal Building and Ancillary Development Works At Weston Airport
Title	Proposed Drainage Layout Plan
Draw. No.	W012L-CSC-ZZ-XX-DR-C-0003
Date	29/11/2022
Des. By	JF
Chkd. By	OS
Appr. by	OS
Scale	1:250 @ A1
Revision	P01

CS Consulting Group
DUBLIN | LONDON | LIMERICK

Head Office
19-22 Dame Street, Dublin 2.
T: +353 (0)1 5480863
e: info@csconsulting.ie
w: www.csconsulting.ie

Quality
Environment
Energy
Health & Safety

ISO 9001:2008
ISO 14001:2004
ISO 50001:2011
OHSAS 18001:2007

W012L