

- PERMEABLE PAVING TO CAR PARKS = 166sqm
=> 166 x 250mm sub-base with 40% Porosity = 16.5m³ of Storage
 - PERMEABLE PAVING ON PODIUM = 1025sqm
=> 1025 x 40mm tray system = 41m³ of Storage
 - POROUS ASPHALT ON PODIUM = 167sqm
=> 167 x 40mm tray system = 6.5m³
 - SEDUM GREEN ROOFS (AT ROOF LEVEL) = 2418SQM
=> 2418 x 20mm tray system = 48m³
 - INTENSIVE/EXTENSIVE GREEN ROOF ON PODIUM = 2280SQM
=> 2280 x 40mm tray system = 115m³
- THEREFORE TOTAL VOLUME OF SuDS SYSTEM PROVIDED
=> 16.5 + 41 + 6.5 + 48 + 115 = **227m³**

LEGEND

- PERMEABLE PAVING SIZED TO ACCOMMODATE 100 YEAR STORMS
- SEDUM GREEN ROOF SYSTEM
- 300 LITRE WATERBUTT
- PERMEABLE PAVING AREAS TO PODIUM
- EXTENSIVE GREEN ROOF AREA TO PODIUM
- INTENSIVE GREEN ROOF AREA TO PODIUM
- POROUS ASPHALT AREA TO PODIUM
- TREE PIT DRAINAGE SYSTEM

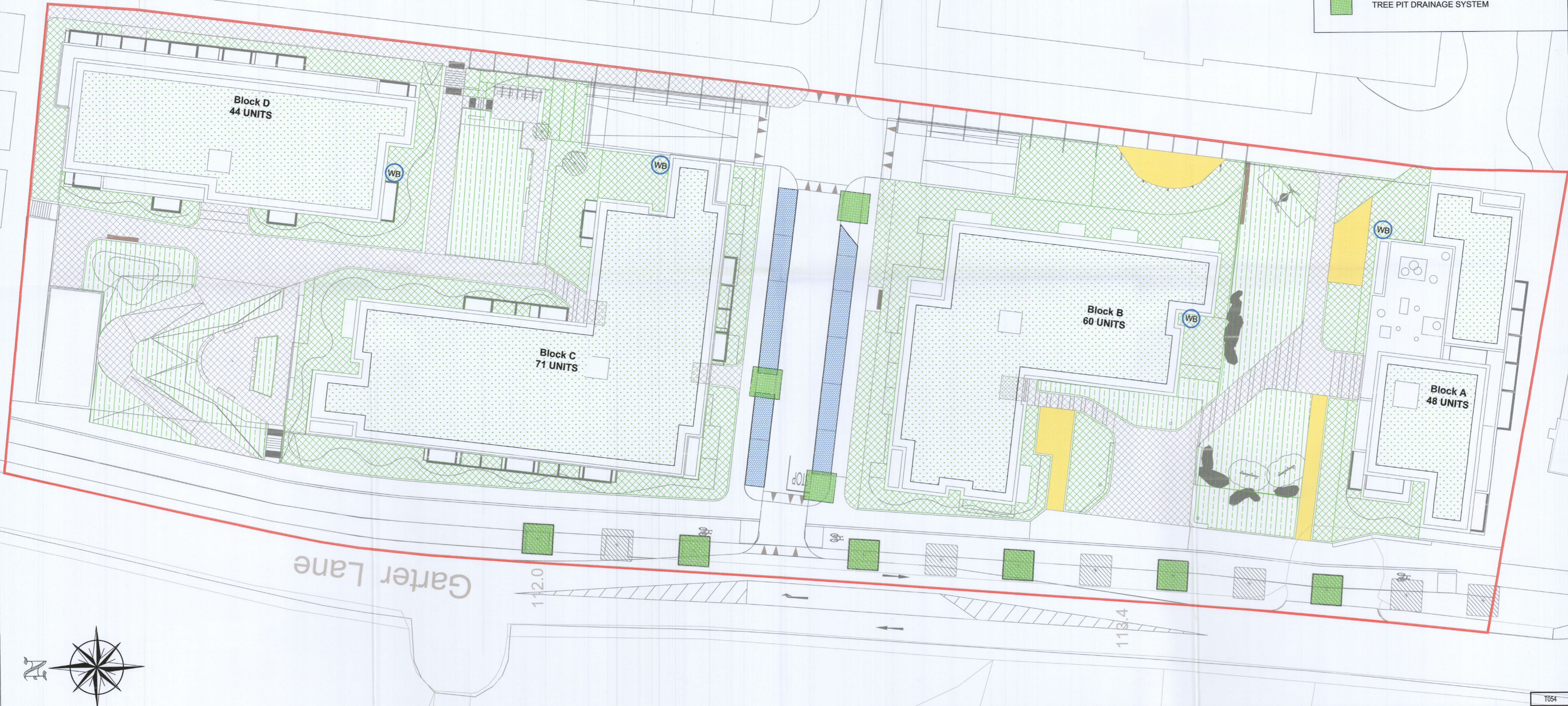

PLANNING DRAWING.
NOT FOR CONSTRUCTION.
ALL LEVELS GIVEN ARE
RELATIVE TO ORDNANCE DATUM.
THIS DRAWING HAS BEEN ISSUED FOR INFORMATION
PURPOSES ONLY AND MUST NOT BE USED
FOR CONSTRUCTION UNDER ANY CIRCUMSTANCES

NOTES

1. For setting out refer to Architect's drawings.
2. This drawing to be read in conjunction with all other Architectural and Engineering drawings and all other relevant drawings and Specifications.
3. DO NOT SCALE THIS DRAWING. Use figured dimensions only.
4. No part of this document may be reproduced or transmitted in any form or stored in any retrieval system of any nature without the written permission as copyright holder except as agreed for use on the project for which the document was originally issued.
5. Ordnance Survey Ireland Licence Number EN 0074022

Rev. No.	Date	REVISION NOTE	Dim. By	Chkd. By
A	2022.12.16	DRAWING REVISED FOLLOWING FURTHER INFORMATION REQUEST	AB	GL

Architect: DARMODY ARCHITECTURE
Project: RESIDENTIAL DEVELOPMENT AT GARTER'S LANE, CITYWEST
Title: SuD's Layout
Dwg. No.: GAR-CSC-ZZ-00-DR-C-0005
Date: Aug 2022
Dim by: AB
Chkd by: GL
Apprd by: NB
Scale: 1:250 @ A1
Revision: A

CS Consulting Group
DUBLIN | LONDON | LIMERICK
Head Office: 19-22 Dame Street, Dublin 2.
T: +353 (0)1 5480863
E: info@csconsulting.ie
W: www.csconsulting.ie
Quality: I.S. EN ISO 9001:2008
Environment: I.S. EN ISO 14001:2004
Energy: I.S. EN ISO 50001:2011
Health & Safety: OHSAS 18001:2007