

- NOTES:**
- ALL DRAINAGE SERVICING BUILDING TO BE PRIVATELY OWNED AND MAINTAINED. DIVERTED SURFACE WATER SEWER TO BE PROVIDED AS PUBLIC.
 - ALL PROPOSED SERVICES TO BE 2.0M MIN CLEAR OF EXISTING WATERMAIN AS REQUIRED BY IRISH WATER.

LEGEND:

- EXISTING FOUL WATER SEWER
- EXISTING SURFACE WATER SEWER
- EXISTING SURFACE WATER SEWER TO BE DEMOLISHED & REMOVED
- EXISTING WATERMAIN
- PROPOSED FILTER DRAIN
- PROPOSED SURFACE WATER SEWER
- PROPOSED FOUL WATER SEWER
- PROPOSED ATTENUATION TANK
- PROPOSED FOUL WATER MANHOLE
- PROPOSED SURFACE WATER MANHOLE
- PROPOSED SURFACE WATER INSPECTION CHAMBER
- EXTENT OF SURFACE WATER SEWER & WATERMAIN WAYLEAVE
- PROPOSED BUILDINGS
- EXTENT OF DEVELOPMENT
- INDICATING BOUNDARY BETWEEN DUN LAOGHAIRE RATHDOWN AND SOUTH DUBLIN COUNTY COUNCILS

EXISTING SERVICES FROM RECORDS:

- EXISTING SURFACE WATER
- EXISTING FOUL SEWER
- EXISTING WATERMAIN

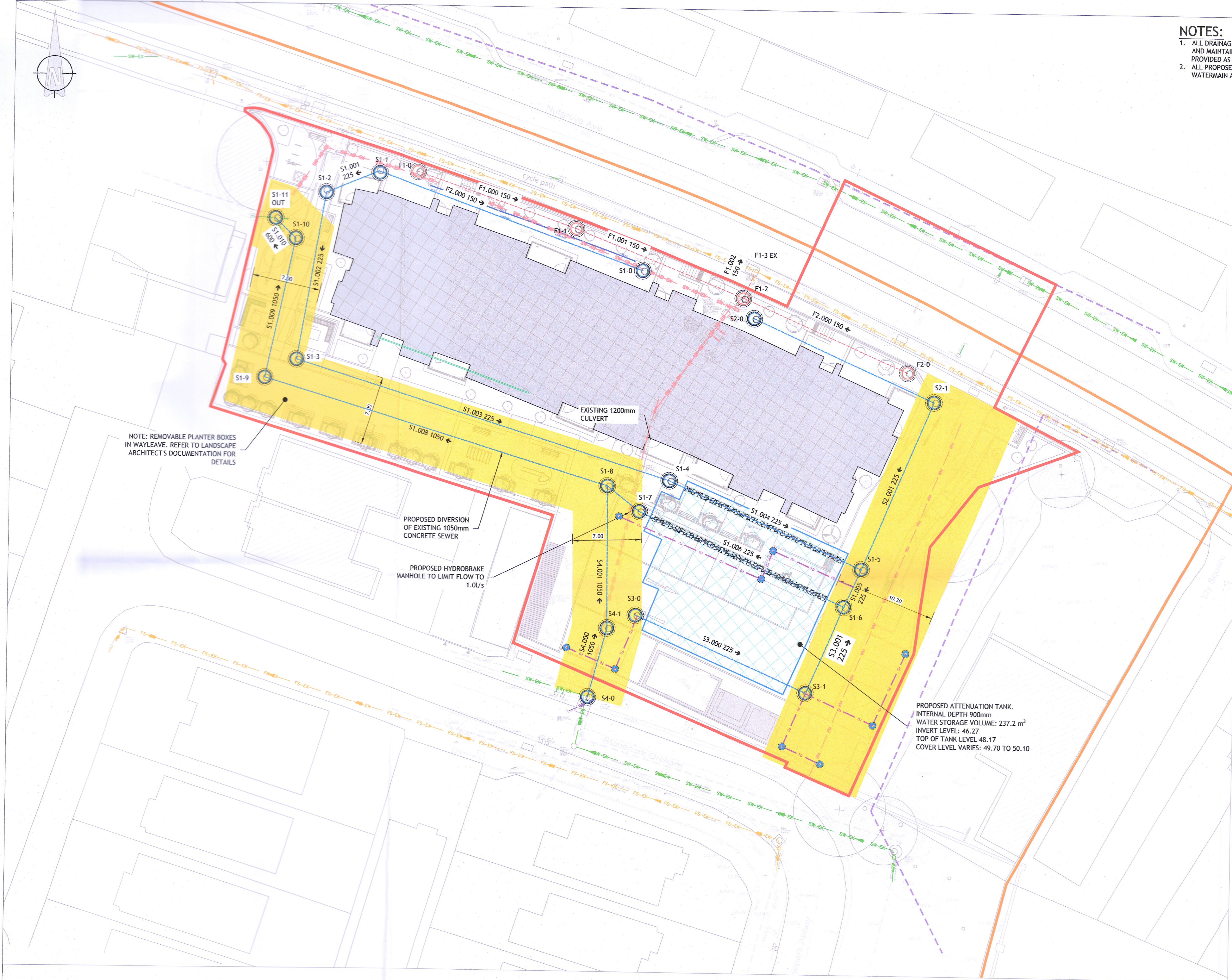

NOTE: REMOVABLE PLANTER BOXES IN WAYLEAVE. REFER TO LANDSCAPE ARCHITECT'S DOCUMENTATION FOR DETAILS

PROPOSED DIVERSION OF EXISTING 1050mm CONCRETE SEWER

PROPOSED HYDROBRAKE MANHOLE TO LIMIT FLOW TO 1.0U/S

PROPOSED ATTENUATION TANK.
INTERNAL DEPTH 900mm
WATER STORAGE VOLUME: 237.2 m³
INVERT LEVEL: 46.27
TOP OF TANK LEVEL 48.17
COVER LEVEL VARIES: 49.70 TO 50.10

STORM MANHOLES					
Name	Cover Level (m)	Diameter (mm)	Easting (m)	Northing (m)	Depth (m)
S1-0	48.6	1200	714926.313	728434.642	0.5
S1-1	48.54	1200	714899.366	728444.204	0.608
S1-2	48.6	1200	714893.948	728442.144	0.702
S1-3	49.3	1200	714891.176	728425.211	1.503
S1-4	49.8	1200	714929.332	728413.455	2.238
S2-0	48.8	1200	714937.706	728429.972	1.1
S2-1	49	1200	714956.119	728421.75	1.423
S1-5	49.7	1200	714948.981	728404.752	2.265
S3-0	50	1200	714926.067	728399.685	1.8
S3-1	49.7	1200	714943.482	728392.114	1.82
S1-6	49.7	1200	714947.277	728400.843	2.29
S1-7	49.8	1200	714926.316	728410.306	2.525
S4-0	50.09	1950	714921.343	728391.384	2.25
S4-1	50	1950	714923.176	728396.373	2.52
S1-8	49.8	1950	714923.031	728412.849	2.608
S1-9	49.3	1950	714887.965	728423.335	2.13
S1-10	48.9	1950	714890.918	728437.47	1.74
S1-11_OUT	48.75	1500	714888.838	728439.494	1.6

FOUL MANHOLES					
Name	Cover Level (m)	Diameter (mm)	Easting (m)	Northing (m)	Depth (m)
F1-0	48.63	1200	714903.335	728444.352	1.35
F1-1	48.55	1200	714919.497	728438.8	1.555
F2-0	48.5	1200	714953.405	728424.706	1.35
F1-2	48.63	1200	714936.55	728431.979	1.941
F1-3_EX	48.8	1200	714937.568	728435.036	2.165

PROPOSED FOUL PIPES										
Name	US Node	DS Node	Length (m)	US IL (m)	DS IL (m)	Fall (m)	Slope (1:X)	Dia (mm)	US Depth (m)	DS Depth (m)
F1.000	F1-0	F1-1	17.099	47.280	46.995	0.285	60.0	150	1.200	1.405
F1.001	F1-1	F1-2	18.367	46.995	46.689	0.306	60.0	150	1.405	1.791
F2.000	F2-0	F1-2	16.357	47.150	46.844	0.306	60.0	150	1.200	1.638
F1.002	F1-2	F1-3_EX	3.230	46.689	46.635	0.054	60.0	150	1.791	2.015

© PUNCH Consulting Engineers
This drawing and any design herein is the copyright of the Consultants and must not be reproduced without their written consent.
All drawings remain the property of the Consultants.
Figured dimension only to be taken from this drawing.
Consultants to be informed immediately of any discrepancies before work proceeds.

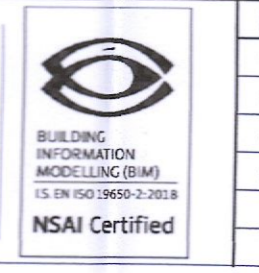

Rev	Amendment	By	Date	Rev	Amendment	By	Date
C01	PLANNING ISSUE	IBS	2021/04/19				
C02	PLANNING FI RESPONSE	DAP	2021/09/16				
C03	PLANNING CLARIFICATION RESPONSE	DAP	2021/11/18				
C04	PLANNING COMPLIANCE	DAP	2022/09/14				

Client: SIRIO HOMES

PUNCH consulting engineers
Dublin | Limerick | Cork | Galway | Glasgow
Carnegie House Library Road,
Dun Laoghaire, Co. Dublin, A96 C7W7
t +353 1 271 2200 | w punchconsulting.com

Project: RESIDENTIAL DEVELOPMENT, NUTGROVE AVENUE, RATHFARNHAM, DUBLIN
Title: PROPOSED DRAINAGE LAYOUT
Drawn: IBS Date drawn: JANUARY 2021 Technician Check: IBS Engineer Check: MR Approved: PC
Project No: 202252 Month: 202252-PUNCH-XX-XX-M2-C-0100 Drawing Status: AD
Scale @ A1: 1:200 Document No: 202252-PUNCH-XX-XX-DR-C-0100 Revision No: C04