

- WATERMAIN NOTES:**
1. WATER SUPPLY INFRASTRUCTURE SHALL BE CONSTRUCTED IN ACCORDANCE WITH THE CIVIL WORKS SPECIFICATION AND THE FOLLOWING DOCUMENTATION:
 - IRISH WATER CODE OF PRACTICE FOR WATER INFRASTRUCTURE (DOCUMENT IW-CDS-5020-03)
 - IRISH WATER WATER INFRASTRUCTURE STANDARD DETAILS (DOCUMENT IW-CDS-5020-01)
 2. ALL PIPEWORK MATERIALS SHALL COMPLY WITH THE FOLLOWING:
 - MEDIUM DENSITY POLYETHYLENE (MDPE) PIPES SHALL BE MANUFACTURED IN MODIFIED HIGH DENSITY POLYETHYLENE AND SHALL COMPLY WITH THE REQUIREMENTS OF I.S. EN 12201. PIPES SHALL BE TYPE PE80 TO WATER INDUSTRY SPECIFICATION WIS 4-32-17, WIS 4-32-14 AND WIS 4-32-15 WITH AN SDR RATING OF 11 OR EQUIVALENT AGREED. MDPE PIPES SHALL ONLY BE PERMITTED ON POTABLE WATER MAINS OF DIAMETERS EQUAL OR SMALLER THAN 200mm.
 - HIGH DENSITY POLYETHYLENE (HDPE) PIPES SHALL BE MANUFACTURED IN ACCORDANCE WITH I.S. EN 12201. PIPES SHALL BE TYPE PE100 TO WATER INDUSTRY SPECIFICATION WIS 4-32-17, WIS 4-32-14 AND WIS 4-32-15 WITH AN SDR RATING OF 11 OR EQUIVALENT AGREED.
 - THE COLOUR OF PIPES SHALL BE IN ACCORDANCE WITH THE UK NATIONAL JOINT UTILITIES GROUP PUBLICATION 'GUIDELINES ON THE POSITIONING AND COLOUR CODING OF UTILITIES' APPARATUS
 3. WATERMAIN TRENCH BACKFILL, BEDDING AND SURROUND SHALL COMPLY WITH DRAWING 22_112-CSE-00-XX-DR-C-2910.
 4. ALL PROPRIETARY FITTINGS TO BE BUTT FUSION FITTINGS TO THE WATER INDUSTRY STANDARD'S WIS 4-32-14/15.
 5. SLUICE VALVE DETAILS (INCLUDING CHAMBER, COVER AND FRAME) SHALL COMPLY WITH DETAIL STD-W-15 OF IRISH WATER WATER INFRASTRUCTURE STANDARD DETAILS (DOCUMENT NO. IW-CDS-5020-01)
 6. SLUICE VALVE DETAILS (INCLUDING CHAMBER, COVER AND FRAME) SHALL COMPLY WITH DETAIL STD-W-15 OF IRISH WATER WATER INFRASTRUCTURE STANDARD DETAIL (DOCUMENT NO. IW-CDS-5020-01)
 7. AIR VALVE DETAILS (INCLUDING CHAMBER, COVER AND FRAME) SHALL COMPLY WITH DETAIL STD-W-22 (ONLINE) AND STD-W-22 (OFFLINE) OF IRISH WATER WATER INFRASTRUCTURE STANDARD DETAILS (DOCUMENT NO. IW-CDS-5020-01)
 8. HYDRANT DETAILS (INCLUDING CHAMBER, COVER AND FRAME) SHALL COMPLY WITH DETAIL STD-W-18 (ONLINE) AND STD-W-19 (OFFLINE) OF IRISH WATER WATER INFRASTRUCTURE STANDARD DETAILS (DOCUMENT NO. IW-CDS-5020-01)
 9. WASHOUT HYDRANT DETAILS (INCLUDING CHAMBER, COVER AND FRAME) SHALL COMPLY WITH DETAIL STD-W-30A OF IRISH WATER WATER INFRASTRUCTURE STANDARD DETAILS (DOCUMENT NO. IW-CDS-5020-01)
 10. THRUST BLOCKS (IF SELF-ANCHORING JOINTS ARE NOT PROVIDED) SHALL COMPLY DETAIL STD-W-28 OF IRISH WATER WATER INFRASTRUCTURE STANDARD DETAILS (DOCUMENT NO. IW-CDS-5020-01)
 11. TESTING AND DISINFECTION SHALL COMPLY WITH SECTION 7 OF THE IRISH WATER CODE OF PRACTICE FOR WATER SUPPLY (DOCUMENT NO. IW-CDS-5020-03)
 12. MARKER TAPE AND MARKER POSTS SHALL BE PROVIDED IN ACCORDANCE WITH SECTION 2.76 OF THE IRISH WATER GENERAL CIVIL ENGINEERING SPECIFICATION (DOCUMENT NO. IW-TEC-300-01).

CALMOUNT ROAD

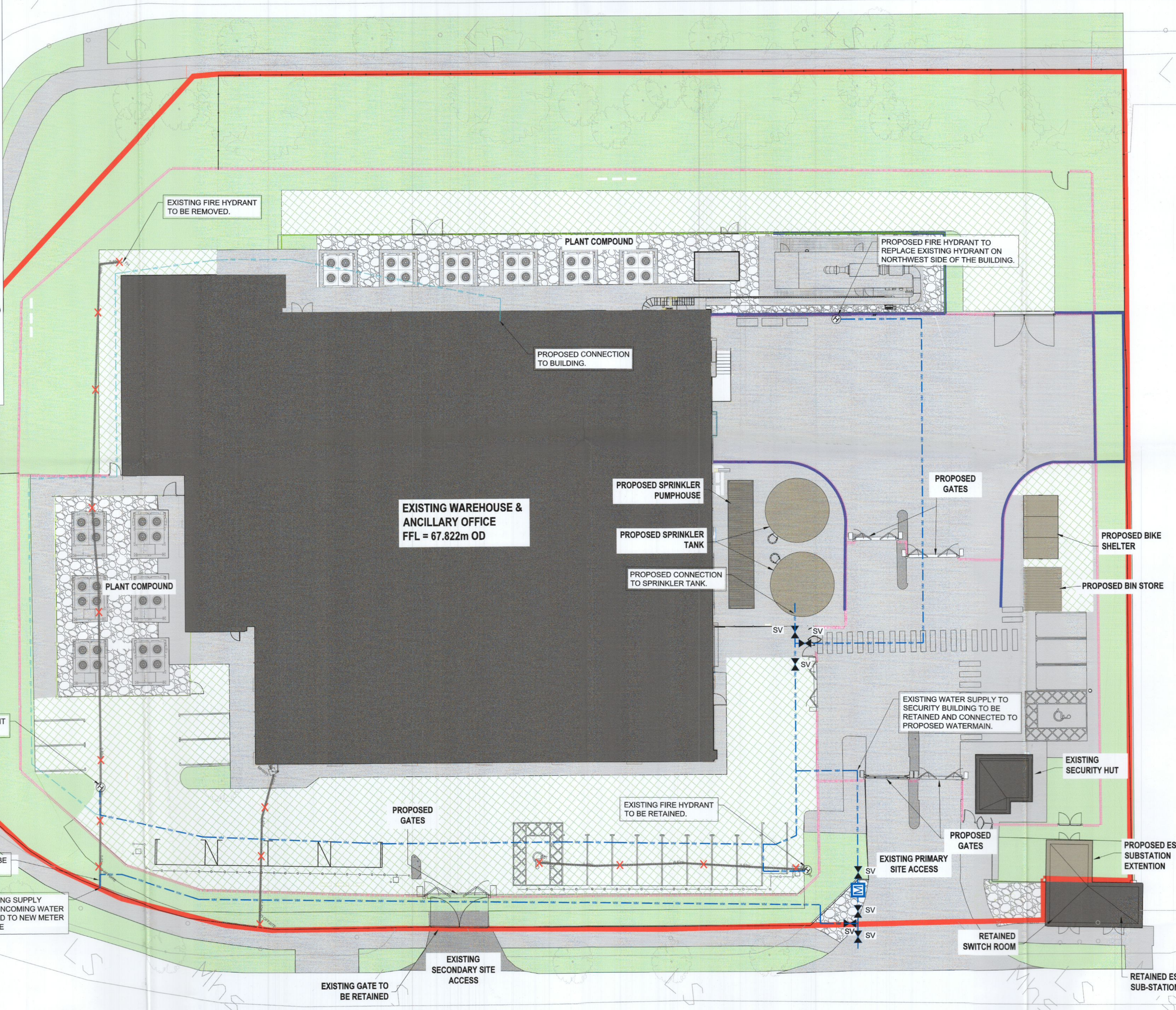

NOTES



KEYNOTES

LEGEND

- OUTLINE OF THE SITE SUBJECT TO THIS APPLICATION
- RETAINING WALLS
- EXISTING BUILDINGS
- GRASSCRETE
- CONCRETE PAVING
- PROPOSED BUILDINGS
- GRAVEL
- LANDSCAPING AREA (REFER TO LANDSCAPE ARCHITECT DRAWING)
- EXISTING FENCE
- PROPOSED FENCE
- PROPOSED PLANT SCREEN
- LOW LEVEL BARRIER
- EXISTING WATER PIPE TO BE RETAINED
- EXISTING WATER PIPE TO BE REMOVED
- PROPOSED 100mmØ WATER PIPE
- PROPOSED 50mmØ WATER PIPE
- WATER METER
- SCOUR VALVE
- FIRE HYDRANT

REV.	DATE	DESCRIPTION	DRN	ENG	CHK	APP
P03	09/12/22	PLANNING ISSUE	LT	CD	CD	HF
P02	14/10/22	PLANNING ISSUE	LT	CD	CD	HF
P01	02/09/22	DRAFT PLANNING ISSUE	LT	CD	CD	HF

ANY UNAUTHORIZED USE OR REPRODUCTION OF THIS DOCUMENT IN WHOLE OR IN PART IS PROHIBITED. DELETE THIS DOCUMENT IF YOU HAVE RECEIVED IT IN ERROR

MECHANICAL & ELECTRICAL ENGINEER CIVIL & STRUCTURAL ENGINEER



ARCHITECT
KAVANAGH TUITE ARCHITECTS
TOWNSHILL WELLS CLOONSHAN ROAD COX 0207 IRELAND
00 0000 0000 MAL@KAVANAGHTUITE.IE

FIRE ENGINEER
BB7
BB7 Fire & Security Consulting
0000 0000 0000 0000
0000 0000 0000 0000
0000 0000 0000 0000

SECURITY ENGINEER
CUNDALL
Cundall Engineering Limited
700 Dunlop Street, Dublin,
00 0000 0000
T: +353 (0)1 453 7000, E: info@cundall.com, W: www.cundall.com

PROJECT:
Unit 1, M50 Business Park

TITLE:
PROPOSED WATER SUPPLY LAYOUT PLAN

DRAWING NO.:
22_112-CSE-00-XX-DR-C-2310

SCALE: 1:200 AGILE No.: REV: P03