

KEY PLAN
SCALE 1:1000

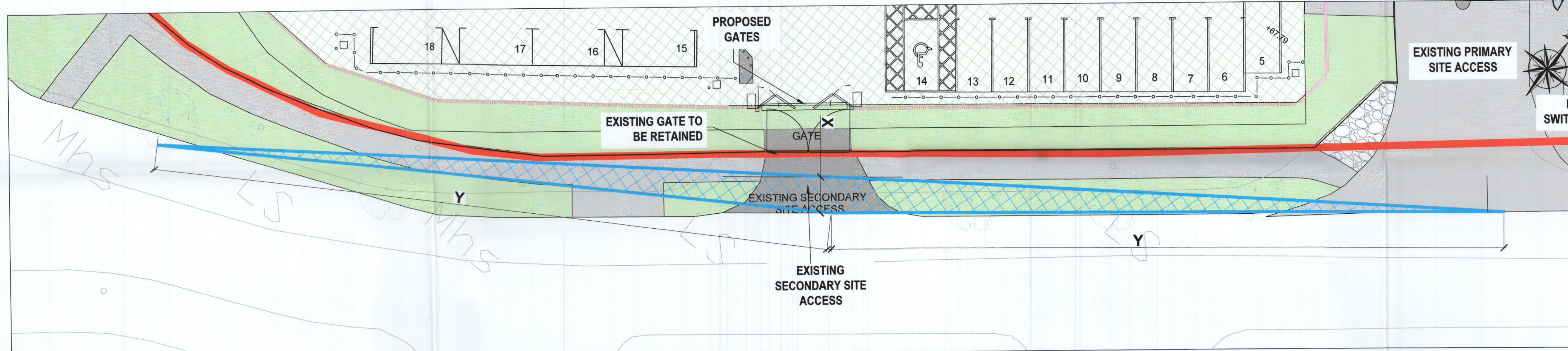

INSERT A-PROPOSED SECONDARY ENTRANCE PLAN -
SCALE 1:150

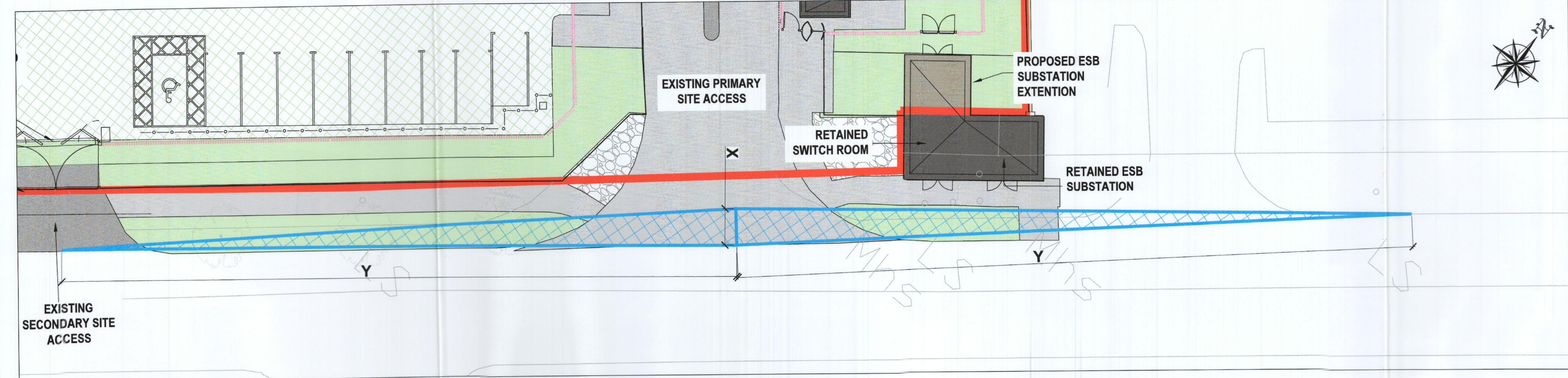

INSERT B-PROPOSED PRIMARY ENTRANCE PLAN -
SCALE 1:150

NOTES:

1. Sight Stopping Distances have been calculated in accordance with Table 4.3 of DMURS)
2. The design speed of the Ballymount Road Upper is 50 kph
3. Refer to Drawing No. 22_112-CSE-00-XX-DR-C-2020 for proposed pavement details.
4. Refer to Drawings 22_112-CSE-00-XX-DR-C-2022 and 2023 for proposed AutoTracking layout plans

LEGEND

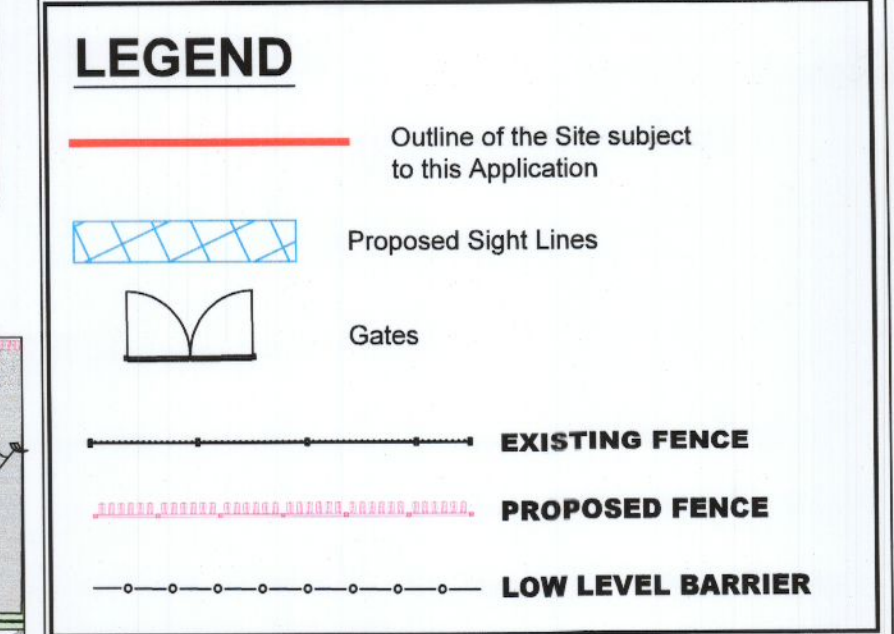

SIGHT STOPPING DISTANCES (SSD's)

X (m) =	2.4
Y (m) =	45 (See Note 1)

REV.	DATE	DESCRIPTION	DRN	ENG	CHK	APP
P03	09/12/22	PLANNING ISSUE	LT	CD	CD	HF
P02	14/10/22	PLANNING ISSUE	LT	CD	CD	HF
P01	02/09/22	DRAFT PLANNING ISSUE	LT	CD	CD	HF

ANY UNAUTHORIZED USE OR REPRODUCTION OF THIS DOCUMENT IN WHOLE OR IN PART IS PROHIBITED. DELETE THIS DOCUMENT IF YOU HAVE RECEIVED IT IN ERROR

MECHANICAL & ELECTRICAL ENGINEER	CIVIL & STRUCTURAL ENGINEER
 Clifton Scannell Emerson Associates <small>Clifton Scannell Emerson Associates Limited Consulting Engineers, 2nd Floor, The Heights, Ballymount Park, Dublin 24, Ireland Tel: +353 (0)1 491 1111 Fax: +353 (0)1 491 1112 Email: info@csesa.com</small>	
ARCHITECT	FIRE ENGINEER
 KAVANAGH TUITE ARCHITECTS <small>TERMINUS HILLS, CLOONESHAR ROAD, D16 D227 IRELAND Tel: +353 (0)1 226 8800 Email: info@kavanaghtuite.ie</small>	
SECURITY ENGINEER	OTHER ENGINEER
 CUNDALL <small>Consulting Engineering Limited 70 Stephen's Green, Dublin 2 D02 Y222 Ireland Tel: +353 (0)1 478 7100 Email: info@cundall.com, www.cundall.com</small>	

PROJECT: Unit 1, M50 Business Park
 TITLE: PROPOSED PRIMARY & SECONDARY ENTRANCE SITE LAYOUT PLAN
 DRAWING NO.: 22_112-CSE-00-XX-DR-C-2021

A1	SCALE: AS INDICATED	AGILE No.:	REV: P03
----	---------------------	------------	----------