

1 2001 Existing First Floor
1:100

NOTES

KEYNOTES

LEGEND

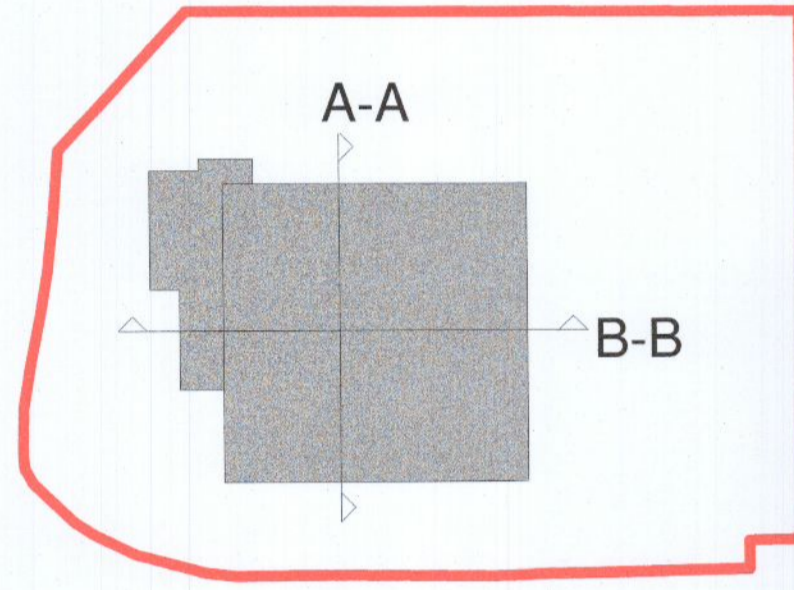

REV.	DATE	DESCRIPTION	DRN	ENG	CHK	APP
P1	16.12.2022	ISSUED FOR PLANNING	KTA	KTA		

ANY UNAUTHORIZED USE OR REPRODUCTION OF THIS DOCUMENT IN WHOLE OR IN PART IS PROHIBITED. DELETE THIS DOCUMENT IF YOU HAVE RECEIVED IT IN ERROR

MECHANICAL & ELECTRICAL ENGINEER CIVIL & STRUCTURAL ENGINEER

Clifton Scannell Emerson Associates
Clifton Scannell Emerson Associates Limited
 Consulting Engineers, 3rd Floor, The Signpost, Station Road, Parkway Rd,
 Donaghadee, Co. Wick, Ireland, 845 0052
 T: +353 (0)1 7288006, E: info@cses.ie, W: www.cses.ie

ARCHITECT
KAVANAGH TUITE ARCHITECTS
TERMINUS MILLS, CLONKILKASH ROAD, DRN 8027, IRELAND
 T: +353 (0)1 2748800, W: WWW.KAVANAGHTUITE.COM

FIRE ENGINEER
BB7
BB7 Fire & Security Consulting
 Unit 10, Blue Pearl Business Centre, Foranagh,
 Dublin, D18 K7D2
 T: +353 (0)1 807 8222, E: info@bb7.ie, W: www.bb7.ie

SECURITY ENGINEER
CUNDALL
Cundall Engineering Limited
 7-11 St. James Street, Dublin, D02 XE27, Ireland
 T: +353 (0)1 479 7100, E: info@cundall.com, W: www.cundall.com

OTHER ENGINEER
Macro Works Ltd
Macro Works Ltd
 Ground Floor, Hibernia House,
 Cherrywood Business Park,
 Longhillsstown,
 Ireland
 D18 E440

PROJECT: UNIT 1, M50 BUSINESS PARK

TITLE: EXISTING FIRST FLOOR PLAN

DRAWING NO.: J2139-KTA-22-XX-DR-A-2001

A1 SCALE: As indicated AGILE No.: REV: P1