

**CONNECTION OF R.W.P./S.V.P. TO MAIN SEWER**  
SCALE 1:50

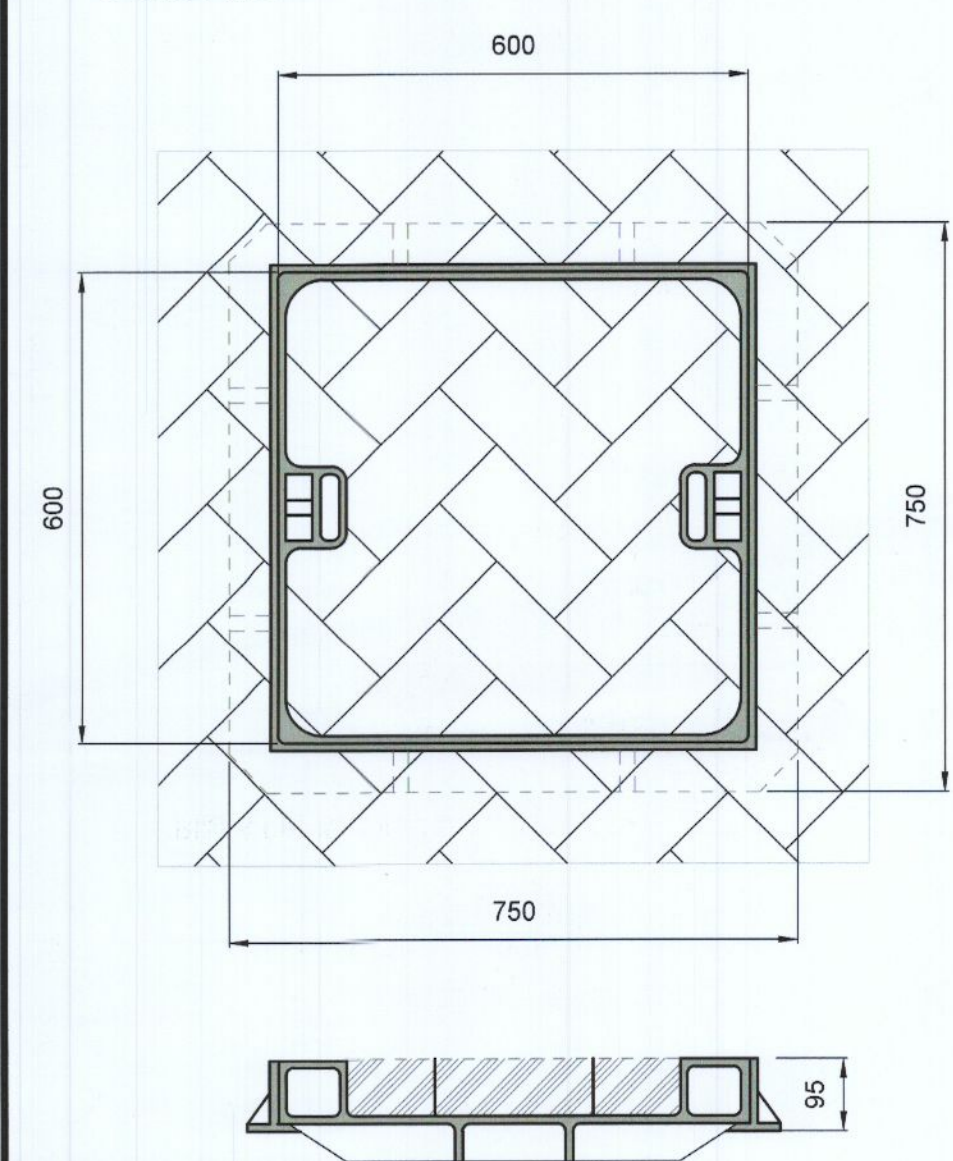

**TYPICAL PAVIOR INFILL MANHOLE COVER**  
SCALE 1:10

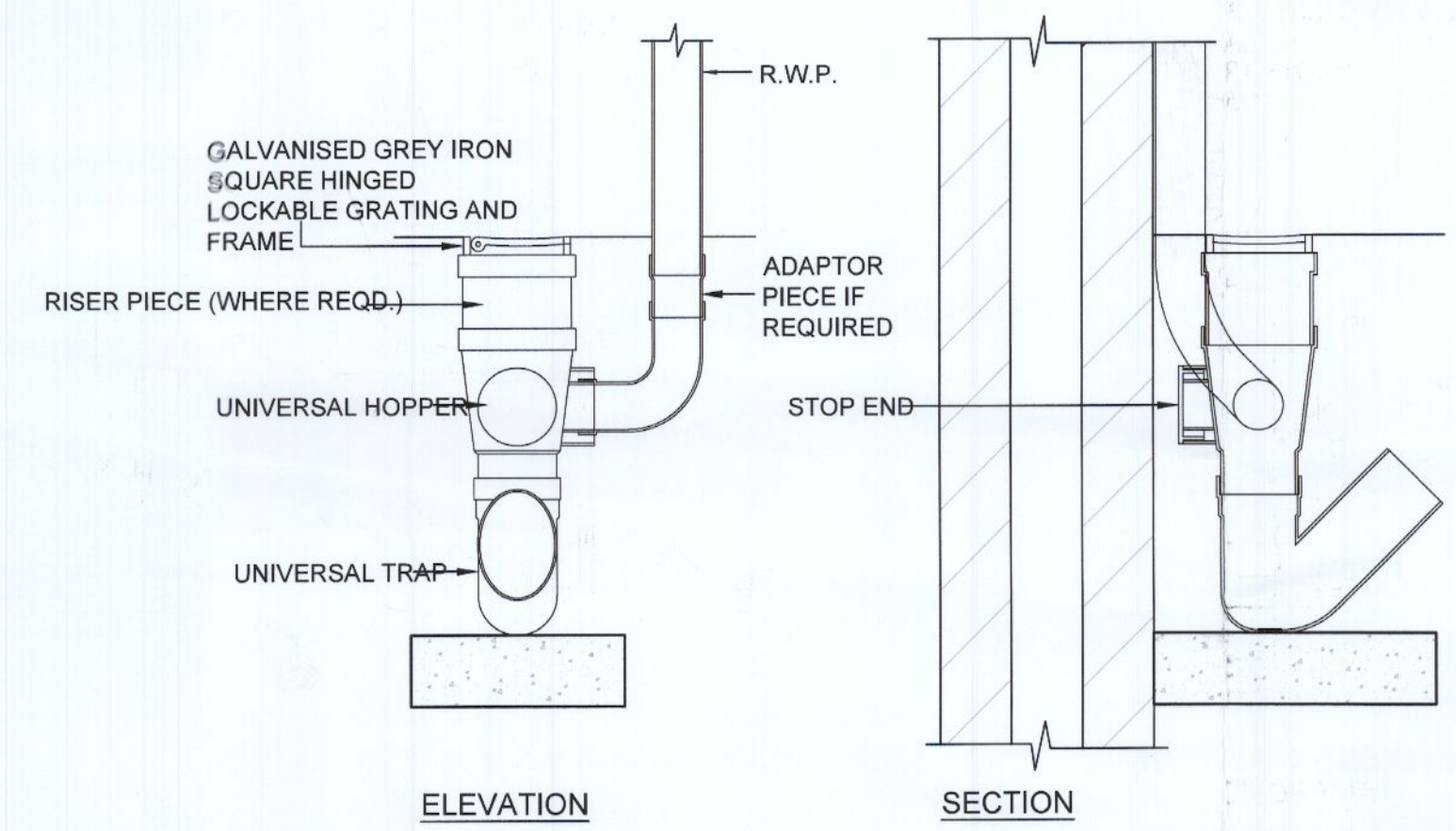

**RWP GULLY DETAIL**  
(SCALE 1:10)

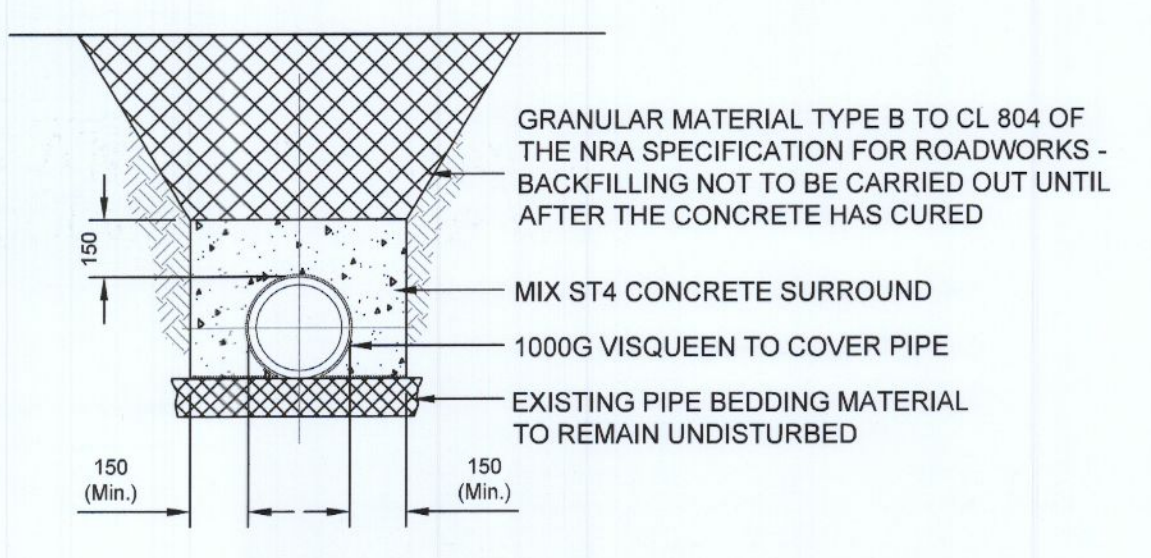

**CONCRETE SURROUND PROTECTION TO EXISTING SEWER**  
SCALE 1:20

D400 CHANNEL AND GRATING IS REQUIRED IN TRAFFICKED AREAS AND C250 MINIMUM IN ALL OTHER AREAS AND SHALL BE LOCKABLE  
IN PEDESTRIAN AREAS AN APPROVED CHANNEL DRAIN WITH GRATING TO INCORPORATE HEEL GUARD SUBJECT TO ARCHITECT'S APPROVAL  
SUPPLIER/MANUFACTURER TO CONFIRM STRUCTURAL, CAPACITY & HYDRAULIC DETAILS

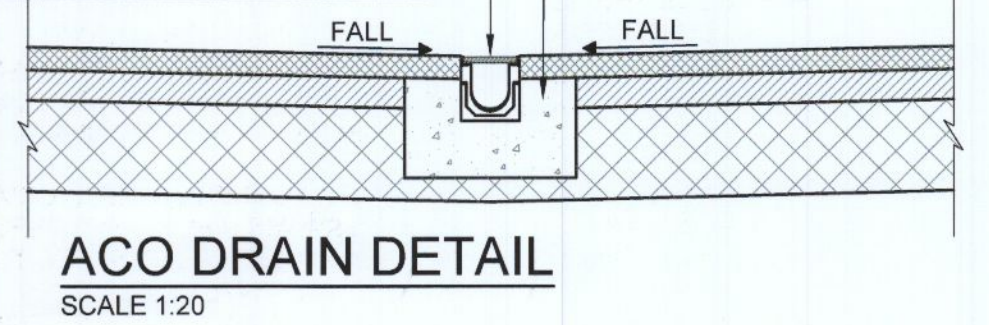

**ACO DRAIN DETAIL**  
SCALE 1:20

FOR CONNECTION TO EXISTING SEWERS ONLY. FOR CONNECTION NEW SEWERS, Y OR T PIECES TO BE USED

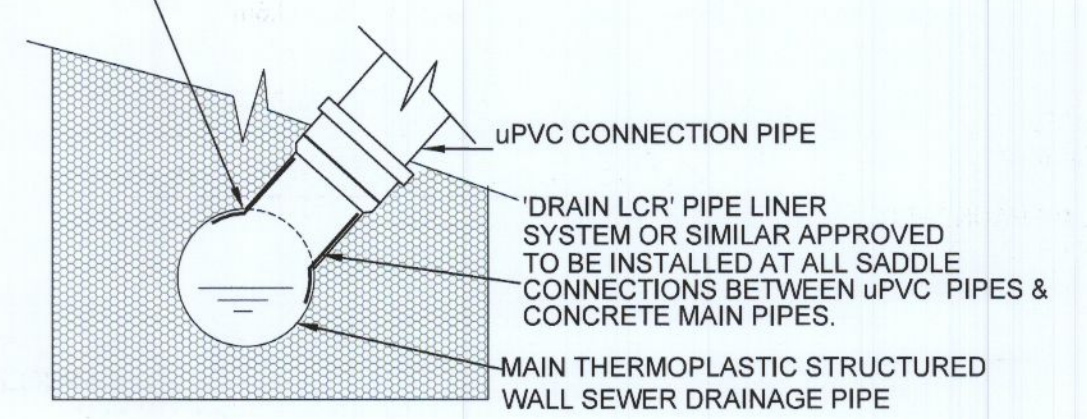

**SEALED WATERTIGHT uPVC TO THERMOELASTIC SADDLE CONNECTION**  
OR  
'DRAIN LCR' PIPE LINER - OPTION 1  
'FLEXSEAL' FLEXIBLE SADDLE - OPTION 2  
NOT TO SCALE

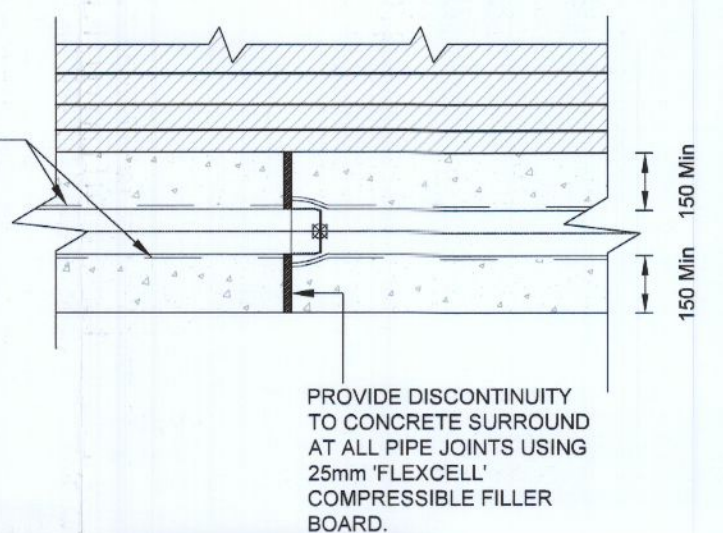

**DISCONTINUITY JOINT DETAIL**  
SCALE 1:20

**NOTES:**  
ACO MULTIDRAIN M150D CHANNEL OR APPROVED EQUIVALENT  
ACO END CAPS TO BE PROVIDED AT START OF RUNS. ACO SUMP UNIT TO BE PROVIDED AT ALL OUTFALL LOCATIONS. 110MM UPVC PIPE TO CONNECT SUMP TO MAIN STORM LINE. ACO JOINTS TO BE SEALED TO ENSURE NO INFILTRATION.

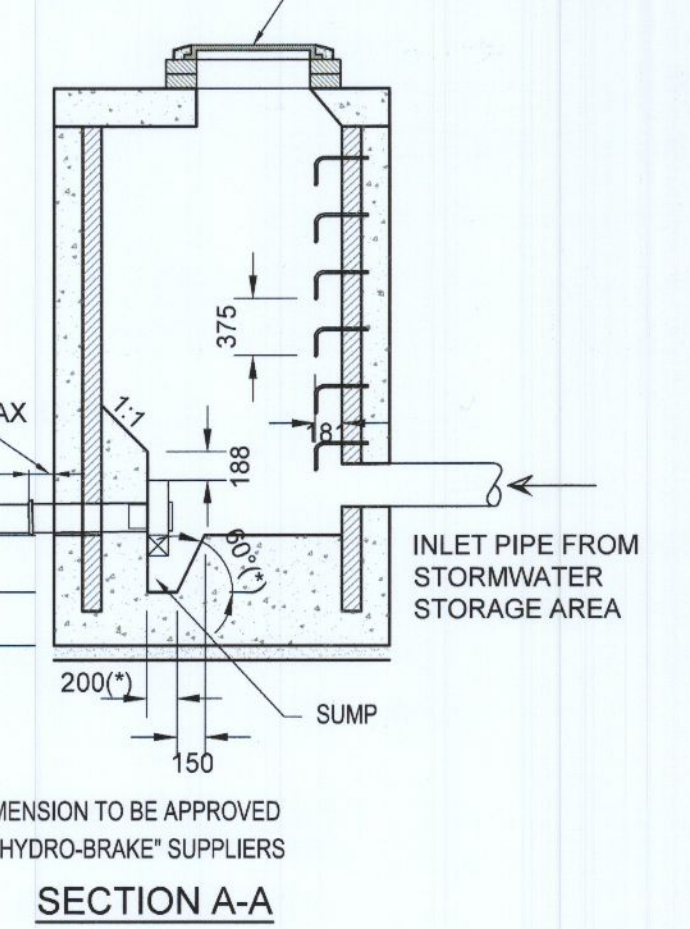
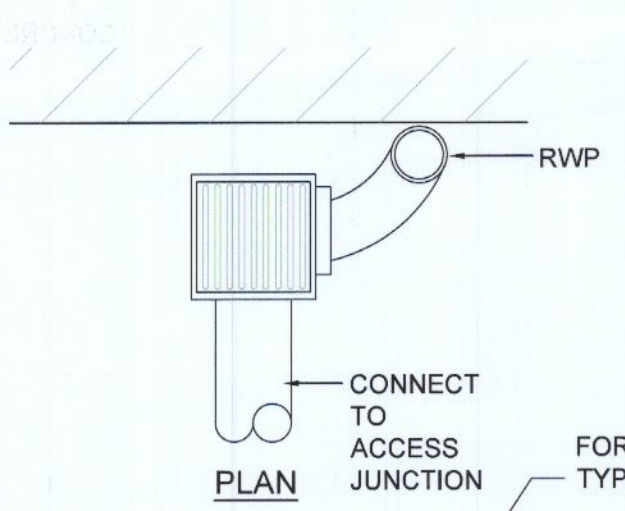

**TYPICAL "HYDROBRAKE" MANHOLE DETAIL**  
SCALE 1:50

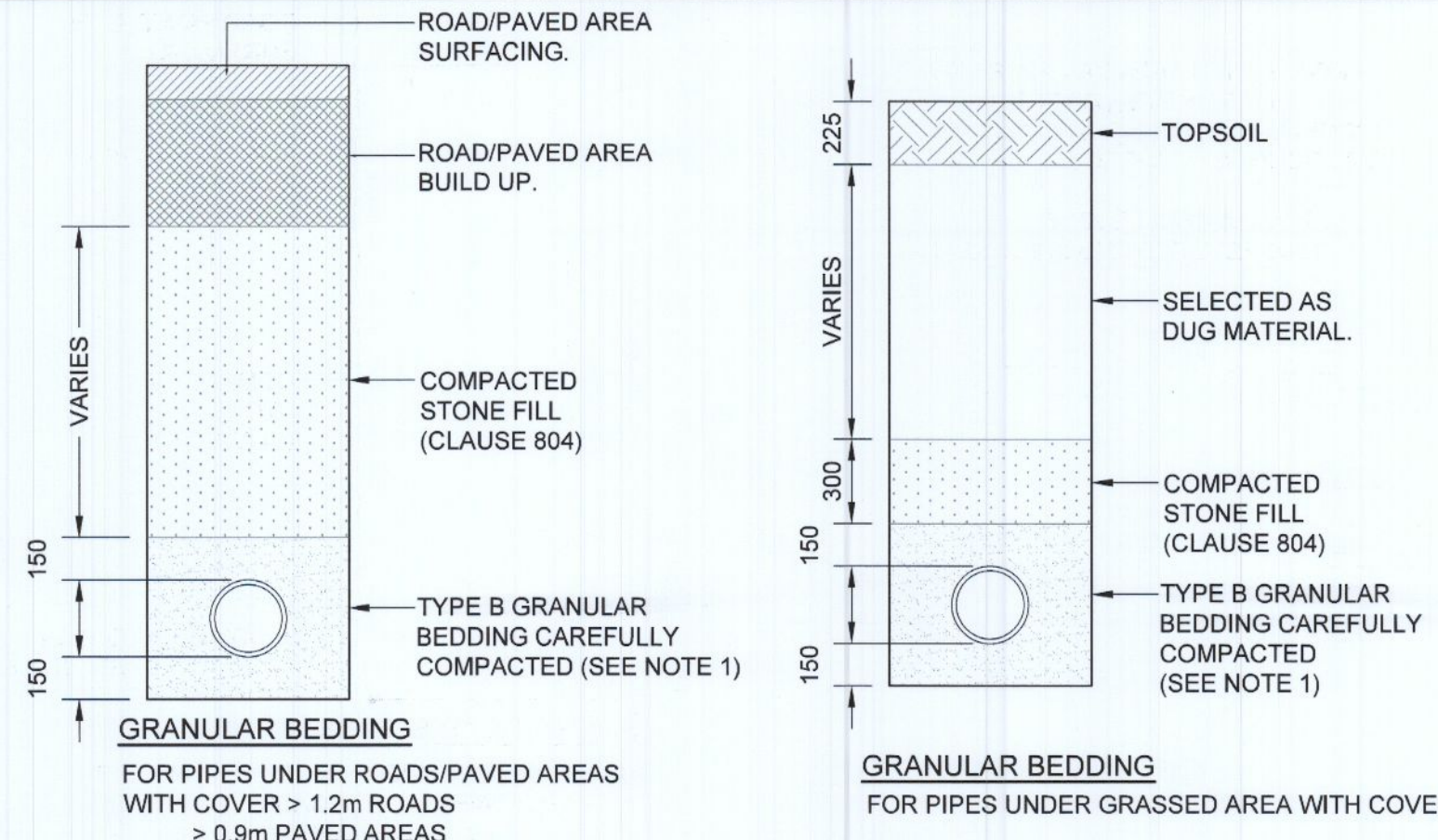

**NOTE**  
DIM A=150m  
C16/20 CONCRETE  
REQUIRED WHERE COVER TO PIPES IS LESS THAN 1.2m & REQUIRED THROUGHOUT FOR PIPES UNDER FLOOR SLABS.  
ALSO REQUIRED WHERE COVER TO SEWER PIPES IN GRASSED/LIGHTLY TRAFFICKED AREAS IS LESS THAN 0.9m FOR PVC PIPES & 0.6m FOR EARTHENWARE PIPES.  
PROVIDE 12mm VERTICAL MOVEMENT AT MAX INTERVAL OF 5m IN CONCRETE SURROUND.

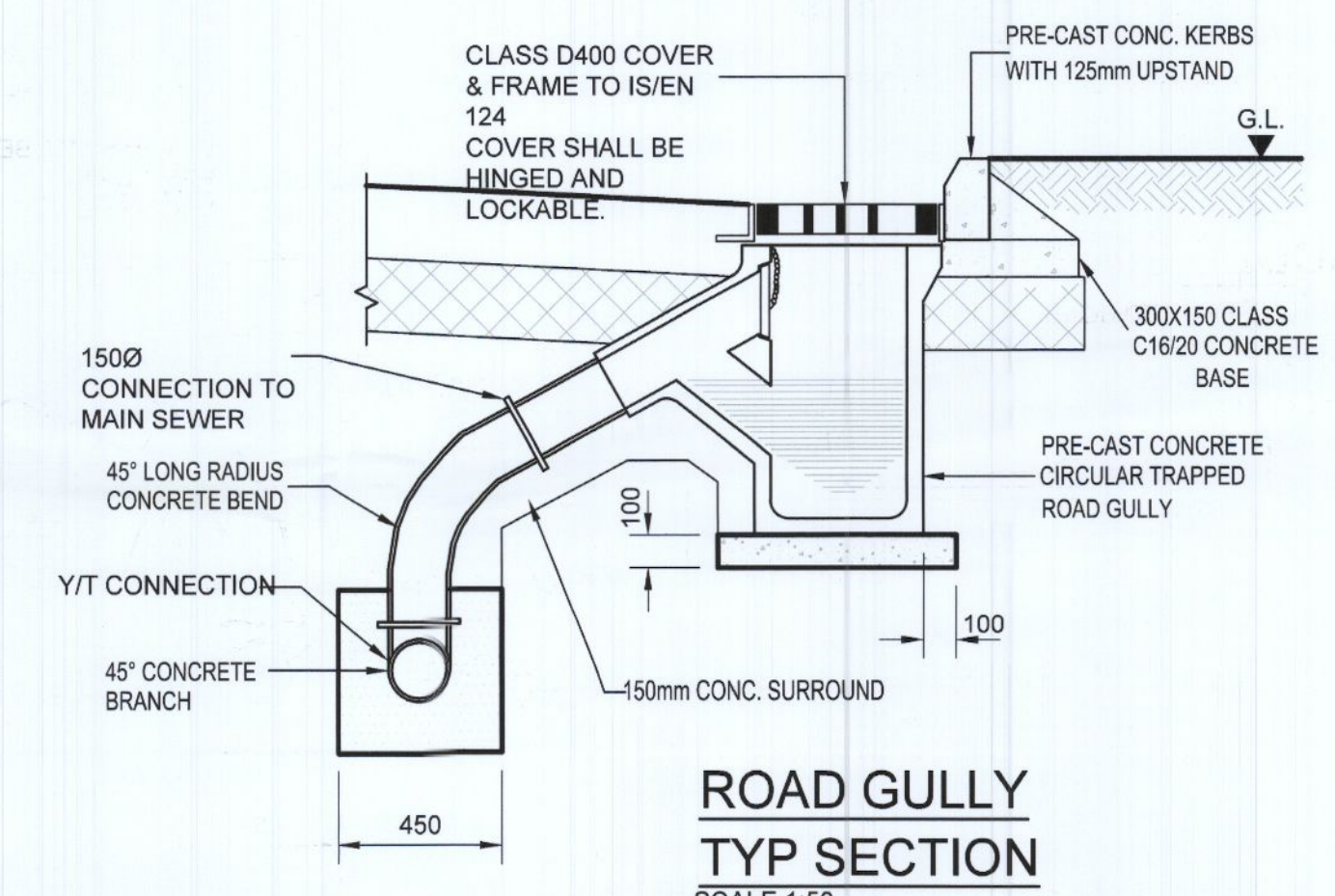

**ROAD GULLY TYP SECTION**  
SCALE 1:50

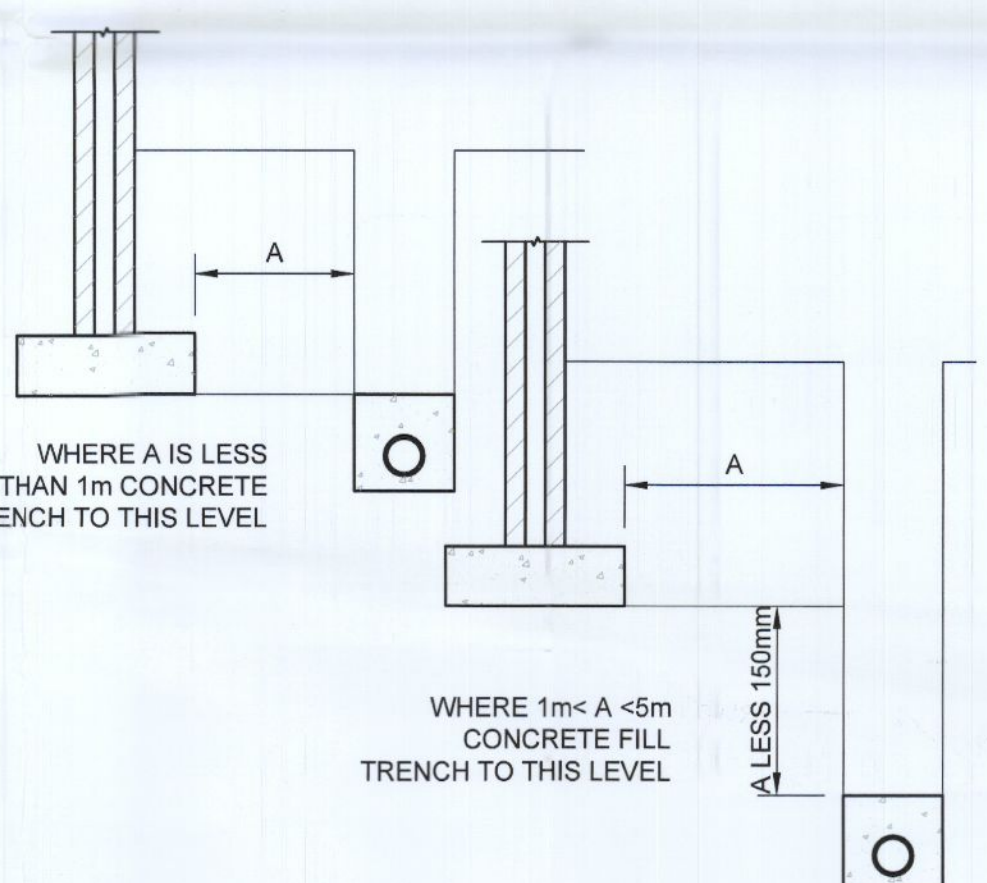

**CONCRETE SURROUND TO PIPE RUN NEAR BUILDINGS**  
NOT TO SCALE

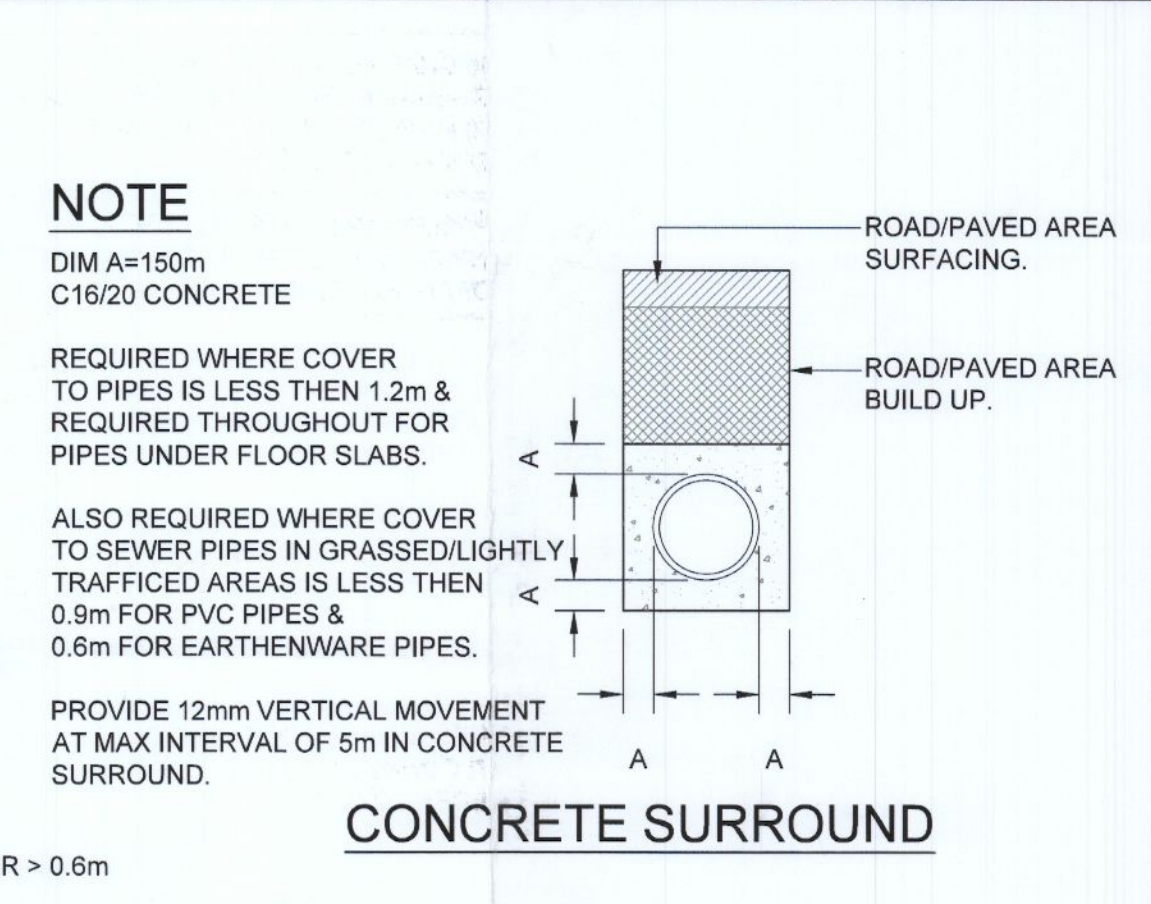

**CONCRETE SURROUND**

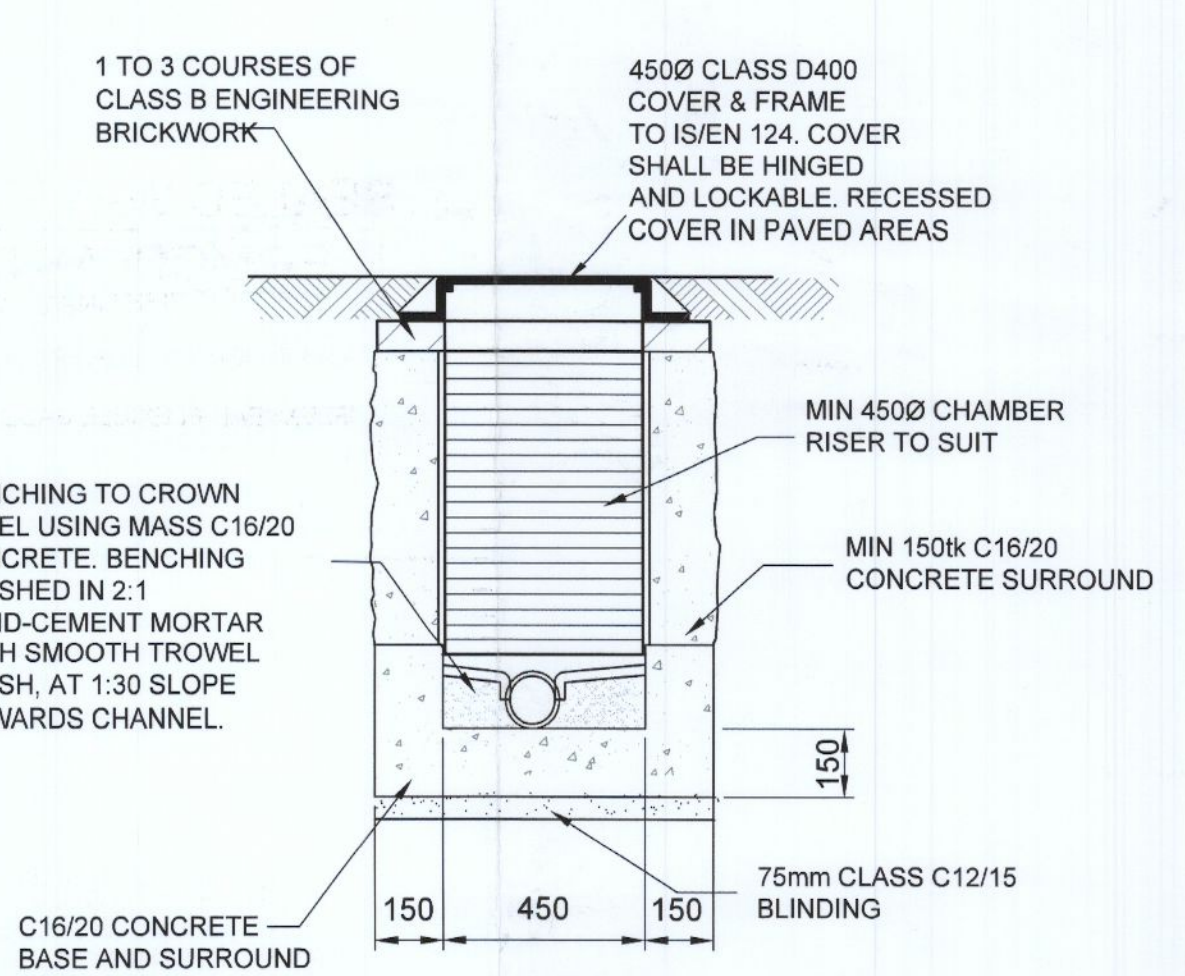

**SECTION A-A**

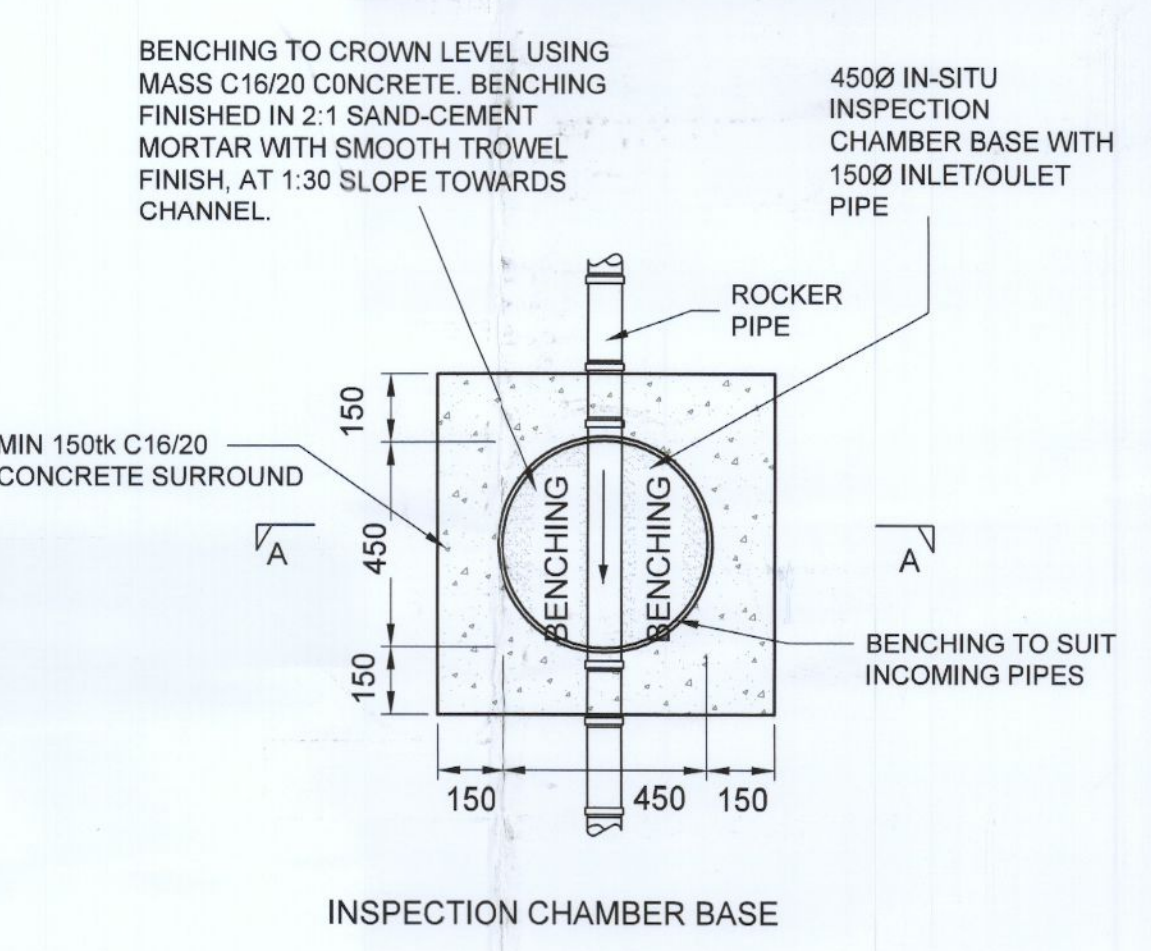

**TYPICAL INSPECTION CHAMBER DETAIL**  
SCALE 1:25

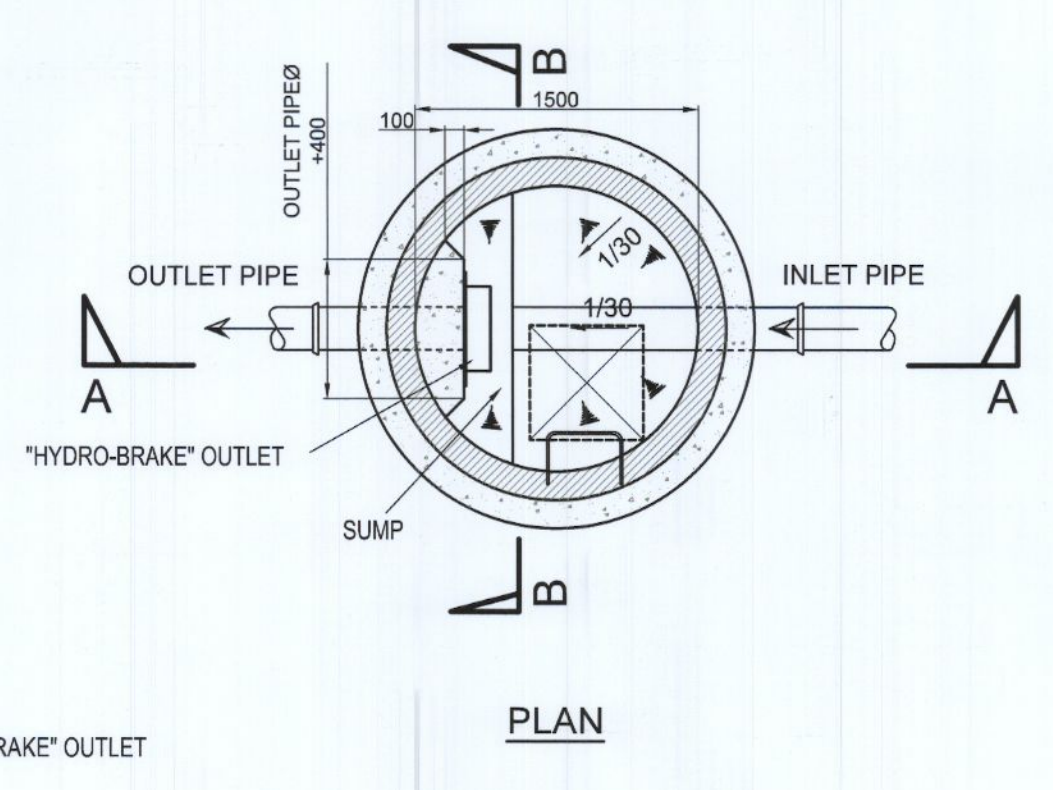

**PLAN**

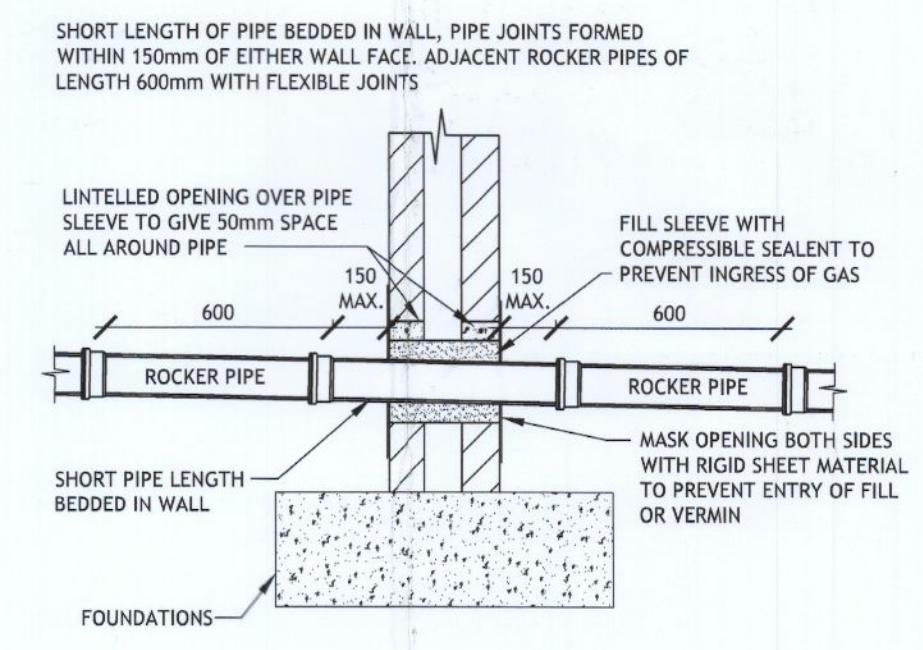

**PIPEWORK PENETRATING BLOCK WALLS**  
Not to scale

**Notes:**  
1. This drawing is the copyright of Collins Boyd Engineering Ltd. It is a confidential document and must not be copied, used or its contents divulged without prior written permission.  
2. DO NOT SCALE, use figured dimensions only, if in doubt ask. All dimensions to be checked by contractor on site, any errors or discrepancies to be reported to the Architects.  
3. All works to be carried out in accordance with the current building control act and building regulations.  
4. Clients are obliged to forward a commencement notice to the local authority at least 14 days prior to the commencement of any works on site.  
5. Consultants to be informed immediately of any discrepancies before work proceeds.

**NOT FOR CONSTRUCTION**

Revisions				
Rev	By	Date	Description	
PRO	MG	21.11.2022	Issued for DT Review prior to Planning Issue	
PL0	MG	01.12.2022	Issued for Planning	

**Client:**  
BoM Esker Educate Together National School, Esker Lane

**Architect:**  
Oppermann, Architects & Interior Designers  
Unit D1, The Millhouse  
The Steelworks  
Foley Street, Dublin 1



**Job Title:**  
Proposed Additional Accommodation Scheme to Esker Educate Together National School, Esker Lane

**Drawing Title:**  
Typical Drainage Details

**Status:** Planning  
**Date:** November 2022  
**Scale:** AS @ A1  
**Drawn by:** MG

JOB No.	DRG No.	REV.
21.135	211	PL0