

Roof Construction  
 Selected Roof Slates on  
 50x50mm Treated Battens on  
 Tuved Roofing Felt on  
 175x44mm Common Rafter @ 400mm Crs  
 Kingspan Thermapitch TP10 125mm Thick  
 Placed Between Common Rafters  
 Kingspan Composite Insulation K18 52.5mm  
 Mechanically Fixed To Underside Of Rafters  
 2mm Skim Coat

ROOF MAKE UP  
 3 LAYERS OF MINERAL FELT ON  
 WBP PLYWOOD DECKING ON  
 FIRING DIECES (1:60)  
 225mmx44mm JOISTS @ 400mmc/c  
 150mm EARTHWOOL BETWEEN JOISTS AND  
 12.5mm Plasterboard &  
 3mm Skim Coat

Bespoke Rooflight For Flat  
 Roofs

External Wall Construction  
 External Render Finish To Match Existing  
 House  
 215mm Cavity Block  
 100mm Kingspan Insulation Board or Equal  
 Finished with 3mm Skim Coat.

Floor Build Up  
 Min. 150mm Power Floated Conc Finish on  
 100mm Kingspan Therma Floor on  
 Monarflex Radon Barrier Membrane on  
 50mm Blinding on  
 250mm min. Compacted Hardcore  
 25mm Perimeter Insulation on  
 All Rising Wall's  
 DPC min 150mm  
 above finished ground level

300x645mm Strip Foundation  
 With Bar Reinforcement to  
 Engineers Specification

Radon Barrier  
 Complete With Sump  
 And Vent To Exterior.

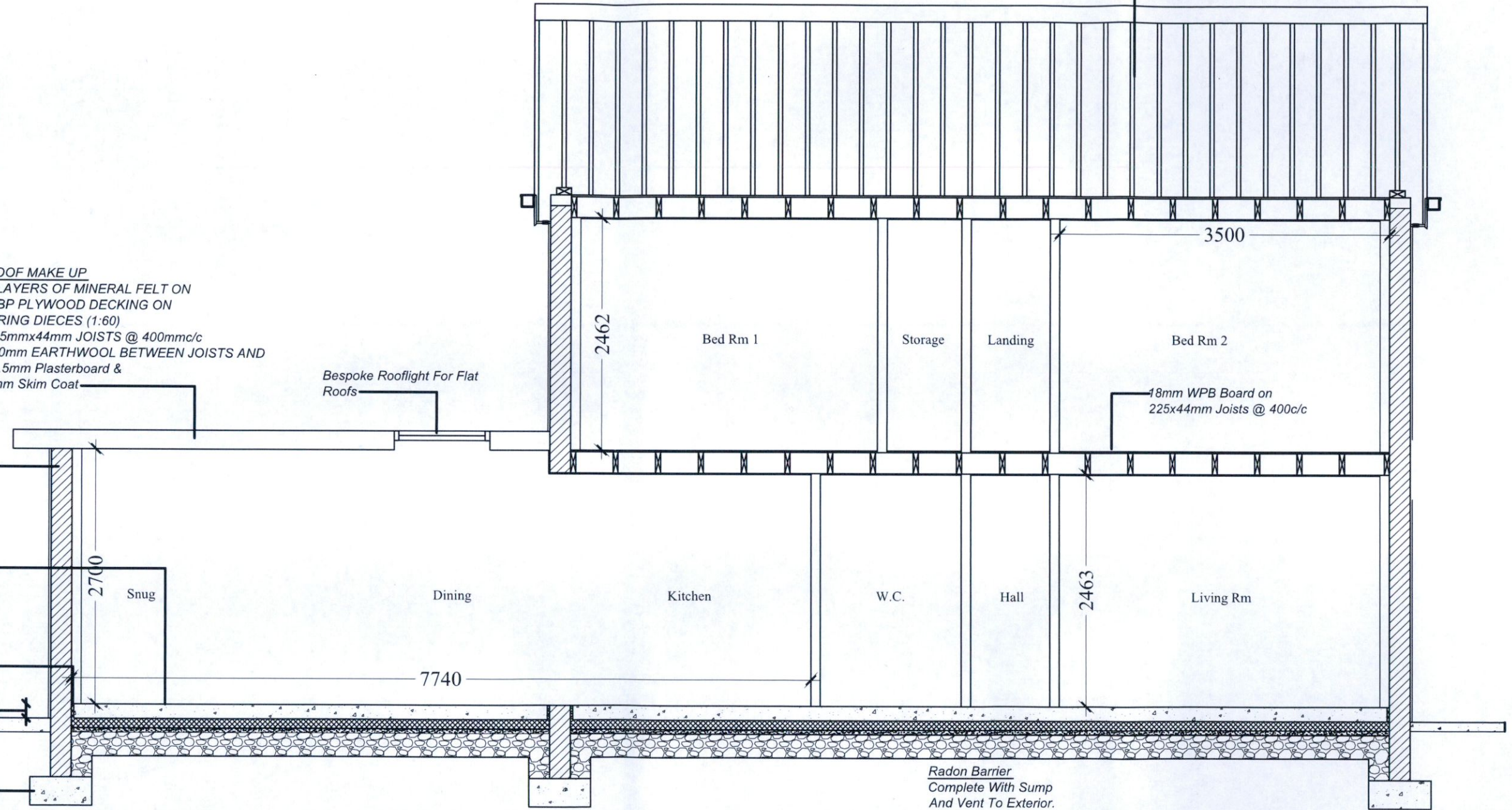

PL1	Issued For Planning	JW	JW	Apr 2022
REV:	REVISION TITLE:	DRN:	CHD:	DATE:

APPLICANT:  
**Deborah Soave**

JOB TITLE:  
 Proposed Two Storey Detached House At,  
 67 Coolamber Park,  
 Knocklyon,  
 Dublin 16.

Jason Walsh  
 Architectural & Engineering  
 12 ARD MOR crescent  
 TALLAGHT  
 Dublin 24  
 Phone: 085 8070 432  
 EMAIL: [gjl.servives@gmail.com](mailto:gjl.servives@gmail.com)

DRAWING TITLE:  
 Proposed Section

SCALE: 1:50	INITIALS: JW	DATE: 04.04.22
JOB No: DS-22	DRAWING No: DS-22-12	REV: PL1

THIS DRAWING IS ISSUED FOR CLARIFICATION OF  
 ADDITIONAL INFORMATION

ALL BUILDING WORK TO BE CARRIED OUT  
 IN ACCORDANCE WITH ENGINEERS DETAILS  
 & CURRENT BUILDING REGULATIONS

CONTRACTORS MUST VERIFY ALL DIMENSIONS  
 ON SITE BEFORE COMMENCING ANY WORK.  
 NO WORKING DIMENSIONS TO BE SCALED.  
 DIMENSIONS TO BLOCKWORK ONLY.  
 THIS DRAWING AND DESIGN IS COPYRIGHT AND  
 IS THE PROPERTY OF JASON WALSH.