

EXISTING LEVELS 99.10

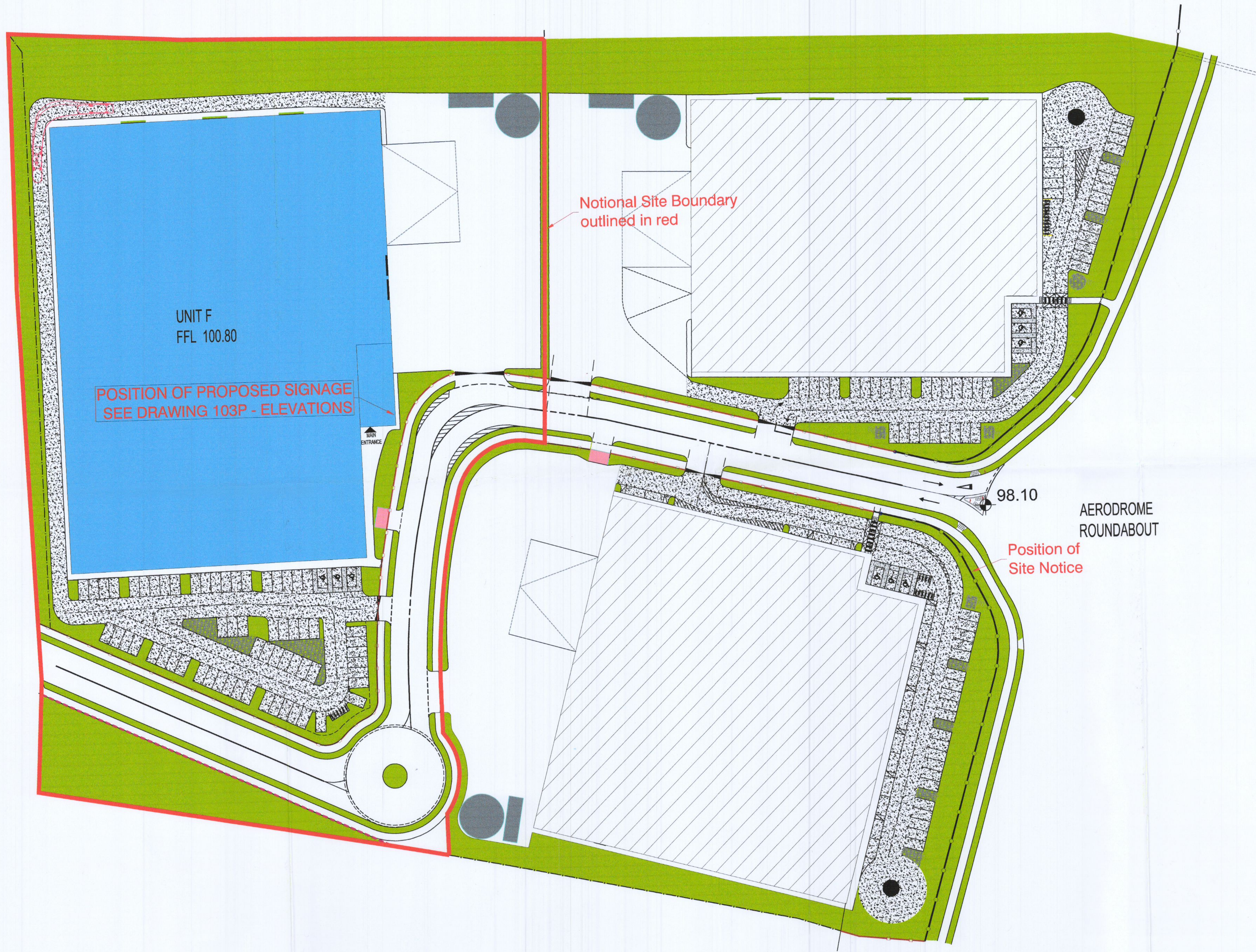

**PLANNING**  
07.12.2022

**Wynne Civil Engineering Ltd.**  
Consulting Engineers  
Greenhills, Kill, Co. Kildare  
T: +353 (0)86 2735148  
e: Eoin@wynneconsulting.ie

CLIENT NAME	ALDAR TISSUES Ltd.	JOB NAME	New Signage at Unit F, Greenogue Logistics Park, Newcastle Road, Rathcoole, Co. Dublin								
DRAWING NAME	Site Layout Plan										
DRAWING No.	102P	REVISION		SHEET SIZE	A1	SCALE	1:500	DATE	Dec 2022	DRAWN BY	EW