

DATE: 28 November 2022  
DESIGNER: Alex Naper  
PROJECT No: SES 15522 Rev B  
PROJECT NAME: Clonburris T3 - Cairn Homes Properties Ltd.



Residential area designed in accordance with EN13201-2:2015 Category P4.

Residential access road designed in accordance with EN13201-2:2015 Category P3.

Junction area meets recommendations of EN13201-2:2015 Category C4.

Rev A: Updated site layout.  
Rev B: Updated site layout.

## **Outdoor Lighting Report**

PREPARED BY: Sabre Electrical Services Ltd.  
Unit 11,  
Bellview Industrial Estate,  
Tolka Valley Road,  
Dublin 11  
Phone Number: 01 8110875  
Contact: Graham Sheehan  
eMail: graham@sabrelighting.ie

## Layout Report

### General Data

Dimensions in Metres Angles in Degrees

### Calculation Grids

ID	Grid Name	X	Y	X' Length	Y' Length	X' Spacing	Y' Spacing
1	Grid 1	705545.95	732495.90	309.78	190.00	1.50	1.50
2	Grid 2	705561.77	732499.67	304.00	57.00	1.50	1.50
3	Grid 3	705522.27	732510.82	42.00	48.00	1.50	1.50

### Luminaires

#### Luminaire A Data

Supplier	C U Phosco
Type	E950-28-P6A-740-SE0575-25W
Lamp(s)	740SA
Lamp Flux (klm)	3.64
File Name	E950-28-P6A-740-SE0575-25W.ies
Maintenance Factor	0.85
Imax70,80,90(cd/klm)	803.0, 171.3, 0.0
No. in Project	6

#### Luminaire B Data

Supplier	C U Phosco
Type	E950-28-F2A-740-SE0575-25W
Lamp(s)	740SA
Lamp Flux (klm)	3.90
File Name	E950-28-F2A-740-SE0575-25W.ies
Maintenance Factor	0.85
Imax70,80,90(cd/klm)	440.1, 52.4, 4.0
No. in Project	4

#### Luminaire C Data

Supplier	Urbis Schreder
Type	AXIA 3.3 5294 Integrated lenses 64 OSLO N SQUARE GIANT@300mA
Lamp(s)	64 OSLO N SQUARE GIANT@300mA NW 740 230V
LampFlux(klm)/Colour	9.08 NW 4000K/70
File Name	AXIA 3.3 5294 64 OSLO N SQUARE GIANT 300mA NW 740 56.5W 441012 Integrated ...
Maintenance Factor	0.87
Imax70,80,90(cd/klm)	613.3, 21.0, 0.0
No. in Project	2



#### Luminaire D Data

Supplier	C U Phosco
Type	E950-28-P4A-740-C350-10W
Lamp(s)	740N
Lamp Flux (klm)	1.32
File Name	E950-28-P4A-740-C0350-10W.ies
Maintenance Factor	0.85
Imax70,80,90(cd/klm)	659.3, 183.1, 0.3
No. in Project	15

#### Luminaire E Data

Supplier	C U Phosco
Type	E950-28-P4A-740-C600-16W
Lamp(s)	740N
Lamp Flux (klm)	2.17
File Name	E950-28-P4A-740-C0600-16W.ies
Maintenance Factor	0.85
Imax70,80,90(cd/klm)	659.3, 183.1, 0.3
No. in Project	27

#### Luminaire F Data

Supplier	C U Phosco
Type	E950-28-F2A-740-C600-16W
Lamp(s)	740N
Lamp Flux (klm)	2.21
File Name	E950-28-F2A-740-C0600-16W.ies
Maintenance Factor	0.85
Imax70,80,90(cd/klm)	623.6, 113.9, 0.3
No. in Project	3

**Layout**

ID	Type	X	Y	Height	Angle	Tilt	Cant	Out-reach	Target X	Target Y	Target Z
1	C	705544.83	732539.06	8.00	358.00	5.00	0.00	1.00			
2	C	705544.92	732506.63	8.00	0.00	5.00	0.00	1.00			
3	A	705569.70	732536.13	6.00	270.00	0.00	0.00	0.40			
4	A	705597.53	732535.01	6.00	266.00	0.00	0.00	0.40			
5	A	705629.18	732534.95	6.00	266.00	0.00	0.00	0.40			
6	E	705614.27	732541.13	6.00	352.00	0.00	0.00	0.40			
7	A	705665.05	732533.82	6.00	266.00	0.00	0.00	0.40			
8	A	705704.89	732530.09	6.00	266.00	0.00	0.00	0.40			
9	A	705738.31	732528.85	6.00	266.00	0.00	0.00	0.40			
10	B	705767.10	732533.14	6.00	266.00	0.00	0.00	0.40			
11	B	705786.59	732532.43	6.00	270.00	0.00	0.00	0.40			
12	B	705812.90	732531.84	6.00	262.00	0.00	0.00	0.40			
13	D	705704.85	732530.27	6.00	91.00	0.00	0.00	0.40			
14	D	705738.31	732529.12	6.00	89.00	0.00	0.00	0.40			
15	B	705839.80	732528.78	6.00	263.00	0.00	0.00	0.40			
16	E	705687.79	732546.22	6.00	350.00	0.00	0.00	0.40			
17	E	705700.09	732569.72	6.00	183.00	0.00	0.00	0.40			
18	D	705681.84	732573.69	6.00	354.00	0.00	0.00	0.40			
19	E	705701.06	732589.33	6.00	176.00	0.00	0.00	0.40			
20	D	705682.71	732592.76	6.00	354.00	0.00	0.00	0.40			
21	E	705699.29	732616.59	6.00	177.00	0.00	0.00	0.40			
22	E	705629.76	732559.91	6.00	174.00	0.00	0.00	0.40			
23	E	705615.61	732575.71	6.00	347.00	0.00	0.00	0.40			
24	E	705631.46	732602.50	6.00	187.00	0.00	0.00	0.40			
25	E	705616.99	732606.99	6.00	353.00	0.00	0.00	0.40			
26	E	705632.50	732625.57	6.00	177.00	0.00	0.00	0.40			
27	D	705565.63	732554.19	6.00	172.00	0.00	0.00	0.40			
28	D	705566.07	732554.16	6.00	356.00	0.00	0.00	0.40			
29	F	705575.52	732577.77	6.00	178.00	0.00	0.00	0.40			
30	F	705576.17	732602.41	6.00	178.00	0.00	0.00	0.40			
31	F	705577.08	732625.32	6.00	178.00	0.00	0.00	0.40			
32	E	705591.03	732627.88	6.00	84.00	0.00	0.00	0.40			
33	E	705617.79	732626.56	6.00	84.00	0.00	0.00	0.40			
34	E	705649.16	732638.71	6.00	267.00	0.00	0.00	0.40			
35	E	705679.92	732637.16	6.00	269.00	0.00	0.00	0.40			
36	E	705708.70	732635.69	6.00	264.00	0.00	0.00	0.40			

**Layout Continued**

ID	Type	X	Y	Height	Angle	Tilt	Cant	Out-reach	Target X	Target Y	Target Z
37	E	705743.33	732633.96	6.00	270.00	0.00	0.00	0.40			
38	E	705771.63	732632.37	6.00	269.00	0.00	0.00	0.40			
39	E	705802.67	732630.73	6.00	269.00	0.00	0.00	0.40			
40	E	705821.58	732617.09	6.00	355.00	0.00	0.00	0.40			
41	E	705820.75	732594.39	6.00	353.00	0.00	0.00	0.40			
42	E	705819.44	732564.69	6.00	356.00	0.00	0.00	0.40			
43	E	705818.50	732539.45	6.00	357.00	0.00	0.00	0.40			
44	E	705753.39	732544.86	6.00	352.00	0.00	0.00	0.40			
45	E	705768.22	732559.41	6.00	174.00	0.00	0.00	0.40			
46	E	705754.50	732574.10	6.00	358.00	0.00	0.00	0.40			
47	E	705769.25	732601.01	6.00	183.00	0.00	0.00	0.40			
48	E	705755.90	732616.62	6.00	347.00	0.00	0.00	0.40			
49	D	705578.18	732648.40	6.00	266.00	0.00	0.00	0.40			
50	D	705612.52	732645.40	6.00	266.00	0.00	0.00	0.40			
51	D	705649.18	732638.94	6.00	85.00	0.00	0.00	0.40			
52	D	705679.89	732637.33	6.00	85.00	0.00	0.00	0.40			
53	D	705708.74	732635.96	6.00	85.00	0.00	0.00	0.40			
54	D	705743.51	732634.04	6.00	85.00	0.00	0.00	0.40			
55	D	705771.71	732632.61	6.00	85.00	0.00	0.00	0.40			
56	D	705802.72	732631.06	6.00	85.00	0.00	0.00	0.40			
57	D	705572.75	732543.43	6.00	183.00	0.00	0.00	0.40			

## Horizontal Illuminance (lux)

Grid 1



### Results

Eav	5.45
Emin	1.07
E <sub>max</sub>	18.07
Emin/E <sub>max</sub>	0.06
Emin/Eav	0.20

## Horizontal Illuminance (lux)

Grid 2

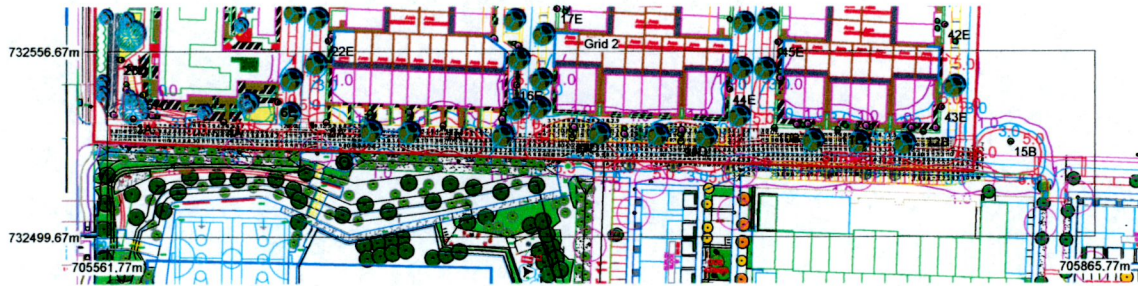

### Results

Eav	7.71
Emin	1.61
Emax	24.15
Emin/Emax	0.07
Emin/Eav	0.21

## Horizontal Illuminance (lux)

Grid 3

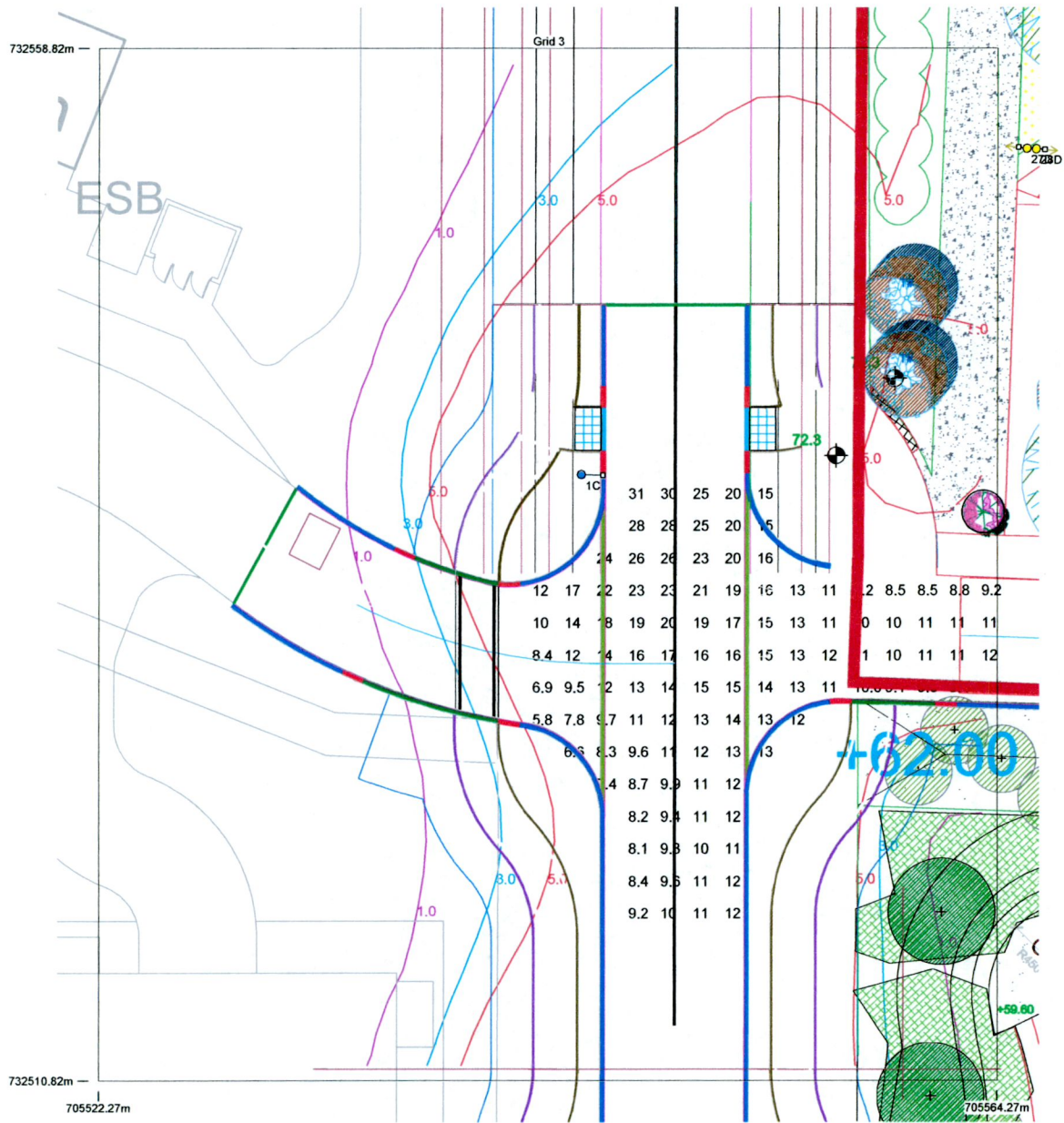

### Results

Eav	13.73
Emin	5.77
Emax	31.00
Emin/Emax	0.19
Emin/Eav	0.42