

# PROPOSED SITE LAYOUT

SCALE ~ 1:200  
Site Area (outlined in Red): 0.27 Ha. / 0.67 Acres

EXTENT OF SITE OUTLINED IN RED (extent of this application)

Location of Site Notice

Location of Site Notice

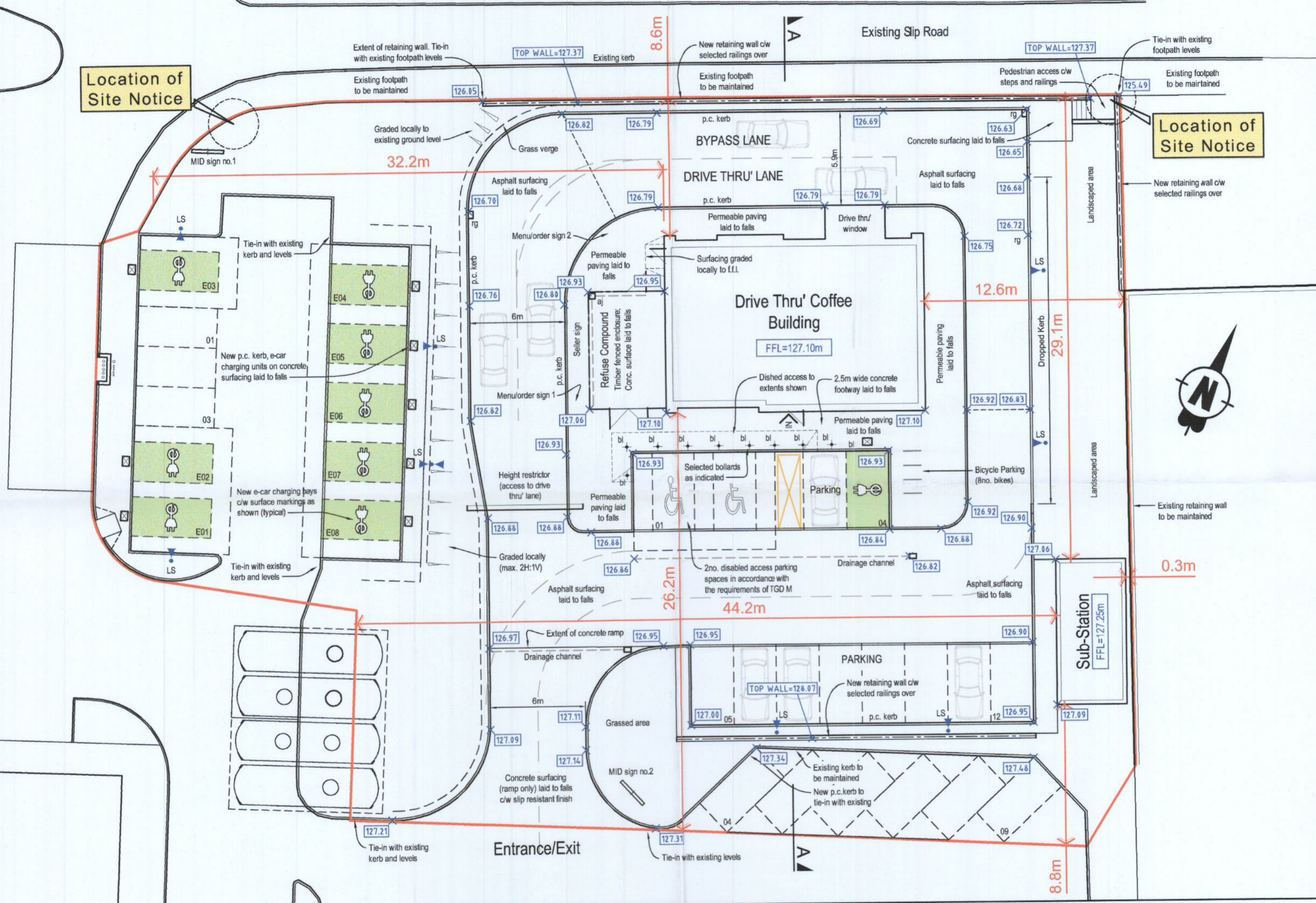

## GENERAL NOTES:

- Written dimensions take precedent over scaled dimensions
- All dimensions are in metres unless noted otherwise
- Any discrepancies found on this drawing should be immediately reported to the engineers
- This drawing is to be read in conjunction with all relevant engineers drawings, specifications and contract documents
- All works are to be in accordance with the relevant and current Health and Safety legislation
- Specification of the works to be to the appropriate Irish standard of the equivalent British standard

Proposed Finished Road Levels: 32.00

Refer to Survey drawing for existing levels & further details

LS New lighting standard

NOTE:  
New site lighting shall be hooded or cowled so as to prevent glare & intrusion on adjacent properties and shall be directed away from public roadway  
Lighting lux levels and lamp standard locations to be designed by others at construction stage and be subject to approval by the Local Authority.

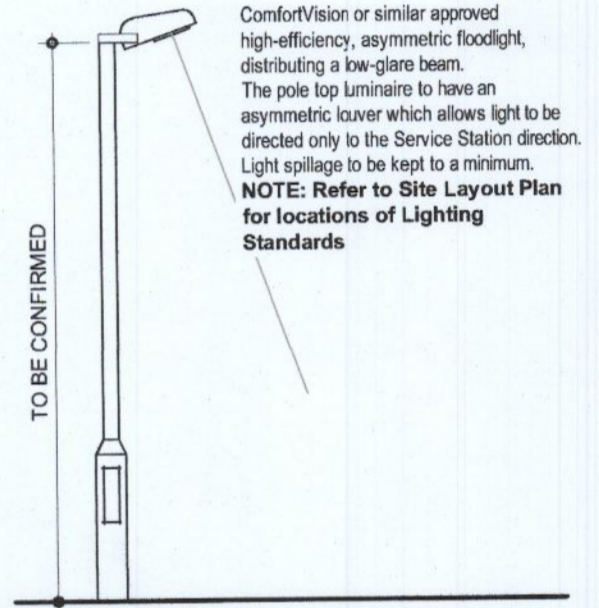

## TYPICAL LIGHTING STANDARD

SCALE: Not to Scale  
TYPICAL ARRANGEMENT FOR PROPOSED LIGHTING STANDARDS (to promote minimum back spill)

PARKING SCHEDULE		
TYPE	No.	Notes:
GENERAL (1)	9	Inside of Drive-thru' facility
DISABLED PARKING	2	Inside of Drive-thru' facility
GENERAL (2)	9	Outside of Drive-thru' facility
E-CHARGE	1	Inside of Drive-thru' facility
E-CHARGE	8	Outside of Drive-thru' facility

Rev	Drawn	Chkd	Appd	Description	Date
1	MN	AOD	JG	Further information issue	DEC.22
-	MN	AOD	JG	PLANNING APPLICATION ISSUE	MAR.22

## PLANNING APPLICATION PURPOSES ONLY

**JA Gorman**  
consulting engineers  
project managers

Forest Park,  
Mullingar, Co. Westmeath.  
Tel: 044-9347338 / 9347341  
Fax: 044-9347400  
Email: info@jagorman.ie  
Web: www.jagorman.ie

CLIENT: **PETROGAS GROUP LTD**

PROJECT TITLE:  
**Electric Vehicle fast-charging hub & Coffee Drive-thru Facility at Tootenhill, Rathcoole, Co.Dublin**

DRAWING TITLE:  
**PROPOSED SITE LAYOUT GENERAL ARRANGEMENT**

PLOT SIZE: A2	PLOT SCALE: 1:200	DRAWN BY: MN
PROJECT No: 3644	DRAWING No: P3644-C004	REV: 1

Copyright © J.A Gorman Consulting Engineers Ltd. Unauthorised reproduction prohibited.

