

# Planning Pack Map

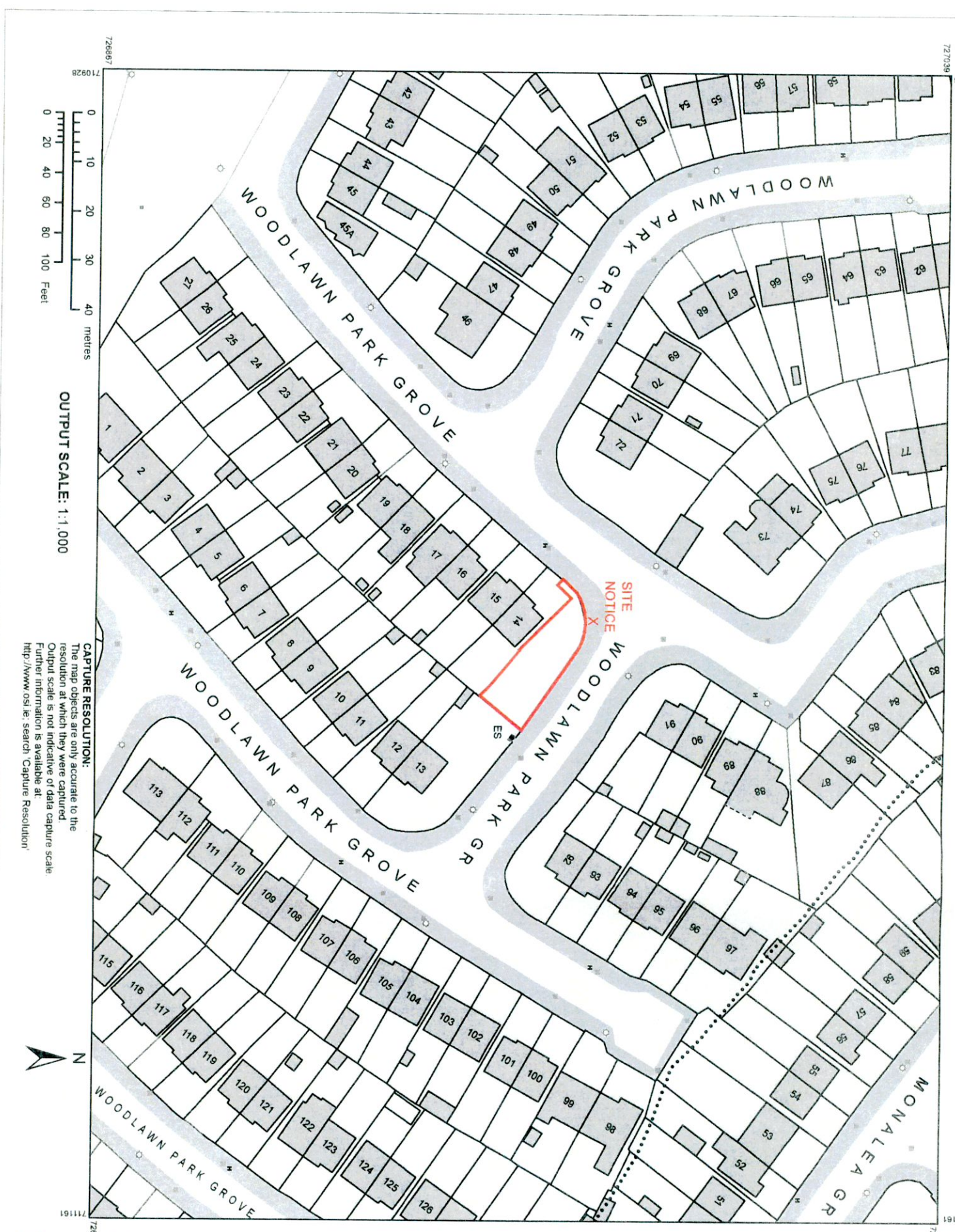

**CAPTURE RESOLUTION:**  
The map objects are only accurate to the resolution at which they were captured. Output scale is not indicative of data capture scale. Further information is available at: <http://www.osi.ie/search/CaptureResolution>



**CENTRE COORDINATES:**  
ITM 711045,726953

**PUBLISHED:** 19/11/2020  
**ORDER NO.:** 50156354\_1

**MAP SERIES:** 1:1,000  
**MAP SHEETS:** 3390-19, 3390-20

**COMPILED AND PUBLISHED BY:**  
Ordnance Survey Ireland,  
Phoenix Park,  
Dublin 8,  
Ireland.

Unauthorised reproduction infringes Ordnance Survey Ireland and Government of Ireland copyright.

All rights reserved. No part of this publication may be copied, reproduced or transmitted in any form or by any means without the prior written permission of the copyright owners.

The representation on this map of a road, track or footpath is not evidence of the existence of a right of way.

Ordnance Survey maps never show legal property boundaries, nor do they show ownership of physical features.

© Suirbhéireacht Ordánais Éireann, 2020  
© Ordnance Survey Ireland, 2020  
[www.osi.ie/copyright](http://www.osi.ie/copyright)

**LEGEND:**  
<http://www.osi.ie>  
search 'Large Scale Legend'

**Legend**  
— site boundary

THIS DRAWING IS COPYRIGHT  
REGISTERED DIMENSIONS TO BE USED IN ALL CASES.

NO.	REVISIONS

CLIENT: JOSEPH HAYDEN

14A WOODLAWN PARK GROVE  
FIRHOUSE  
D24 PXW6

TITLE: SITE LOCATION PLAN  
AMENDMENT TO PP. S0204/0299

DATE	BY	SCALE	AS INDIC.	CHECKED
11/11/22	SM	AS INDIC.	AS	

NO. 2011

2011-PL-100

**ROBIN MANDAL ARCHITECTS**

THE COURTYARD, 40 MAIN STREET  
BLACKROCK COUNTY DUBLIN

T: (01) 278 6164  
F: (01) 283 6923  
E: [architects@robinmandal.ie](mailto:architects@robinmandal.ie)

