

Tree Protection

- Existing Tree to be retained
 - Crown spread
 - Tree tag reference number
 - Colour coded tree stem
 - RPA, Root protection area
- Colour coding
- Category A: Trees of high quality
 - Category B: Trees of moderate quality
 - Category C: Trees of low quality
 - Category U: Trees unsuitable/unsafe for retention
- Existing Tree to be removed
 - Existing Vegetation retained
 - Existing Vegetation removed
 - Tree protection fence (Temporary during construction)
 - Area for cellular root protection system for tree retention

TREE PROTECTION FENCING - BS 5837 : 2012 TREES IN RELATION TO CONSTRUCTION
Item No. 11 Demolition and construction in proximity to existing trees

Panels, secured to uprights with wire ties and where necessary scaffold clamps

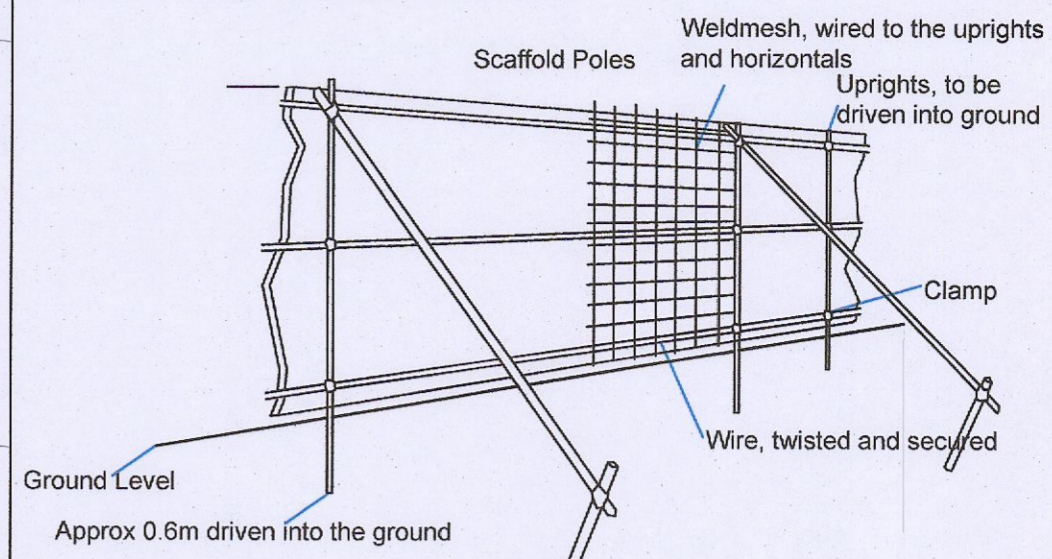

CD 02 Cellular confinement detail

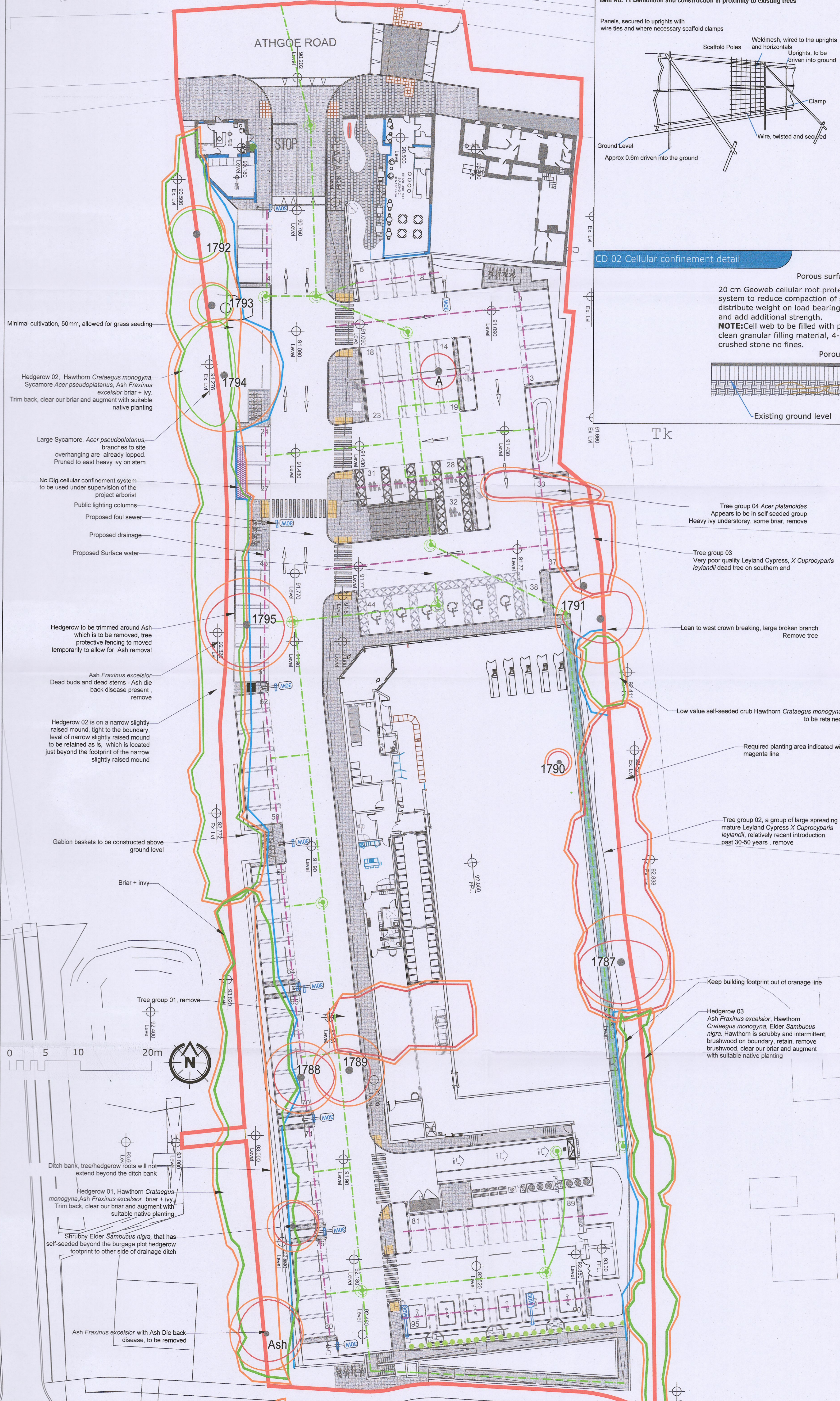
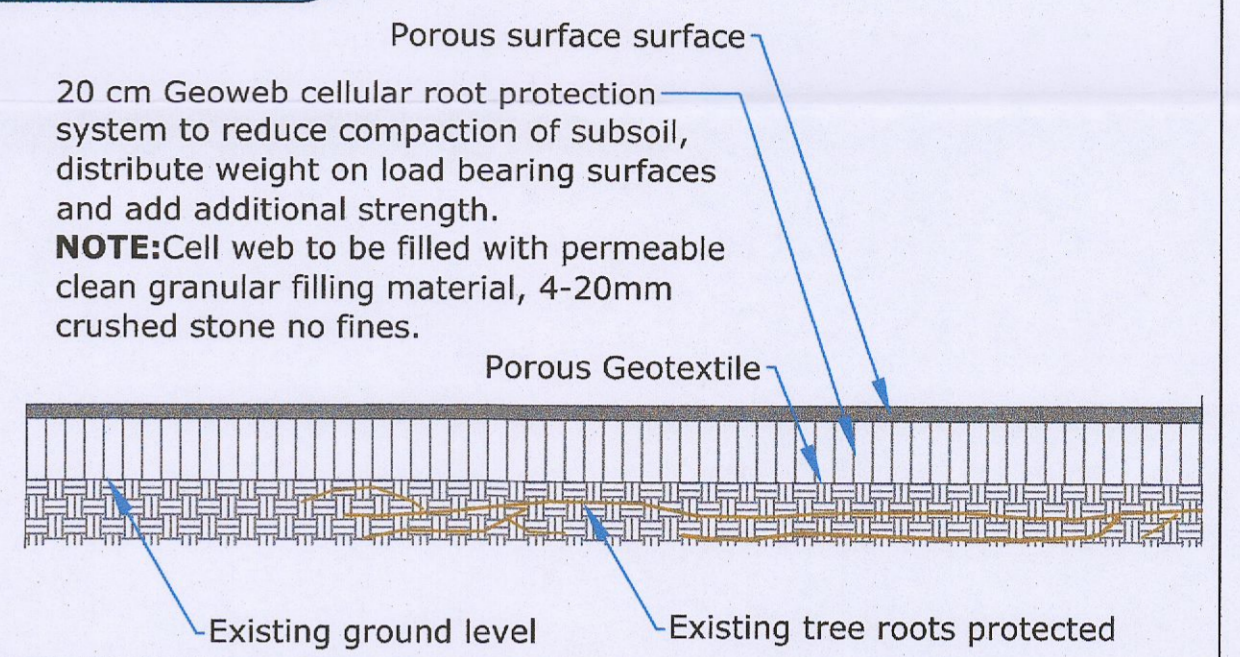

Tree group 04 *Acer platanoides*
Appears to be in self seeded group
Heavy ivy understorey, some briar, remove

Tree group 03
Very poor quality Leyland Cypress, *X Cuprocypris leylandii* dead tree on southern end

Lean to west crown breaking, large broken branch
Remove tree

Low value self-seeded crab Hawthorn *Crataegus monogyna*
to be retained

Tree group 02, a group of large spreading mature Leyland Cypress *X Cuprocypris leylandii*, relatively recent introduction, past 30-50 years, remove

Keep building footprint out of orange line

Hedgerow 03
Ash *Fraxinus excelsior*, Hawthorn *Crataegus monogyna*, Elder *Sambucus nigra*. Hawthorn is scrubby and intermittent, brushwood on boundary, retain, remove brushwood, clear our briar and augment with suitable native planting

Planning reference SD22A/0312
This arboricultural survey and plan has been completed by Eunan O'Donnell BSc Ag, Dip Hort, Arb cert, MILL, TechArborA

Rev	Date	By	Details
F	15/11/22	EOD	Scale bar and Northpoint
E	15/11/22	EOD	Update drain location
D	10/11/22	EOD	Update to latest layout
C	11/07/22	EOD	Update to latest layout
B	20/05/22	EOD	Update to latest layout
A	28/04/22	EOD	Tree Protection Plan

AUSTEN ASSOCIATES
Renshaw House, Ballygale Bog, Wicklow Town, Co. Wicklow, A67 X9R62
T: 0404 66827
Email: design@autenassociates.ie | Web: www.autenassociates.ie
landscape architecture design
arboriculture project management
Copyright Austen Associates, 2022

Client:	Lidl GmbH
Project title:	Lidl Newcastle
Drawing title:	Tree Protection Plan
Drawn by:	CD
Scale:	1:250 on A1
Approved by:	TA
Date:	March 2022
Status:	Planning
Drawing no:	077622_TP_01
Revision:	F