

REFER TO DRAWING 6902-JOD-004 FOR SECTION, ROAD AND FOOTPATH CONSTRUCTION DETAILS.

EXISTING SCHOOL ROAD MARKINGS ON KNOCKLYON ROAD TO FRONT OF SITE TO BE RETAINED

EXISTING SCHOOL ROAD MARKINGS ON KNOCKLYON ROAD TO FRONT OF SITE TO BE RETAINED

GENERAL NOTES:

1. FIGURED DIMENSIONS ONLY TO BE TAKEN FROM THIS DRAWING.
2. ALL DRAWINGS TO BE CHECKED BY THE CONTRACTOR ON SITE.
3. THE CONTRACTOR SHALL BE RESPONSIBLE FOR ANY DISCREPANCIES BEFORE ANY WORK COMMENCES.
4. THE CONTRACTOR SHALL UNDERTAKE A THOROUGH CHECK FOR THE GROUND BEFORE ANY WORK COMMENCES.
5. ALL LEVELS SHOWN RELATE TO ORDNANCE SURVEY DATUM AT MALIN.
6. THIS DRAWING IS TO BE READ IN CONJUNCTION WITH ALL OTHER RELEVANT DRAWINGS AND SPECIFICATIONS. CONTRACTOR TO VERIFY THE ACCURACY OF THIS PROPOSAL TO THE ENGINEER AND ALLOW FOR CORRECTIONS AS DEEMED NECESSARY WITH A REASONABLE TIMEFRAME.

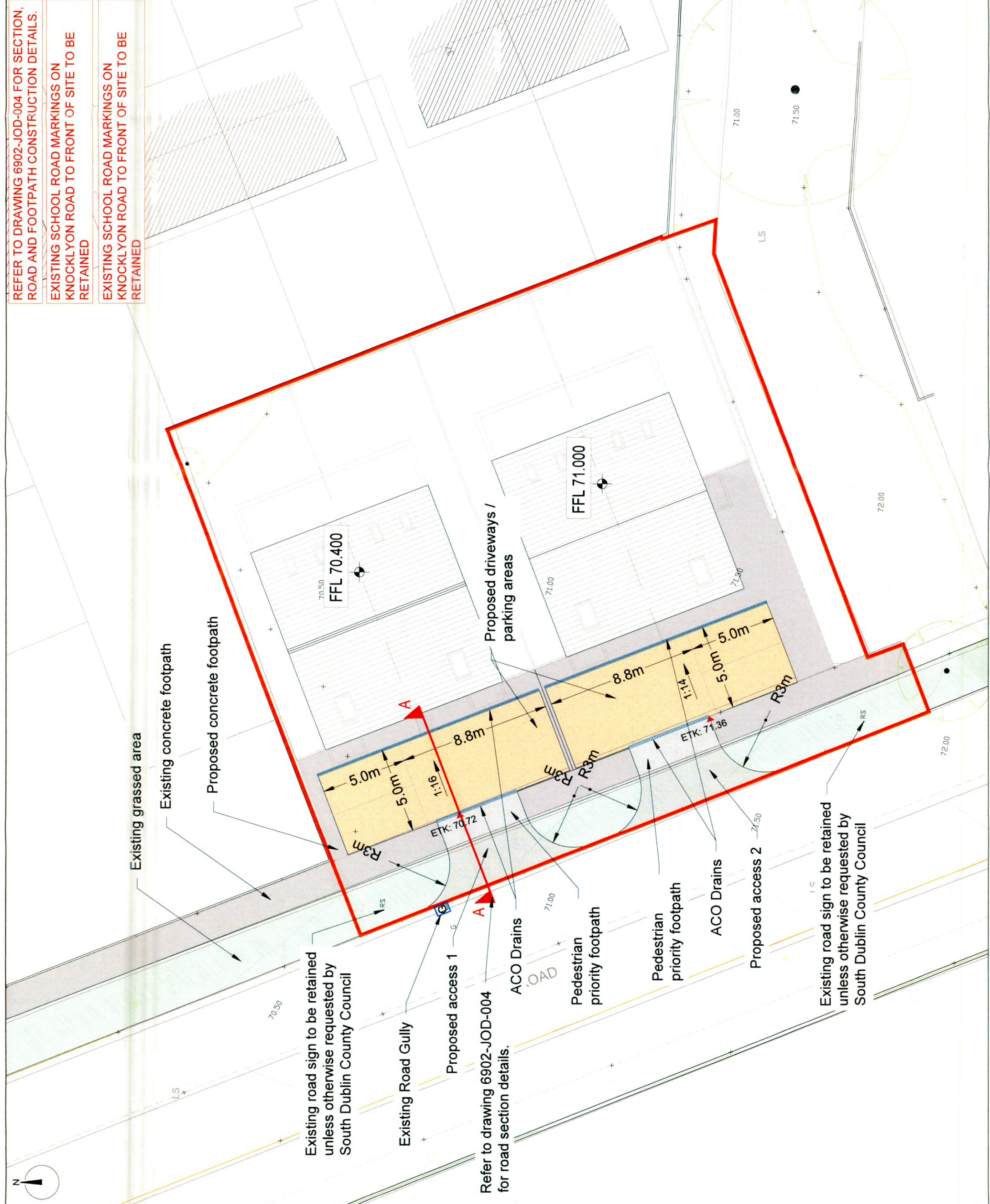

LEGEND

SITE BOUNDARY INDICATED THUS

NORTH SIGN INDICATED THUS

PROPOSED LEVELS

EXISTING LEVELS

40mm SMA SURF PBM 65/105-60 DES (COLOUR TO ARCHITECTS DETAIL) ON 80mm AC 32 DENSE BASE 40/80 DES ON 300mm SUB-BASE CLAUSE 804 COMPACTED TO CLAUSE 802 OF THE TII SPECIFICATION FOR ROAD WORKS

EXISTING FOOTPATH AREA TO BE REINSTATED AND RETAINED AS VEHICULAR ACCESS TO DWELLINGS

EXISTING GRASSED AREA TO BE REPLACED WITH ACCESS ROAD

EXISTING TOP OF KERB LEVEL TO BE RETAINED ETK: 70.72

GENERAL NOTES:

1. FIGURED DIMENSIONS ONLY TO BE TAKEN FROM THIS DRAWING.
2. ALL DRAWINGS TO BE CHECKED BY THE CONTRACTOR ON SITE.
3. THE CONTRACTOR SHALL BE RESPONSIBLE FOR ANY DISCREPANCIES BEFORE ANY WORK COMMENCES.
4. THE CONTRACTOR SHALL UNDERTAKE A THOROUGH CHECK FOR THE GROUND BEFORE ANY WORK COMMENCES.
5. ALL LEVELS SHOWN RELATE TO ORDNANCE SURVEY DATUM AT MALIN.
6. THIS DRAWING IS TO BE READ IN CONJUNCTION WITH ALL OTHER RELEVANT DRAWINGS AND SPECIFICATIONS. CONTRACTOR TO VERIFY THE ACCURACY OF THIS PROPOSAL TO THE ENGINEER AND ALLOW FOR CORRECTIONS AS DEEMED NECESSARY WITH A REASONABLE TIMEFRAME.

NOTES

Site Area:-
1056 m² 0.2609 Acres, 0.1056 Hectares
ITM Co-Ordinates of site:-
711636, 727432

Ordnance Survey Ireland Licence No. CYAL624498
© Ordnance Survey Ireland/Government of Ireland.
OS Sheet No.3390-15

Layout Ref.:
P.01 Planning Issue SL MF 26.10.22
rev. modifications by fchhd date

client
PATHWAY HOMES LTD.

project
PROPOSED RESIDENTIAL DEVELOPMENT AT SITE, KNOCKLYON ROAD, DUBLIN

stage
PLANNING

title
PROPOSED ROAD LAYOUT PLAN

scale
1:200 @ A3

surveyed SL MF checked MF date
drawn SL MF checked MF date
Oct 2022

© COPYRIGHT OF
JENNINGS O'DONOVAN & PARTNERS
CONSULTING ENGINEERS,
FINISKILIN,
SLIGO,
IRELAND.
TEL: +353 (0)71 916 1416
FAX: +353 (0)71 916 1080
Email: info@jodireland.com

drawing no. 6902-JOD-XX-ZZ-DR-C-002
revision P.01