

1. General

Stephen Reid Consulting Traffic & Transportation Limited (SRC) has been retained by Lidl Ireland GmbH (Lidl) to prepare this note in response to the traffic points in the Request for Further Information (RFI) issued by South Dublin County Council (SDCC) in respect of a planning application for proposed development at Main Street, Newcastle, Co Dublin by Lidl Ireland GmbH (SDCC ref.: SD22A/0312).

2. SDCC RFI Traffic Items and SRC Responses

Item 3 is as follows:

"3. The Applicant is requested to provide a revised Site Layout Plan demonstrating the following:

(i) The addition of a Toucan Crossing on Athgoe Road at the raised table ramp to improve access for vulnerable pedestrians at the proposed development.

(ii) The provision of space for additional bicycle parking should it become necessary to provide them.

SRC Response

Item 3(i) – Please find enclosed drawing SRC 214-100 which illustrates the general arrangement for a Toucan crossing on the proposed revised traffic calming ramp, to SDCC standard specifications.

Item 3(ii) -

The SRC TIA report submitted for planning noted as follows:

"The cycle parking standard in Table 13.24 of the Development Plan is a minimum of 1/5 staff for retail and café uses (long term, covered and secure from public access) plus 1/50 sq. m (short term) for retail uses, and 1/10 seats for café use.

Assuming 25 staff at Lidl and 8 staff in the 2 smaller units, this would equate to a requirement for 7 long stay spaces for staff and 45 (retail) + 3 (café) short stay spaces for customers.

It is considered that the short-stay provision would far exceed demands for the convenience retail element (Lidl) and therefore it is proposed to provide 32 spaces (in two groups of 16 spaces) using Sheffield stands located opposite the trolley bay (for cyclists accessing the site from the Main Street) and at the bottom of the ramp from the Cairn site (for cyclists accessing from the Cairn site internal network).

A further 8 spaces for staff cycle are proposed to be located on the perimeter of the car park to the south of the Kelly Estates building. These will be long stay use and therefore will be covered and secure."

It is considered that the proposal submitted for planning contains more than adequate cycle parking to accommodate the future needs of the development, as the peak hour traffic attraction is in the order of 100 vehicles, and it is highly unlikely there would ever be a scenario where 32 customers would arrive to this type of development in a single hour, let alone the development peak hour, due to the nature of many convenience retail trips where customers would carry out a weekly 'trolley' shop and it would be impractical for such a trip to be undertaken on a bicycle.

In the event of a significant surge in cycle travel to the development in the future (resulting in a demand for cycle parking greater than the 32 visitor spaces and 8 staff spaces proposed) it is noted that this would be due to a mode shift rather than an increased level of trips and there would be a consequent reduction in private car use. If that were to occur, it would be a practical solution to convert underutilised parking spaces into cycle parking to address any future shift in demands.

Stephen Reid Consulting Traffic and Transportation Limited

16.11.2022

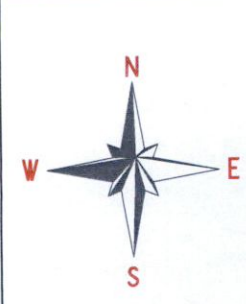
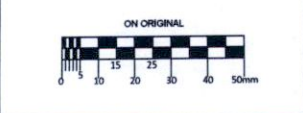

RIDGE
*98.129

TRAFFIC SIGNAL CONTROLLED
TOUCAN PEDESTRIAN & CYCLIST CROSSING
ON 100mm TRAFFIC & CYCLIST RAMP
FORMED IN PM SMA

APARTMENT

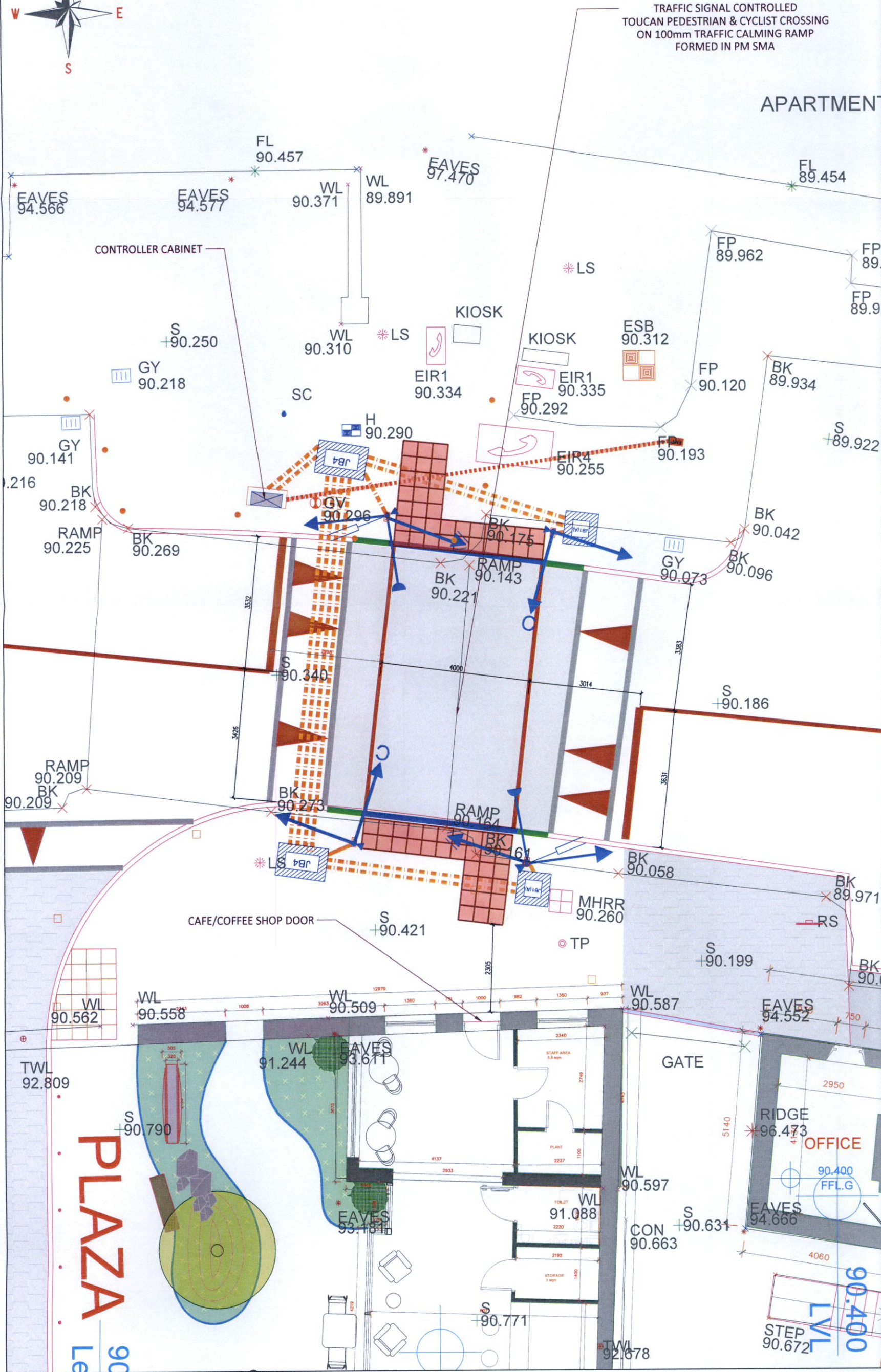

- NOTES**
1. SITE LAYOUT AND SURVEY SUPPLIED BY DARMODY ARCHITECTS
 2. ALL ROAD MARKINGS WHITE THERMOPLASTIC UNLESS OTHERWISE SPECIFIED, APPLIED ACCORDING TO TRAFFIC SIGNS MANUAL
 3. ALL ROAD MARKINGS AND SIGNAGE IN ACCORDANCE WITH TRAFFIC SIGNS MANUAL
 4. CONTRACTOR TO CHECK ALL MEASUREMENTS AND POSITIONS OF EXISTING FEATURES ON SITE AND ADVISE CERTIFYING ENGINEER AND DESIGNER OF ANY DISCREPANCIES
 5. NO WORKS ON THE PUBLIC ROAD, INCLUDING VERGES AND FOOTPATHS TO BE UNDERTAKEN WITHOUT ROAD OPENING LICENCE FROM SDCC IN COMPLIANCE WITH ALL PLANNING CONDITIONS AND/OR AS SET OUT IN R.O.I. CONDITIONS AND ALL REQUIRED TEMPORARY TRAFFIC MANAGEMENT MEASURES IN PLACE AND MAINTAINED AT ALL TIMES

- RED TACTILE 400x400x3mm PAVERS
 - INSTALLED 2 ROWS DEEP ACROSS FULL WIDTH OF CROSSING WITH 3 ROWS WIDE STEM EXTENDING TO BACK OF FOOTPATH
 - DROPPED KERB TO HAVE A 6mm MAX BEVEL AND EXTEND 100mm BEYOND 4.0m TACTILE WIDTH
 - 1.0m TRANSITION KERB FROM DROPPED KERB TO FULL HEIGHT KERBS
 - NEW ROAD MARKINGS TO BE INSTALLED FOR PROPOSED CROSSINGS PER TSM REQUIREMENTS
 - RTS001 PRIMARY SIGNAL HEAD (RAG)
 - RTS001 SECONDARY SIGNAL HEAD (RAG)
 - RPC04 PEDESTRIAN SIGNAL (RmAmGm)
 - PEDESTRIAN DEMAND UNIT
 - HEMIDALL VEHICLE DETECTOR
 - SIEMENS TRAFFIC SIGNALS CONTROLLER UNIT ON CONCRETE PLINTH
 - IBA COLLECTOR CHAMBER (TRAFFIC)
 - IB1(A) TRAFFIC CHAMBER
 - 110mm MDPE ORANGE DUCTING STAMPED "TRAFFIC"
- note:
 4ND: AT ROAD CROSSINGS (750mm MIN COVER UNDER ROADS)
 2ND: CONNECTING TO TRAFFIC CHAMBERS (450mm MIN COVER UNDER FOOTPATHS)
 1ND: CONNECTING TO RSL15 POLE RETENTION SOCKETS (450mm MIN COVER UNDER FOOTPATHS)
- Note: 230v AC Single Phase Traffic Signals Power Supply Connection to ESRN to be confirmed on-site and subject to unmettered supply application



LEGEND

Symbol	Description
Red dot	RTS001 PRIMARY SIGNAL HEAD (RAG)
Blue dot	RTS001 SECONDARY SIGNAL HEAD (RAG)
Green dot	RPC04 PEDESTRIAN SIGNAL (RmAmGm)
Yellow dot	PEDESTRIAN DEMAND UNIT
Orange dot	HEMIDALL VEHICLE DETECTOR
Purple dot	SIEMENS TRAFFIC SIGNALS CONTROLLER UNIT ON CONCRETE PLINTH
Light blue dot	IBA COLLECTOR CHAMBER (TRAFFIC)
Dark blue dot	IB1(A) TRAFFIC CHAMBER
Red dashed line	110mm MDPE ORANGE DUCTING STAMPED "TRAFFIC"
Blue dashed line	4ND: AT ROAD CROSSINGS (750mm MIN COVER UNDER ROADS)
Green dashed line	2ND: CONNECTING TO TRAFFIC CHAMBERS (450mm MIN COVER UNDER FOOTPATHS)
Yellow dashed line	1ND: CONNECTING TO RSL15 POLE RETENTION SOCKETS (450mm MIN COVER UNDER FOOTPATHS)
Red solid line	RTS001 PRIMARY SIGNAL HEAD (RAG)
Blue solid line	RTS001 SECONDARY SIGNAL HEAD (RAG)
Green solid line	RPC04 PEDESTRIAN SIGNAL (RmAmGm)
Yellow solid line	PEDESTRIAN DEMAND UNIT
Orange solid line	HEMIDALL VEHICLE DETECTOR
Purple solid line	SIEMENS TRAFFIC SIGNALS CONTROLLER UNIT ON CONCRETE PLINTH
Light blue solid line	IBA COLLECTOR CHAMBER (TRAFFIC)
Dark blue solid line	IB1(A) TRAFFIC CHAMBER
Red solid line	110mm MDPE ORANGE DUCTING STAMPED "TRAFFIC"
Blue solid line	4ND: AT ROAD CROSSINGS (750mm MIN COVER UNDER ROADS)
Green solid line	2ND: CONNECTING TO TRAFFIC CHAMBERS (450mm MIN COVER UNDER FOOTPATHS)
Yellow solid line	1ND: CONNECTING TO RSL15 POLE RETENTION SOCKETS (450mm MIN COVER UNDER FOOTPATHS)

REV.	DATE	DESCRIPTION	BY	CHKD.
1				

Stephen Reid Consulting Traffic and Transportation
 Estuary House, New Street, Malahide, Co Dublin T15H 9F92
 Tel: 01 879 9079

www.stephenreidconsulting.com
 Stephen Reid Consulting
 Traffic and Transportation

PROJECT NAME
 MIXED DEVELOPMENT
 MAIN STREET, NEWCASTLE
 CO DUBLIN
 (REF: SD22A/0312)

CLIENT
 LIDL IRELAND GmbH

DRAWING
 PROPOSED TOUCAN CROSSING
 AT RAMP ON R405 ATHGOE ROAD
 (RESPONSE TO ITEM 31 OF RFI)

DRG. NO.
 SRC-214-100

DESIGNED	SR	CAD	CP
DATE	OCT 2022	CHECKED	SR

RFI RESPONSE

SCALE 1:100@A3; 1:50 @A1 FILE REF. SRC-214-100