

### E.Planting Area 5

Scale (1:150)



- Ligustrum vulgare x 45no.
- S2 x 120no. & S5 x 60no., Gc2 x 32no.
- S3 x 15no.
- S2 x 12no.
- Ligustrum vulgare x 19no.
- S3 x 45no. & S4 x 15no., Gc1 x 28no.
- S2 x 36no.
- S2 x 60no, S3 x 60no., & S5 x 60no., Gc3 x 26no.
- Ligustrum vulgare x 20no.
- S6 x 25no.
- S1 x 30no.
- Ligustrum vulgare x 12no.
- S2 x 40no & S5 x 30no., Gc2 x 20no.
- S3 x 24no. & S4 x 12no., Gc1 x 26no.
- S1 x 60no, S4 x 30no., & S6 x 50no., Gc1 x 49no.

### F.Planting Area 6

Scale (1:150)

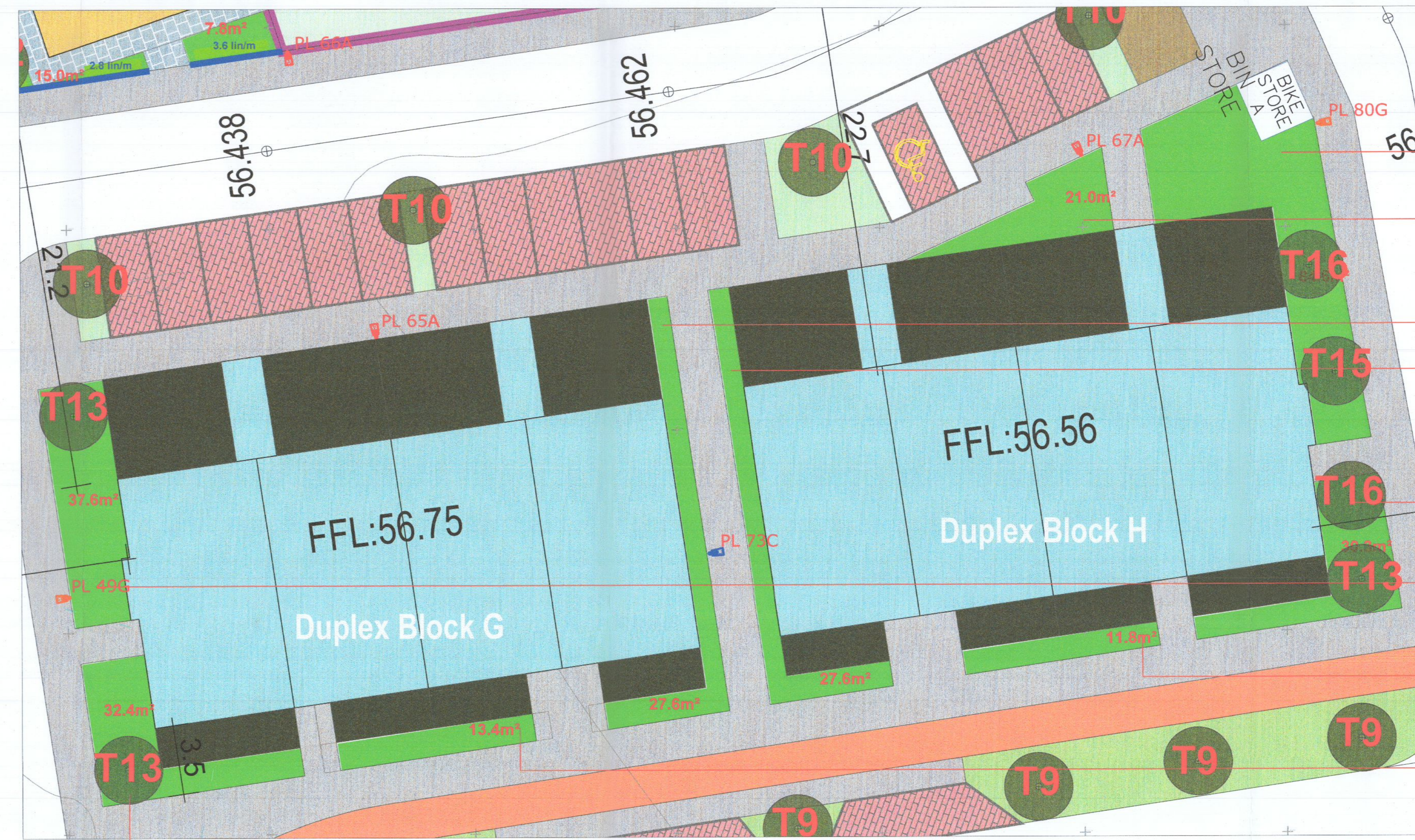

- S2 x 80no, S3 x 120no., & S5 x 60no., Gc3 x 23no.
- S2 x 40no & S5 x 15no., Gc2 x 30no.
- S2 x 80no. & Gc1 x 38no.
- S2 x 80no. & Gc1 x 38no.
- S1 x 45no & S4 x 30no., Gc1 x 27no.
- S2 x 20no, S3 x 60no., & S5 x 15no., Gc3 x 38no.
- S5 x 30no. & Gc3 x 9no.
- S5 x 30no. & Gc3 x 17no.
- S1 x 45no & S4 x 15no., Gc1 x 19no.

### F.Planting Area 6 cont.

Scale (1:150)

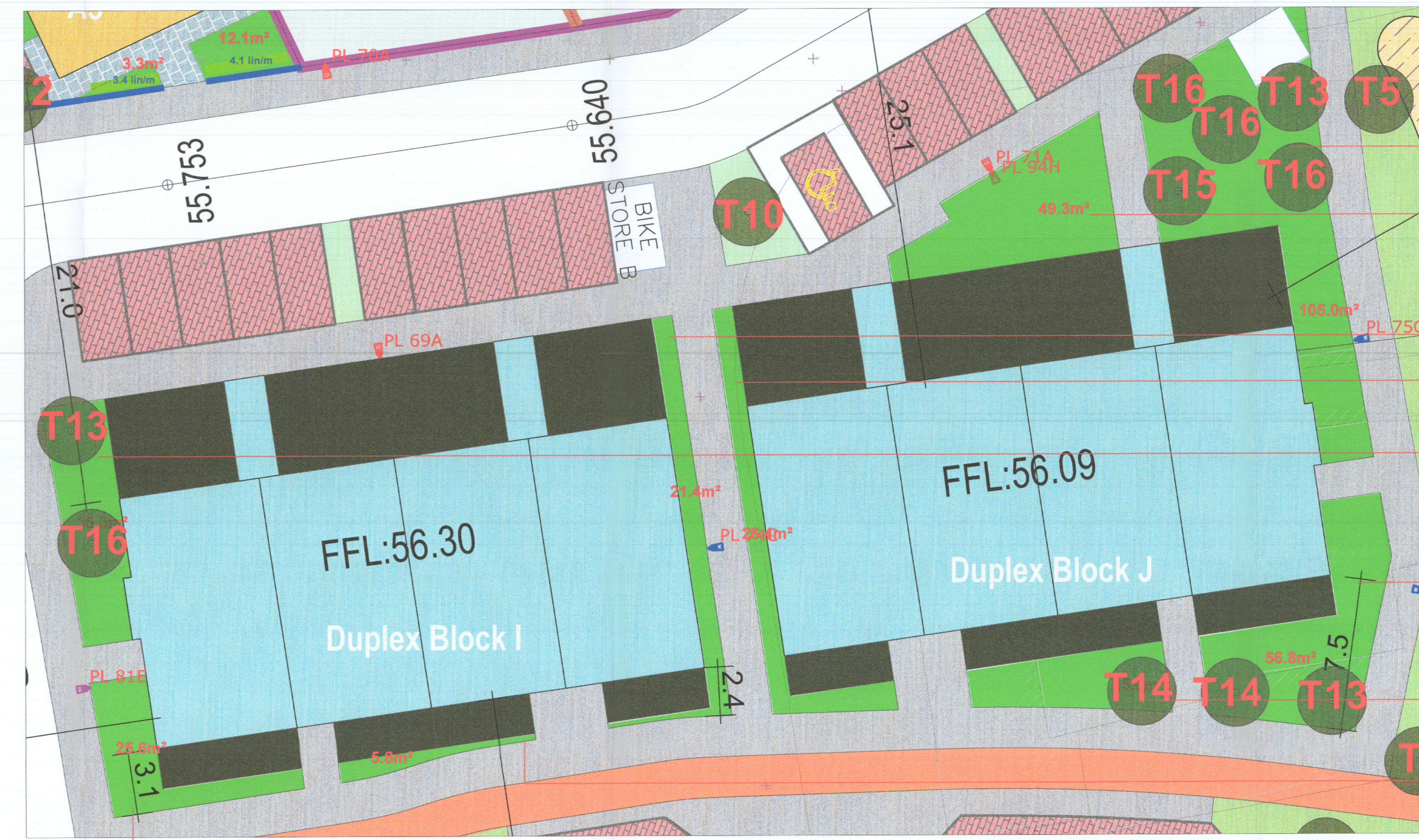

- S2 x 80no, S3 x 120no., & S5 x 60no., Gc3 x 23no.
- S2 x 40no, S3 x 60no., & S5 x 15no., Gc2 x 47no.
- S2 x 60no. & Gc1 x 30no.
- S2 x 80no. & Gc1 x 32no.
- S2 x 20no, S3 x 60no., & S5 x 15no., Gc3 x 27no.
- S1 x 90no, S4 x 30no., S6 x 50no. & Gc1 x 34no.
- S3 x 45no, S5 x 15no. & Gc3 x 30no.
- S5 x 17no.
- S1 x 45no & S4 x 15no., Gc1 x 28no.

### Location Plan



Proposed Shrub Planting - 2601.4 sq.m				
Code	Species Name	Specification	Plant/m2	No.
P.o.	<i>Prunus</i> 'Otto Luyken'	c/g 3L 30-40cm ht.	3m²	1055
L.a.	<i>Lavandula angustifolia</i>	c/g 3L 30-40cm ht.	4m²	2691
L.g.	<i>Libertia grandiflora</i>	c/g 3L 30-40cm ht.	3m²	1560
C.c.	<i>Cistus corbariensis</i>	c/g 3L 30-40cm ht.	3m²	354
S.c.	<i>Sarcococca confusa</i>	c/g 3L 30-40cm ht.	3m²	1360
A.s.	<i>Asterella</i> 'Silver Spear'	c/g 2L 30-40cm ht.	5m²	634
S.s.	<i>Sedum spectabile</i>	c/g 2L 30-40cm ht.	5m²	154

Proposed Ground Cover Planting				
Code	Species Name	Specification	Plant/m2	No.
B.c.	<i>Bergenia cordifolia</i>	c/g 2L 30-40cm ht.	5m²	721
P.a.	<i>Panicum affinis</i>	c/g 2L 30-40cm ht.	5m²	517
H.n.	<i>Helleborus niger</i>	c/g 2L 30-40cm ht.	5m²	402

	<b>H1 - Native Hedgerow</b> (450mm topsoil depth / 100cm double row)
	Species Name
	<i>Craetagus monogyna, Ilex aquifolium, Corylus avellana, Viburnum opulus</i>
	- approx. 933.3 lin/m
	<b>H2 - Evergreen hedgerow</b> (450mm topsoil depth / 100cm single row)
	<i>Ligustrum vulgare</i> - approx. 612.3 lin/m

REV	DATE	BY	CHECKED	DESCRIPTION

Project Title: Clonburris SDZ at Dublin 22

Client: Kelland Homes      Dwg No. 06 LPP

Drawing Title: Landscape Planting Plan (N)      Scale: Varies

Job No: 1577      Date: 12/11/2020

**Ronan MacDiarmada + Associates Ltd.**  
Landscape Architects and Consultants.

5 Tooterhill, Rathcoole, Co. Dublin  
tel: +353 1 412 4478    mob: 086 26 25 438  
fax: +353 1 401 3748    e-mail: ronan@rmda.ie

This Drawing is Copyright