

G.Planting Area 7 Scale (1:150)

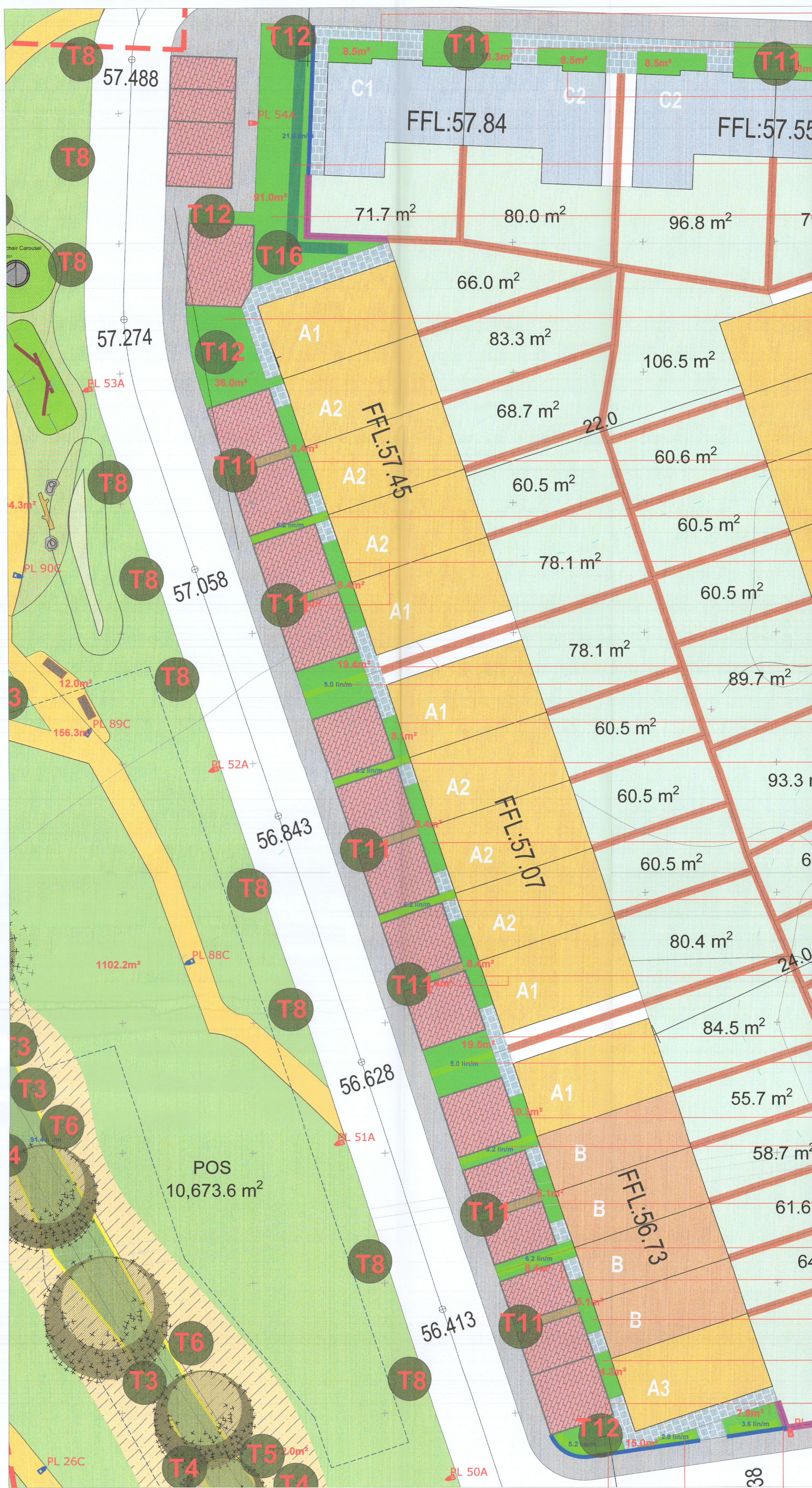

- S2 x 34no.
- S3 x 40no.
- S2 x 34no.
- Native Hedge x 63no.
- S1 x 120no S5 x 60no. & S6 x 30no., Gc1 x 105no.
- S2 x 40no & S3 x 60no., Gc3 x 30no.
- S2 x 34no.
- Ligustrum vulgare x 19no.
- S3 x 32no.
- S5 x 29no & S6 x 29no. Ligustrum vulgare x 15no.
- S2 x 20no.
- Ligustrum vulgare x 19no.
- S2 x 34no.
- Ligustrum vulgare x 19no.
- S3 x 32no.
- S5 x 29no & S6 x 29no. Ligustrum vulgare x 15no.
- S2 x 41no.
- Ligustrum vulgare x 19no.
- S7 x 26no.
- Ligustrum vulgare x 15no.
- S6 x 42no.
- S1 x 15no.
- S2 x 9no.
- S1 x 69no.
- Ligustrum vulgare x 11no.
- Ligustrum vulgare x 8no.

D.Planting Area 7 cont. Scale (1:150)

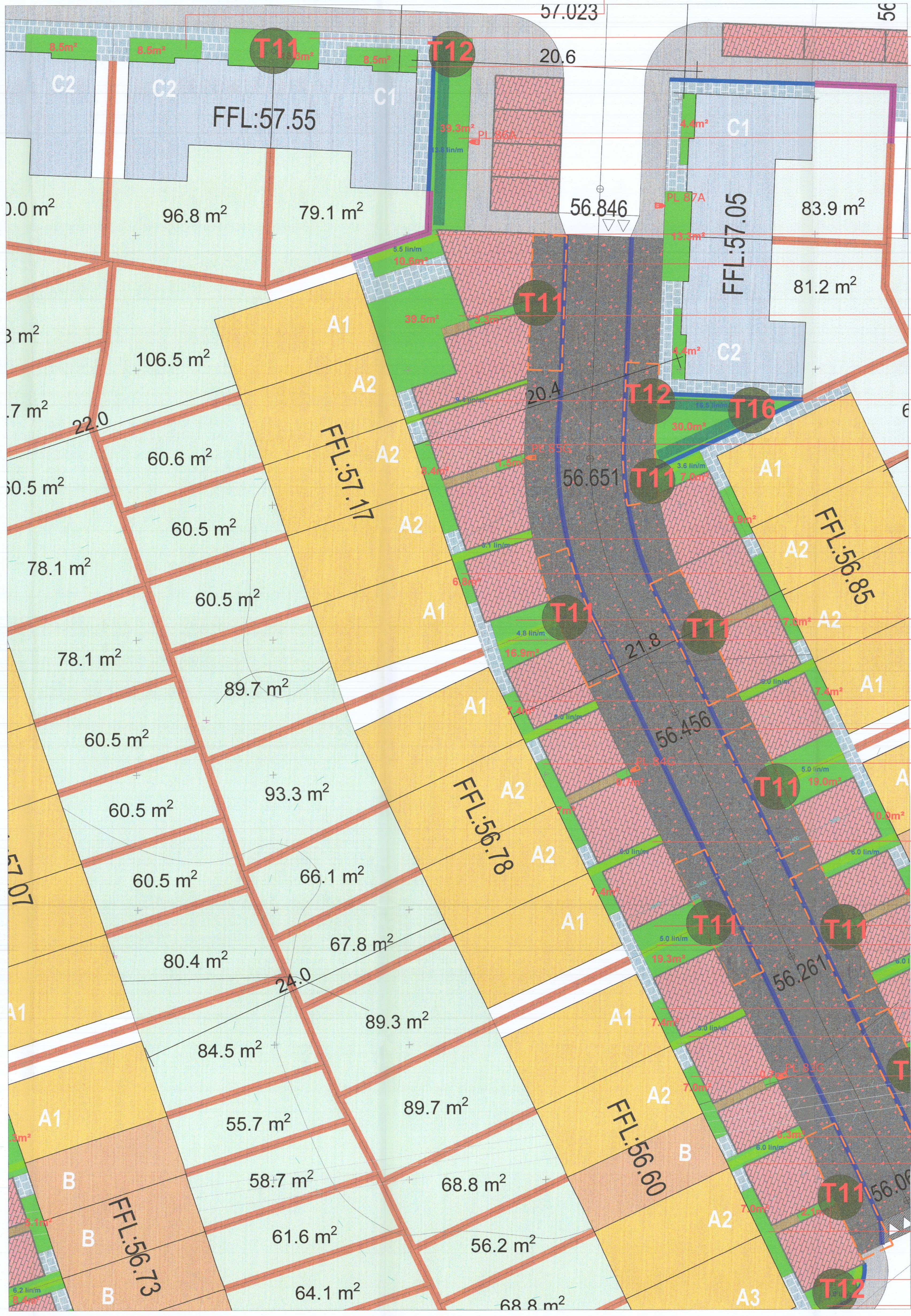

- S2 x 60no., Gc1 x 19no.
- S3 x 26no.
- S2 x 40no & S3 x 60no., Gc1 x 47no.
- Native Hedge x 41no.
- Ligustrum vulgare x 17no.
- S1 x 32no.
- S2 x 40no & S3 x 60no., Gc2 x 64no.
- Ligustrum vulgare x 28no.
- S3 x 30no.
- Ligustrum vulgare x 18no.
- S2 x 20no.
- S5 x 25no & S6 x 25no. Ligustrum vulgare x 14no.
- S2 x 22no.
- Ligustrum vulgare x 18no.
- S3 x 23no.
- Ligustrum vulgare x 19no.
- S5 x 29no & S6 x 29no. Ligustrum vulgare x 15no.
- S2 x 22no.
- Ligustrum vulgare x 18no.
- S3 x 23no.
- Ligustrum vulgare x 18no.
- S5 x 19no.
- S6 x 46no.
- S1 x 26no.
- Ligustrum vulgare x 18no.

Proposed Shrub Planting - 2601.4 sq.m
450mm topsoil depth

Code	Species Name	Specification	Plant/m2	No.
P.o.	<i>Prunus 'Ota Luyken'</i>	c/g 3L 30-40cm ht.	3m ²	1055
L.a.	<i>Lavandula angustifolia</i>	c/g 3L 30-40cm ht.	4m ²	2691
L.g.	<i>Libertia grandiflora</i>	c/g 3L 30-40cm ht.	3m ²	1560
C.c.	<i>Cistus corbariensis</i>	c/g 3L 30-40cm ht.	3m ²	354
S.c.	<i>Sarcococca confusa</i>	c/g 3L 30-40cm ht.	3m ²	1360
A.s.	<i>Astelia 'Silver Spear'</i>	c/g 2L 30-40cm ht.	5m ²	634
S.s.	<i>Sedum spectabile</i>	c/g 2L 30-40cm ht.	5m ²	154

Proposed Ground Cover Planting
450mm topsoil depth

Code	Species Name	Specification	Plant/m2	No.
B.c.	<i>Bergenia cordifolia</i>	c/g 2L 30-40cm ht.	5m ²	721
P.a.	<i>Persicaria affinis</i>	c/g 2L 30-40cm ht.	5m ²	517
H.n.	<i>Helleborus niger</i>	c/g 2L 30-40cm ht.	5m ²	402

H1 - Native Hedgerow (450mm topsoil depth / 100cm double row)
Species Name
Craetagus monogyna, Ilex aquifolium, Corylus avellana, Viburnum opulus
- approx. 933.3 lin/m

H2 - Evergreen hedgerow (450mm topsoil depth / 100cm single row)
Ligustrum vulgare - approx. 612.3 lin/m

Location Plan

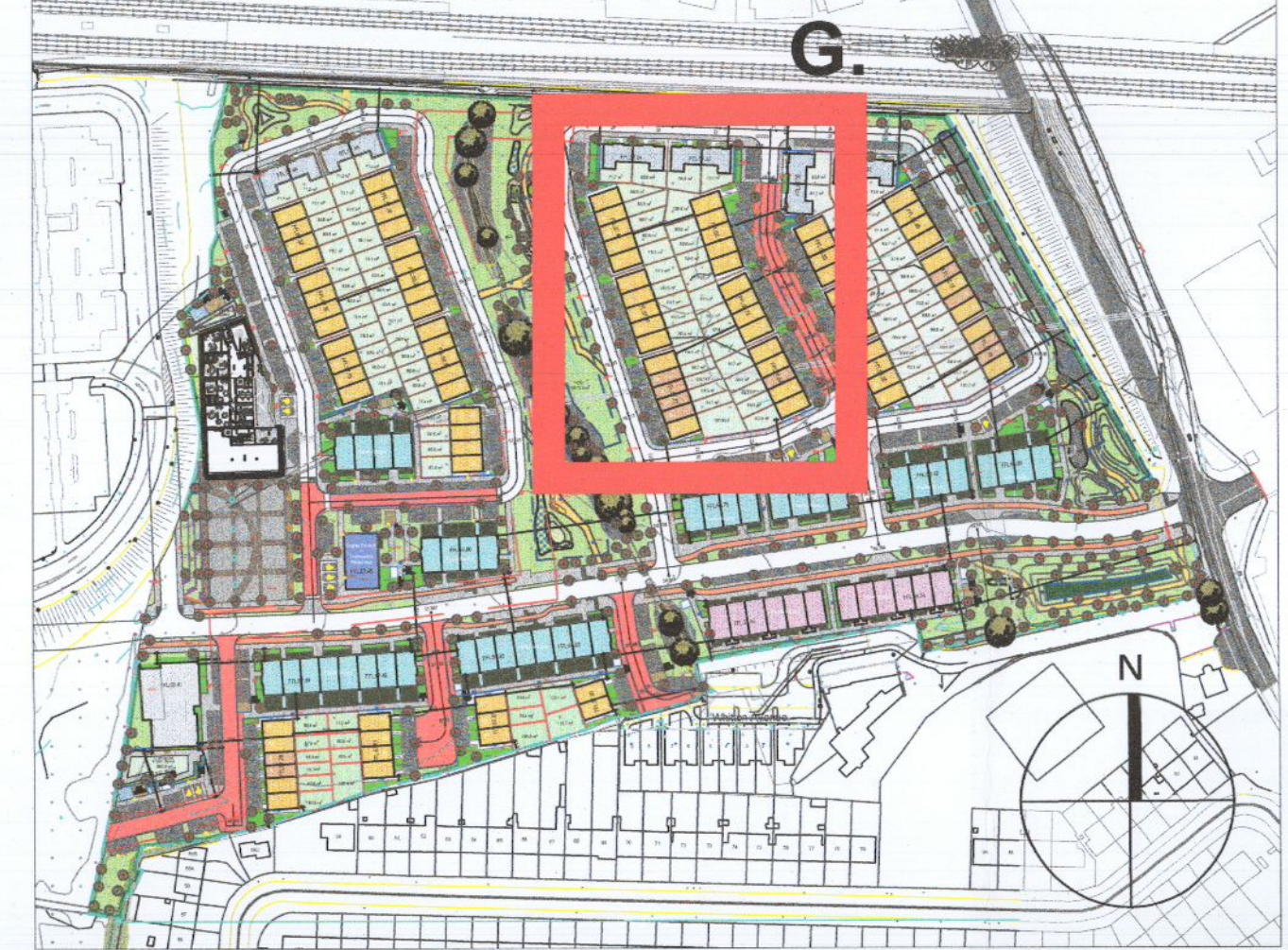

REV	DATE	BY	CHECKED	DESCRIPTION

Project Title: Clonburris SDZ at Dublin 22

Client: Kelland Homes
Dwg No: 06 LPP

Drawing Title: Landscape Planting Plan (v)
Scale: Varies

Job No: 1577
Date: 12/11/2020

Ronan MacDiarmada + Associates Ltd.
Landscape Architects and Consultants.

5 Tootenhill, Rathcoole, Co. Dublin
tel: +353 1 412 4476 fax: +353 1 401 3748
mob: 086 26 25 438 e-mail: ronan@rmda.ie

This Drawing is Copyright