

**NOTES**

- THIS DRAWING IS TO BE READ IN CONJUNCTION WITH ALL ENGINEERS & ARCHITECTS DRAWINGS FOR DIMENSIONS ONLY. FOOTING TO ADJACENT PROPERTY IS TO BE MAINTAINED IN THE EXISTING STATE UNLESS OTHERWISE NOTED.
- CONSULTANTS TO BE INFORMED IMMEDIATELY OF ANY DISCREPANCIES BEFORE WORK PROCEEDS.

CIVIL LEGEND	
	SITE BOUNDARY
	PROPOSED ROAD
	PROPOSED PERMEABLE PAVING
	PROPOSED FOOTPATH
	PROPOSED SHARED SURFACE (CYCLE / PEDESTRIAN)
	PROPOSED CYCLE PATH
	PROPOSED TACTILE PAVING
	PROPOSED BIN AREA
	ROAD WIDENING
	PROPOSED BASED TABLE
	PROPOSED ROAD LEVEL
	PROPOSED ROAD LEVEL
	PROPOSED ROAD LEVEL
	CHEVRON BOX AREA
	EXISTING ROAD
	EXISTING FOOTPATH
	EXISTING BUILDING
	EXISTING SHARED SURFACE (CYCLE / PEDESTRIAN)
	EXISTING CYCLE PATH
	EXISTING BUS STOP

NOTE: REFER TO ARCHITECTS DRAWINGS FOR DIMENSIONS TO FLOOR LAYOUTS OF BLOCKS A-F.

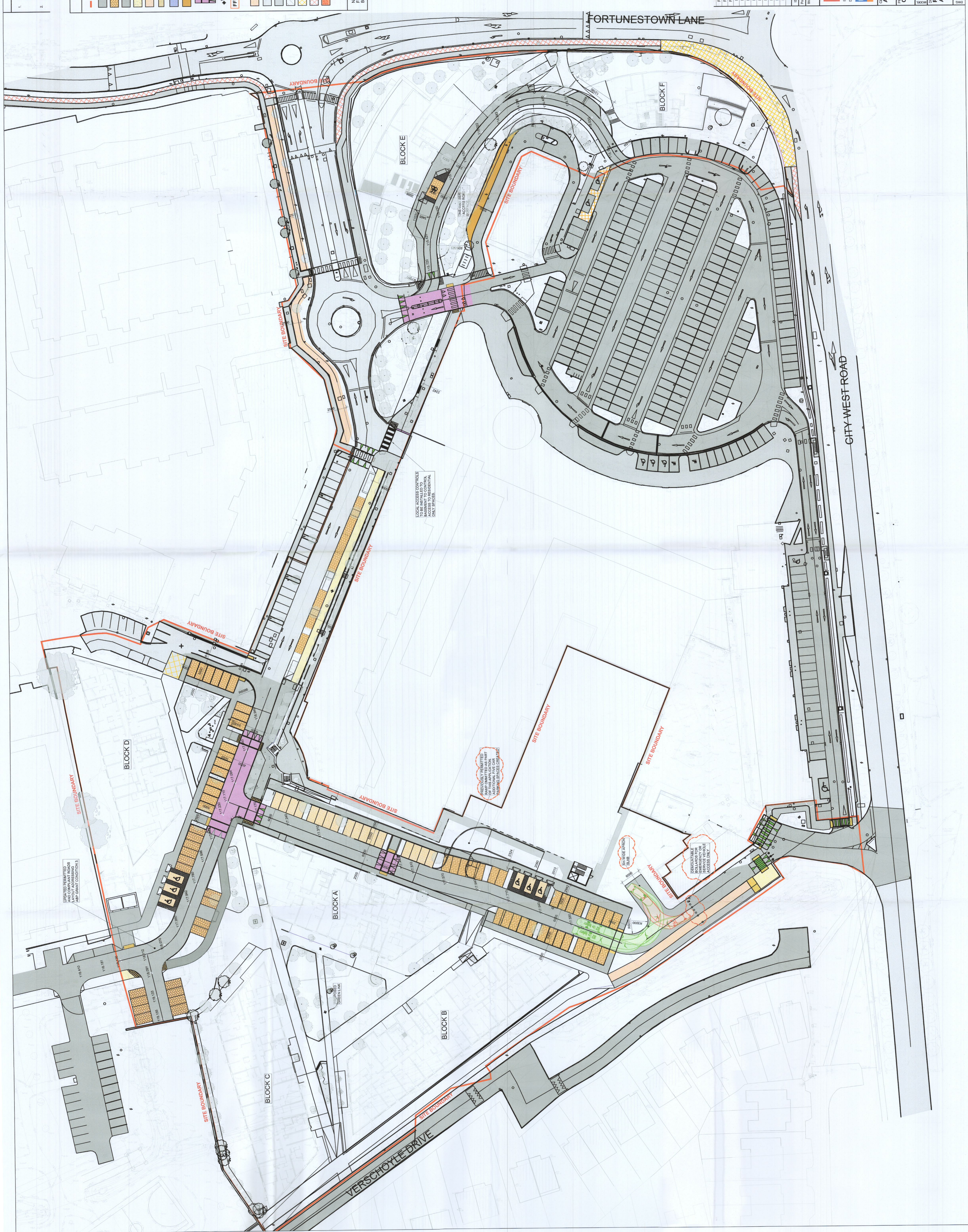

REV	DATE	DESCRIPTION
PL12	27.10.22	SITE LAYOUT REVISED
AM	14.10.22	SITE LAYOUT REVISED
AM	10.10.22	SITE LAYOUT REVISED
PL8	02.09.22	ISSUED FOR PLANNING
AM	30.08.22	ISSUED FOR PLANNING
PL7	29.07.22	ISSUED FOR PLANNING
AM	13.07.22	ISSUED FOR PLANNING
MR	10.06.22	ISSUED FOR PLANNING
PL4	31.03.22	PLANNING COMPLIANCE
DB	16.03.22	PLANNING COMPLIANCE
MR	15.02.22	PLANNING COMPLIANCE
PL2	02.02.22	ISSUED FOR PLANNING
DB	02.02.22	ISSUED FOR PLANNING
PL1	02.02.22	ISSUED FOR COORDINATION
PL2	02.02.22	ISSUED FOR COORDINATION
ISSUE	DATE	DESCRIPTION

**PLANNING**

BM STRATHMORE  
 15541 New South Street, Suite 1, Strathmore  
 Tel: 011 877 2020 Fax: 011 877 2134  
 15541 New South Street, Suite 1, Strathmore  
 Tel: 011 877 2020 Fax: 011 877 2134

**ARDSTONE**  
 Project Director: M.H.

**CECI**  
 The City of Cape Town  
 City Engineer: M.H.

**BM**  
 15541 New South Street, Suite 1, Strathmore  
 Tel: 011 877 2020 Fax: 011 877 2134

PROJECT TITLE: CITY WEST  
 REFERENCE: CWD-BMCE-XX-ZZ-M3-C-00001  
 DRAWING TITLE: ROADS LAYOUT AND LEVELS - PLANNING APPLICATION 2  
 PROJECT NO: 21.226  
 REVISION: P01.01  
 DATE: 21.10.22  
 DRAWN BY: M.H.