

**KEY DESIGN PARAMETERS FOR CELLUAR SOAKAWAYS**

STONE VOID RATIO		95%					
SOAKAWAYS	LENGHT (M)	WIDTH (M)	DEPTH (M)	SIZE (M <sup>2</sup> )	SIZE REQUIRED (M <sup>2</sup> )	IMPERMEABLE AREA(M <sup>2</sup> )	F-VALUE (M/SEC)
A	10.00	2.60	0.60	15.60	15.13	263	2.40 <sup>-5</sup>
B	13.00	2.00	0.60	15.60	15.36	263	1.62 <sup>-5</sup>
EXISTING HSE	6.00	3.00	0.60	10.80	8.58	210	3.06 <sup>-5</sup>

SILT TRAP INSTALLED BEFORE DISCHARGE TO CELLUAR STORAGE

ALL ELEMENTS OF THE CELLUAR STORAGE MUST BE MAINTAINED BY SUITABLY QUALIFIED PROFESSIONALS

**KEY DESIGN PARAMETERS FOR PERMEABLE PAVING**

STONE VOID RATIO	30%
STORAGE DEPTH	137MM
TOTAL PERMEABLE PAVING AREA	485M <sup>2</sup>
F-VALUE	2.01 <sup>-5</sup> M/SEC

ALL ELEMENTS OF THE PERMEABLE PAVING MUST BE MAINTAINED BY SUITABLY QUALIFIED PROFESSIONALS

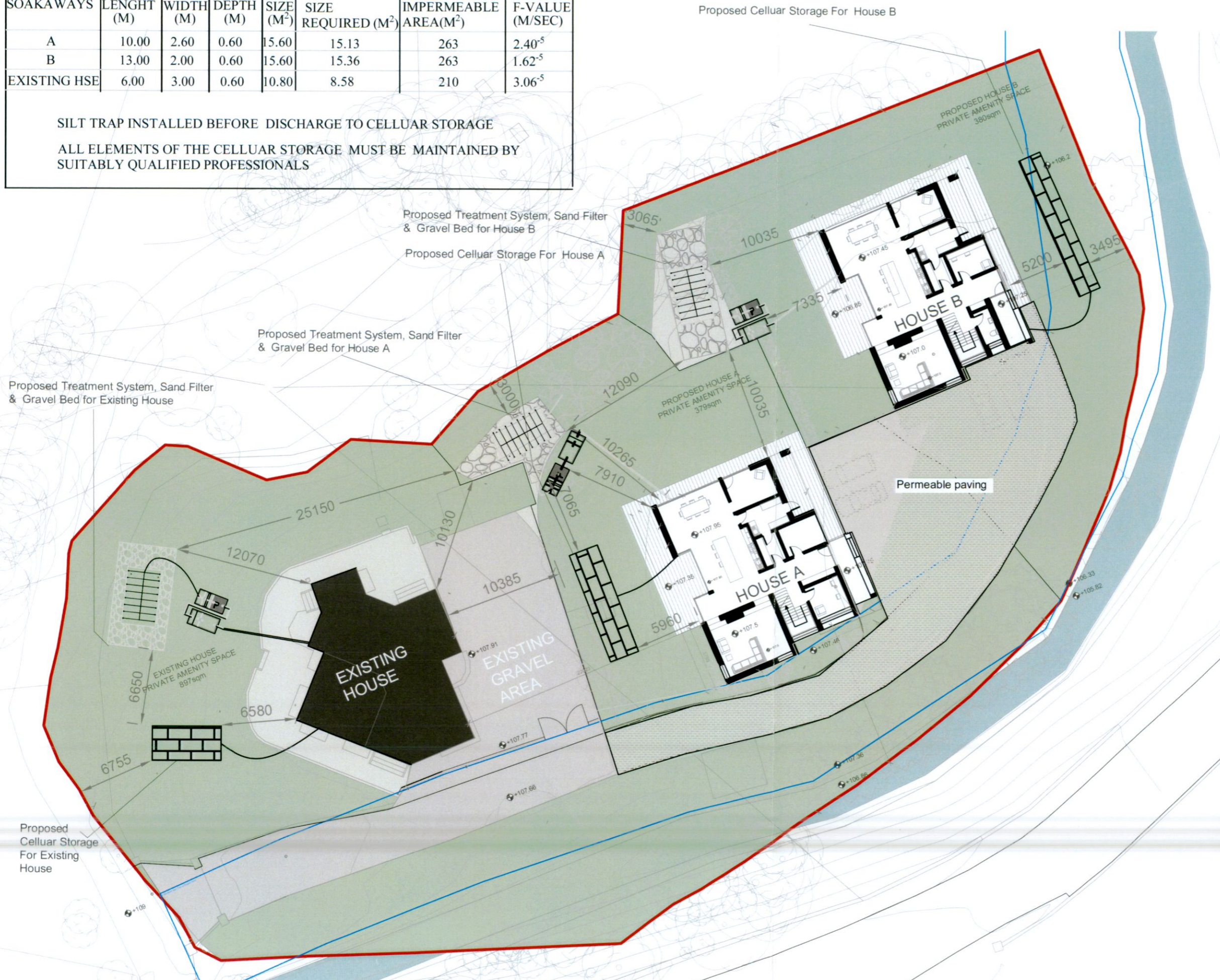

REV.	DATE	DESCRIPTION	APPROVE

COPYRIGHT RESERVED – THIS DRAWING IS NOT TO BE USED FOR A PURPOSE OTHER THAN THAT FOR WHICH IT HAS BEEN ISSUED BY TRAYNOR ENVIRONMENTAL LTD. NOR IS IT TO BE COPIED OR REPRODUCED IN ANY MATTER WITHOUT WRITTEN CONSENT.



**Traynor Environmental Ltd**

CLIENT  
NICOLA LYNCH, BRIAN DUNNE, CIARA LYNCH & RICHARD O'FARRELL

PROJECT TITLE  
LYNBROOK, WHITECHURCH RD,  
RATHFARNHAM, DUBLIN 16

DRAWING TITLE  
SITE LAYOUT WITH PERCOLATION AREAS  
& SOAKAWAYS

SCALE	DRAWN	CHECKED	APPROVED
1/350	KILLIAN BANNON	NEVIN TRAYNOR	NEVIN TRAYNOR
	DATE APRIL 2022	DATE APRIL 2022	DATE APRIL 2022

DRAWING No.	REV.
TE22.206.100	C