

Boundary Type Key Plan:

- Existing:
- A- Existing walls, fence & gate to be retained
- Proposed:
- B- Metal "Estate Railings", 1.8m high
 - C- Timber slat fence, 1.8m high
 - D- Metal "Estate Railings" and matching gates, 1.2m high
 - E- 300mm wide line of stone paving set in gravel driveway to denote boundaries
 - F- No new boundary proposed to stream

1. SITE BOUNDARIES

1:500

To be read in conjunction with Landscape Architects Drawings:
Gannon & Associates Dr no's: "LP-01" & "LP-011"

Indicative Images of Boundary Treatments



Type A- Existing walls, fence & gates (Photo 01)



Type B & D- Metal "Estate Railings"



Type C- Timber Slat fence

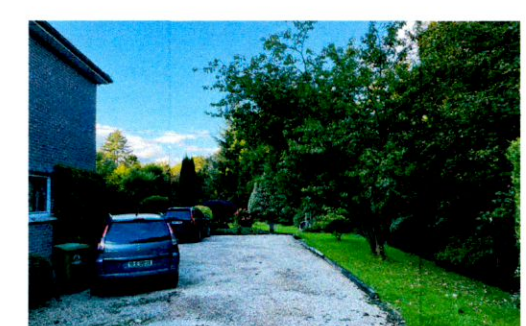

Type F- No new boundary proposed to stream

No existing boundary to stream



Type E- 300mm wide line of stone paving set in gravel driveway to denote boundaries
Driveway to consist of Ballylusk fines/ gravel on permeable stabilising mat



To be read in conjunction with Landscape Architects Drawings:
Gannon & Associates Dr no's: "LP-01" & "LP-011"

Proposed Site Subdivision

- Ex- Existing Dwelling (proposed site)
- A- Proposed Dwelling A
- B- Proposed Dwelling B
- C- Shared Access/ Driveway. To be formalised by future legal & management agreement

Key Plan (not to scale)

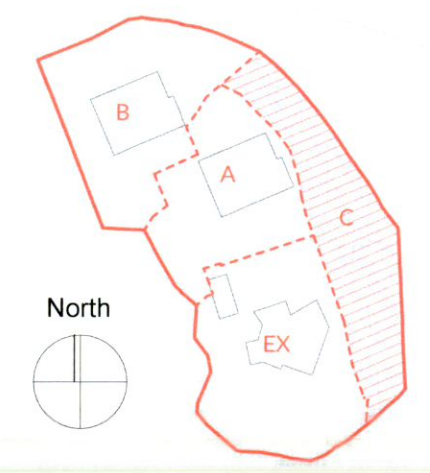

NOTES:

Do not scale off this drawing. Check all dimensions on site. Notify Architect of all and any discrepancies. Discrepancies to be referred to the Architect for clarification. All drawings to be read in conjunction with Architects specification and all relevant documents. Drawing to be printed in colour and at noted size for clarity. This drawing and its content is copyright to Brock Finucane Ltd. This drawing shall not be copied, reproduced or otherwise used without the written consent of Brock Finucane Ltd.

KEY PLAN:



BROCK FINUCANE

28 LOWER BAGGOT STREET
DUBLIN 2 D02 NX 43
IRELAND
WWW.BROCKFINUCANE.COM
INFO@BROCKFINUCANE.COM
+353 1 9108735

ARCHITECTS

| | | | |
|----------|-------------------------------|-------|------------------|
| PROJECT | LYNBROOK, DUBLIN | DATE | OCT 22 |
| DRAWING | SITE BOUNDARIES & SUBDIVISION | DRAWN | PF |
| STAGE | PLANNING | CHECK | RF |
| DWG. NO. | 2003_P701 | REV. | SCALE 1:500 @ A3 |

CLIENT Nicola Lynch, Brian Dunne & Ciara Lynch, Richard O'Farrell