

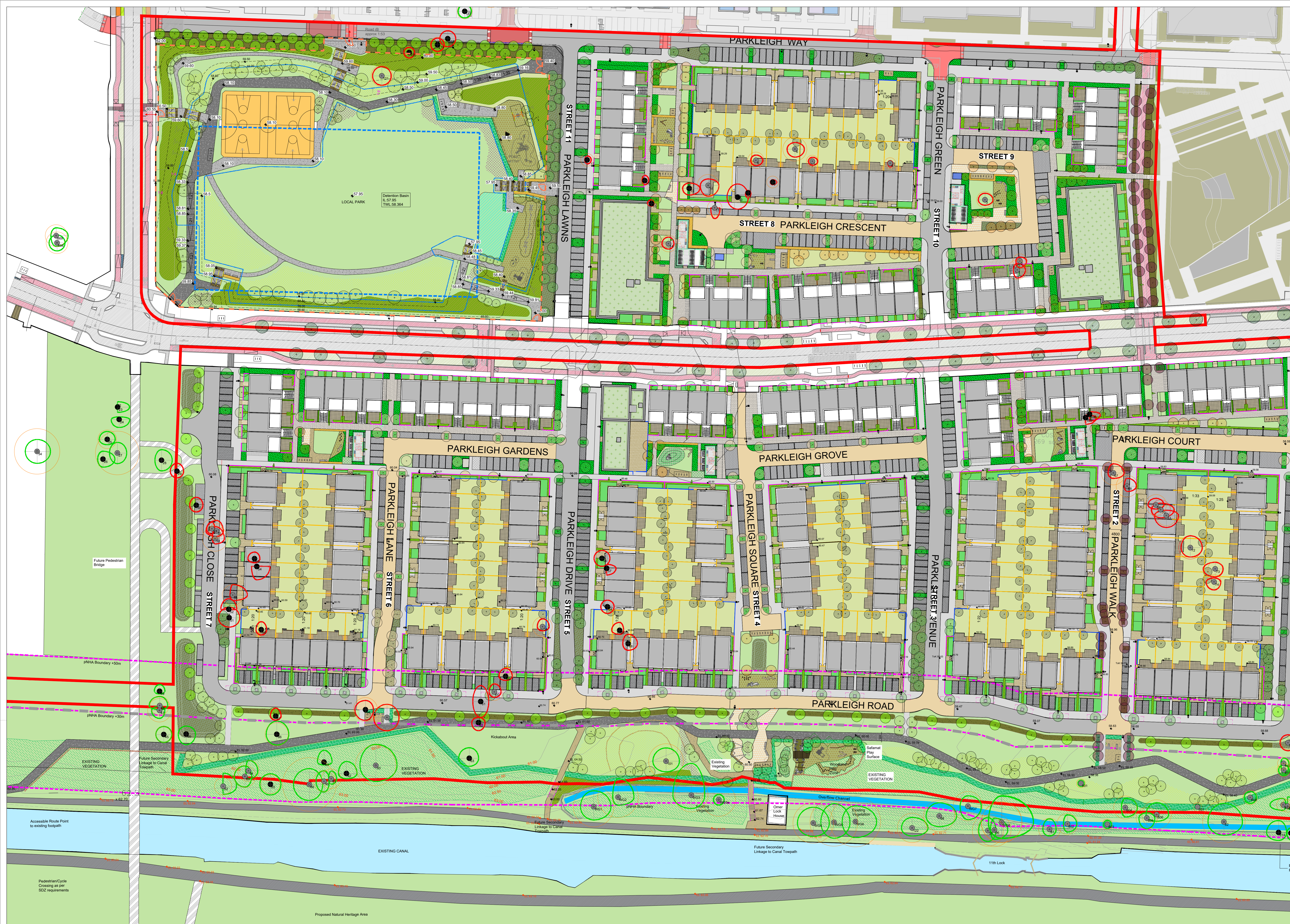

- SOFT LANDSCAPE** (refer to 1738_T_P_04.104.2)
- Existing Trees to be retained
 - Existing Trees to be removed
 - Existing Vegetation to Canal boundary and Forthill Rd to be retained and enhanced
 - Proposed Street Trees: Tree Pit in Paving - Structural Soil where shown
 - Link Street
 - Green Corridor
 - Local Streets
 - Small Residential Streets/Homezones
 - Proposed Open Space Trees
 - Parkland Trees
 - Urban Edge
 - Proposed Communal Open Spaces/Garden Trees
 - Communal Open Space/Apt/Duplex/Specimen Ornamental
 - Rear Garden Trees
 - Native Woodland Planting
 - Street/Public Realm Planting
 - Front Garden Planting
 - Residential Hedge Planting
 - Open Space Hedge Planting
 - Open Space Native Hedge
 - Planted Swale
 - Biorotation Area
 - Wet Area
 - Amenity Grass Lawn
 - Garden Lawn
 - Native Meadow Grass
 - Bulk planting in grass
 - Climbers - Green Wall Planting with trellis
 - Proposed Green Roof



LEGEND

<ul style="list-style-type: none"> Site Boundary - Extent of work Wayleaves - Gas & Water HARD LANDSCAPE Existing Pathways along the Canal Future Pedestrian Bridge Proposed Street Asphalt Roadway with in-situ concrete kerbs (to Engineer's specification and details) Proposed Homezone Local Street Asphalt (RSA) with buff coloured strip (to Engineer's specification and details) Proposed Footpaths In-situ concrete, Brushed Finish (to Engineer's specification and details) Proposed Paths Permeable Solid Surface Sustainable Surface Solution, Flexible or Porous Asphalt, color TBC, or similar and approved 	<ul style="list-style-type: none"> House - Private Side Entrance In-situ concrete, Brushed Finish (to Engineer's specification and details) Footpaths Compacted Gravel Surface with Timber Edge, Self-Binding Gravel surface, 6-10mm to dust of aggregate - Ballykiss and approved Paving UP1 - Public Spaces: Footpaths Kiloran, Newrange, 3 size mix x 60mm D, Silver, Black detailing / Textured Granite, Random Stretcher, or similar and approved UP2 - Public Spaces: Seating Areas, Feature Spaces Kiloran, Newrange, 3 size mix x 60mm D, Silver, Black detailing / Textured Granite, Coursed Stretcher, or similar and approved UP3 - Car Parking Spaces - Permeable Paving - Off Curtilage Kiloran, Cimpagne Stone, 200 x 100 x 80, Silver / Textured Granite, Herringbone, or similar and approved UP4 - Car Parking Spaces - Permeable Paving - On Curtilage Kiloran, Cimpagne Stone, 3 size mix x 60mm D, Black / Textured Granite, Random Stretcher, or similar and approved UP5 - Entrance to houses / gardens / driveways Kiloran, Newrange, 600 x 600 x 50mm, Silver Granite, Stretcher Bond, or similar and approved UP6 - Private patios / GL terraces Kiloran, Newrange, 600 x 400 x 50mm or 400 x 400 x 50mm, Buff Granite, Stretcher Bond, or similar and approved UP7 - Fire / maintenance route Rivar, Prograss, 500 x 300 x 45 mm, Standard - recycled plastic HD-PE (regardant), surface, environmentally neutral, Green, or similar and approved. To manufacturer's connection system. UP8 - Play Area Surfaces Grass Safety Matting (in Detention Basins) & Play Bark mulch suitable for play areas UP9 - Safety Surfacing - Playground Surface Wood fibre manufactured using 100% seasoned, recycled softwood shavings, 300mm depth Supplier: Connaught Timber, Product: Playground Wood Chip or similar and approved Gravel Strip Willow Granite 11-14mm, 50mm deep layer over 150mm of P6a Gravel, Pressure Treated Timber edging, min. 20mm thick Steps Pre-cast concrete steps with Slip Noising - Grip / Visibility Strip recessed into concrete step. Refer to Engineer's package for specifications and build-up Tactile Paving Stepped & Ramped accesses, Curbside tactile concrete flag. Double wide line of tactile surface on top and bottom landing, 400mm apart from landings Phoretic crossings Cycleway Refer to Engineer's package for specifications and build-up FURNITURE Bench Powder coated stainless steel (colour Anthracite Grey RAL 7016 or similar approved) and recycled concrete timber seat. Supplier: Harbortec, Product: HC2033S Seat or similar and approved. To include back and arm rests. Size: 1500x300x40mm. To be fixed to concrete pad. Bins Semi domed top, cast ductile iron liner bin with half circle aperture, 224x125mm. Dimensions: 1900 x 430 x 200mm. Galvanized with powder coated finish (color Anthracite Grey RAL 7016 or similar approved). Supplier: Harbortec, product: HC2035 - 100 ltr, or similar and approved. To be supplied with detachable base plate. To be fixed to concrete pad. Bollard 304 grade stainless steel bollard Supplier: Fitman, product: Stern Dome Stainless Steel Bollard (P-956766), dim: 1200(H) x Ø 114mm, or similar and approved Handrail Outdoor Bicycle Stands (100 stands) - Short stay Bicycle Spaces (200 spaces) Sheffield Bicycle Stands (uncovered) - located in open spaces Supplier: Harbortec (for similar and approved), Product: Sheffield stand, or similar and approved. Material: 316 grade stainless steel. Dim: H202mm, W195mm (at 1000mm). Fixing: concrete foundation under proposed surface treatment. Retaining Walls/Raised Planters (+450mm - 600mm) Rendered Concrete Block with PC Concrete Coping Raised Planters +450mm height Exposed Aggregate Concrete with shot-blasted finish. Timber seating elements incorporated. Lighting Columns (with 5m exclusion Zone) See Lighting Engineers drawings for details PROPOSED PLAYGROUND EQUIPMENT To comply with BS EN 1176 Note: specification and installation as per manufacturer's product sheet Mixed playground and fitness equipment Mixed fitness equipment Natural play elements 	<ul style="list-style-type: none"> BOUNDARIES TREATMENT W1 - Boundary between Residential and Public Realm Rendered Concrete Block Wall with PC concrete coping & Brick Piers +2.0m high, or similar and approved W2 - Rear House Garden Dividing Boundary Timber Panel with Concrete Post, +1.8m high, or similar and approved W3 - Rear House Garden Dividing Boundary with retaining elements Timber Panel with concrete post. To include 300mm concrete base as retaining element, 1.2m high, or similar and approved W4 - Front houses Rendered Concrete Block Wall - Retaining wall with 0.3m railing Rendered retaining wall, less than 0.6m high, with 0.9m estate railing guarding Data membrane as DPC to the rear of all retaining walls before backfilling, or similar and approved W5 - Apartment Courtyard Railing Steel Bar Railing, Powder coated, Colour: Black, +1.8m high, or similar and approved with gates to match W6 - Front Houses and Duplexes Railing Estate fence railing, 900mm high with horizontal bar, Colour: Black, or similar and approved W7 - Local Park Railing Low wall with heavy duty round bar, 16mm diam, galvanized and powder coated matt metal railing, Colour: Black, 1.5m high, Gates to match, or similar and approved W7.1 - Steel Bar Gate Double and single steel bar gate to match railing, Automation TBC F1 - Duplex Terrace - Composite panel fence (1.6m high) Between Duplex properties for privacy. Supplier: Irish Fencing, Product: Composite timber fencing, dim: height 1600mm, post size 100x100mm, board dim: 206x1910mm, Color Dark Grey or similar and approved F2 - Protective Fencing along existing Hedgerow Chestnut Pole Fencing, 1.2m high, to protect existing vegetation within the pMAA Proposed Kerbs refer to Eng's "Proposed pavement & kerbing details sheets" and specifications Below Ground Attenuation Tank See Engineer's drawings for more information Attenuation Basin - Top & Bottom of proposed slope TREE PITS (Refer to drawing no: 1738_PLD_D_01 and Engineer's details, drawing no: CS-B-1A-94-SW-XXX-GR-06FL-CE-5304) Typ1 Tree Pit in Paving with Tree Grid and Structural Soil
--	--	--

murray & associates
landscape architecture

16 The Square Building
40-42 Colindale Avenue
London, NW9 1UH
Date: 3. 2024 RPS

PROJECT NO:	1738_PLD_P_01.1	SHEET NO:	AD
PROJECT TITLE:	RESIDENTIAL DEVELOPMENT CLOUBURRIS	DATE:	17/11/22
SHEET FILE:	Masterplan - 01.02	SCALE:	1:500
DATE:	17/11/22	DESIGNER:	MB
PROJECT NO:	1738_PLD_P_01.1	CHECKER:	MB
PROJECT TITLE:	RESIDENTIAL DEVELOPMENT CLOUBURRIS	DATE:	17/11/22
SHEET FILE:	Masterplan - 01.02	SCALE:	1:500
DATE:	17/11/22	DESIGNER:	MB
PROJECT NO:	1738_PLD_P_01.1	CHECKER:	MB
PROJECT TITLE:	RESIDENTIAL DEVELOPMENT CLOUBURRIS	DATE:	17/11/22
SHEET FILE:	Masterplan - 01.02	SCALE:	1:500
DATE:	17/11/22	DESIGNER:	MB