

- LIST OF IRISH WATER STANDARD DETAILS BROUGHT INTO THE CONTRACT
- STD-W-04 GENERAL PIPE CONNECTIONS (SHEET 1 OF 7)
 - STD-W-05 GENERAL PIPE CONNECTIONS (SHEET 2 OF 7)
 - STD-W-06 GENERAL PIPE CONNECTIONS (SHEET 3 OF 7)
 - STD-W-07 GENERAL PIPE CONNECTIONS (SHEET 4 OF 7)
 - STD-W-08 GENERAL PIPE CONNECTIONS (SHEET 5 OF 7)
 - STD-W-09 GENERAL PIPE CONNECTIONS (SHEET 6 OF 7)
 - STD-W-10 GENERAL PIPE CONNECTIONS (SHEET 7 OF 7)
 - STD-W-11 TYPICAL SERVICE LAYOUT INDICATING SEPARATION DISTANCES
 - STD-W-12 RESTRICTIONS ON TREES / SHRUBS PLANTING ADJACENT TO WATERMANS
 - STD-W-13 TRENCH BUCKLE & BEDDING
 - STD-W-14 SLUICE VALVE FOR DUCTILE IRON (D.I.) PIPE (<350MM DIA.) (SHEET 1 OF 2)
 - STD-W-15 SLUICE VALVE FOR POLYETHYLENE (P.E.) PIPE (<350MM DIA.) (SHEET 2 OF 2)
 - STD-W-16 ON-LINE HYDRANT FOR DUCTILE IRON (D.I.) PIPE (SHEET 1 OF 4)
 - STD-W-17 OFF-LINE HYDRANT FOR DUCTILE IRON (D.I.) PIPE(SHEET 2 OF 4)
 - STD-W-18 ON-LINE HYDRANT FOR POLYETHYLENE (P.E.) PIPE(SHEET 3 OF 4)
 - STD-W-19 OFF-LINE HYDRANT FOR POLYETHYLENE (P.E.) PIPE(SHEET 4 OF 4)
 - STD-W-20 ON-LINE AIR VALVE FOR DUCTILE IRON (D.I.) PIPE(SHEET 1 OF 4)
 - STD-W-21 OFF-LINE AIR VALVE FOR DUCTILE IRON (D.I.) PIPE(SHEET 2 OF 4)
 - STD-W-22 ON-LINE AIR VALVE FOR POLYETHYLENE (P.E.) PIPE(SHEET 3 OF 4)
 - STD-W-23 OFF-LINE AIR VALVE FOR POLYETHYLENE (P.E.) PIPE(SHEET 4 OF 4)
 - STD-W-24 PRESSURE REDUCING / SUSTAINING VALVE(P.R.V./P.S.V.) CHAMBER
 - STD-W-25 METER CHAMBER (300MM DIA.)
 - STD-W-26 MARKER POSTS / RALES
 - STD-W-27 WATER MAIN THRUST & SUPPORT BLOCKS
 - STD-W-28 SCOUR CHAMBER & HEAD WALL ARRANGEMENTS
 - STD-W-29 WASHOUT HYDRANT
 - STD-W-30 TYPICAL DITCH / STREAM CROSSING FOR WATER MAIN

NOTES

1. ALL DRAWINGS TO BE CHECKED BY CONTRACTOR ON SITE AND ENGINEER INFORMED OF DISCREPANCIES BEFORE WORK COMMENCES
2. ALL LEVELS ARE IN METRES AND ARE RELATED TO ORDNANCE DATUM
3. ALL DIMENSIONS TO BE IN MILLIMETERS UNLESS NOTED OTHERWISE
4. CONTRACTOR SHALL SATISFY HIMSELF AS TO THE ACCURACY OF PAVEMENT LEVELS ON SITE PRIOR TO COMMENCEMENT OF WORKS ON SITE
5. ALL SURFACE WATER DRAINAGE WORKS TO BE IN ACCORDANCE WITH THE REQUIREMENTS OF THE LOCAL AUTHORITY'S CODE OF PRACTICE FOR DRAINAGE AND THE CROSS
6. ALL SURFACE WATER SEWERS TO BE CLASS H CONCRETE TO EN1916 & IS 6 2004.
7. ALL FOUL DRAINAGE WORKS TO BE IN ACCORDANCE WITH IRISH WATERS' CODE OF PRACTICE FOR WASTEWATER SUPPLY AND WASTEWATER INFRASTRUCTURE STANDARD DETAILS.
8. FOUL SEWERS TO BE THERMOPLASTIC STRUCTURED WALL PIPES (COMPLYING WITH THE PROVISIONS OF IS EN 13476 AND WIS 4-35-01 2000) AND COMPLY WITH THE REQUIREMENTS OF THE IRISH WATER CODE OF PRACTICE
9. WATERMAIN INSTALLATION AND ALL WATER SUPPLY WORKS TO BE IN ACCORDANCE WITH THE REQUIREMENTS OF IRISH WATERS' CODE OF PRACTICE FOR WATER SUPPLY AND WATER INFRASTRUCTURE STANDARD DETAILS
10. WATERMANS TO BE TYPE HPPE, PE-100, SDR-17 RATED AND SHALL CONFORM TO IS EN 12201 (PART 1, PART 2 & PART 3)
11. WATERMAIN SERVICE CONNECTION PIPES TO BE HDPE (PE-80) MATERIAL WITH SDR-17 RATING
12. ANCHOR BLOCKS TO BE POSITIONED AT DEAD ENDS, TEES, BENDS AND AT EACH SIDE OF HYDRANTS AND VALVES IN ACCORDANCE WITH THE REQUIREMENTS OF IRISH WATER STANDARD DETAIL STD-W-28 (WATER MAIN THRUST AND SUPPORT BLOCKS).
13. HYDRANT OUTLET TO BE 200mm BELOW GROUND LEVEL UNLESS REQUESTED OTHERWISE.
14. WHERE COVER TO PIPE IS LESS THAN 900mm IN GREEN AREAS AND 1200mm IN TRAFFICKED AREAS, ENCASE PIPE IN NEW 150mm CONCRETE WITH MOVEMENT JOINTS.

- LEGEND
- SV --- PROPOSED HPPE(PE100 SDR 17) WATERMAIN
 - H --- SLUICE VALVES AS PER IRISH WATER STANDARD DETAIL STD-W-14/15
 - AV --- HYDRANTS AS PER IRISH WATER STANDARD DETAIL STD-W-16/18
 - BB --- AIR VALVES S PER IRISH WATER STANDARD DETAIL STD-W-20/23
 - M --- PROPOSED BOUNDARY BOX AND HDPE SERVICE CONNECTION (PERD SDR 17)
 - M --- METER CHAMBER AS PER IRISH WATER STANDARD STD-W-26
 - WM --- EXISTING WATERMAIN
 - --- SITE BOUNDARY
 - --- PROPOSED BUILDING
 - --- PROPOSED FOOTPATH
 - --- PROPOSED ROADWAY
 - --- EXTENT OF BASEMENT

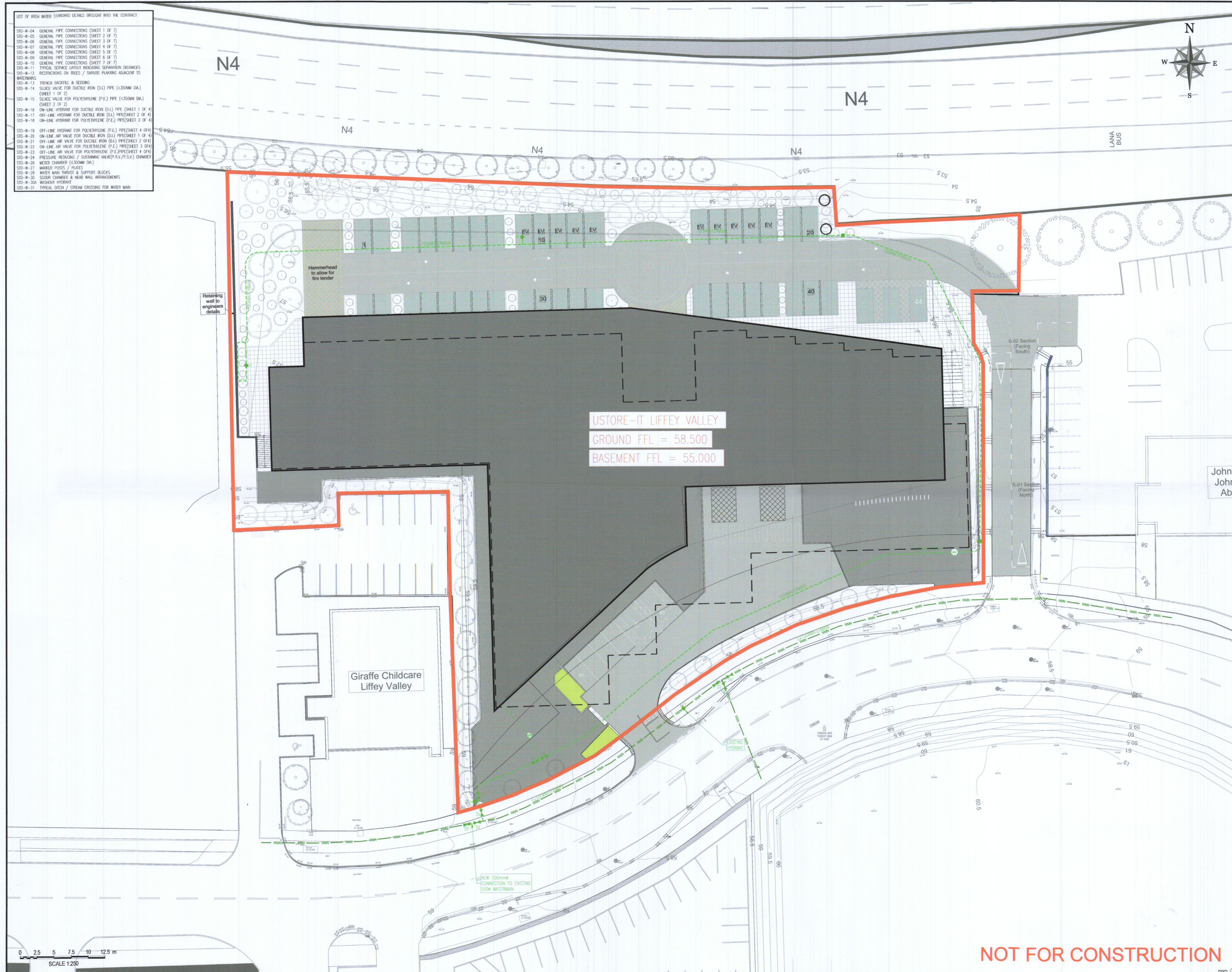
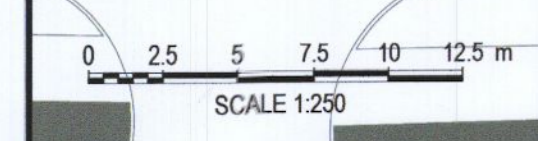

USTORE-IT LIFFEY VALLEY
 GROUND FFL = 58.500
 BASEMENT FFL = 55.000

P	28/10/22	PLANNING SUBMISSION	SM	SJ
Rev	Date	Description	By	Chk

PLANNING

gdcl
CONSULTING ENGINEERS

Scope House, 75 Shelton Street, Covent Garden, London WC2H 9JQ
 Perrystown, Dublin D12 K8PP
 www.gdalyc consulting.com

PROJECT: U-Store-It, Liffey Valley

CLIENT: Oceanglade Ltd

DRAWING TITLE: Proposed Watermain Layout

dm. by: SM	date: Oct 22	scale: 1:250
drawing size: A1	chk: SJ	app: GD
job no: P2005	drg. no: P2005-C-302	rev: p

NOT FOR CONSTRUCTION