

## Roads Department – Planning Report

**Register Reference:** SD22A/0388 **Date:** 08-Nov-2022  
**Development:** Stand-alone, portable drop in structure which can house new kitchen with adequate space for 3 staff members in the upper car park, this unit is 6m x 4m in size and can be moved if necessary.  
**Location:** SD22A0388 - Parkside Childcare, Rear of 20 Fonthill Abbey, Ballyboden Road, Rathfarnham, Dublin 14  
**Applicant:** Parkside Childcare Limited  
**App. Type:** Permission  
**Planning Officer:** EVAN WALSH  
**Date Recd:** 11-Oct-2022  
**Decision Due Date:** 05-Dec-2022

*Prior to commencement of any works in the public domain, and in order to comply with The Roads Act 1993 Section 13 Paragraph 10, a Road Opening Licence must be secured from South Dublin County Council, Roads Maintenance Department.*

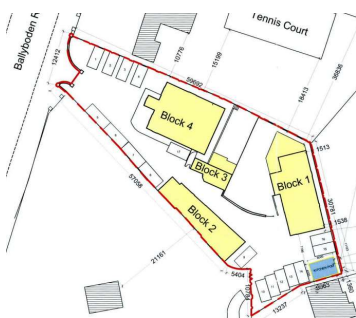

### **Description:**

Stand-alone, portable drop in structure which can house new kitchen with adequate space for 3 staff members in the upper car park, this unit is 6m x 4m in size and can be moved if necessary.

### **Access & Roads Layout:**

No roads issues arise.

### **No Roads objections**

### **Should the permission be granted, the following conditions are suggested:**

1. Crane operations may require a permit if articles are being moved through a public area.
2. Operations to be carried out in line with all relevant HSA guidelines & regulations.