

- GENERAL NOTES**
- DO NOT SCALE THIS DRAWING. WORK ONLY TO FIGURED DIMENSIONS.
 - FOR ALL RELEVANT NOTES, REFER TO STRUCTURAL AND CIVIL ENGINEERING PERFORMANCE SPECIFICATION.
 - ANY DISCREPANCIES ARE TO BE REPORTED TO PINNACLE CONSULTING ENGINEERS IMMEDIATELY.
 - THIS DRAWING IS TO BE READ IN CONJUNCTION WITH ALL OTHER RELEVANT ENGINEERS, ARCHITECTS AND SUB-CONTRACTORS DRAWINGS AND DETAILS.

LANDS UNDER THE CONTROL OF _____
 APPLICANT

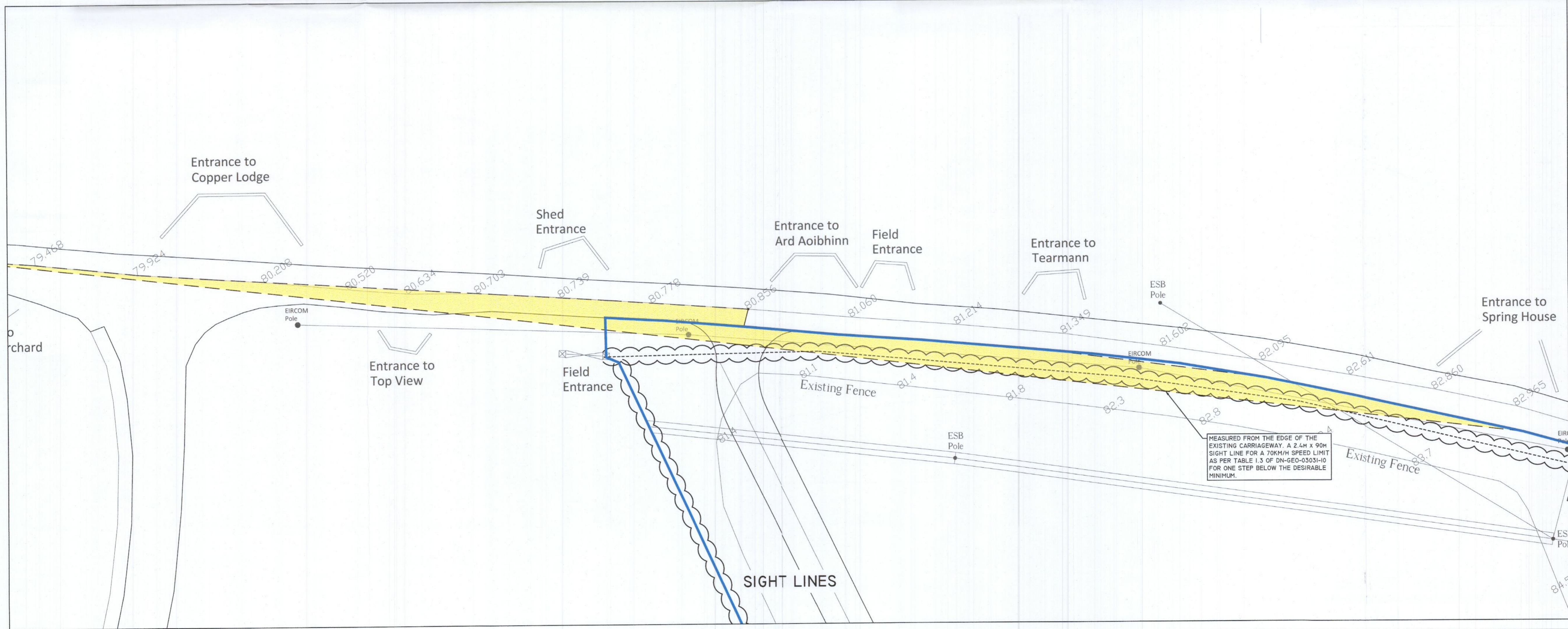

P05	BLUE LINE ADDED	RK	RK	24/10/22
P04	SIGHT LINES UPDATED	RK	RK	18/10/22
P03	SIGHT LINES UPDATED	RK	RK	17/10/22
P02	UPDATED SIGHT LINES	RK	RK	30/09/22
REV	DESCRIPTION	BY	CHK	DATE

CLIENT
PEARSE MC KIERNAN

PROJECT
**PROPOSED DWELLING,
 AT REDGAP, CO. DUBLIN**

DRAWING TITLE
**ALTERNATIVE ACCESS
 JUNCTION GA AND SIGHTLINES**

PINNACLE
 CONSULTING ENGINEERS

GROSVENOR COURT,
 67A PATRICK STREET,
 DUN LAOGHAIRE,
 COUNTY DUBLIN
 IRELAND. TELEPHONE: +353 1231 1041
 WELWYN GARDEN CITY | NORWICH | LONDON | THE HAGUE

DRAWING STATUS

PLANNING			
SCALE @ A1	DATE	DRAWN BY	CHECKED
1:250	SEPT'22	RK	RK
DRG NO.	REVISION		
P210304-PIN-XX-DR-D-0007-SI	P05		

COPYRIGHT PINNACLE

REF: P210304