

KEY PLAN

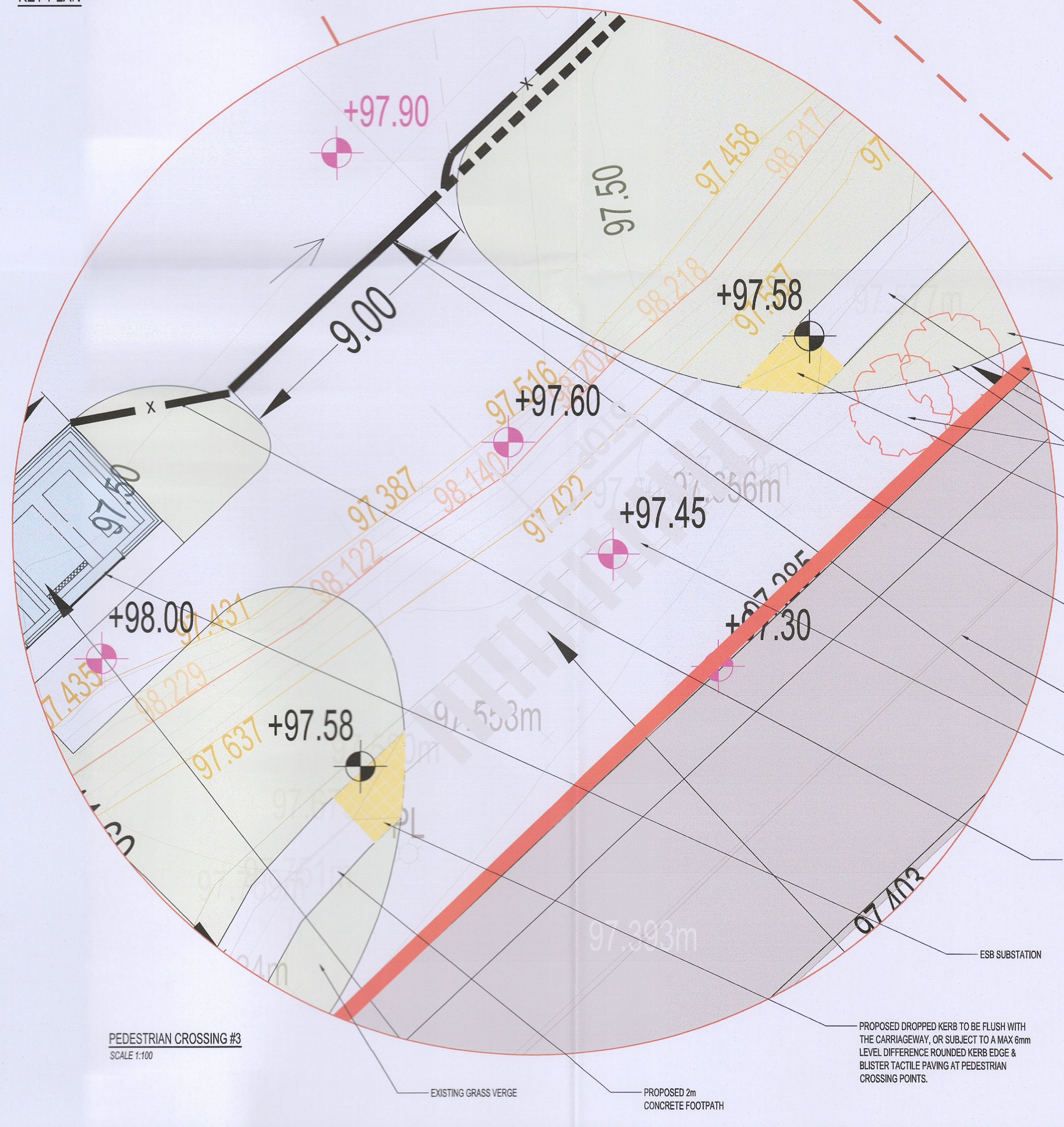

PEDESTRIAN CROSSING #3
SCALE 1:100

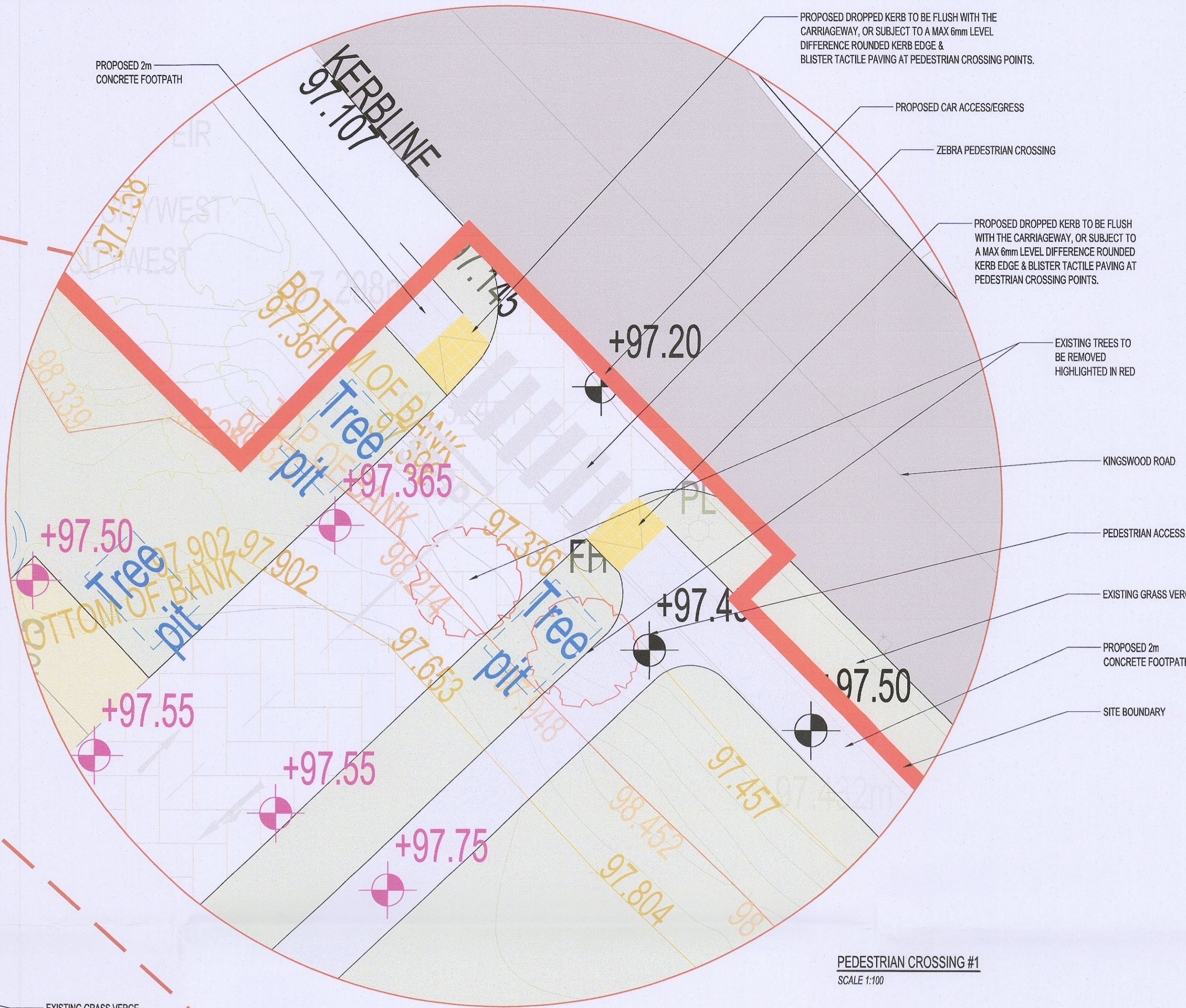

PEDESTRIAN CROSSING #1
SCALE 1:100

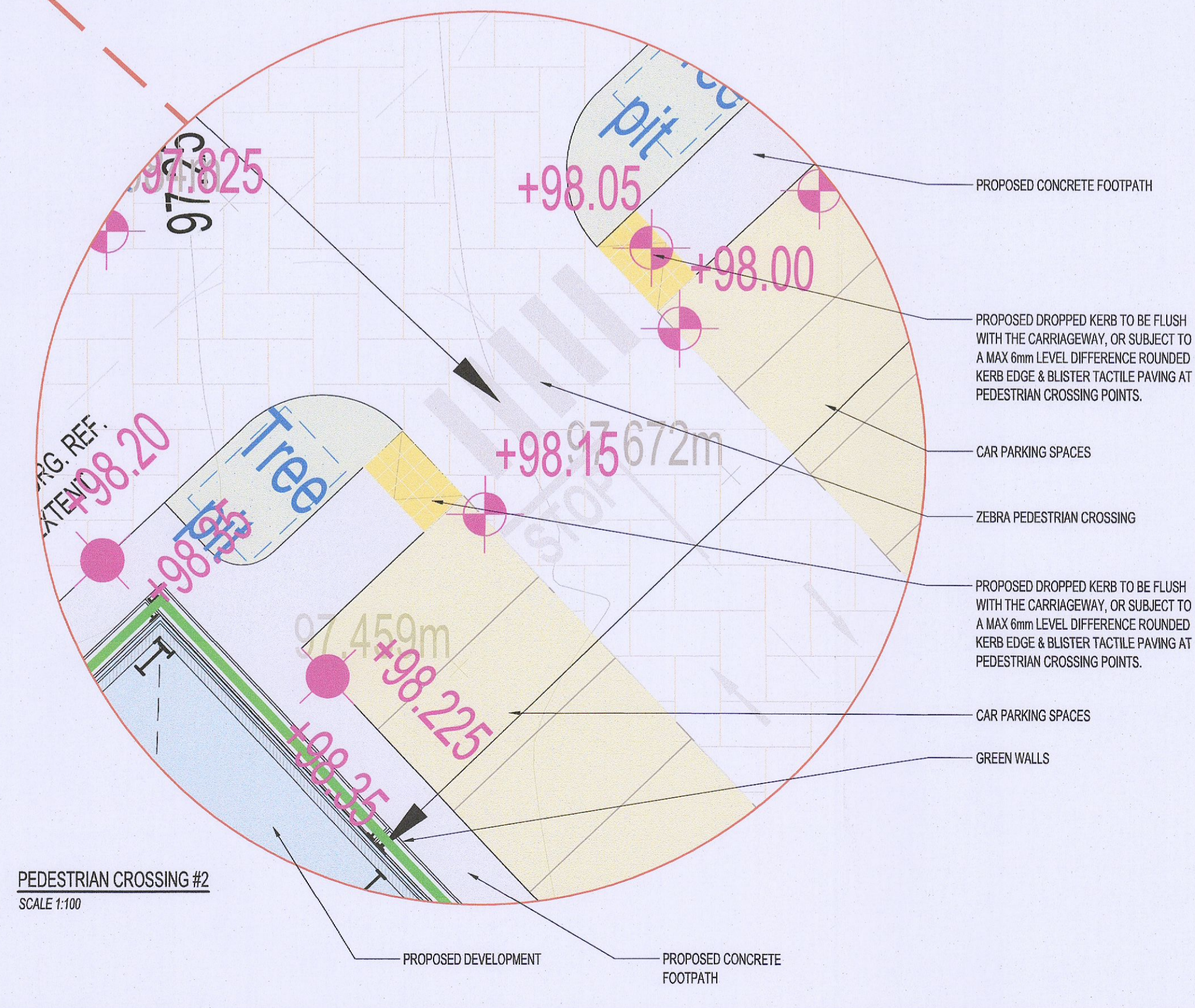

PEDESTRIAN CROSSING #2
SCALE 1:100

LEGEND

- DENOTES PROPOSED CONCRETE FOOTPATH
- DENOTES LANDSCAPING FOR DETAILS REFER TO LANDSCAPE ARCHITECT DRAWINGS AND SPECIFICATIONS
- DENOTES PERMEABLE PAVING FOR DETAILS REFER TO LANDSCAPE ARCHITECT DRAWINGS AND SPECIFICATIONS
- DENOTES GRASSCRETE TO FIRE TENDER ROAD & PARKING SPACES. FOR DETAILS REFER TO LANDSCAPE ARCHITECT DRAWINGS AND SPECIFICATIONS
- DENOTES CONCRETE TO PROPOSED YARD

PL2	24-10-2022	GS	PK	PK	ISSUED FOR PLANNING ADDITIONAL INFORMATION
PL1	27/03/2022	GS	PK	PK	ISSUED FOR PLANNING
Mark	Date	By	Chk	App.	Revision
Drawing Title					
PLANNING (A1)					
Job Title					
WAREHOUSE DEVELOPMENT AT KINGSWOOD ROAD, CITYWEST BUSINESS PARK, DUBLIN 24					
Drawing Title					
PEDESTRIAN CROSSINGS DETAILS					
Address/Client					
ROCKFACE DEVELOPMENTS LTD.					
<p>KAVANAGH BURKE CONSULTING ENGINEERS</p>					
Tel. 01 - 450 0694		Unit F3 Calmount Park, Ballymount, Dublin 12		Fax. 01 - 426 4340	
Email: pkavanagh@kavanaghburke.ie					
Dr	GS	Checked	PK	Approved	PK
Scale	1:100	Date	October 2022		
Job No.	D1736	Drawing No.	D2-1	Rev.	PL2