

Site boundary - total size 63,390m<sup>2</sup>  
Open Green Space 18,270m<sup>2</sup>

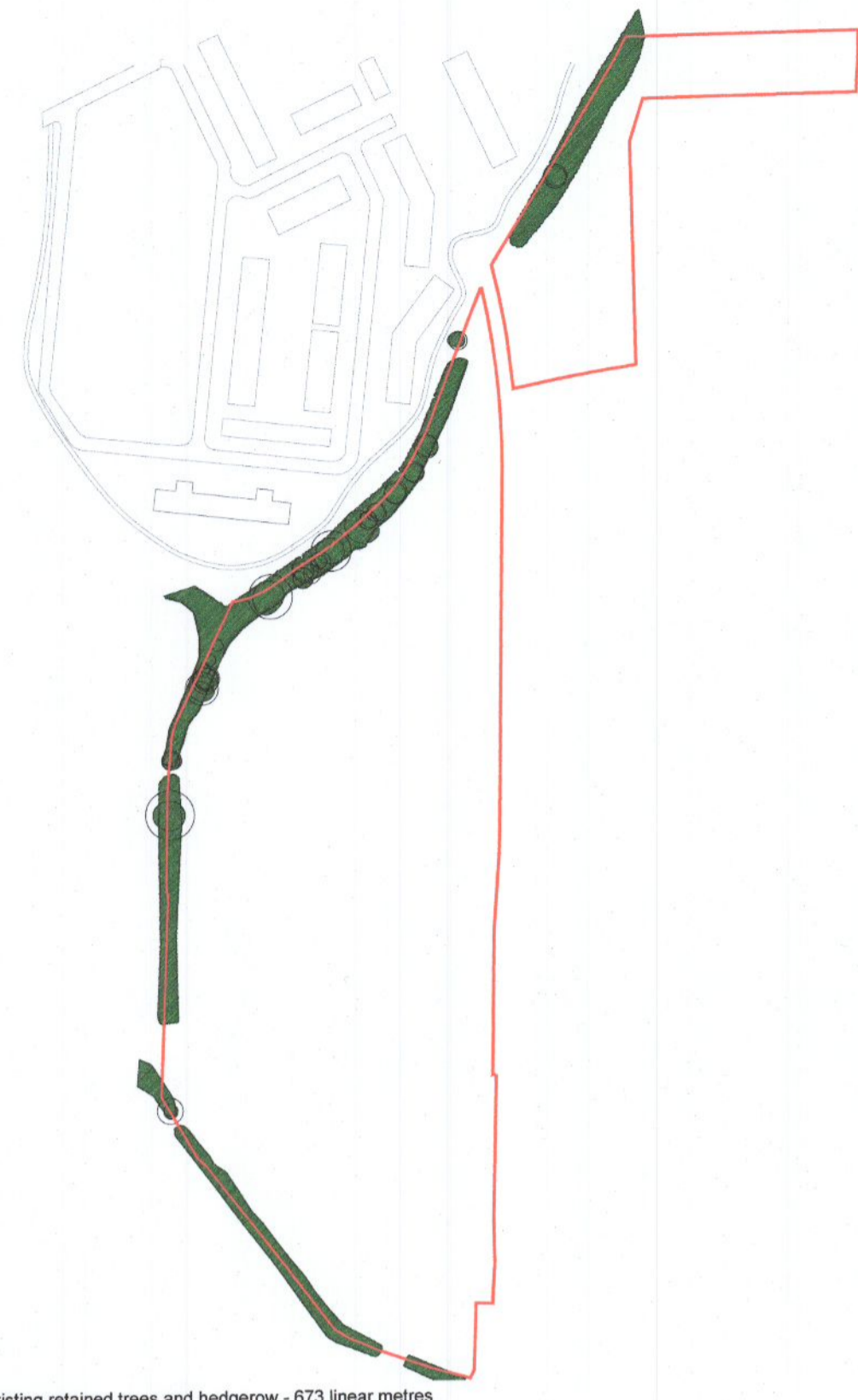

Existing retained trees and hedgerow - 673 linear metres

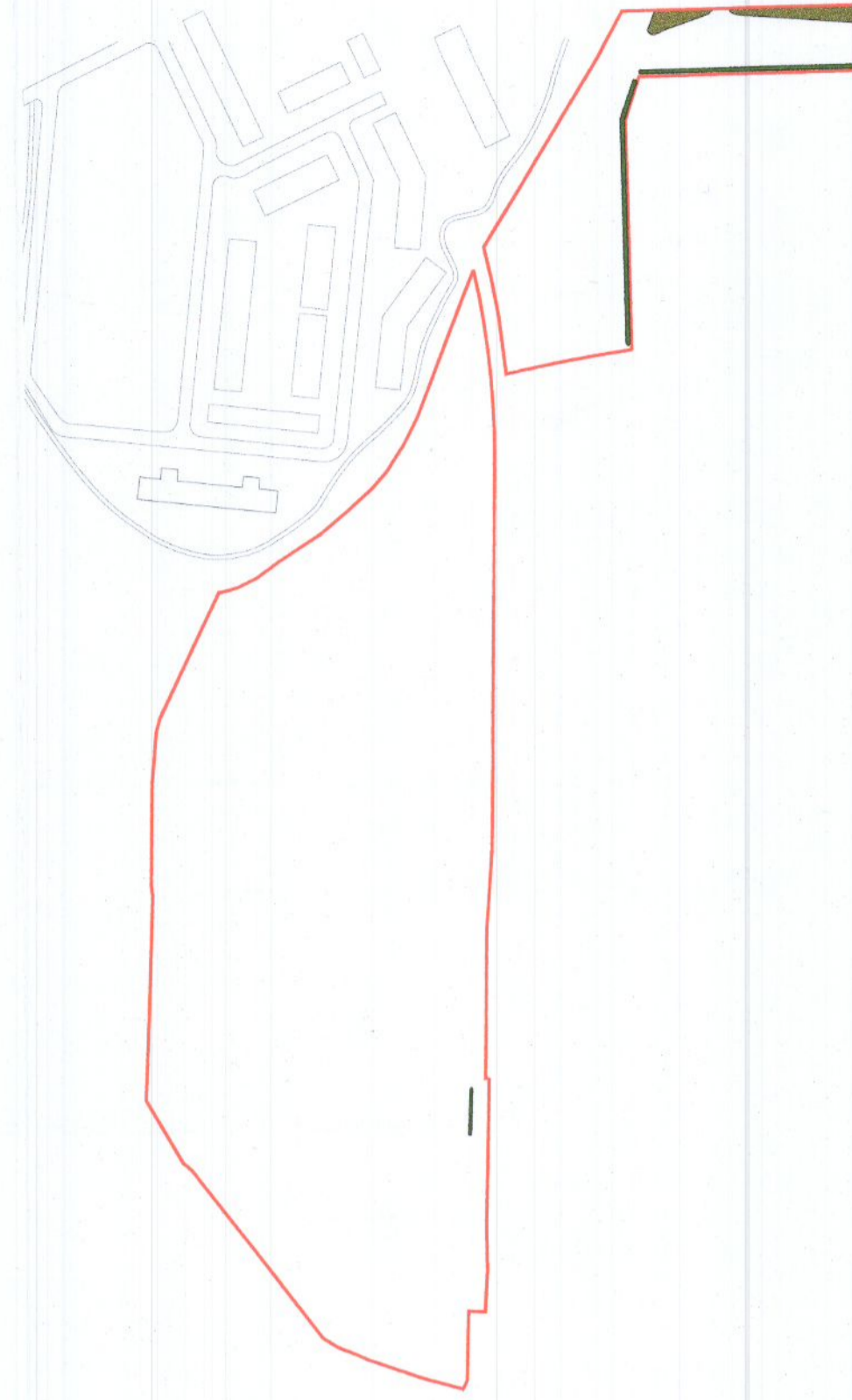

Proposed new native hedge planting 247 linear metres  
Proposed new native woodland planting 500m<sup>2</sup>

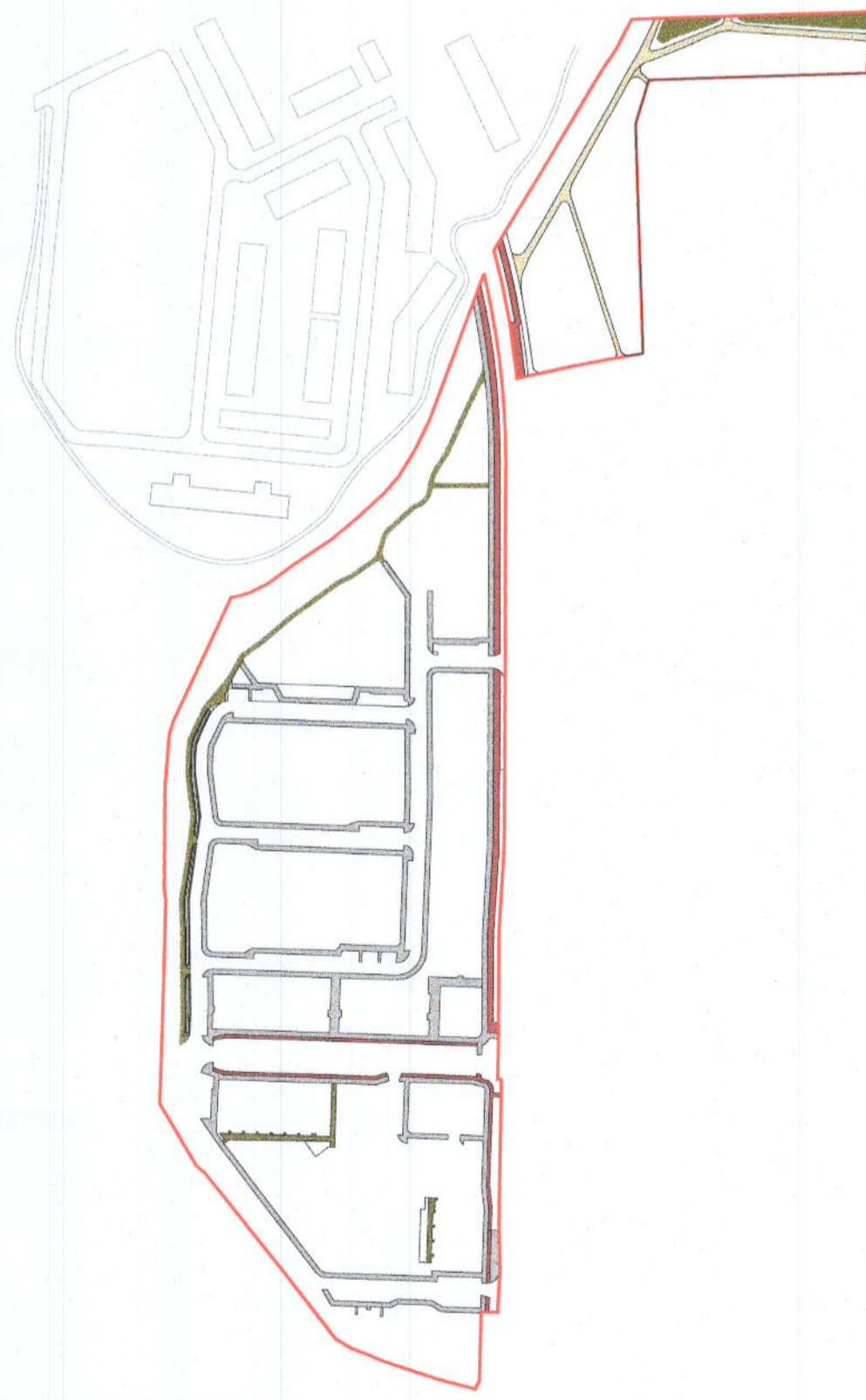

Proposed footpaths 2050 linear metres  
Proposed cycle lanes 686 linear metres

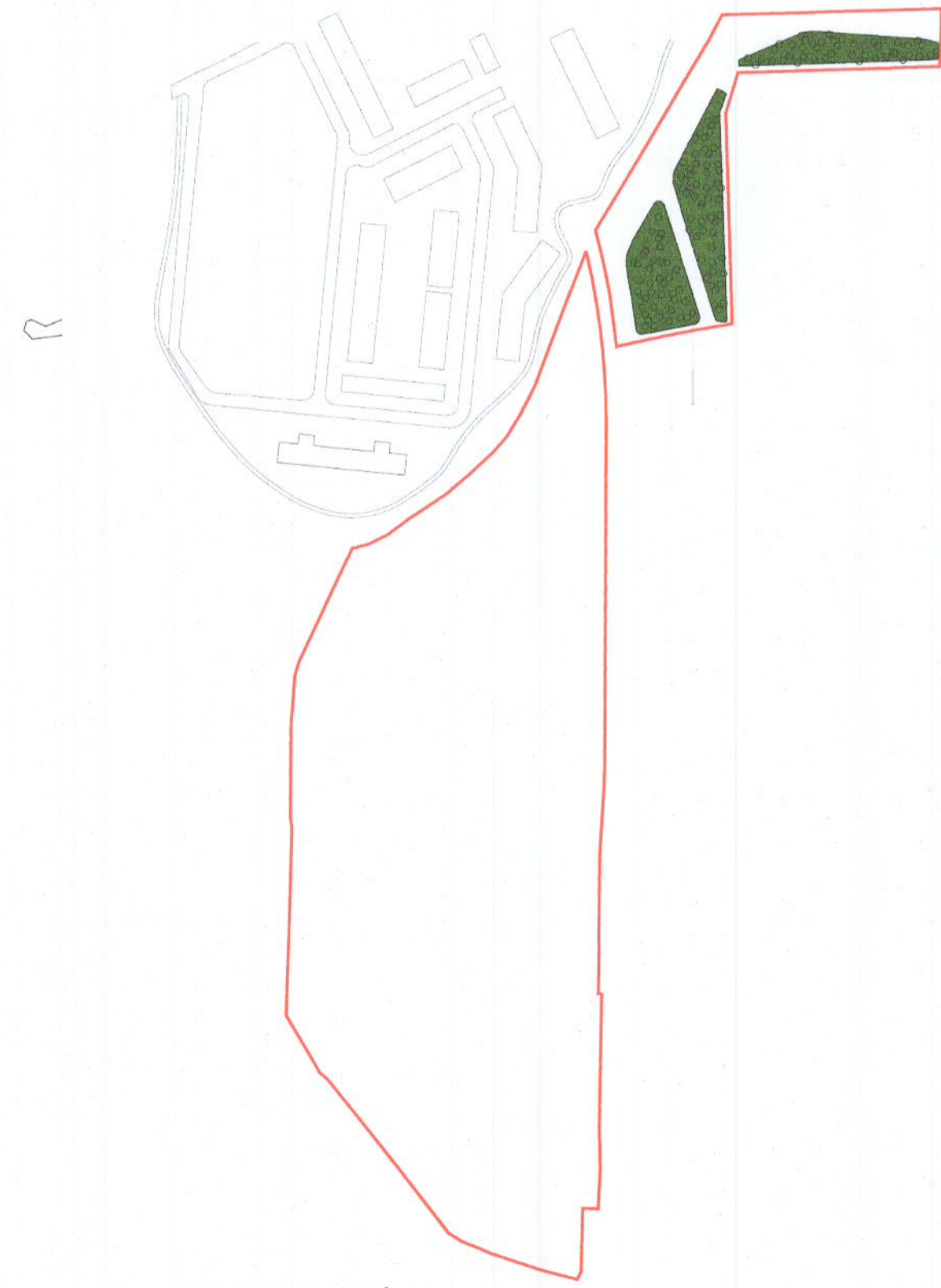

Proposed Miyawaki planting 5163m<sup>2</sup>



Proposed new street trees 161 no.  
Proposed new open space trees 202 no.  
Proposed bio retention tree pits 108 no.  
Proposed swales, total length 150 linear mtrs



Rev.	Date	Note
00	0000-00-00	00

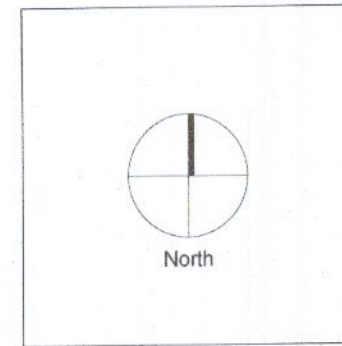

General Notes

**Doyle & O'Troithigh**  
Landscape Architecture

Project Name	Adamstown Aderrig Phase 3	Drawing Name	Green Infrastructure Plan
Status	Planning	Drawing No	GIP-01-PP
Project No	17-064	Revision No	00
Scale	1:1500	Drawn By	KGR
Date	07/10/2022	Checked By	DOT

Linda Doyle  
Director  
+353 (0)87 267 4198  
linda@doyle-otroithigh.com

Daithí O'Troithigh  
Director  
+353 (0)87 322 5439  
daithi@doyle-otroithigh.com

Office Address  
Pembroke House  
28-29 Upper Pembroke St  
Dublin 2

Contact  
mair@doyle-otroithigh.com  
+353 (0)1 459 7762