

- LEGEND**
- SITE BOUNDARY
 - EXIST. STRUCTURES TO BE DEMOLISHED
 - NEW STRUCTURES
 - EXISTING STRUCTURES
 - BUILDINGS ON NEIGHBOURING PROPERTIES
 - PERMEABLE SURFACE AREA
 - HARD SURFACES - OTHER
 - GREENERY - TREES, BUSHES, SHRUBS
 - INDICATIVE PLANNED PRIVATE SEWAGE LINE

P01	24.10.2022	ISSUED FOR PLANNING
NO.	DATE REVISED	DESCRIPTION OF REVISION

CLIENT:
NIALL COX
 18 OWENDORE CRESCENT
 RATHFARNAM, DUBLIN 14

PROJECT NAME AND ADDRESS:
DOMESTIC HOUSE EXTENSION & ALTERATIONS, @ 18 OWENDORE CRESCENT
 18 OWENDORE CRESCENT, RATHFARNAM, DUBLIN 14

ARCHITECT:
NAANarchitects
 17 Glenalua Road, Killiney,
 Co. Dublin,
 tel.: +353 (0) 861779777
 e-mail: info@naanarchitects.com

DRAWING TITLE:
PROPOSED FIRST FLOOR PLAN

DRAWING NO.
128-02-07

SCALE & FORMAT: 1:100 @A3	DATE: 24.10.2022
-------------------------------------	----------------------------

REVISION: P01	PROJECT STATUS: PLANNING
-------------------------	------------------------------------

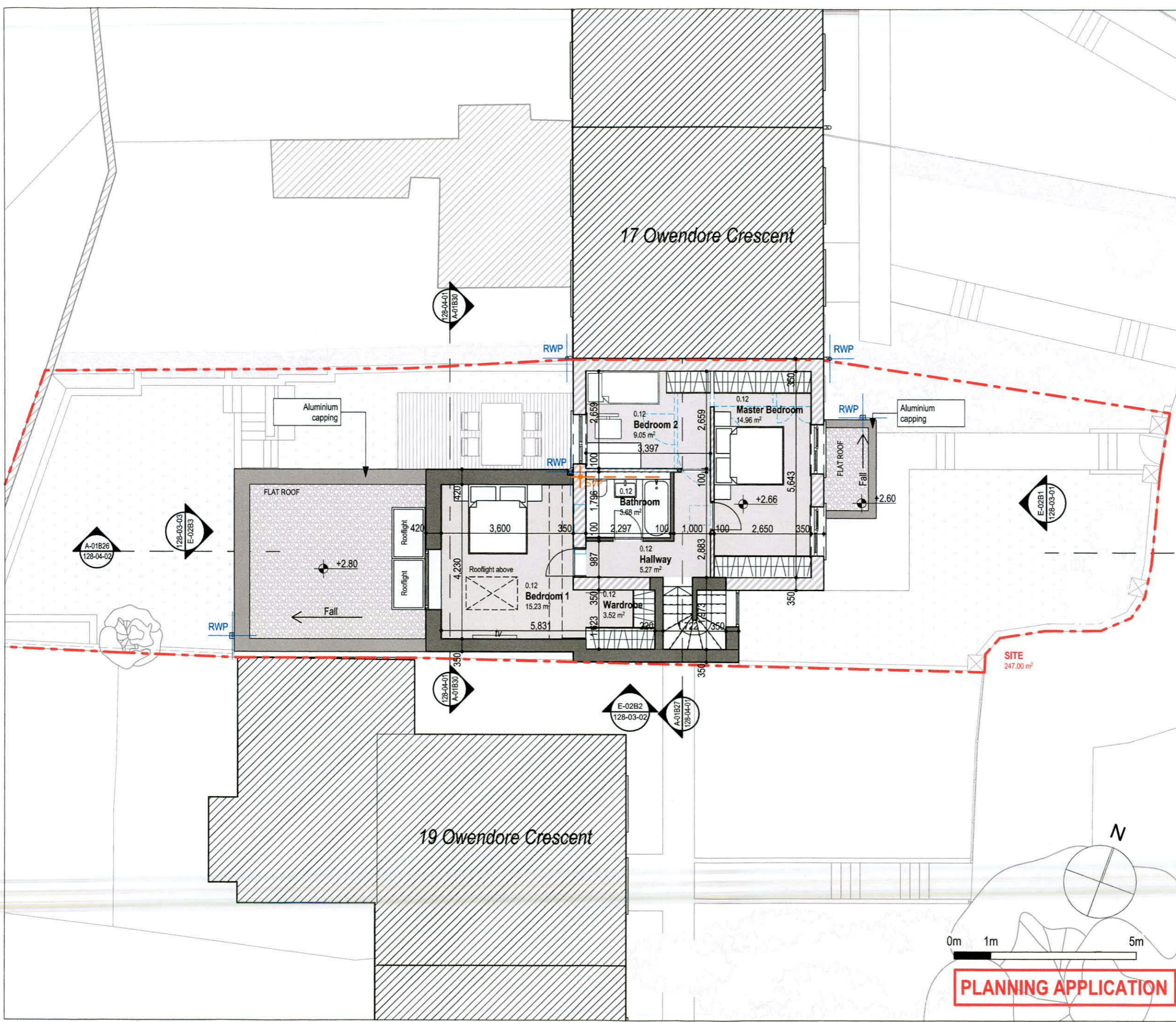

PLANNING APPLICATION