



544

546

545

547

548

549

2.4x33m VISIBILITY SPLAY COMMENSURATE WITH MEASURED SPEEDS TO THE RIGHT ON EXIT TAKING IN EXIT FROM WALKINSTOWN ROUNDABOUT

Ballymount Road Lower

2.4x45m SIGHT LINE TO THE LEFT ON EXIT TAKEN TO THE CARRIAGEWAY CENTRELINE

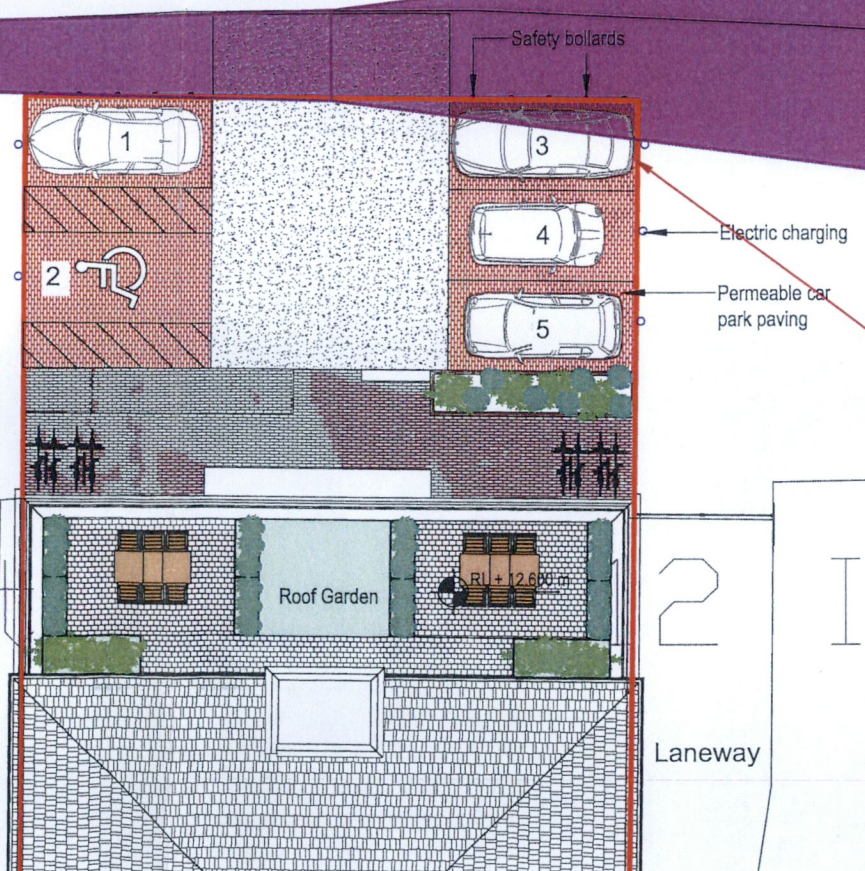

NOTE: PARKING SPACE PARTIALLY IMPINGING UPON SIGHT LINE WHICH IS ALLOWABLE UNDER DMURS SECTION 4.4.5 WHEREBY "Splays should generally be kept free of on-street parking, but flexibility can be shown on lower speed streets with regard to minor encroachments"

Walkinstown\01 - Project 2 Issued\2022

NRB Consulting Engineers Ltd recommend that Road and land ownership boundaries are verified through Legal & Land searches by the Client.

This drawing is based upon architects drawing 21122-MD-SP-00-DR-A-P002_Site Layout Plan received 26/09/22. NRB Consulting Engineers Ltd shall not be liable for any inaccuracies or deficiencies.

NRB Consulting Engineers Ltd
1st Floor, Apollo Building
Dundrum Road
Dundrum
Dublin 14

Phone/Fax: +353 1 292 1941
Email: info@nrb.ie
Web: www.nrb.ie

Registered in Ireland No. 491679



Client	Project No. 22-075	Drawing No. NRB-PA-001
Project Paintworld Dublin	Drawn PB	Checked ER 25/10/22
Title Proposed Development Access DMURS Sightlines	Date 25-Oct-22	Approved ER 25/10/22
NRB Consulting Engineers Ltd accept no responsibility for any unauthorised amendments to this drawing. Only figured dimensions to be worked to.	Purpose of Issue <input type="checkbox"/> Draft <input type="checkbox"/> As Built	Scale @ A3 1:200
	<input type="checkbox"/> Information <input type="checkbox"/> Tender	Rev - <input type="checkbox"/> Approval <input type="checkbox"/> Construction

REV	DATE	AMENDMENTS	DRAWN	CHK	APP
-----	------	------------	-------	-----	-----

COPYRIGHT © RESERVED