

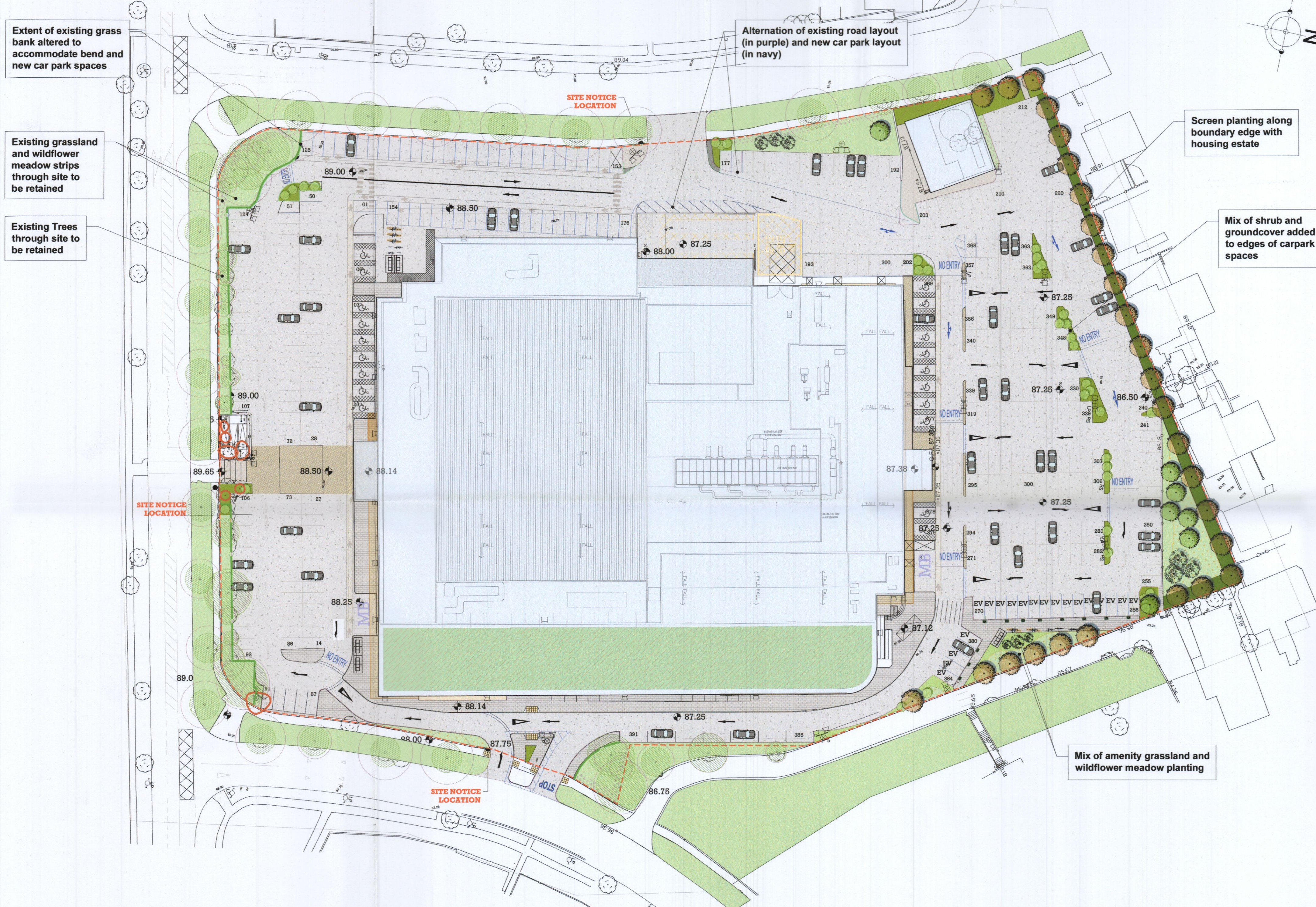

LEGEND

- EXISTING TREES AND SHRUBS TO BE REMOVED
- EXISTING TREES TO BE RETAINED
With ROOT PROTECTION AREA & PROTECTION FENCING
- EXISTING GRASSLAND
- EXISTING WILDFLOWER MEADOW STRIPS
- STREET TREES
- SPECIMEN TREES
- PARKLAND SPECIMEN TREES
- SHRUBS AND GROUND COVER PLANTING
- HEDGE PLANTING
- AMENITY GRASS AREA
- IRISH WILDFLOWER CONSERVATION GRADE SEED MIXTURE
- SEDUM MAT GREEN ROOF SYSTEM
To Architects Spec
- EXISTING CONCRETE BLOCK PAVING
- CONCRETE BLOCK PAVING
SILVER & BLACK GRANITE COLOUR
To Architects Spec
- CAR PARK ASPHALT SURFACE
- EXISTING CONCRETE SURFACE
- EXTENDED CONCRETE SURFACES
To Engineers Spec
- LIGHTING
To Engineers Spec
- SITE BOUNDARY



- GENERAL NOTES:**
- a. To be read in conjunction with all other drawings.
 - b. Do not scale off drawing. Refer to dimensions given.
 - c. This drawing is for planning purposes only.
 - d. All products are as indicated or equivalent.

B 25/10/22 Parking Layout Updated RF
 A 26/7/22 Parking Layout Updated
 REV DATE AMENDMENT

CUNNANE STRATTON REYNOLDS
LAND PLANNING & DESIGN

DUBLIN OFFICE
 3 MOLESWORTH PLACE DUBLIN 2
 TEL 01 661 0419 FAX 01 661 0431
 EMAIL info@csrlandplan.ie



SPECIES	SIZE	SPACING	%
PROPOSED STREET TREES - All trees to have straight, unsupported leaders with symmetrical crowns.			
<i>Carpinus betulus</i> 'Fastigiata' 1.8m clear stem	18-20cm girth, std.,RB	as shown	30
<i>Pyrus calleryana</i> 'Chanticleer' 1.8m clear stem	18-20cm girth, std.,RB	as shown	40
<i>Acer platanoides</i> 'Emerald Queen'	18-20cm girth, std.,RB	as shown	30
PROPOSED SPECIMEN TREES - All trees to have straight, unsupported leaders with symmetrical crowns.			
<i>Malus tschonski</i>	16-18cm girth, std.,RB	as shown	30
<i>Amelanchier arborea</i> 'Robin Hill'	16-18cm girth, std.,RB	as shown	20
<i>Sorbus aucuparia</i>	16-18cm girth, std.,RB	as shown	20
PROPOSED PARKLAND SPECIMEN TREES - All trees to have straight, unsupported leaders with symmetrical crowns.			
<i>Betula pendula</i>	16-18cm girth, std.,RB	as shown	70
<i>Alnus glutinosa</i>	16-18cm girth, std.,RB	as shown	30

SPECIES	SIZE	SPACING	%
GROUNDCOVERS AND ORNAMENTALS - mass plant in blocks of same species - block areas range from 5-15m2.			
<i>Euonymus fortunei</i>	5L, PG	4/m2	10
<i>Calamagrostis x acutiflora</i> 'Karl Foerster'	2L, PG	4/m2	5
<i>Lavandula angustifolia</i> 'Hidcote'	2L, PG	7/m2	10
<i>Viburnum davidii</i>	5L, PG	4/m2	10
<i>Pachysandra terminalis</i> 'Green Carpet'	2L, PG	6/m2	10
<i>Hypericum hookerianum</i> 'Hidcote'	3L, PG	2/m2	10
<i>Viburnum x burkwoodii</i>	3L, PG	2/m2	5
<i>Ilex aquifolium</i>	3L, PG	2/m2	10
<i>Hypericum hidcote</i>	3L, PG	4/m2	10
<i>Viburnum opulus</i> 'Compactum'	5L, PG	3/m2	5
<i>Fuchsia magellanica</i> 'Riccartonii'	5L, PG	2/m2	5
<i>Aucuba japonica</i> 'Variegata'	5L, PG	2/m2	5
<i>Cercis canadensis</i> 'Forest Pansy'	90-120cm ht, PG	1/m2	5

SPECIES	SIZE	SPACING	%
HEDGE PLANTING			
<i>Prunus lusitana</i>	60-80cm high PG	5/lin m	20
<i>Viburnum opulus</i> 'Roseum'	60-80cm high PG	5/lin m	20
<i>Fagus sylvatica</i>	90-120cm high PG	5/lin m	60
WILDFLOWER PLANTING MIX - wildflower seed mixes to be comprised of native species collected and grown on the island of Ireland. Wildflower seed mix to include:			
<i>Lotus corniculatus</i>			
<i>Ajuga reptans</i>			
<i>Primula veris</i>			
<i>Taraxacum officinale</i>			
<i>Veronica chamaedrys</i>			
<i>Campanula rotundifolia</i>			
<i>Trifolium pratense</i>			
<i>Trifolium repens</i>			
<i>Thymus serpyllum</i>			

SPECIES	SIZE	SPACING	%
AMENITY GRASS - Repair grass areas following works.			
80%Fescue sp. 20% Brown bent top			
RB = Rootball, BR = Bare root, std. = standard, ftd. = feathered			

PROJECT:	DATE:	JULY 2022
Dunnes Stores Kilnamanagh SC Extension, D24	SCALE:	1:500 @ A1
DRAWING:	DRAWN:	HT
Landscape Masterplan	CHECKED:	RF
DRAWING NO:	22146-2-100	