

This drawing is to be read in conjunction with the respective arboricultural schedules and reports relevant to this project.
 Where contradictions between this drawing and any other design information becomes apparent, the respective authors should be contacted immediately.
 It is the responsibility of the main site contractor to check and verify all information and measurements onsite and confirm prior to the commencement of works, and to ensure that all site operatives work in accordance with respective arboricultural reports and BS5837:2012. Trees in relation to design, demolition and construction.

- BS5837:2012 Tree Categorisation**
- Category A**
Trees of high quality with an estimated remaining life expectancy of at least 40 years
 - Category B**
Trees of moderate quality with an estimated life expectancy of at least 20 years
 - Category C**
Trees of low quality with an estimated life expectancy of at least 10 years, or young trees with a stem diameter below 150mm
 - Category U**
Those in such a condition that they cannot realistically be retained as living trees in the context of the current land use for longer than 10 years

- Key**
- Tree, Shrub or Hedgerow Group.
 - T2** Reference Number for Tree, Group or Hedgerow.
 - Tree Protection Zone - Protective fencing to be installed as per Specification. Designated Construction Exclusion Zone.
 - Existing boundary to be retained and protect neighbouring trees.
 - Area of existing hard standing. No excavation beyond existing sub-base layer.
 - Site boundary.

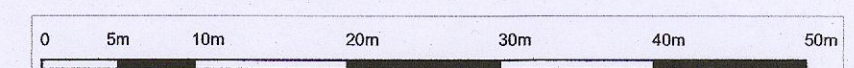

Revision	Date	Description
Title: Tree Protection Plan		
Project: Lands at Kingswood Truck Wash		
Client: Bradawl Limited		
Date: Aug 2022	Scale: 1:500 @ A1	Status: Planning
Drawn by: CMcC	Dwg ref: 220728-P-11	Rev: -
Checked by: CMcC		

This drawing is the copyright of Charles McCorkell Arboricultural Consultancy has been produced for the client and project as stated above. The drawing may not be reproduced or amended, except by the written permission of Charles McCorkell Arboricultural Consultancy. No liability will be accepted for any amendments made by other persons. ©

CHARLES MCCORKELL
ARBORICULTURAL CONSULTANCY

T: 085 843 7015 / E: charles@cmarbor.com / W: www.cmarbor.com

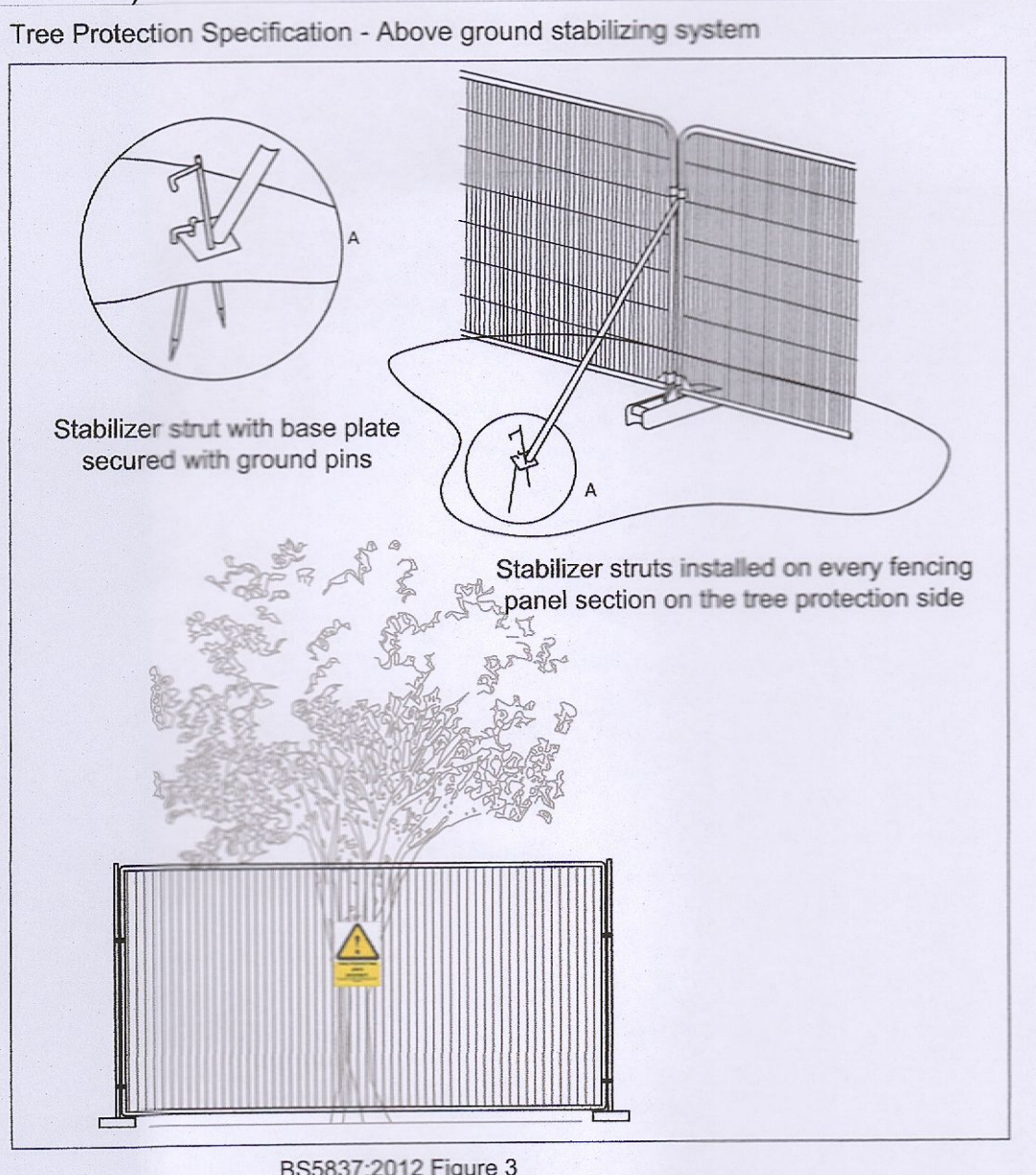

Additional Information Point 3 (a)(b)(c) - Planning Reference: SD22A/0150