

Surveyed 1977  
 Revised 2015  
 Levelled 1993

# Urban PLACE Map



ITM CENTRE PT COORDS  
 713366, 728886

**DESCRIPTION**

**MAP SHEETS**

1:1000  
 3391-02



Area shown does not include any Subdivided Ordnance  
 Control, Part of Ordnance Survey, Ordnance Survey  
 Ireland, Ordnance Survey, Dublin, Ireland.

OSi is a registered trademark of Ordnance Survey Ireland  
 Ordnance Survey Ireland is a registered trademark of  
 Ordnance Survey Ireland.

Each used as a resource. No trademark or other  
 indication is made of any other person's name or  
 business or of any other person's name or business  
 or of any other person's name or business.

OSi is a registered trademark of Ordnance Survey  
 Ireland. OSi is a registered trademark of Ordnance  
 Survey Ireland. OSi is a registered trademark of  
 Ordnance Survey Ireland.

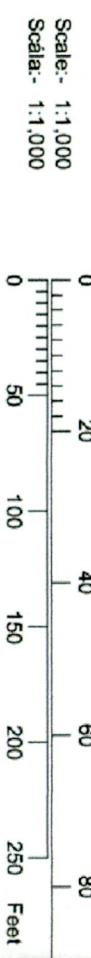
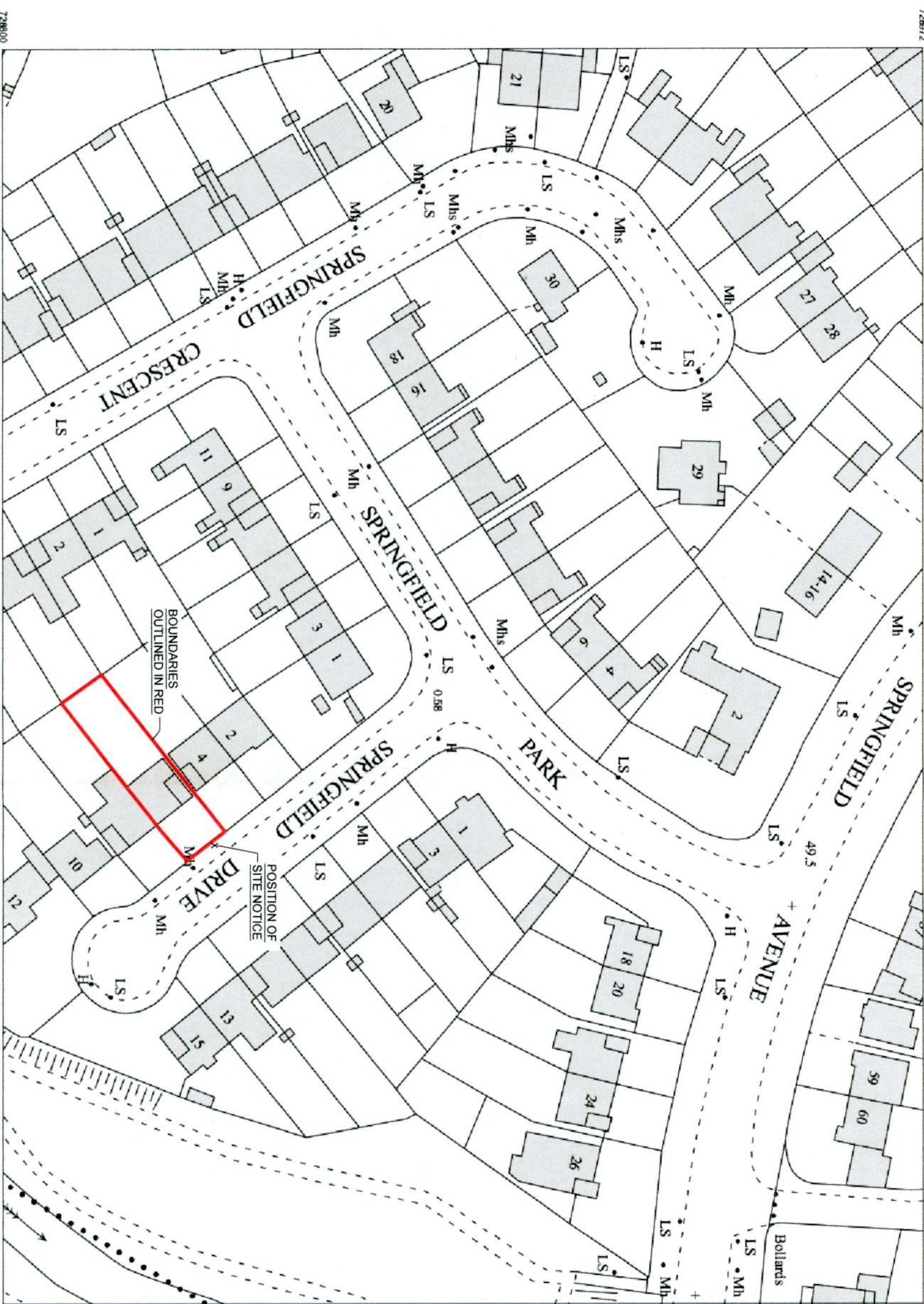

Plot Ref: No. 19721142\_1\_1  
 Plot Date 25-JUL-2016

**NOTES / LEGEND**  
 SITE BOUNDARY  
 OUTLINED IN RED

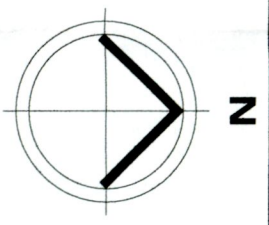

**ORDNANCE SURVEY MAP**

Revision	Date	Description	By

© Ordnance Survey Ireland, 2016  
 Ordnance Survey Map

# CEARDEAN

architects

Client: WALL & UNA MERRIMAN  
 Project: 6 SPRINGFIELD DRIVE, TEMPLEogue DUBLIN  
 Drawing: Ordnance Survey Map  
 Date: 03.10.22  
 Scale: 1:1000  
 Size: A3  
 Sheet: 1B  
 Title: A  
 Date: 22015  
 Scale: 0,000  
 Date: 00