

Existing Rear/West Elevation C-C 1:100

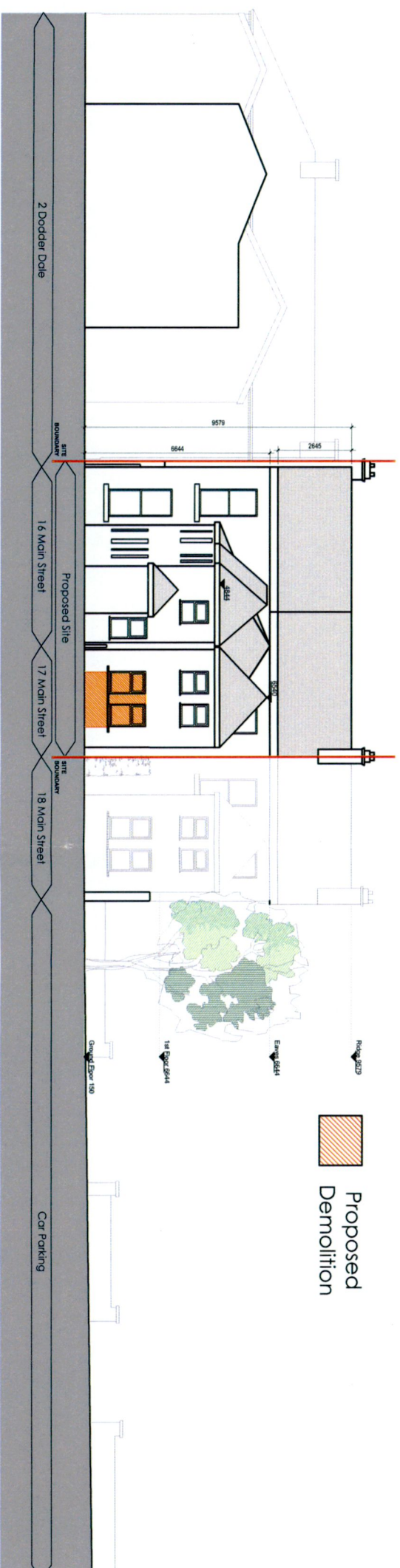

Existing Rear/West Context Elevation C-C 1:200

Proposed Demolition

Proposed Demolition

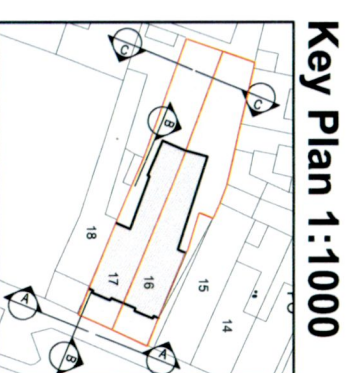

Key Plan 1:1000

Revisions

No.	Description	Date
1	Issue for Planning	22-01-6-P-2.005
2	Issue for Planning	22-01-6-P-2.005
3	Issue for Planning	22-01-6-P-2.005
4	Issue for Planning	22-01-6-P-2.005
5	Issue for Planning	22-01-6-P-2.005
6	Issue for Planning	22-01-6-P-2.005
7	Issue for Planning	22-01-6-P-2.005
8	Issue for Planning	22-01-6-P-2.005
9	Issue for Planning	22-01-6-P-2.005
10	Issue for Planning	22-01-6-P-2.005

This work is copyright and can not be reproduced or copied in any form without the prior written permission of the author. The author is not responsible for any errors or omissions in this document. The author is not responsible for any damage or loss of any kind resulting from the use of this document. The author is not responsible for any damage or loss of any kind resulting from the use of this document.

**DPA**  
 Design & Planning  
 Architects & Planners  
 CONSULTANTS

62 Brighton Square, Rathgar,  
 Dublin 6, D06A T1Z9  
 Tel: +353 (0)1 480 0499  
 Email: info@dsearch.ie  
 Web: www.dsearch.ie

**RIAI**  
 The Royal Institute of Architects in Ireland

NO.	DATE	DESCRIPTION	BY	CHECKED
1	22-01-6-P-2.005	EXISTING REAR/WEST ELEVATION	LM	LM

PLANNING  
 PROPOSED CHANGE OF USE AT 17 MAIN STREET  
 MATYKABNAKA  
 22-01-6-P-2.005  
 SEP 22