









- LEGEND:**
-  100MM DIA SURFACE DRAIN PERFORMED FOR FULL LENGTH OF AVENUE
 -  100MM DIA FOUL DRAIN
 -  PIPED SUPPLY & IN-LINE FILTER
 -  EXISTING COMBINED DRAIN
 -  25mm DIA GREY WATER SUPPLY
 -  NEW SOAKAWAY TO COMPLY WITH BRE DIGEST 365
 -  PERMEABLE PAVING
 -  250L RAIN WATER BUTT FITTED TO RWP WITH TAP CONNECTION & OVERFLOW TO GULLY TRAP



Revisions:

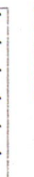

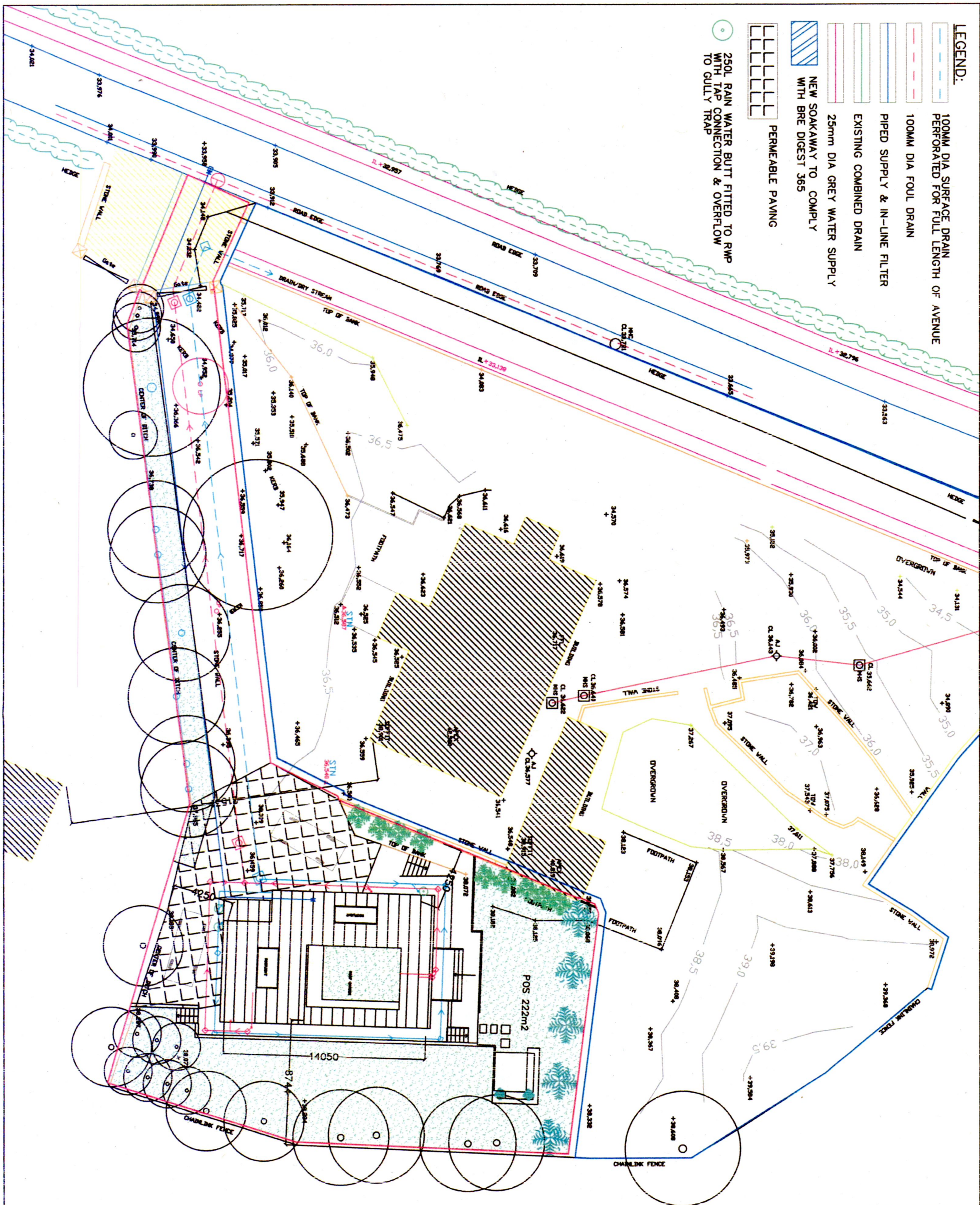
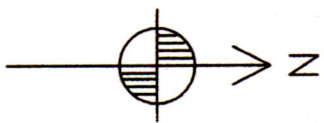
PREPARED FOR THE PURPOSES OF
PLANNING

ONLY

ANNE MANN ARCHITECTS LIMITED
 (INCORPORATED IN IRELAND)
 9A Wood Farm Drive,
 Palmrestown, Dublin 20.
 Tel: (01) 6237922 Mob: 087 623 9194
 E-Mail: architect@annemannarch.com

Project:
 DETACHED DWELLING HOUSE,
 GREENWAYS, TUBBER LANE ROAD
 LUCAN,
 Co. DUBLIN, K78 P5V3.

Drawing name:
 PROPOSED
 DRAINAGE LAYOUT

Scale:	1:250	Date:	01.06.2022
Rev:	A3	Drawn by:	AM

Drawing No:
 21.159.PL.07