



**GENERAL NOTES:**

1. ALL ARCHITECTURAL DRAWINGS ARE TO BE READ IN CONJUNCTION WITH ODA ARCHITECTURE SPECIFICATIONS. THE CONTRACTOR SHALL NOTIFY THE ARCHITECT OF ANY DISCREPANCIES BETWEEN THE DRAWINGS AND THE SPECIFICATION BEFORE IMPLEMENTING THE WORK.
2. NO DIMENSIONS SHALL BE SCALED FROM THIS DRAWING. ALL DIMENSIONS AND SETTING OUT CO-ORDINATES SHALL BE CONFIRMED ON SITE PRIOR TO CONSTRUCTION.
3. THE CONTRACTOR SHALL NOTIFY THE ARCHITECT OF ANY DISCREPANCIES BETWEEN (A) THE ARCHITECTURAL PLANS, SECTIONS AND ELEVATIONS AND (B) THE ARCHITECTURAL DRAWINGS AND THOSE OF THE ENGINEER BEFORE IMPLEMENTING THE WORK.

**LEGEND**

- Site boundary
- ▨ Demolition / removal works
- Existing Surface Water Mains
- Existing Water Mains
- Existing Sewer Mains

**DEMOLITIONS SCHEDULE:**

GROUND FLOOR:	AREA	AREA (m <sup>2</sup> )
WAREHOUSE	218 m <sup>2</sup>	
ANCILLARY OFFICE ACCOMMODATION	156 m <sup>2</sup>	
FIRST FLOOR:		
ANCILLARY OFFICE ACCOMMODATION	85 m <sup>2</sup>	
CURTAIN SIDED STORAGE RACK NO 1	23 m <sup>2</sup>	
CURTAIN SIDED STORAGE RACK NO 2	23 m <sup>2</sup>	
<b>TOTAL</b>	<b>505 m<sup>2</sup></b>	

**REVISED**

rev.	date	description	dwn by	chkd by
F	20.09.2022	Issued for Planning	MP	COD
E	19.09.2022	survey update	MP	COD
D	13.09.2022	Issued for information	MP	COD
C	08.08.2022	Issued for information	SA	COD
B	30.05.2022	Issued for information	MP	COD
A	25.02.2022	Issued for information	MP	COD

client: **JFK Environmental Ltd.**

job description: **Proposals for Commercial Development John F Kennedy Industrial Estate**

drawing title: **Existing Site Plan Proposed demolitions area**

drawn by	date	scale
MP	August 2022	A1 - 1:250
COD		A3 - 1:500

media	drawing no	rev
PLANNING	B0125-A-002	F



maiborough mews maiborough lane dublin 4 ireland  
 353 1 441 6423  
 info@odaarchitecture.ie www.odaarchitecture.ie

No part of this drawing may be reproduced or transmitted in any form or stored in any retrieval system of any nature without the written permission of ODA Architecture as copyright holder except as agreed for use on the project for which the document was originally issued.

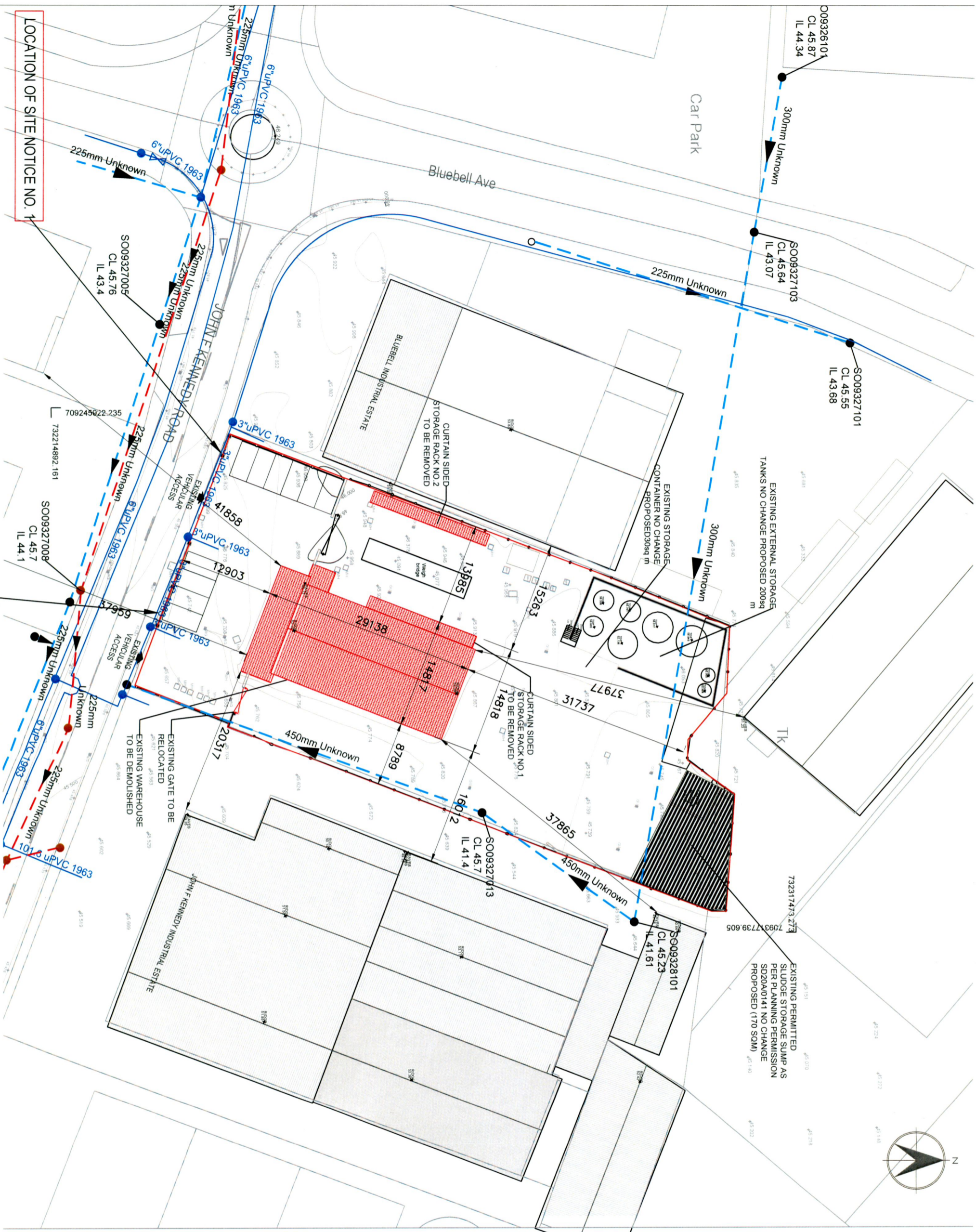

1 EXISTING SITE PLAN (PROPOSED DEMOLITION)  
 SCALE 1:500@A3

LOCATION OF SITE NOTICE NO. 1

LOCATION OF SITE NOTICE NO. 2