

GENERAL NOTES:
 DO NOT SCALE. USE FIGURED DIMENSIONS ONLY.
 ALL DIMENSIONS & LEVELS IN MILLIMETERS.
 ALL DIMENSIONS TO BE CHECKED ON SITE.
 THIS DRAWING TO BE READ IN CONJUNCTION WITH
 ALL RELEVANT DRAWINGS & SPECIFICATIONS.
 IN THE EVENT OF ANY DISCREPANCIES BETWEEN
 DRAWINGS INFORM THE ARCHITECT IMMEDIATELY.
 © COPYRIGHT - THIS DRAWING IS THE PROPERTY OF
 ARGO DEVELOPMENT STUDIO AND IS NOT TO BE
 REPRODUCED OR DISTRIBUTED WITHOUT PERMISSION.

PROJECT
 1A The Crescent, Coolfinagh, Lucan,
 Co. Dublin, K78 K786

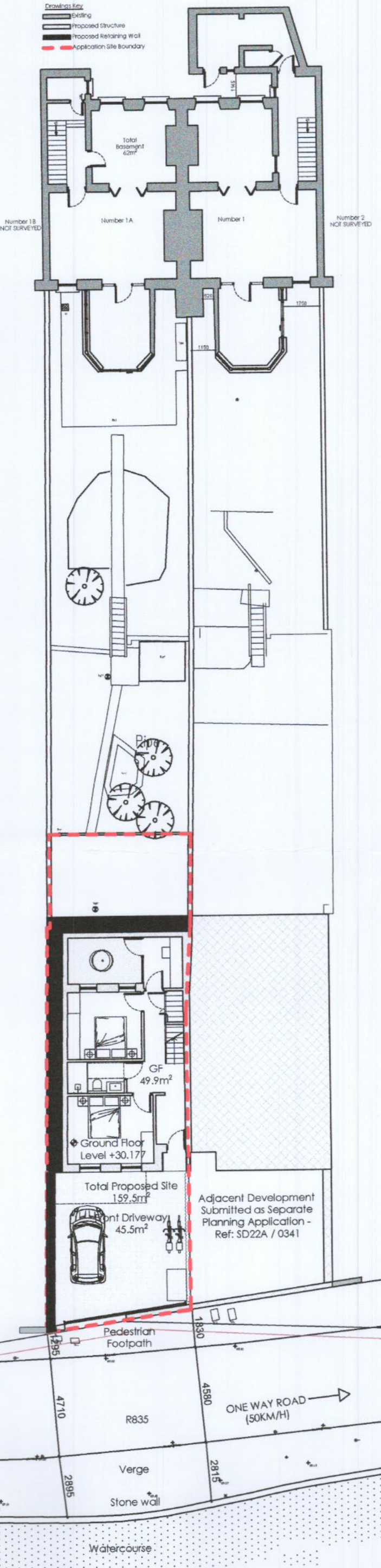

Proposed AREA'S of Proposed Dwelling

| AREA SCHEDULE | m ² |
|---|---------------------------|
| Site | 159.5m ² |
| Front Driveway | 45.5m ² |
| GROUND FLOOR | 49.9m² |
| Storage | 1.2m ² |
| Foyer / Corridor | 12.4m ² |
| Bedroom 1 | 13.5m ² |
| Bathroom | 4.1m ² |
| Bedroom 2 | 11.5m ² |
| Office | 4.6m ² |
| Courtyard | 7.8m ² |
| FIRST FLOOR | 51.2m² |
| Corridor | 7.2m ² |
| Toilet | 2.9m ² |
| Kitchen / Living / Dining Room | 37m ² |
| Balcony | 6.6m ² |
| SECOND FLOOR | 52.3m² |
| Corridor | 7.2m ² |
| Storage Room | 2.8m ² |
| Master Bedroom | 18.6m ² |
| En-suite | 5.5m ² |
| Walk-in | 5.5m ² |
| Office / Storage | 7.4m ² |
| Terrace | 7.4m ² |
| ROOF TERRACE | 53.5m² |
| Total Internal space | 153.4m² |
| Total storage space | 9.5m² |
| Total external private space without the balcony and front drive | 68.7m² |
| Front Drive | 45.5m² |

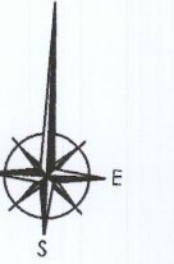

| REVISION | DESCRIPTION | DATE |
|----------|-------------|------|
| | | |
| | | |
| | | |
| | | |
| | | |
| | | |
| | | |
| | | |
| | | |
| | | |
| | | |
| | | |
| | | |
| | | |
| | | |
| | | |
| | | |
| | | |
| | | |
| | | |
| | | |
| | | |
| | | |
| | | |
| | | |
| | | |
| | | |
| | | |

Proposed Site Plan
 Scale 1:200

ARGO
 development studio

DRAWING PLANNING PERMISSION
 STATE:

CLIENT: Slobhan and Dominic Muller

DRAWING: Number 1A - Proposed Site
 Plans 1:200

DRAWN BY: KB CHECKED BY: AC DATE: July 22

PROJECT CODE: 00315 SCALES: 1:200

DRAWING NO: 00315-P-0003 REV: