

new conc. tile finished roof to match existing on 50mm x 25mm timber battens on Roofshields breather membrane on 44mm x 175mm C16 rafters, collars and ceiling joists @ 400mm c/c with 150mm rigid insulation between rafters with 100mm x 75mm timber wall plates on dpc strapped to new structure. 5lb lead flashing

new conc. tile finished hipped roof to match existing on 50mm x 25mm timber battens on Roofshields breather membrane on 44mm x 175mm C16 rafters, collars and ceiling joists @ 400mm c/c with 150mm rigid insulation between rafters with 100mm x 75mm timber wall plates on dpc strapped to new structure. 5lb lead flashing

new conc. tile finished hipped roof to match existing on 50mm x 25mm timber battens on Roofshields breather membrane on 44mm x 125mm C16 rafters, collars and ceiling joists @ 400mm c/c with 150mm rigid insulation between rafters with 100mm x 75mm timber wall plates on dpc strapped to new structure. 5lb lead flashing

double glazed thermally broken alum. / pvc window and screens (to detail) on presact concrete cills with dpc below and behind, 25mm insulation behind cills.

marine ply soffit painted.

new external wall construction : 19mm sand and cement render finish painted, 215mm hollow conc. blockwork, dry lined internally with 42.5 EXTHERM XT/ TL insulated plasterboard and skim finish throughout (u value = 0.16).

load bearing timber stud partitions constructed in 100mm x 44mm timber studs @ 300mm c/c complete with double sole and header timbers and bridging at 1/3 height with 12.5mm plasterboard and plaster skim each pace.

selected t&g timber flooring on 225mm x 44mm sc c16 timber joists @ 400mm c/c supported on galv. steel joist hangers . plasterboard and skim to underside.

double glazed thermally broken alum. / pvc window and screens (to detail) on presact concrete cills with dpc below and behind, 25mm insulation behind cills . patent plaster reveal painted.

smooth plaster plinth painted.

FGL 99.85

FGL 99.85

300mm solid concrete blockwork rising walls on 1000mm x 300mm rc strip foundations to structural engineers details and specifications.

selected floor finish on 150mm concrete floor slab (c25/30) with A193 mesh with patent under floor heating system on 100mm Extratherm XT/UF rigid insulation (u=0.15) on radon barrier on 50mm sand blinding on well compacted hardcore. provide radon sump in hardcore.

RADON SUMP

provide 400mm x 400mm paving slabs to areas as indicated on 50mm sand on 150mm blinded and well consolidated hardcore..

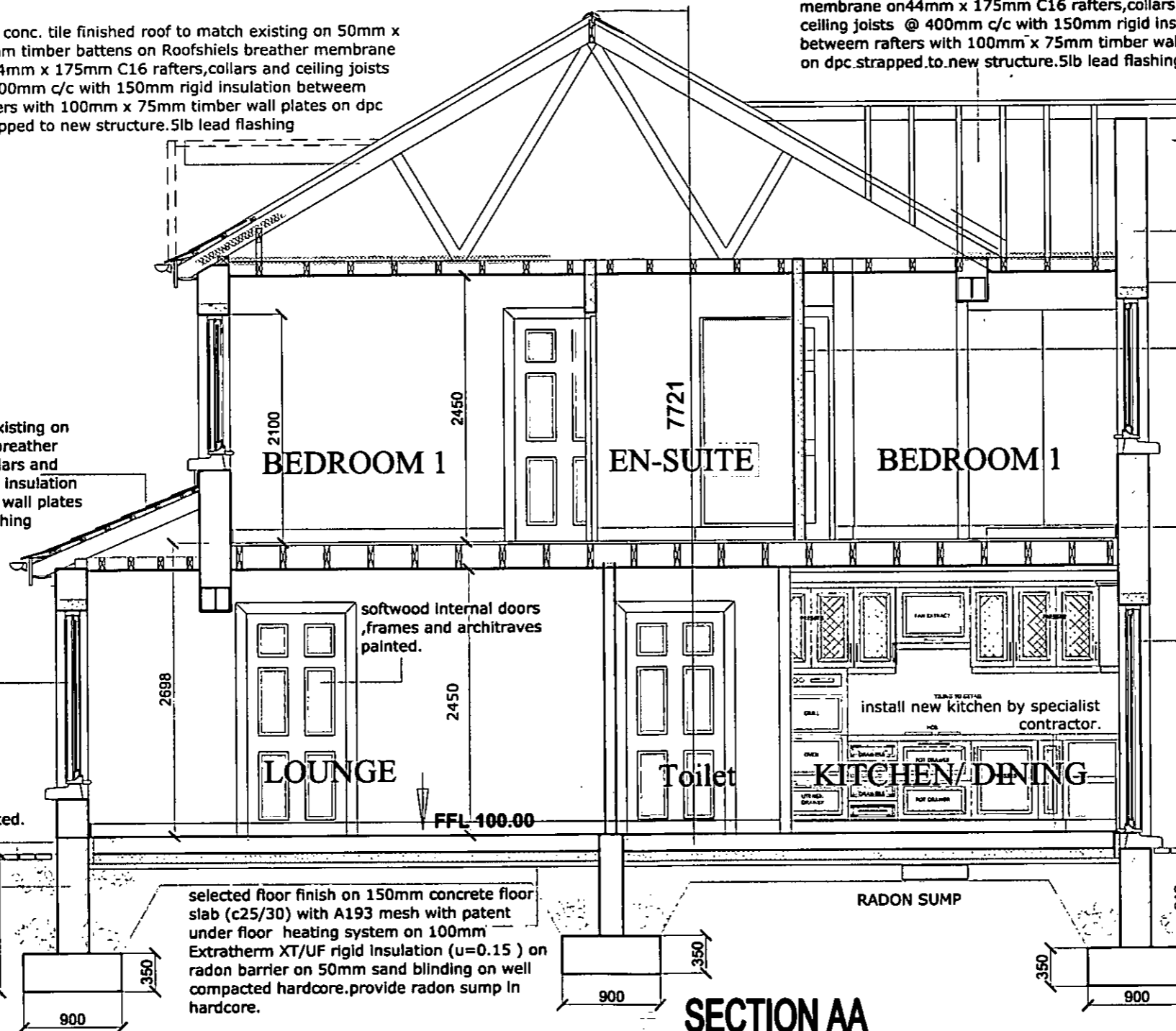

SECTION AA

PLANNING ISSUE.

DESMOND J. HALPIN & ASSOCIATES
 Planning & Building Design Consultants

16 Carrigee Drive, Fishhouse, Dublin 24 Phone: 01-4523710 Email: deshalpin16@gmail.com

| | | |
|--|------------------------|--------------|
| Project: PROPOSED NEW DWELLING AT No 1 DE SELBY PARK, BLESSINGTON ROAD, TALLAGHT, DUBLIN 24. | Scale 1:50 @ A3. | Drawn DJH |
| Drawing Title PROPOSED SECTION AA. | Drawing No 09-12-22 | Rev |
| Applicant: Ms. DANIELLE DONNOLLY. | Date Sept. 2022. | Chk JK |