

DE SELBY PARK

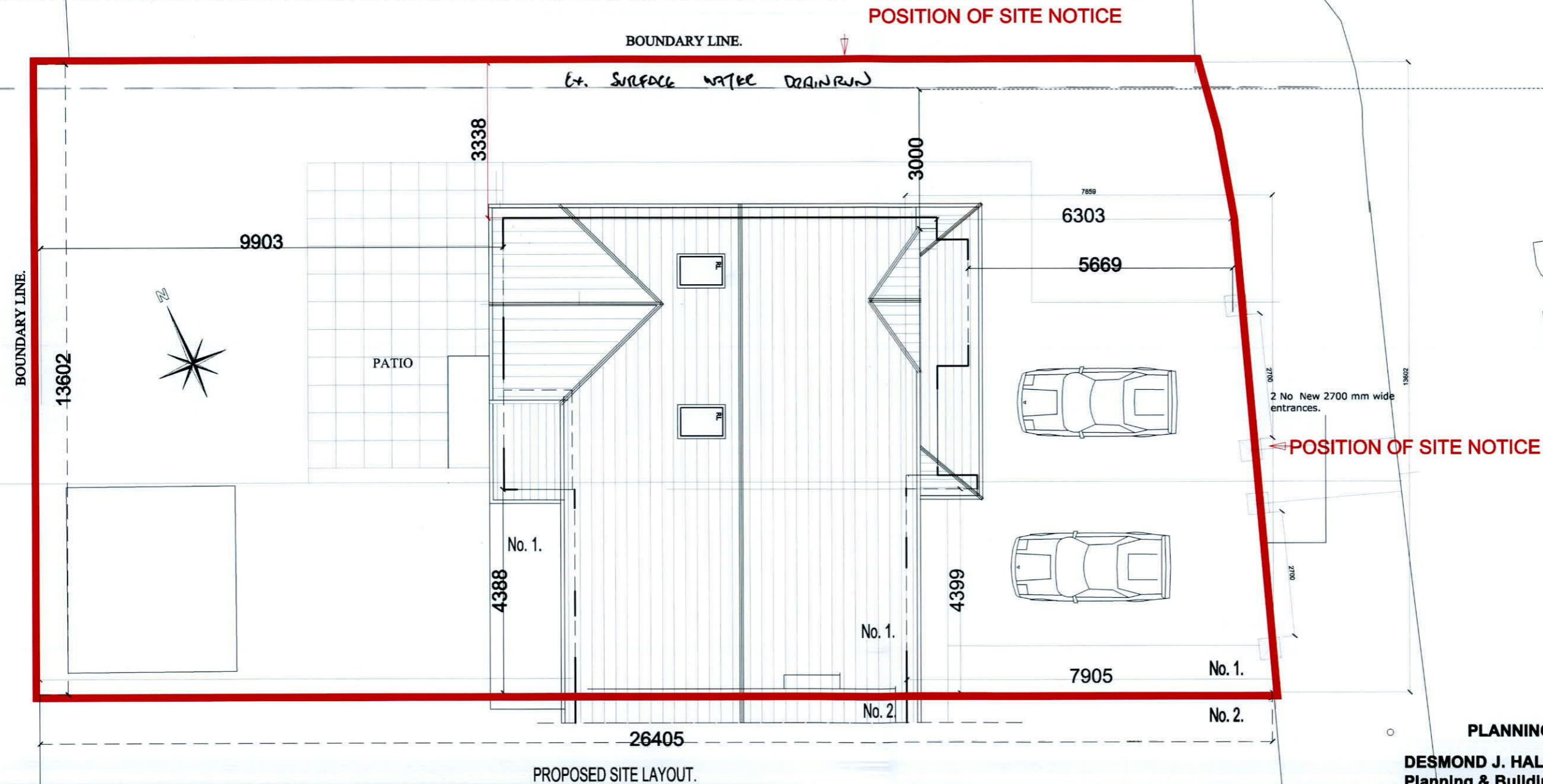

DE SELBY

PLANNING ISSUE.

DESMOND J. HALPIN & ASSOCIATES
 Planning & Building Design Consultants

15 Carrigra Drive, Firhouse, Dublin 24 Phone: 01-4623710 Email: deehalpin16@gmail.com

Project:	Scale	Drawn
PROPOSED DEVELOPMENT AT 146 St. MAELRUANS PARK, BLESSINGTON ROAD, TALLAGHT, DUBLIN 24,	1:100 @ A3.	DJH
Drawing Title	Drawing No	Rev
PROPOSED SITE LAYOUT.	10-12 -22	
Applicant:	Date	Chk
Ms. DANIELLE DONNOLLY.	Sept. 2022.	JK

NOTE:
 A SURVEY OF EXISTING DRAINAGE SYSTEM TO BE CARRIED OUT PRIOR TO THE COMMENCEMENT OF THE WORKS.
 THE DRAINAGE SYSTEM IS A COMBINED DRAINAGE SYSTEM,
 ALL NEW RAINWATER DRAIN RUNS TO DISCHARGE INTO EXISTING COMBINED RAINWATER SYSTEM,
 ALL NEW FLOOR DRAIN RUNS TO DISCHARGE INTO EXISTING COMBINED SOIL SYSTEM,
 ALL 100mm DIAM SURFACE / RAINWATER WATER DRAIN RUNS UNDER STRUCTURE TO BE ENCASED IN 150mm LEAN CONCRETE WITH PRECAST CONC LINTOLS OVER,
 ALL DISUSED DRAIN RUNS AND SIGNS TO BE REMOVED AND FILLED IN WITH SUITABLE MATERIAL.

No. 3.