

Planting Outside Red Line 1:100 @A1-

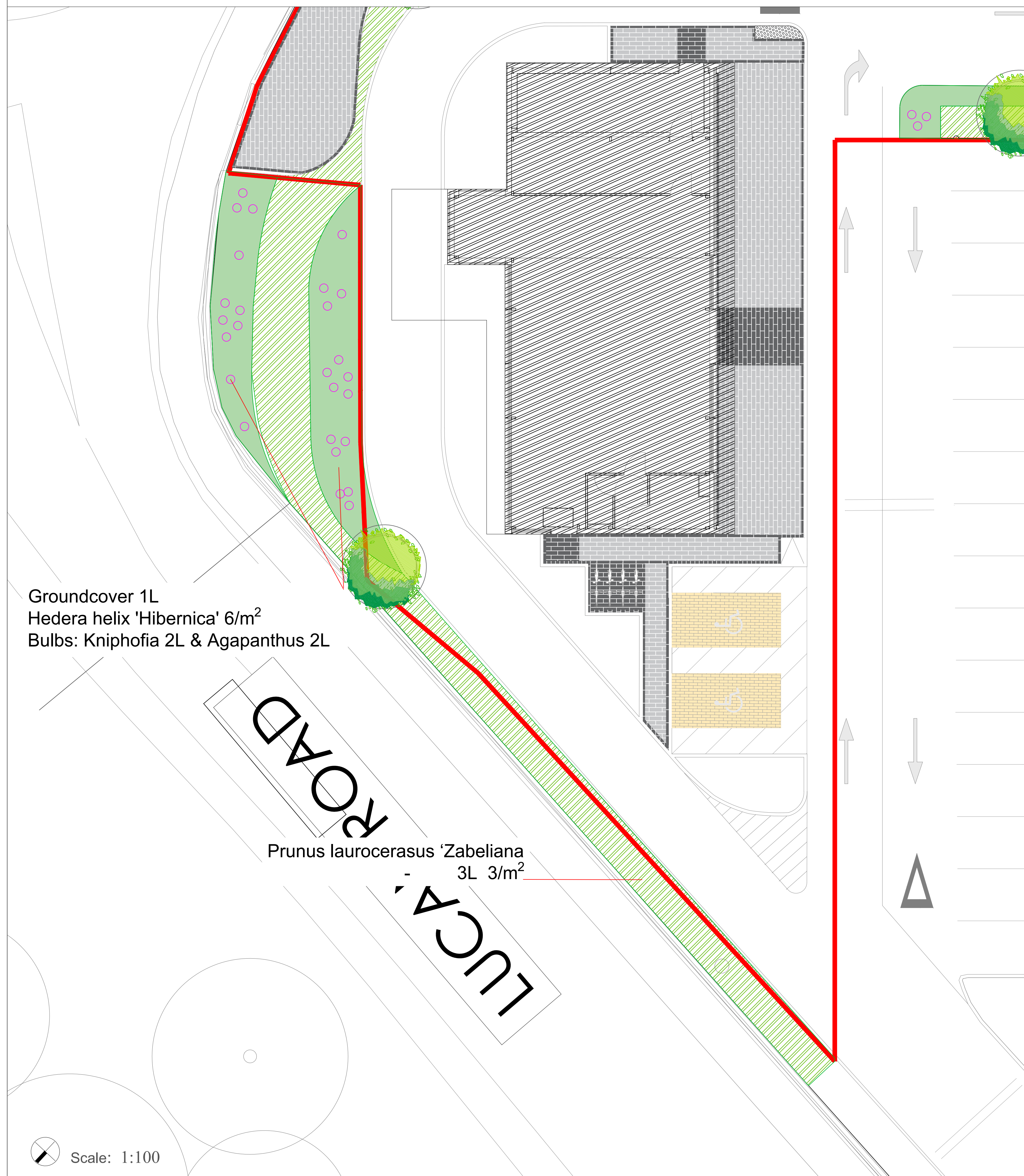

Agapanthus 2L



Kniphofia 'Royal standard' 2L



Hedera helix 'Hibernica' 6/m²



Prunus laurocerasus 'Zabeliana'

Legend:

SOFT LANDSCAPE - or similar approved plants - subject to availability.	
	Proposed Tree Planting T1 - Carpinus betulus 'Frans Fontaine' or Fagus sylvatica Dawyck 18-20cm
	- Prunus laurocerasus 'Zabeliana' (300-500mm high) 450mm topsoil depth
	- Sarcococca hookeriana (300mm - 500mm high) 450mm topsoil depth
	- Buxus sempervirens (300mm - 500mm high) 450mm topsoil depth
	- Libertia grandiflora (300mm - 500mm high) 450mm topsoil depth
	- Lavandula 'Hidcote'
	- Hedera helix Hibernica with bulbs: + Kniphofia royal standard 2L, Agapanthus 2L
HARD LANDSCAPE	
	Main Roadway Tarmac/Asphalt
	P1 - Paving - 360x120 x 60mm, 480x120x 60mm - Milan Midnight Or similar approved
	P2 - Paving - 360x120 x 60mm, 480x120 x 60mm - Silver Granite Or similar approved
	P3 - Paving - 200 x 100 x 60mm - Aqua Cobblesett Natural- Soldier Course. Or similar approved
	Car Parking - To Engineer spec or similar approved
	Tactile Metal Blister Studs @ Crossings Steps and Ramps
	Dropped Kerb - Please see Engineer DWG for details

Project Title: Drive Through Coffee Shop, Lucan Retail Park, Dublin	Dwg. No.: 04
Client: Starbucks	Scale: 1:100 @ A1
Date: 04.07.2022	Drawing By: CW
Drawing Title: Planting Outside Site Red Line	Checked By: RMD
Job No.: 1677	

REV	DATE	BY	DESCRIPTION
A	23.02.22	CW	Masterplan
B	03.07.22	CW	Masterplan Update
C	16.08.22	CW	Compliance

Ronan MacDiarmada + Associates Ltd.
Landscape Architects and Consultants.
5 Tootenhill, Rathcoole, Co. Dublin
tel: +353 1 412 4476 mob: 086 26 25 438
fax: +353 1 401 3748 e-mail: ronan@rmda.ie