

Landscape Planting Plan 1:100 @A1-

Planting Legend:

SOFT LANDSCAPE - or similar approved plants - subject to availability.	
	Proposed Tree Planting T1 - Carpinus betulus 'Frans Fontaine' or Fagus sylvatica Dawyck 18-20cm
	- Prunus laurocerasus 'Zabeliana' (300-500mm high) 450mm topsoil depth
	- Sarcococca hookeriana (300mm - 500mm high) 450mm topsoil depth
	- Buxus sempervirens (300mm - 500mm high) 450mm topsoil depth
	- Libertia grandiflora (300mm - 500mm high) 450mm topsoil depth
	- Lavandula 'Hidcote'
	- Hedera helix Hibernica with bulbs: + Kniphofia royal standard 2L, Agapanthus 2L

Planting Areas:

- 184m² - Prunus laurocerasus 'Zabeliana' - 3L 3/m²
- 24m² - Buxus sempervirens
- 6.5m² - Lavandula 'Hidcote'
- 86m² - Sarcococca hookeriana 3L
- 5m² - Libertia grandiflora
- 82m² - Groundcover 1L Hedera helix 'Hibernica' 6/m²
Bulbs: Kniphofia 2L & Agapanthus 2L

T1 T1 - Carpinus betulus 'Frans Fontaine' or Fagus sylvatica Dawyck 18-20cm

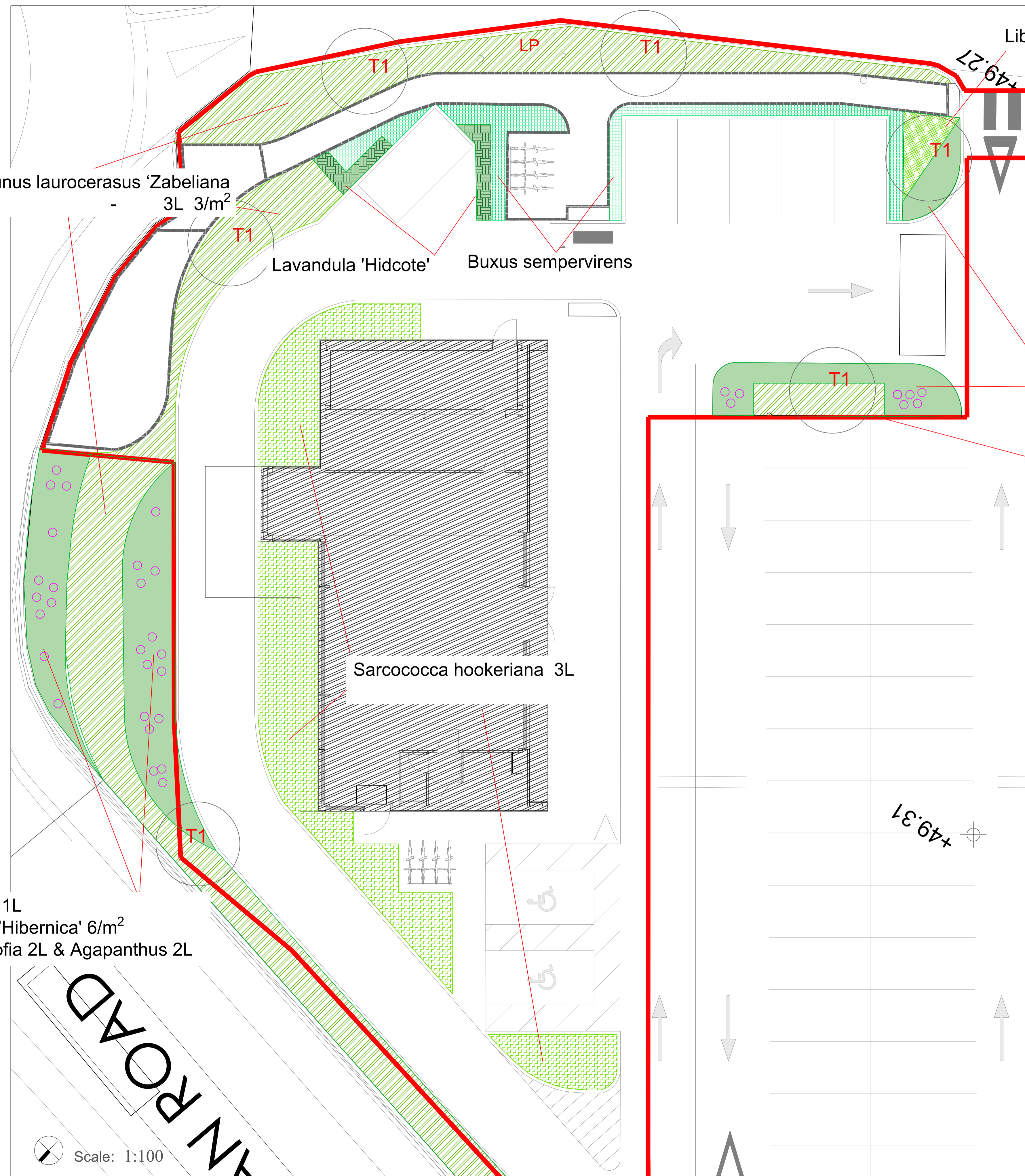

Groundcover 1L
Hedera helix 'Hibernica' 6/m²
Bulbs: Kniphofia 2L & Agapanthus 2L

Groundcover 1L
Hedera helix 'Hibernica' 6/m²
Bulbs: Kniphofia 2L & Agapanthus 2L

Prunus laurocerasus 'Zabeliana' - 3L 3/m²

Scale: 1:100

REV	DATE	BY	DESCRIPTION
A	23.02.22	CW	Masterplan
B	03.07.22	CW	Masterplan Update
C	16.08.22	CW	Compliance

Project Title: Drive Through Coffee Shop, Lucan Retail Park, Dublin	Dwg. No.: 03
Client: Starbucks	Scale: 1:100 @ A1
Date: 05.07.2022	
Drawing Title: Landscape Planting Plan	Drawing By: CW
Job No.: 1677	Checked By: RMD

RMDA
LANDSCAPE ARCHITECTS + CONSULTANTS

Ronan MacDiarmada + Associates Ltd.
Landscape Architects and Consultants.

5 Tootenhill, Rathcoole, Co. Dublin
tel: +353 1 412 4476 mob: 086 26 25 438
fax: +353 1 401 3748 e-mail: ronan@rmda.ie