

**TRAFFIC MANAGEMENT SCHEME**

*for*

*Proposed Utility Works at  
Scholarstown Road, Scholarstown, Co.  
Dublin, DX039*





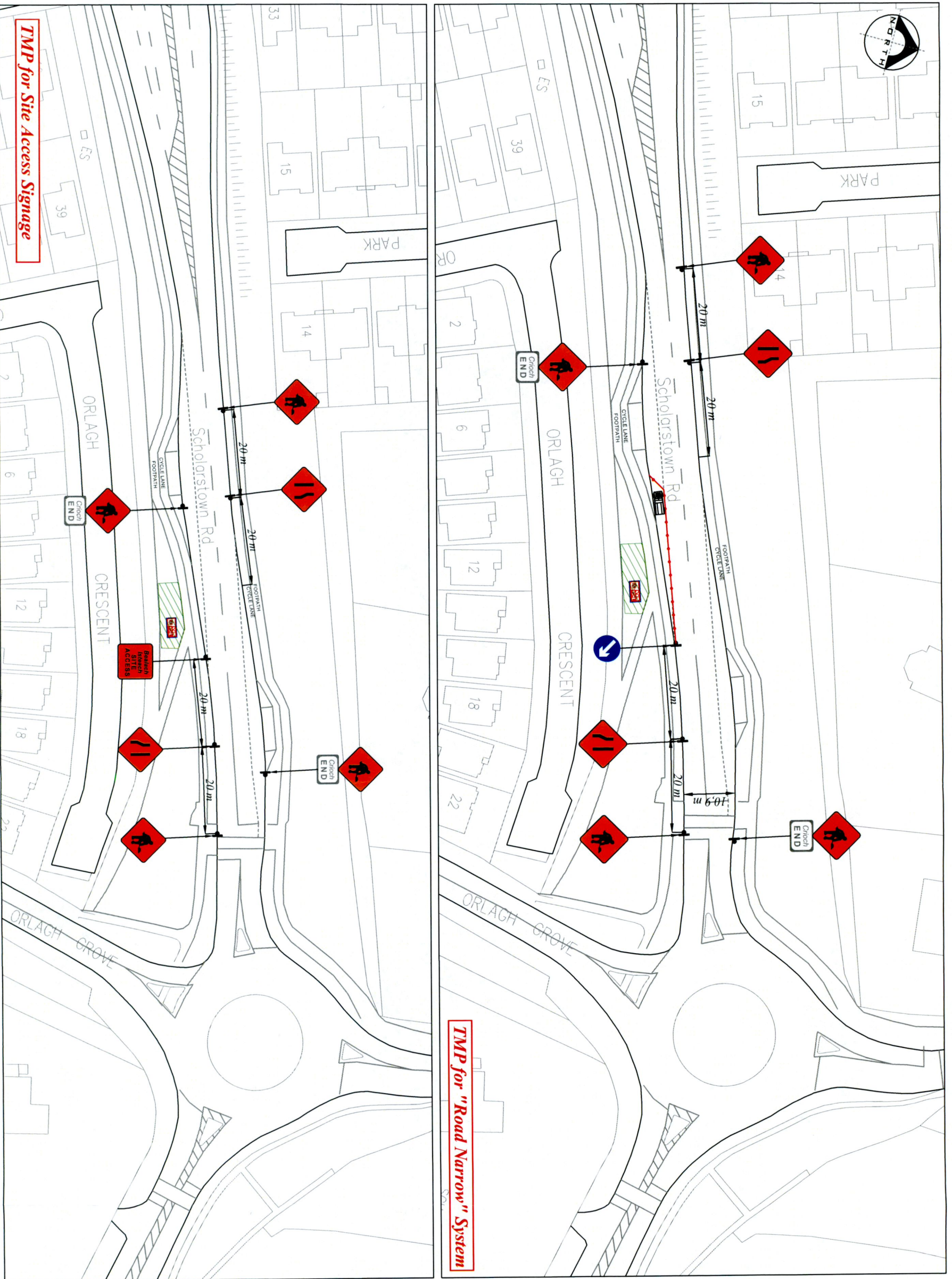

**TMP for Site Access Signage**

**TMP for "Road Narrow" System**



**Design Parameters:**

Design Parameters:	Level (m)
1. Statutory Speed of the Road -	50km/h
2. Cumulative Distance	40
3. Distance between Advance Signs:	20m
4. Number of Advance Signs:	2 No
5. Minimum Visibility of Signs:	50m
6. Longitudinal Safety Zone:	5m
7. Leading Taper:	4.5deg
8. Max. at Tapers Cone Space:	3m
9. Max. Longitudinal Cone Space:	6m
10. Cone Height	750mm
11. Sign Size	600mm

- Note:**
- All signs to comply with Chapter 8 of the "Traffic Signs Manual", Guidance Document.
  - All Traffic Management to be carried out in accordance with Chapter 8 of the "Traffic Signs Manual".
  - Detailed Risk assessment to be carried out prior to the installation of Traffic Management System.
  - The Contractor shall be responsible for providing all required ramp access to all changes in road surface level where traffic runs on a temporary surface and also for cycle/pedestrian ramps where footpath, cycle paths or any surface which has a level discontinuity as a result of the works.
  - Exact sign positions to be agreed on site.
  - All safety zones to be maintained at all times.
  - All affected Parties and An Garda Siochana to be notified prior to works commencing.
  - Signs to be positioned so as not to cause an obstruction to other road users.
  - All signs to be faced with retro-reflective material to class ref 2 of EN 12899.
  - All delineation devices should be designed in accordance with IS EN 13422.
  - All signage shall be per Tables 8.2.2.2 - 8.2.2.9 of the Chapter 8 "Traffic Signs Manual".
  - Safety barrier to be in accordance with IS EN 1317.
  - "End of Roadworks" sign placed 20m to 50m from end of works area.
  - Pedestrian barriers to be used around works area.

Rev:	Description:	Date:	Job Details:	Drawing:	Dwg no:
			Proposed Utility Works at Scholartstown Road, Scholartstown, Co. Dublin	T.M. Plan for Lane Closure System / Site Access Signage	01
			Sheet: 2 of 2	Drawn By: JM	Rev:
			Project/Job no: DX039	Date: July 2022	Scale: As Shown

