

LEGEND:

- EXISTING WATERMAIN
- - - PROPOSED 150mm ϕ WATERMAIN
- SV PROPOSED SLUICE VALVE
- FH PROPOSED HYDRANT
- BB BOUNDARY BOX
- M MAG FLOW BULK METER BOX WITH CHAMBER
- RED LINE BOUNDARY
- AV PROPOSED AIR VALVE

- NOTE:**
- ALL PIPE WORK, VALVES, CHAMBERS, NETWORK ARRANGEMENTS AND ALL ASSOCIATED WATERMAIN WORKS TO BE IN ACCORDANCE WITH IRISH WATER CODES OF PRACTICE AND STANDARD DETAILS.
 - ALL NEW WATERMAIN MATERIAL SHALL BE PE80 SDR17 FUSION WELDED IN ACCORDANCE WITH SECTION 3.9 OF THE IRISH WATER CODE OF PRACTICE.
 - ALL MANHOLES IN GRASSED AREAS TO HAVE 200MM WIDE X 100MM DEEP CONCRETE PLINTH/NEB CAST TO THEIR PERIMETER TO ENSURE THEY ARE NOT OVERGROWN. CONCRETE TO BE GRADE C20/25.
 - INDIVIDUAL SUB-METER FACILITIES TO BE PROVIDED TO EACH APARTMENT UNIT. METERS FOR APARTMENTS SHALL BE INSTALLED INTERNALLY WITHIN THE PREMISES IN ACCORDANCE WITH THE AUTHORITY'S BUILDING CONTROL REQUIREMENTS AND SUBJECT TO REVIEW BY IRISH WATER AS PER SECTION 3.15.2 OF THE CODE OF PRACTICE.
 - FOR INTERNAL WATER SUPPLY TO BUILDING A BREAK TANK AND BOOSTER SYSTEM IS PROPOSED. AN ISOLATION DEVICE SHALL BE PROVIDED USING A CONNECTION VIA A UNRESTRICTED AIR-CAP DEVICE (AA TYPE DEVICE, IS EN 1717) TO PREVENT BACKFLOW TO IW NETWORK AS PER SECTION 3.13 OF THE IW CODE OF PRACTICE.
 - TYPICAL SERVICE LAYOUT DISTANCES (HORIZONTAL AND VERTICAL) AS PER DETAIL STD-W-11
 - WATERMAIN 'T' JUNCTIONS TO BE AT 90 DEGREE ANGLES AS PER STD-W-07.
 - PROPOSED WATERMANS TO BE LOCATED A MINIMUM OF 300mm FROM THE WASTEWATER INFRASTRUCTURE IN ACCORDANCE WITH SECTION 3.5.18 OF THE IRISH WATER WASTEWATER CODE OF PRACTICE.
 - THE LOCATION OF THE BULK METER, VALVES AND HYDRANTS SHALL BE DESIGNED IN ACCORDANCE WITH SECTION 3.15.4 OF THE IRISH WATER CODE OF PRACTICE.
 - BULK METERS INTO EACH OF THE MAIN BUILDINGS SHALL BE IN ACCORDANCE DETAIL STD-W-26A
 - IT IS CONFIRMED THAT ALL HYDRANTS SHALL NOT BE LOCATED ANY MORE THAN 46m FROM ANY PART OF THE DEVELOPMENT.
 - ALL WATERMAIN WORKS TO BE TAKEN IN CHARGE TO BE AIR PRESSURE TESTED IN ACCORDANCE WITH IW CODE OF PRACTICE SECTION 4.10.
 - CONTRACTOR TO REVIEW IRISH WATER SPECIFICATIONS AND REQUIREMENTS PRIOR TO COMMENCEMENT OF ANY WORKS.
 - CONTRACTOR TO REVIEW IRISH WATER QA FIELD INSPECTION REQUIREMENTS MANUAL PRIOR TO COMMENCEMENT OF ANY WORKS.

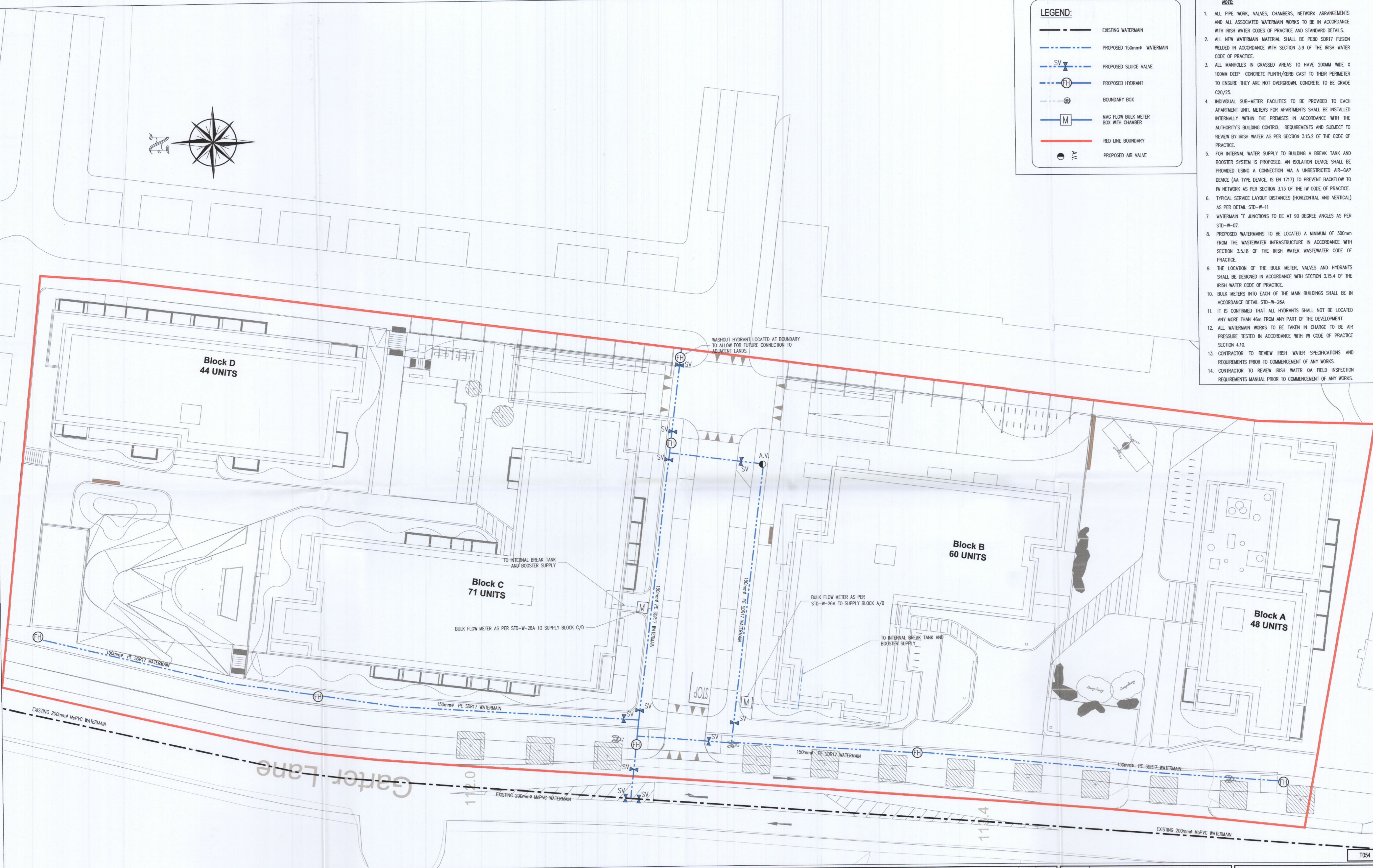

PLANNING DRAWING.
NOT FOR CONSTRUCTION.
 ALL LEVELS GIVEN ARE
 RELATIVE TO ORDNANCE DATUM.
 THIS DRAWING HAS BEEN ISSUED FOR INFORMATION
 PURPOSES ONLY AND MUST NOT BE USED
 FOR CONSTRUCTION UNDER ANY CIRCUMSTANCES

- NOTES**
- For setting out refer to Architect's drawings.
 - This drawing to be read in conjunction with all other Architectural and Engineering drawings and all other relevant drawings and Specifications.
 - DO NOT SCALE THIS DRAWING. Use figured dimensions only.
 - No part of this document may be reproduced or transmitted in any form or stored in any retrieval system of any nature without the written permission as copyright holder except as agreed for use on the project for which the document was originally issued.
 - Ordnance Survey Ireland Licence Number EN 0074022

Rev. No.	Date	REVISION NOTE	Drn. By	Chkd. By

Architect
 DARMODY ARCHITECTURE
 Project
 RESIDENTIAL DEVELOPMENT AT
 GARTER'S LANE, CITYWEST
 Title
 Watermain Layout
 Dwg. No.
 GAR-CSC-ZZ-00-DR-C-0004
 Date
 Aug 2022
 Drn. by
 AB
 Chkd. by
 GL
 Apprd. by
 NB
 Scale
 1:250@A1
 Revision

CS Consulting Group
 DUBLIN | LONDON | LIMERICK
 Head Office
 19-22 Dame Street, Dublin 2.
 T: +353 (0)1 5480863
 e: info@csconsulting.ie
 w: www.csconsulting.ie
 Quality
 Environment
 Energy
 Health & Safety
 I.S. EN ISO 9001:2008
 I.S. EN ISO 14001:2004
 I.S. EN ISO 50001:2011
 CHSAS 19001:2007