

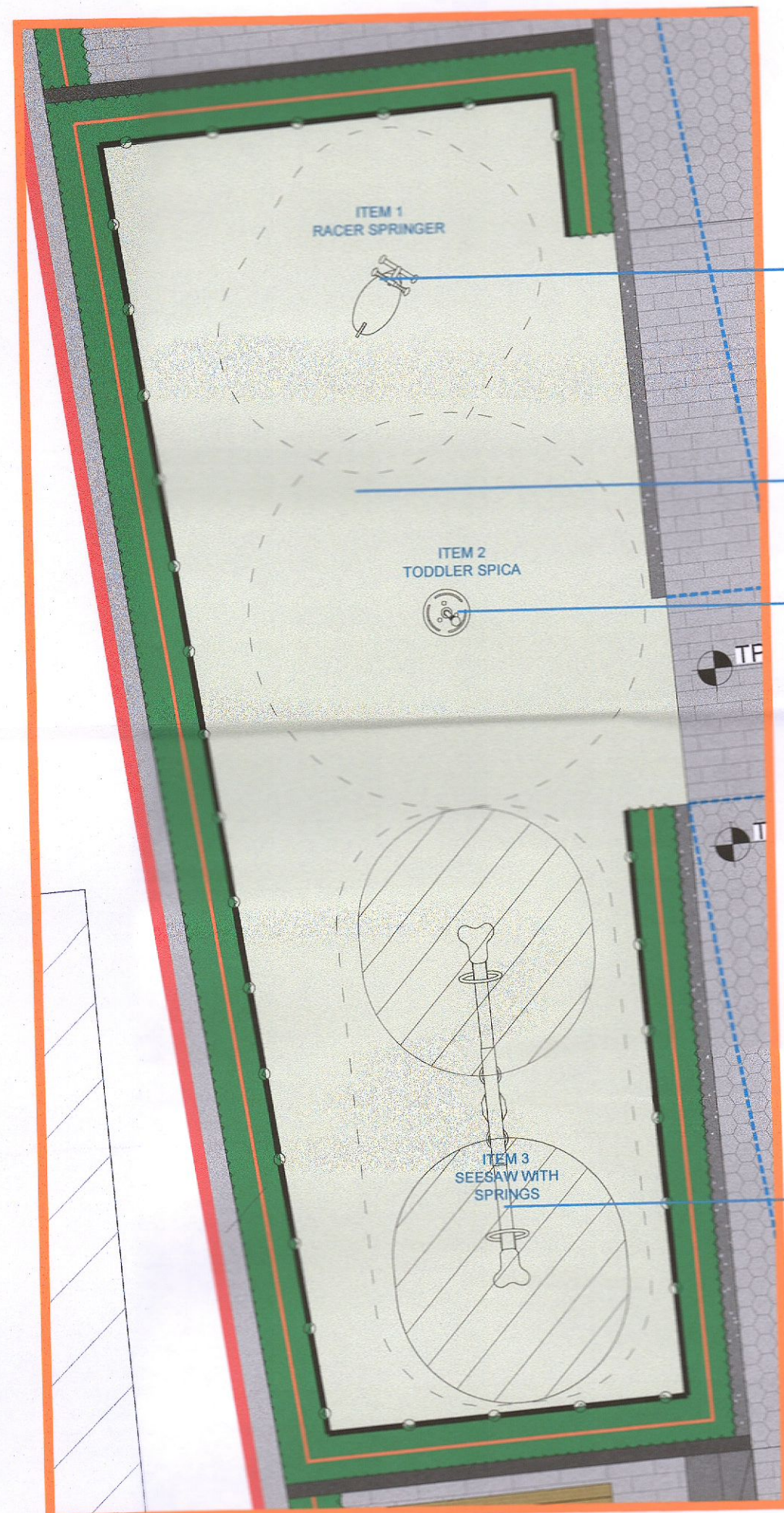

INDICATION PLAN
SCALE: NTS@A1

ENGINEERED WOOD CHIP SAFETY SURFACE



TODDLER PLAY SPACE
SCALE: 1:50@A1



ITEM 1
KOMPAN RACER SPRINGER

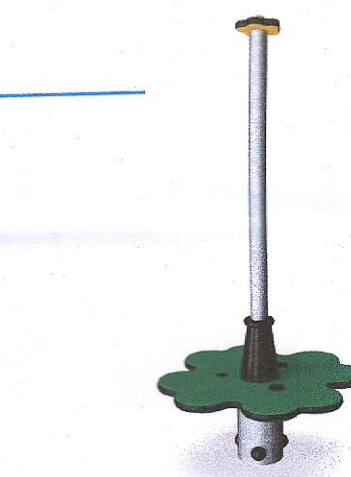

ITEM 2
KOMPAN TODDLER SPICA

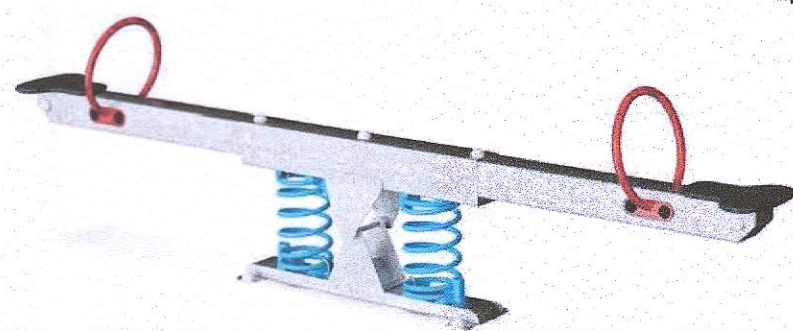

ITEM 3
SEESAW WITH SPRINGS

TOTAL TODDLER PLAY
AREA = 37SQ.M

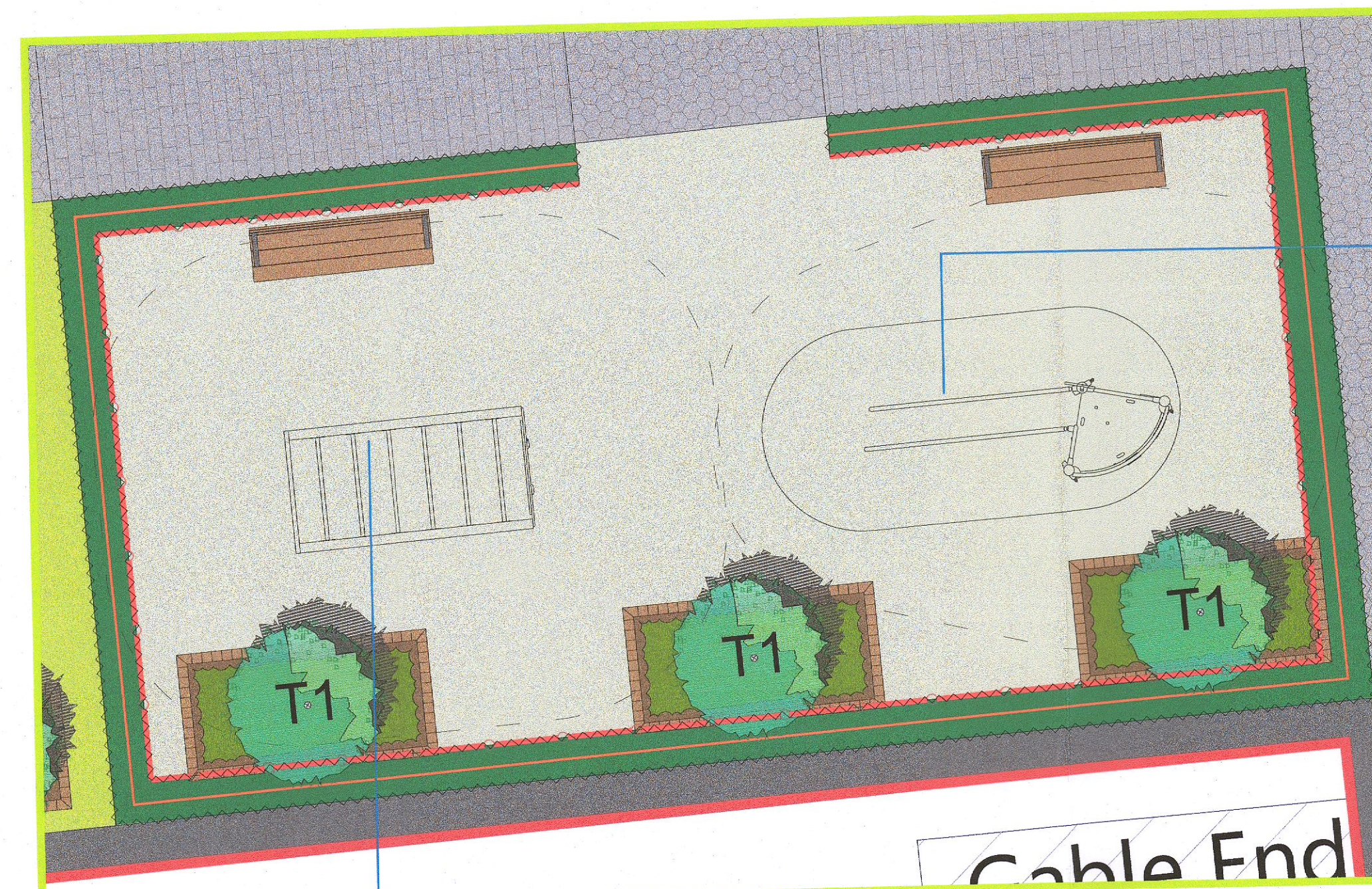
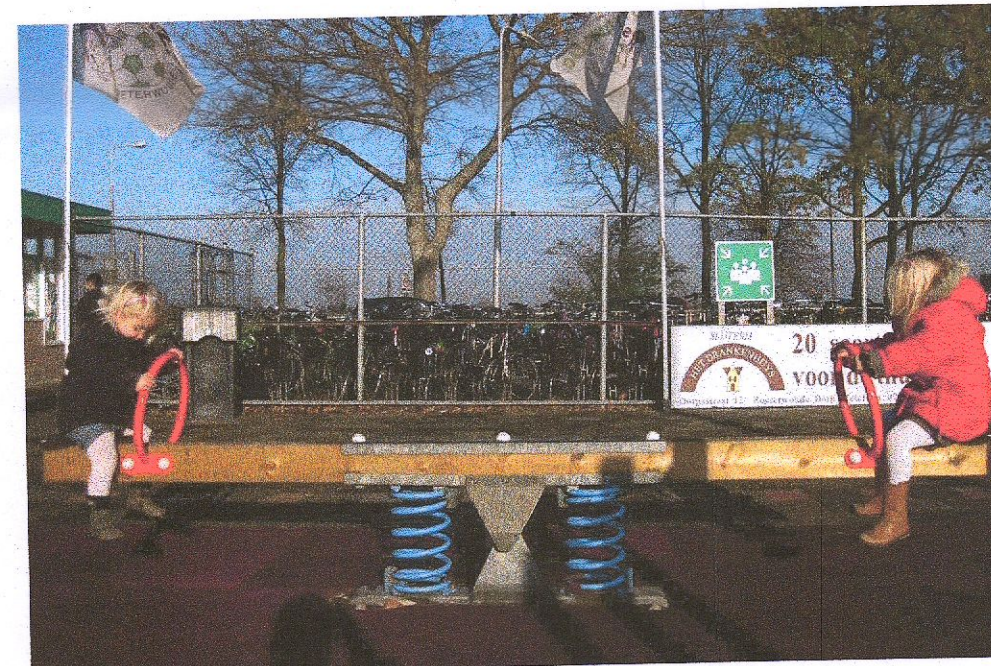

CHILDREN'S PLAY SPACE
SCALE: 1:50@A1

ITEM 1
KOMPAN CLIMBING STRUCTURE

ITEM 2
KOMPAN MATTERHORN

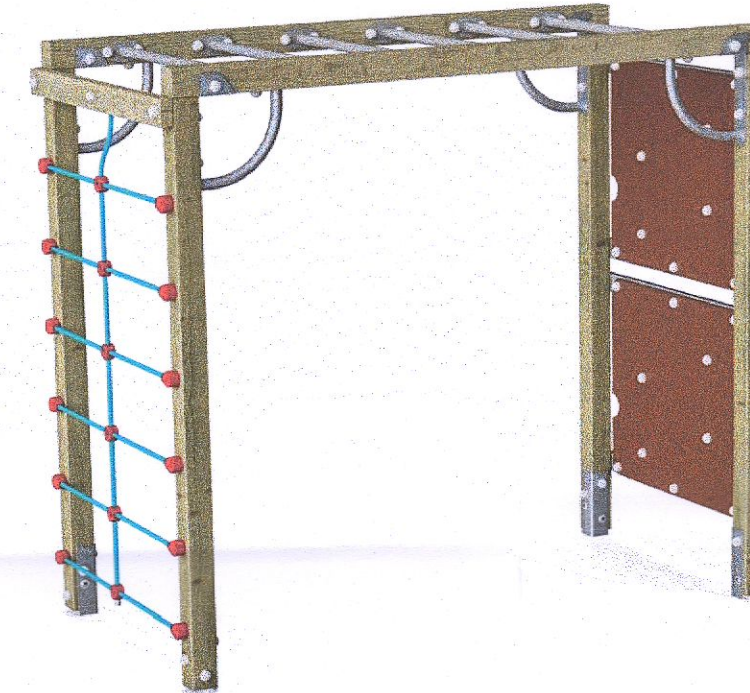

ITEM 1
KOMPAN CLIMBING STRUCTURE

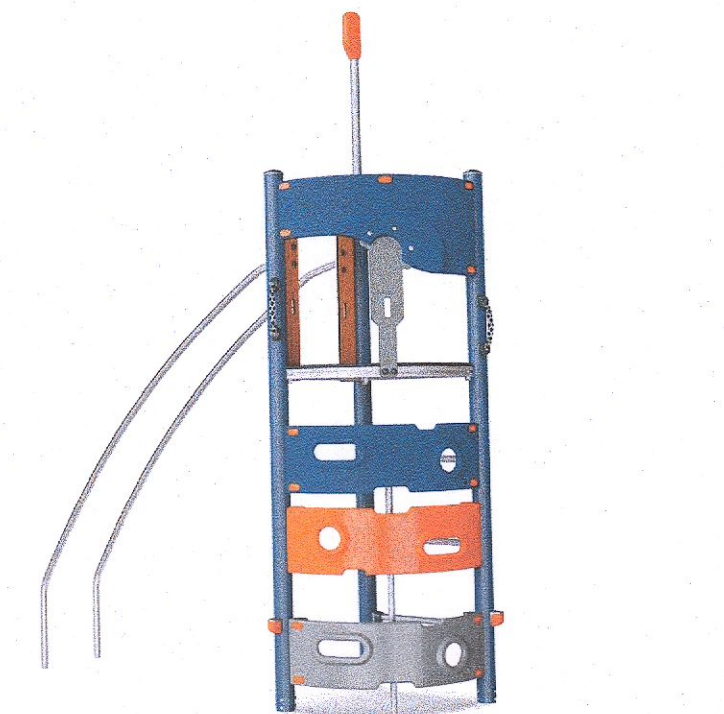

ITEM 2
KOMPAN MATTERHORN

PLAY AREA - MATERIALS KEY

	HARD LANDSCAPING - Surface 4
	• Playground Safety Surface - Engineered Wood Chip
	• To be laid to manufacturers specifications
	SOFT LANDSCAPING - Hedge 1
	• <i>Prunus lusitanica</i>
	• 1.2m Portuguese laurel hedging to screen terraces and winter gardens.
	HARD LANDSCAPING - Fence 2
	• High 'anti-trap bow top' fencing.
	• 1200mm height
	HARD LANDSCAPING - Public Seating
	• Timber bench, Pressure treated wood.
	• Anchored to ground.
	HARD LANDSCAPING - Play Equipment
	• Timber wrapped planted boxes 1250mm x 2500mm x 1000mm.
	• Moveable by forklift if required.
	SOFT LANDSCAPING - Tree 1
	• <i>Acacia dealbata</i> (Mimosa Tree)
	• 2m clear stem, 18/20cm girth, CG.



ENGINEERED WOOD CHIP SAFETY SURFACE - MIN. 200MM DEPTH.
NOTE: CONFORMS TO EN 1177 EUROPEAN STANDARDS FOR PLAYGROUND SURFACING

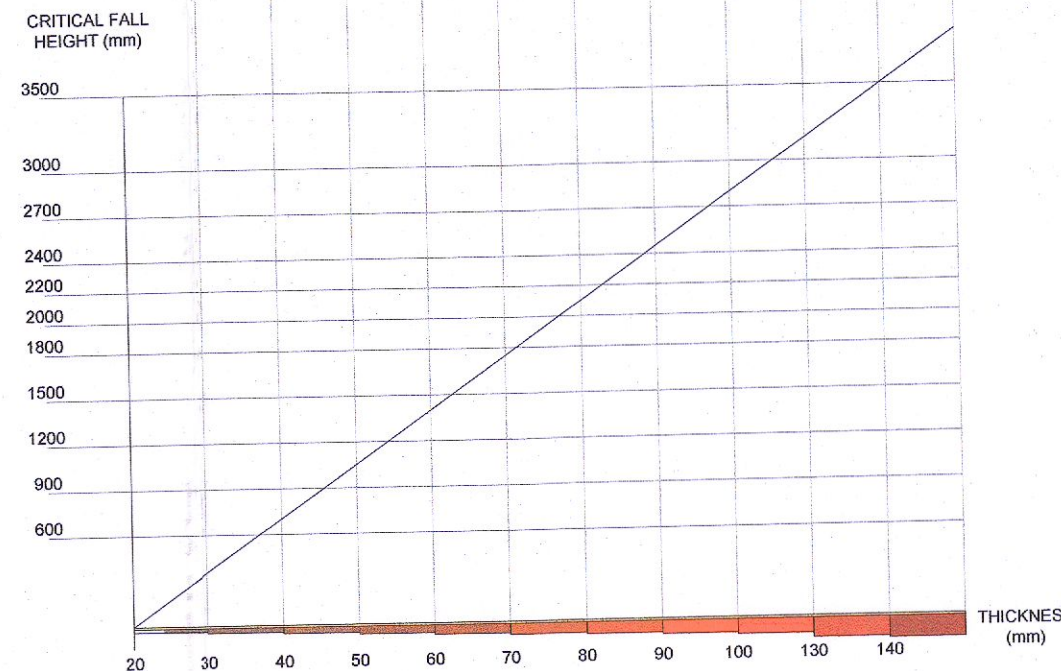

SAFETY SURFACE THICKNESS RELEVANT TO CRITICAL FALL HEIGHT
SCALE: NTS@A3

TODDLER PLAY AREA - SCHEDULE OF EQUIPMENT						
ITEM	NAME	QTY	REF CODE	PRODUCT LINE	CATEGORY	MAX FALL HT (CM)
1	RACER SPRINGER	1	ELE400002	Traditional Play	Springer Units	2-6 68
2	TODDLER SPICA	1	M19101	Traditional Play	Toddler Equipment	1-4 60
3	SEESAW WITH SPRINGS	1	KPL111	Traditional Play	Seesaws	3-8 100

NOTE: ALL PROPOSED PLAY EQUIPMENT CONFORMS TO EN 1176-1-11 EUROPEAN STANDARDS FOR PLAY EQUIPMENT

CHILDREN'S PLAY AREA - SCHEDULE OF EQUIPMENT						
ITEM	NAME	QTY	REF CODE	PRODUCT LINE	CATEGORY	MAX FALL HT (CM)
1	CLIMBING STRUCTURE	1	KPL815	Freestanding Play Equipment	Balancing & Climbing	6-12 212
2	MATTERHORN	1	PCE110100	Play Systems	Elements - School Age	6+ 238

NOTE: ALL PROPOSED PLAY EQUIPMENT CONFORMS TO EN 1176-1-11 EUROPEAN STANDARDS FOR PLAY EQUIPMENT

DO NOT SCALE FROM THIS DRAWING. WORK ONLY FROM FIGURED DIMENSIONS
ALL ERRORS AND OMISSIONS ARE TO BE REPORTED TO LANDSCAPE ARCHITECT

REV.	DATE	REFERENCE	BY:	REV.	DATE	REFERENCE	BY:
A	2022-09-09	TODDLERS AND CHILDRENS PLAY EQUIPMENT DETAIL	SK				

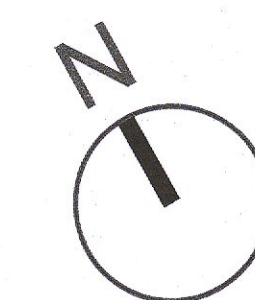

MURPHY+SHEANON
Horticulture & Landscape Architecture

Contact : colum@murphysheanon.ie
Tel : +353860787147
Address : 2Richmond Lodge, Richmond Green,
Corrickbrennan Road, Monkstown, Dublin 18

CLIENT:
SIRO HOMES
PROJECT:
NUTGROVE AVENUE, RATHFARNHAM

TITLE:
TODDLERS AND CHILDRENS PLAY EQUIPMENT DETAILS

CAD FILE REFERENCE:
g:\shared drives\murphy sheanon office\m+s_office\jobs\2101362 - nutgrove avenue, rathfarnham\m+s3_tender\21-362-td-01_09.09.22.dwg

DRAWING NUMBER:
362-TD-05
PROJECT NUMBER:
362
PROJECT STATUS:
TENDER
DATE:
SEPTEMBER 2022
SCALE:
AS SHOWN@A1
DRAWN BY:
SK
CHECKED BY:
KR/CSS