

THIS DRAWING IS TO BE USED BY PAUL O'LOUGHLIN & ASSOCIATES (P.O.A.) AND SHOULD NOT BE USED FOR ANY OTHER THAN ITS ORIGINAL INTENDED USE.
 THIS DRAWING IS PROTECTED BY COPYRIGHT AND IS NOT TO BE REPRODUCED, COPIED OR MANIPULATED IN ANY WAY WITHOUT WRITTEN CONSENT FROM P.O.A.
 DO NOT SCALE FROM THIS DRAWING

SITE AREA
 Total Site Area - 4420sq m

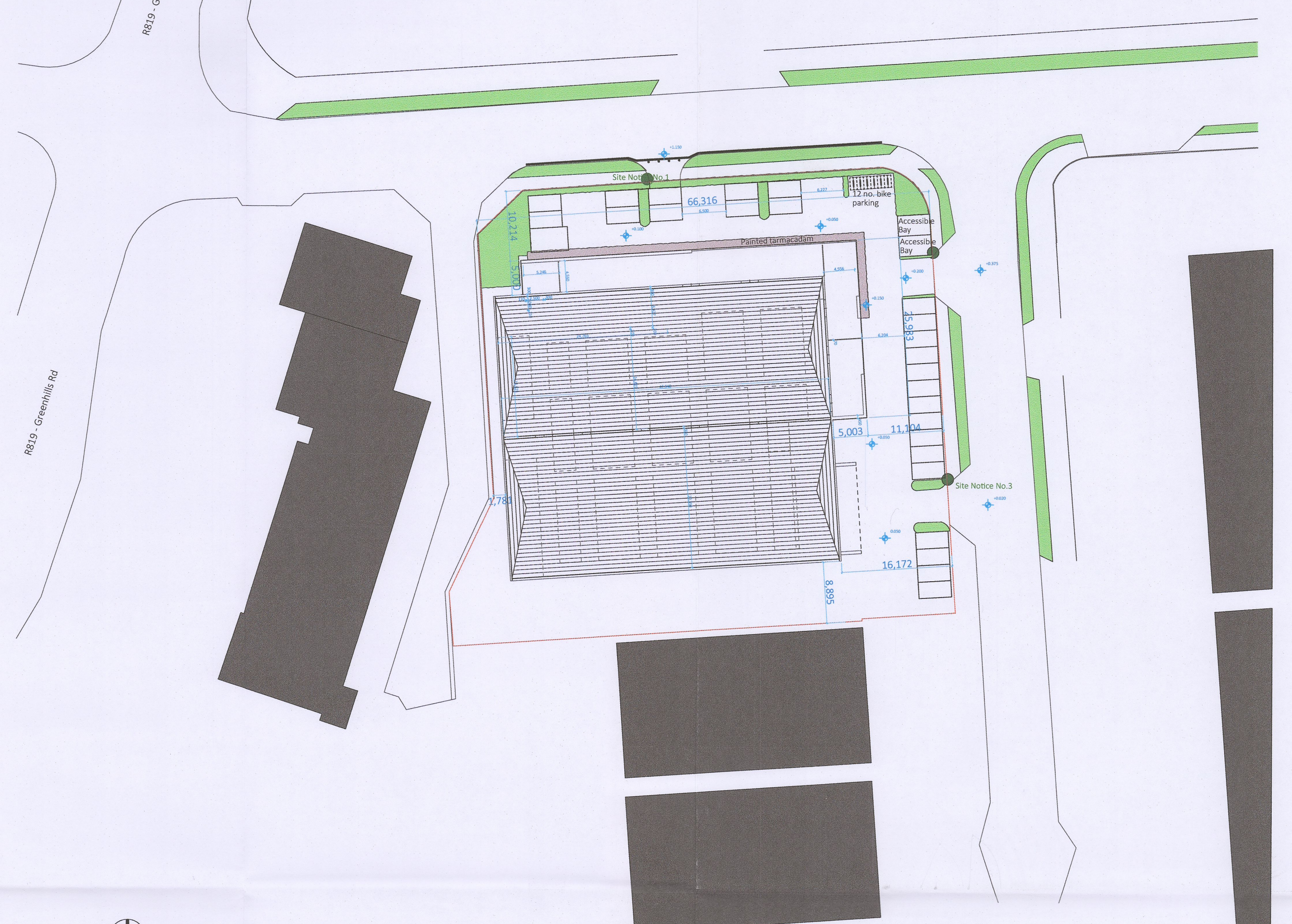
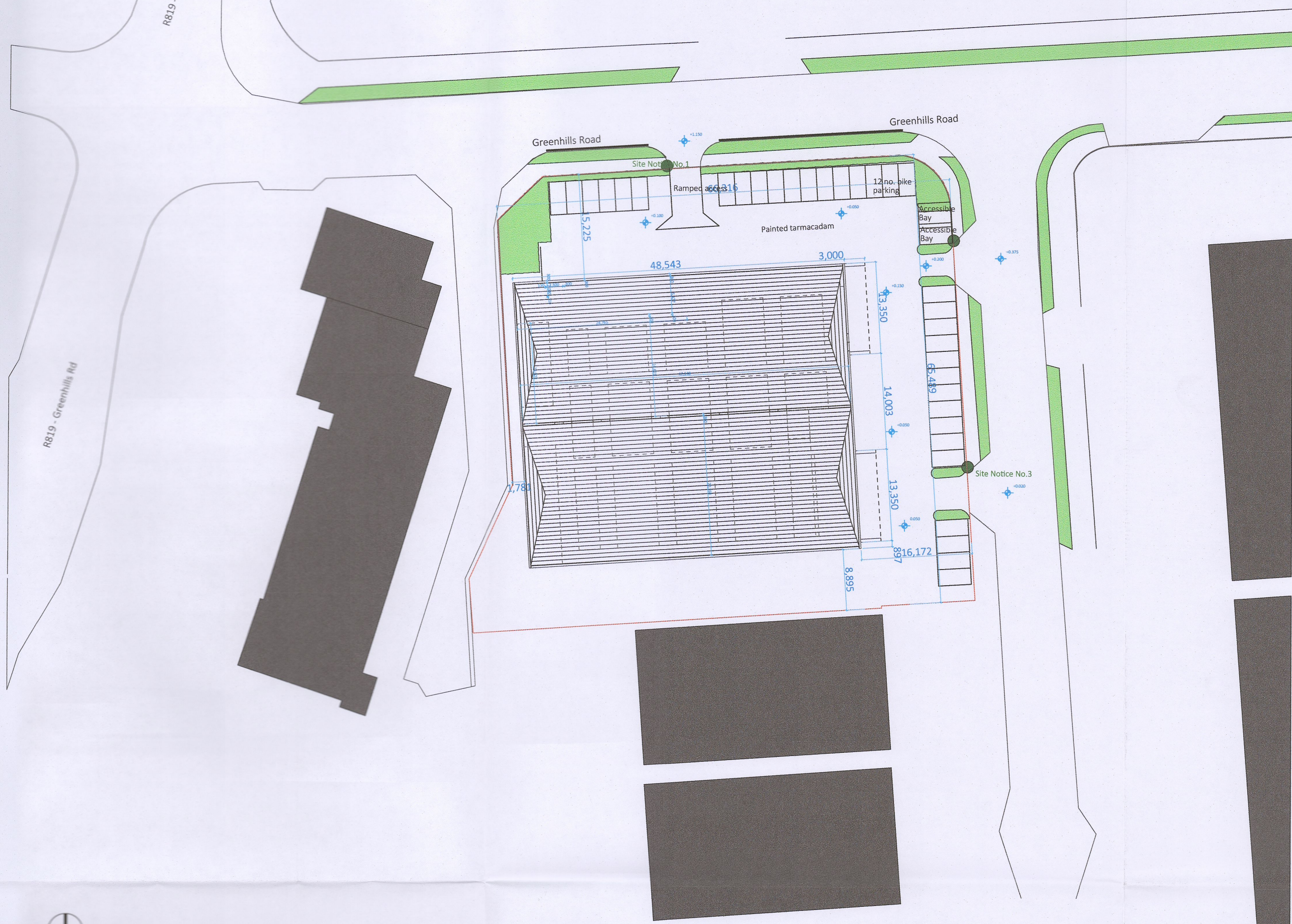

Existing Site Layout
 Scale 1:500

Existing double yellow lines to be continued across existing entrance (which is to be closed up). 4no. bollards, set back slightly from the road, to be installed to prevent parking. All in agreement with SDCC

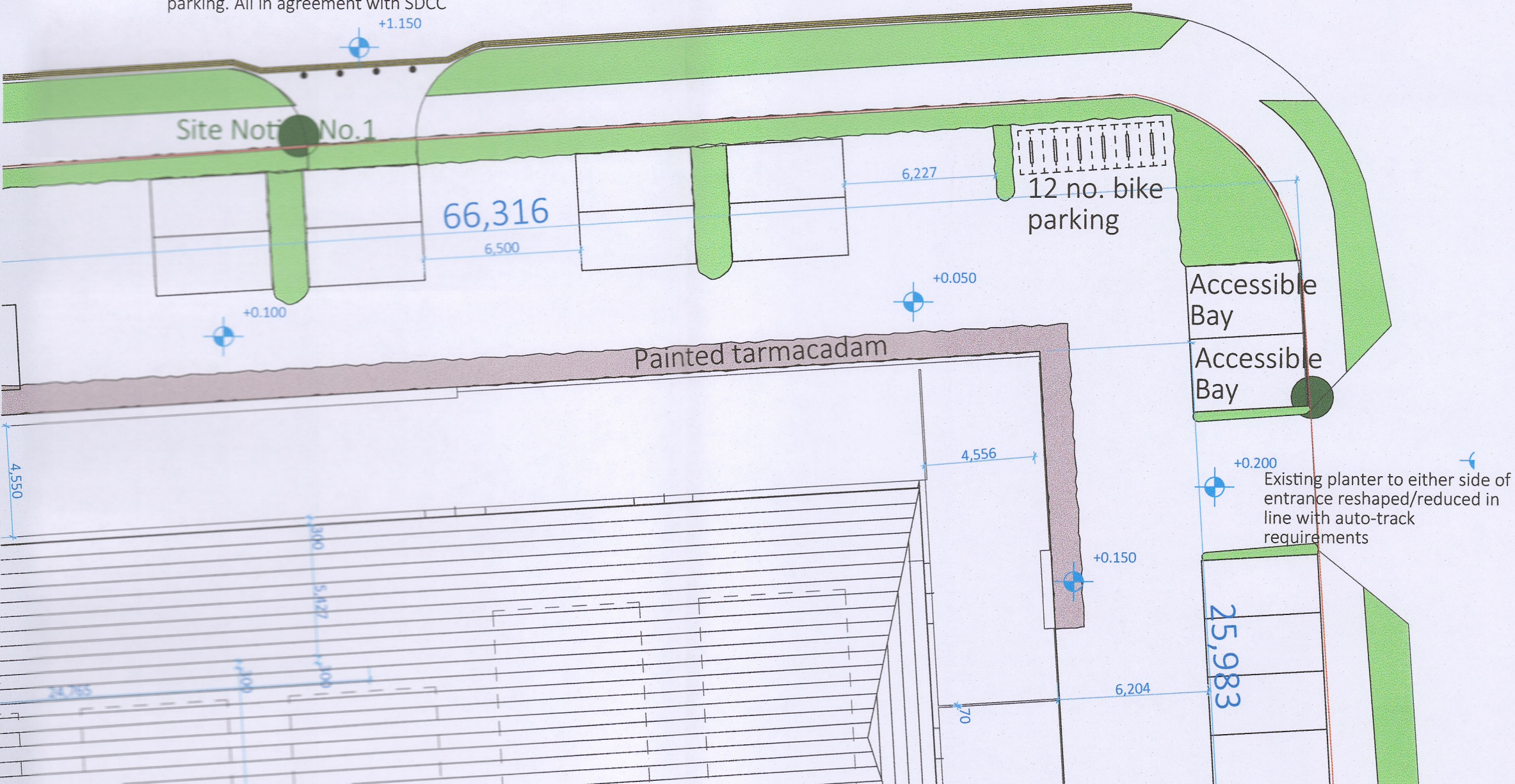

Proposed Detail Site Layout Extract
 Scale 1:200

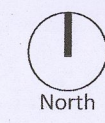

Proposed Site Layout
 Scale 1:500

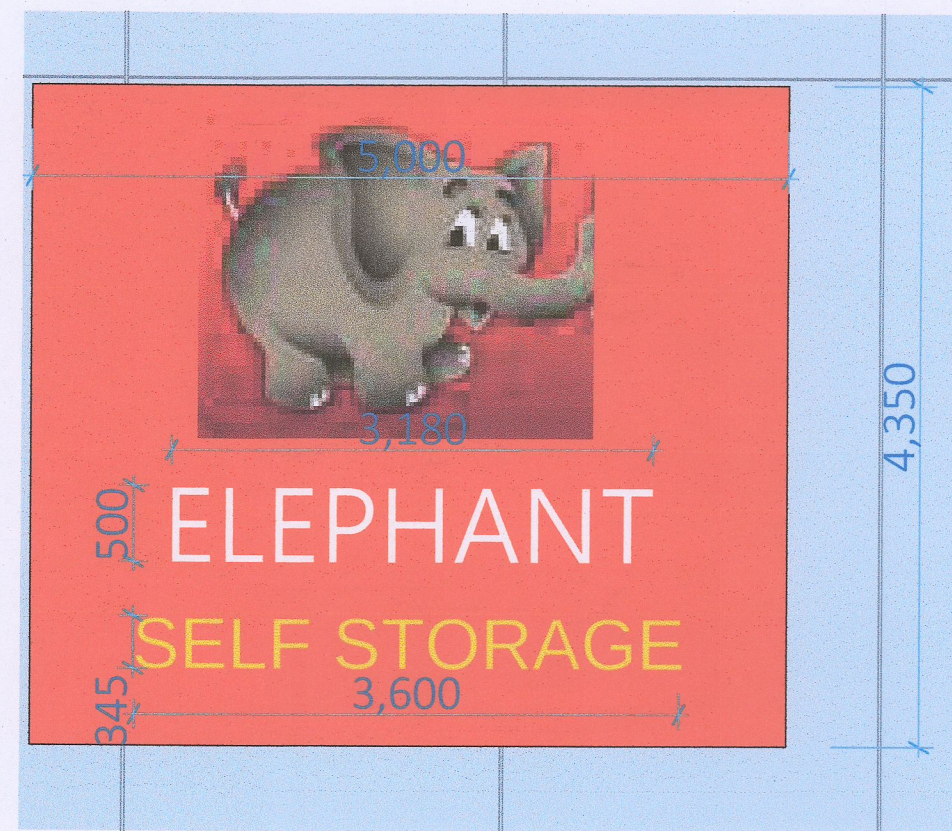

Proposed Northern Signage
 Scale 1:50@A1

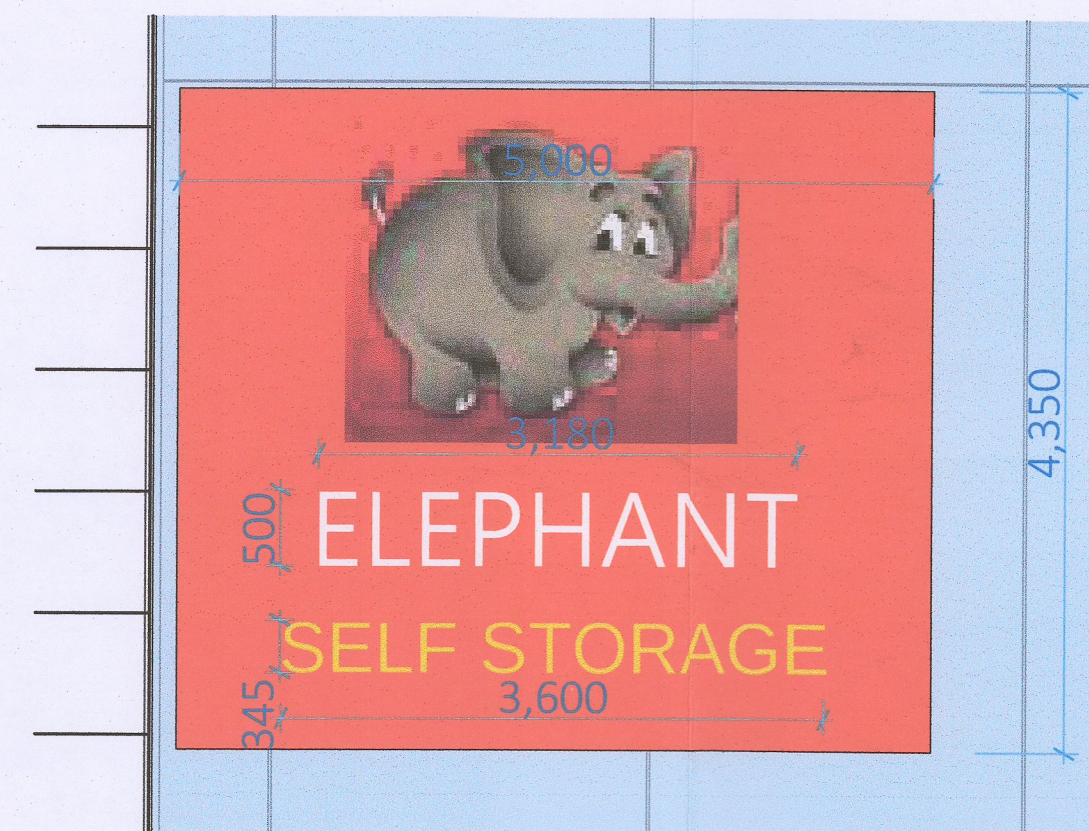

Proposed Eastern Signage
 Scale 1:50@A1

Red (RAL3028-Pure Red) backing panel 100mm thick aluminium box mounted onto proposed glazing system frame with inset lighting for backlighting graphic and text

Elephant Graphic - backlit
 2mm thick aluminium graphic

"Elephant" text - backlit
 2mm thick aluminium text

"Self Storage" text - backlit
 2mm thick aluminium text

Drawing Key: [] Drawing Notes:

Drawing Scale:
 AS INDICATED@A1

PLANNING FURTHER INFORMATION

REVISION	DATE ON	REVISION	DESCRIPTION
A	22/10/20	SIF	Detail site plan added (1:200) and detail signage added (1:50)

PAUL O'LOUGHLIN & ASSOCIATES <small>17 HIBERNIAN INDUSTRIAL ESTATE, GREENHILLS RD, TALLAGHT, DUBLIN 24, D24K163</small>	
PROJECT ADDRESS: 17 HIBERNIAN INDUSTRIAL ESTATE, GREENHILLS RD, TALLAGHT, DUBLIN 24, D24K163	PROJECT REF NUMBER: 22-05
DRAWING NUMBER: 22-05-PL - 004	DRAWING NAME: Existing and Proposed Site Layouts
DRAWING DATE: 02.06.2022	LATEST REVISION: A
CLIENT: GALLUSWOOD LTD	