

ALL DIMENSIONS TO BE CHECKED ON SITE
 NO DIMENSIONS TO BE SCALED FROM THIS DRAWING
 DRAWING IS TO BE READ IN CONJUNCTION WITH RELEVANT CONSULTANTS DRAWINGS

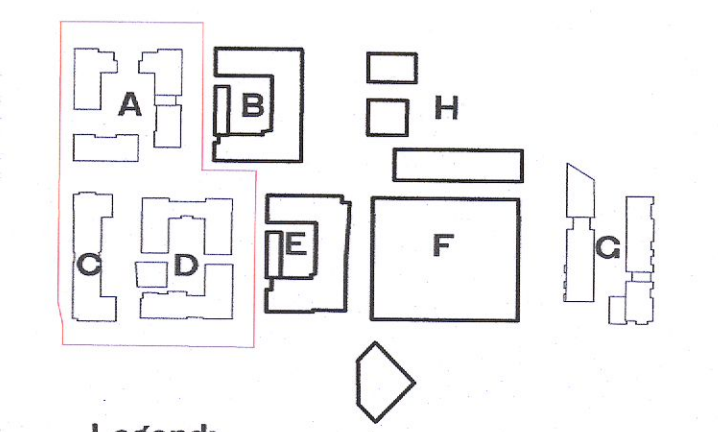

Legend:

- Extent of Site Boundary
- Extents of boundary of development permitted under Planning Permission Reg. Ref. SDZ20A/0008, as amended by SDZ20A/0016 SDZ20A/0018 and SDZ21A/0017

RFI 1 (a)

Block D North - Changes to Core entrance hall facing Great Western Way updated to accommodate new apartment type T.301_D revised apartment type T.102_D

RFI 1 (b)

Block D South - Changes to apartment type T.201_D and T.202_D to overcome privacy/overlooking issues

RFI 2

Block D South - Changes to facade material to brick on the upper floor levels

Red dash line indicates extent of amendments to address RFI 0723 dated 08 JUNE 2022

H.J.L Drawing Number on previously lodged planning application: SDZ22A/0005
ADC3-HJL-ACD-ZZ-DR-A-P0010 Revision (P01)

REV	DATE	DESCRIPTION	CHK	DRN
P02	06/09/2022	ISSUED FOR FURTHER INFORMATION	RJ	SEN
P01	08/04/2022	ISSUED FOR PLANNING	RJ	FM

STATUS CODE DESCRIPTION
ISSUED FOR FURTHER INFORMATION

CLIENT
QUINTAIN IRELAND LTD.

PROJECT
ADAMSTOWN STATION BLOCKS ACD

DRAWING
SITE LAYOUT PLAN

PROJECT NUMBER: 960747 DATE: 08/04/22
 SCALE@ A1: 1:500 DRAWING CHECKED: FM/RJ

STATUS CODE: A1 DRAWING NUMBER: ADC3-HJL-ACD-00-DR-A-P0010 REVISION: P02

Henry J Lyons

Architecture + Interiors
 henryjlyons.com +353 1 888 3333 info@henryjlyons.com 51-54 Pearse Street Dublin D02 KA66

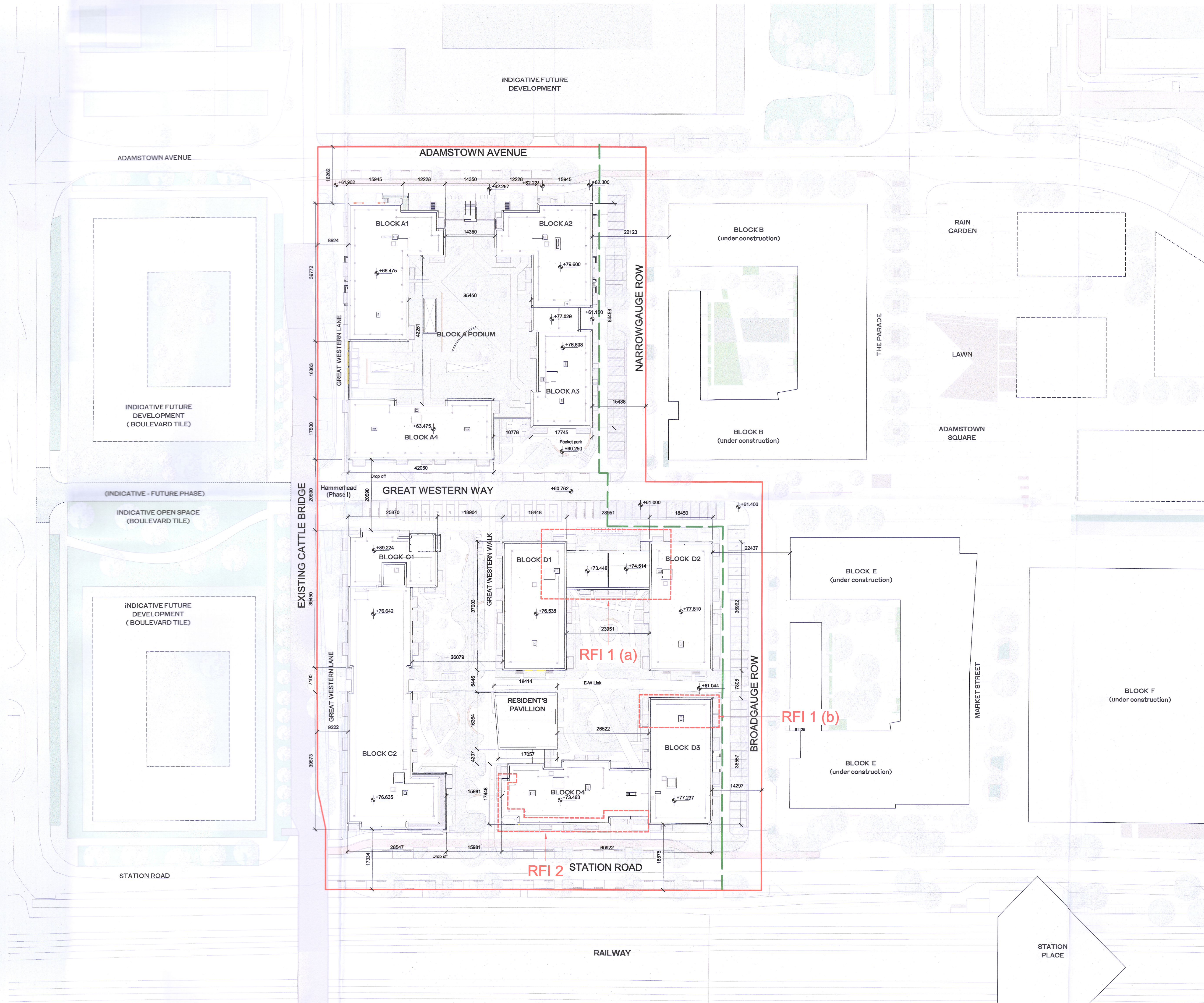

STATION PLACE