

A1

DO NOT SCALE

100
0 10

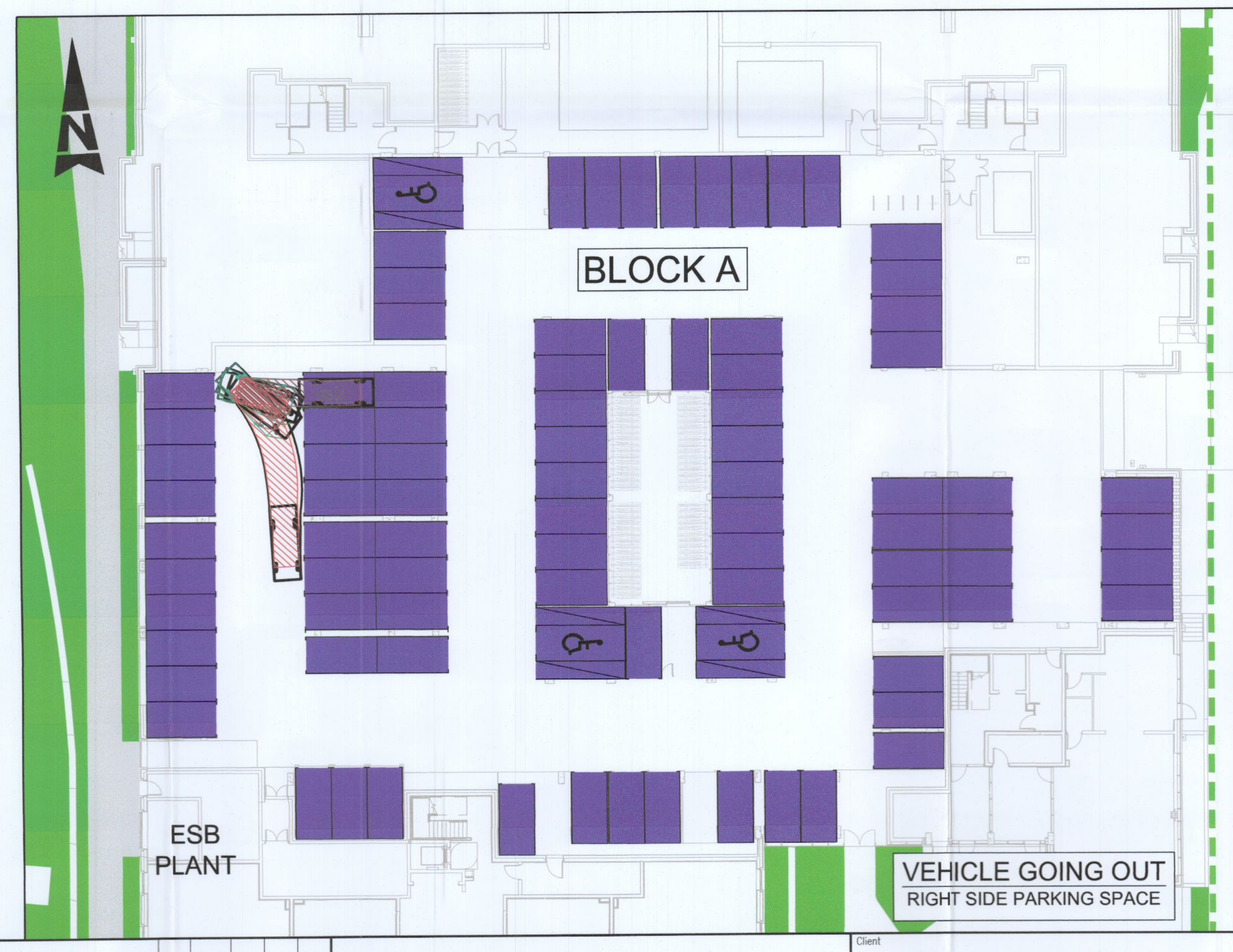
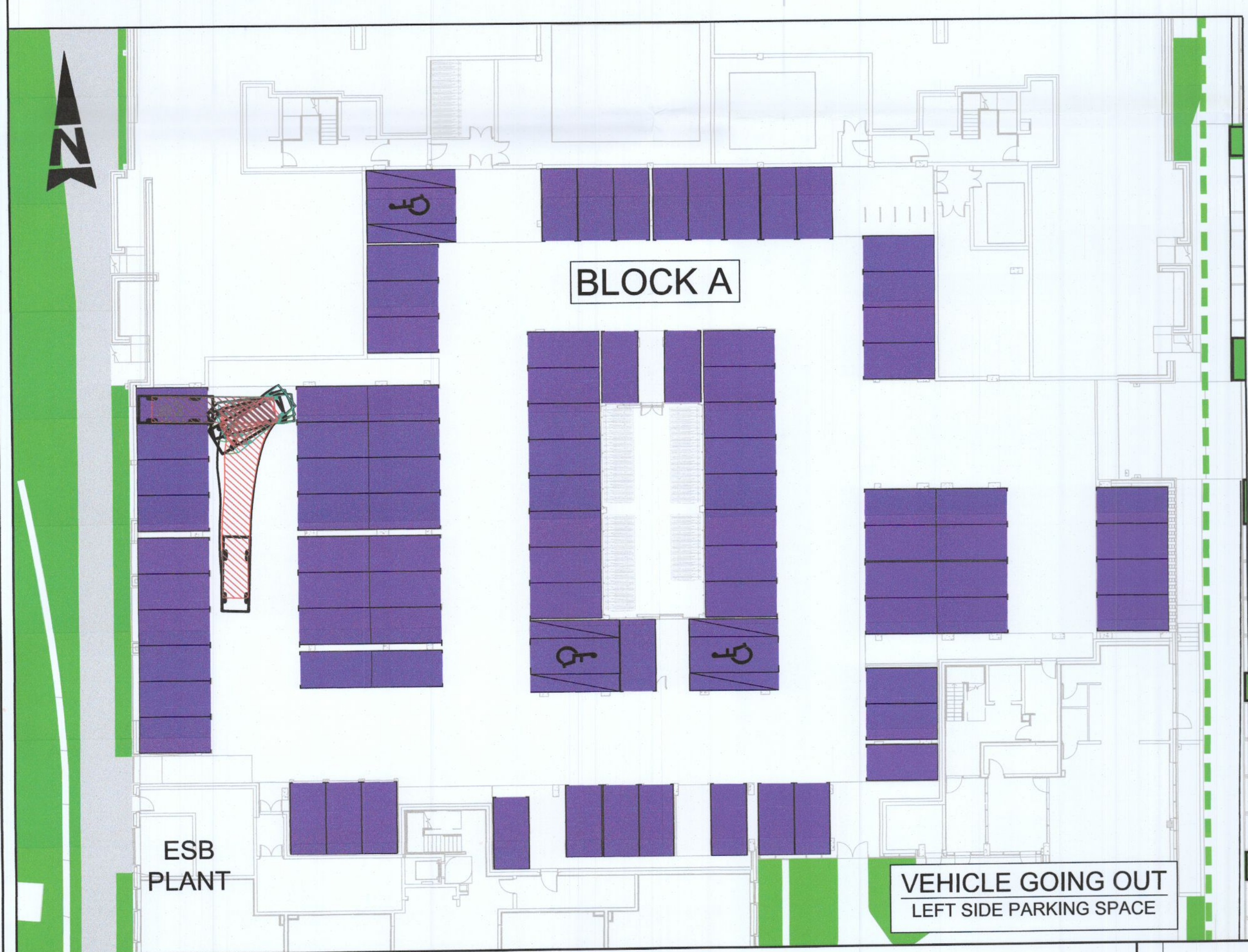
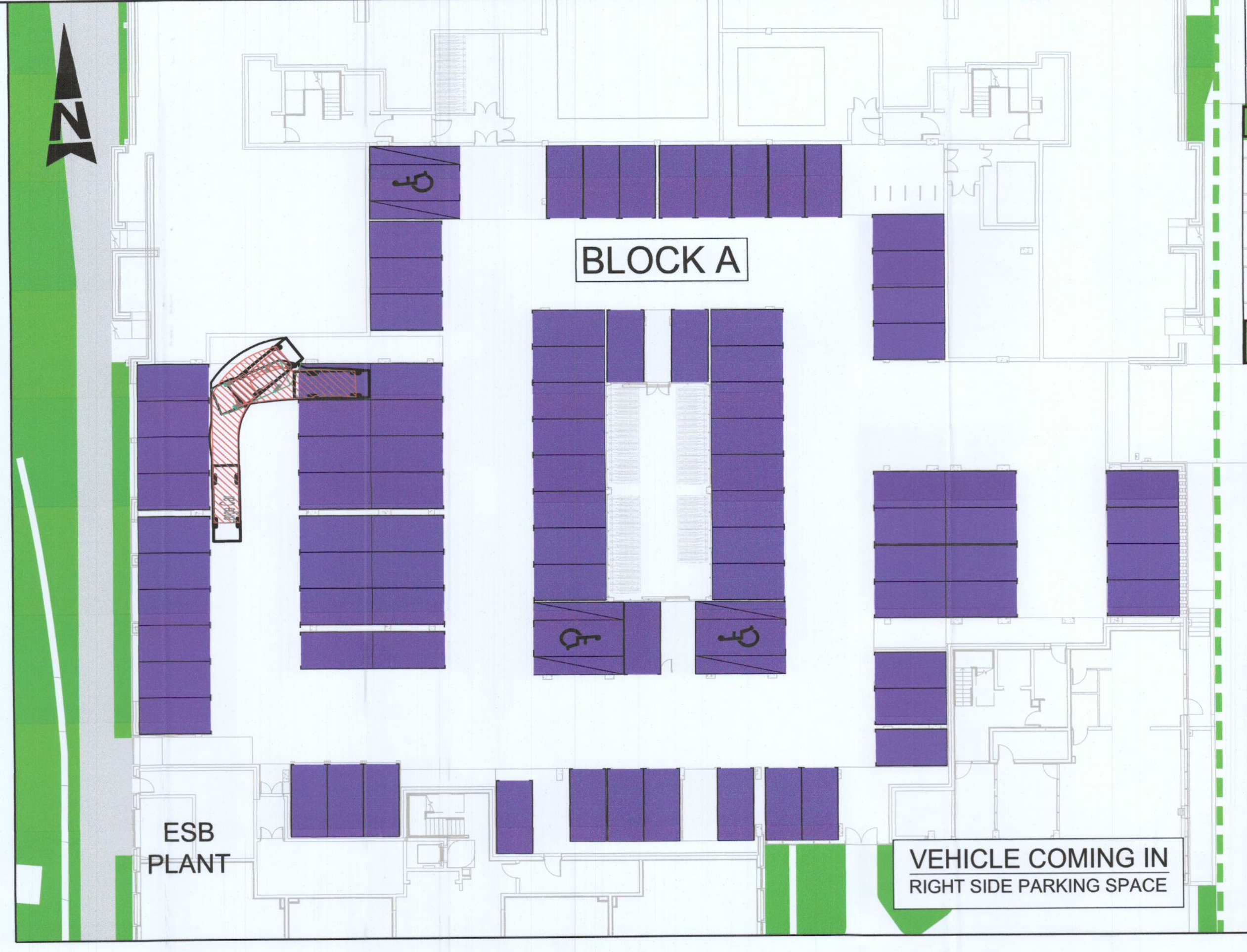
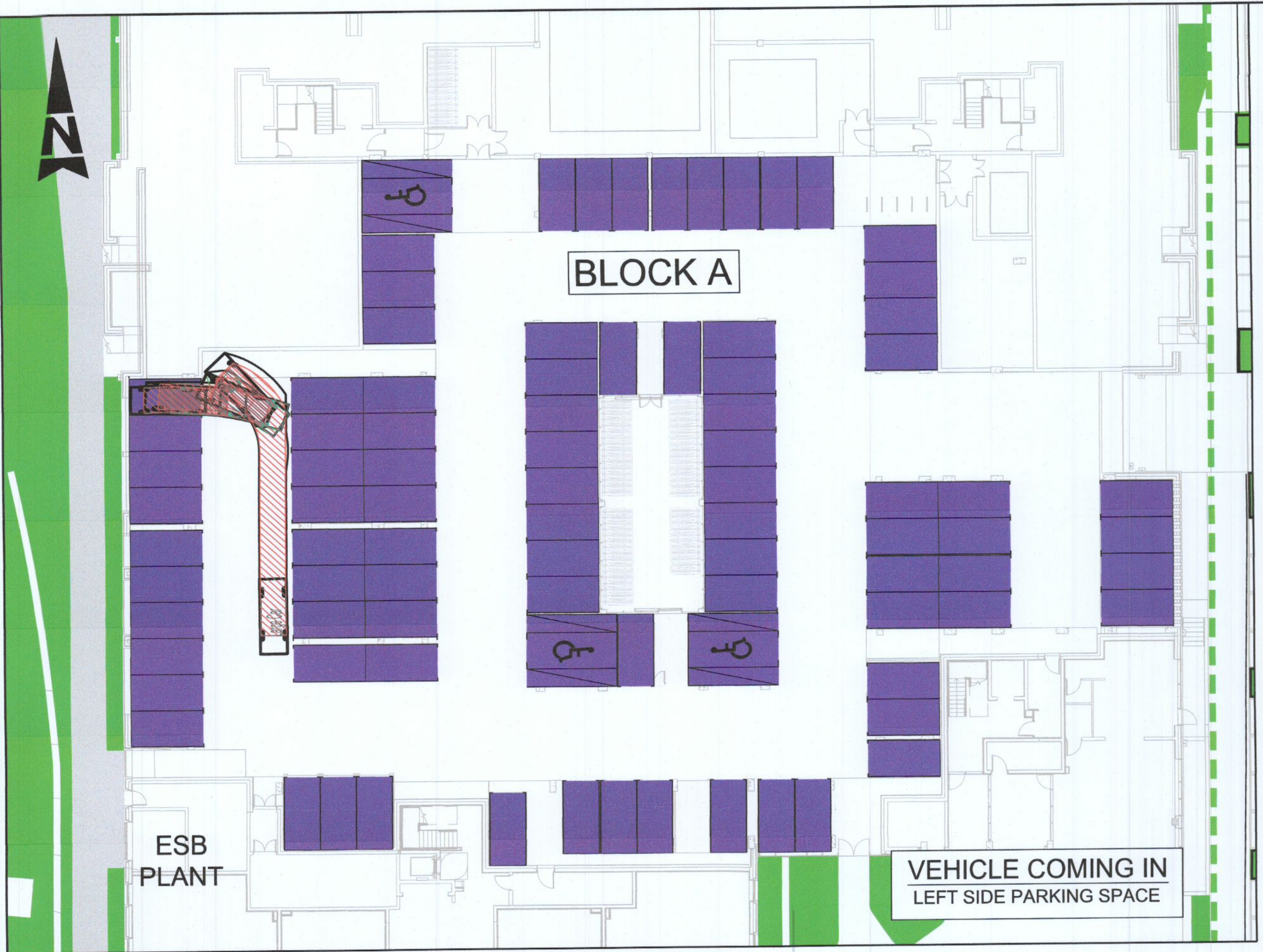

- GENERAL NOTES**
1. ALL DIMENSIONS ARE IN MILLIMETRES UNLESS NOTED OTHERWISE
 2. ONLY WRITTEN DIMENSIONS SHALL BE USED. NO DIMENSIONS SHALL BE SCALED FROM THE DRAWINGS
 3. ALL LEVELS ARE IN METRES AND ARE TO MALIN HEAD DATUM
 4. ALL COORDINATES ARE IN METRES AND ARE TO IRISH TRANSVERSE MERCATOR
 5. DRAWINGS ARE TO BE READ IN CONJUNCTION WITH THE SPECIFICATION

VEHICLE PROFILE:

Large Car	4.988m
Overall Length	1.793m
Overall Body Height	1.502m
Min Body ground Clearance	0.287m
Track Width	1.700m
Lock-to-lock time	4.00s
Curb to Curb Turning Radius	6.200m

LEGEND:

--- BOUNDARY OF DEVELOPMENT PERMITTED UNDER PLANNING PERMISSION REG. Ref: SDZ20A/0008

File: 5150924_HTR_08_SK_046.dwg
Date: Sep 06, 2022 - 9:31am
Plotted by: G.Sorbo

© ORDNANCE SURVEY IRELAND LICENSE NR. AR 0082522. ORDNANCE SURVEY IRELAND & GOVERNMENT OF IRELAND
ATKINS WILL NOT TO BE HELD LIABLE FOR THE USE OF THIS DATA ON ANY PROJECT OTHER THAN THE PROJECT:

Risk Level	Atkins Base Line - Low Risk
	Atkins Sensitive - Medium Risk
	Atkins Private - High Risk
	Client Critical - Already Marked

Rev	Description	By	Date	Chk'd	Rev'd	Auth
-	PLANNING	YC	18.08.22	PF		KB

ATKINS
Member of the SNC-Lavalin Group

Atkins House, 150-155 Airside Business Park, Swords, Co. Dublin
Tel (+353) 01 810 8000
Fax (+353) 01 810 8001

Unit 2B, 2200 Cork Airport Business Park, Cork
Tel (+353) 021 429 0300
Fax (+353) 021 429 0360

1st Floor Technology House Parkmore Technology Park, Galway
Tel (+353) 091 786 050
Fax (+353) 091 779 830

Client	QUINTAIN DEVELOPMENTS IRELAND LTD
Project	ADAMSTOWN DISCRIC CENTRE PHASE 3

Purpose	PLANINIG
Title	UNDERCROFT VEHICLE TRACKING LARGE CAR IN-OUT
Original Scale	1:250 at A1
Drawn	YC
Checked	PF
Reviewed	PF
Authorised	KB
Date	18.08.22
Date	18.08.22
Date	18.08.22
Date	18.08.22
Status	P
Drawing Number	5150924 / HTR / 08 / SK / 046
Rev	-