

Legend:

Location of Site Boundary indicated thus: 

Location of Site Notice indicated thus: 

New Extension Area hatched thus: 

Existing Mains Water Line indicated thus: 

Foul Sewer Line indicated thus: 

Surface Water Sewer Line indicated thus: 

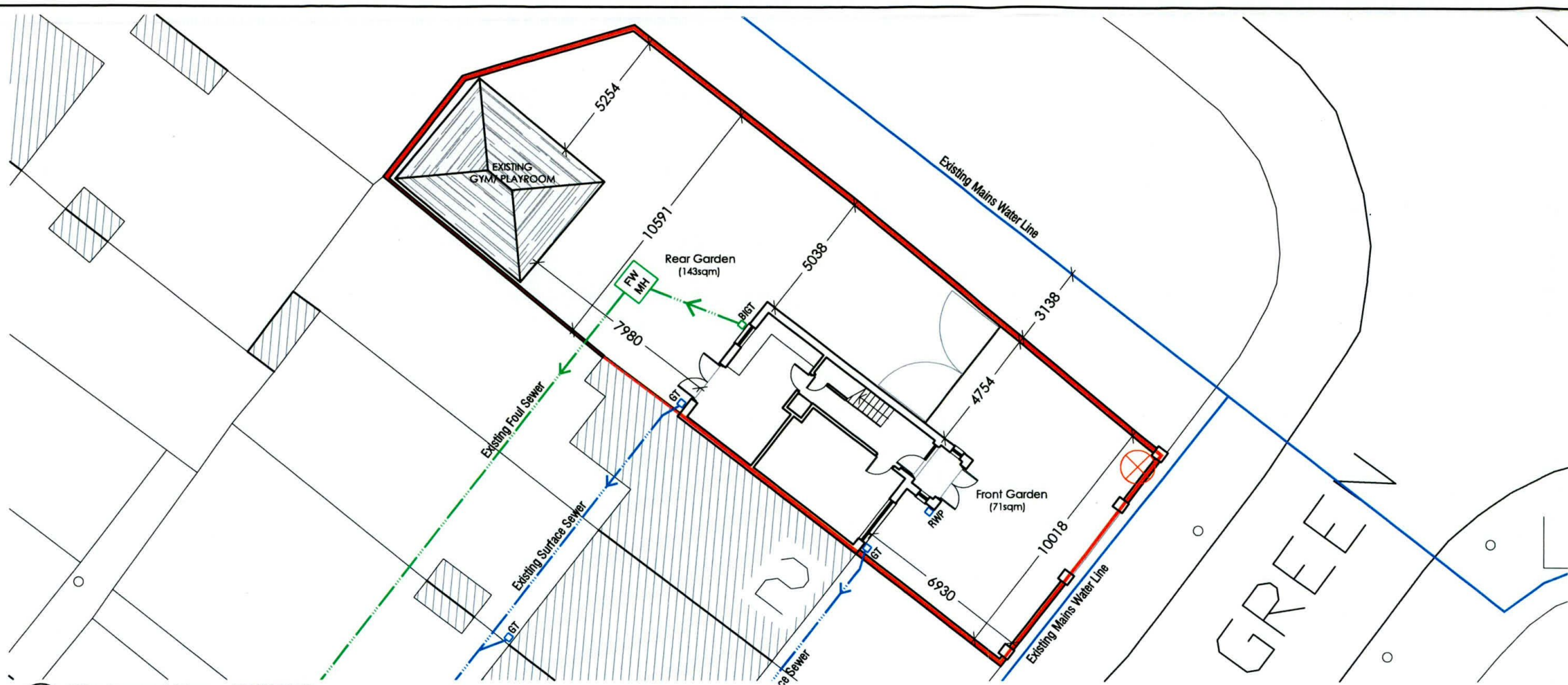

001 Site Layout Plan - EXISTING
01 1:200

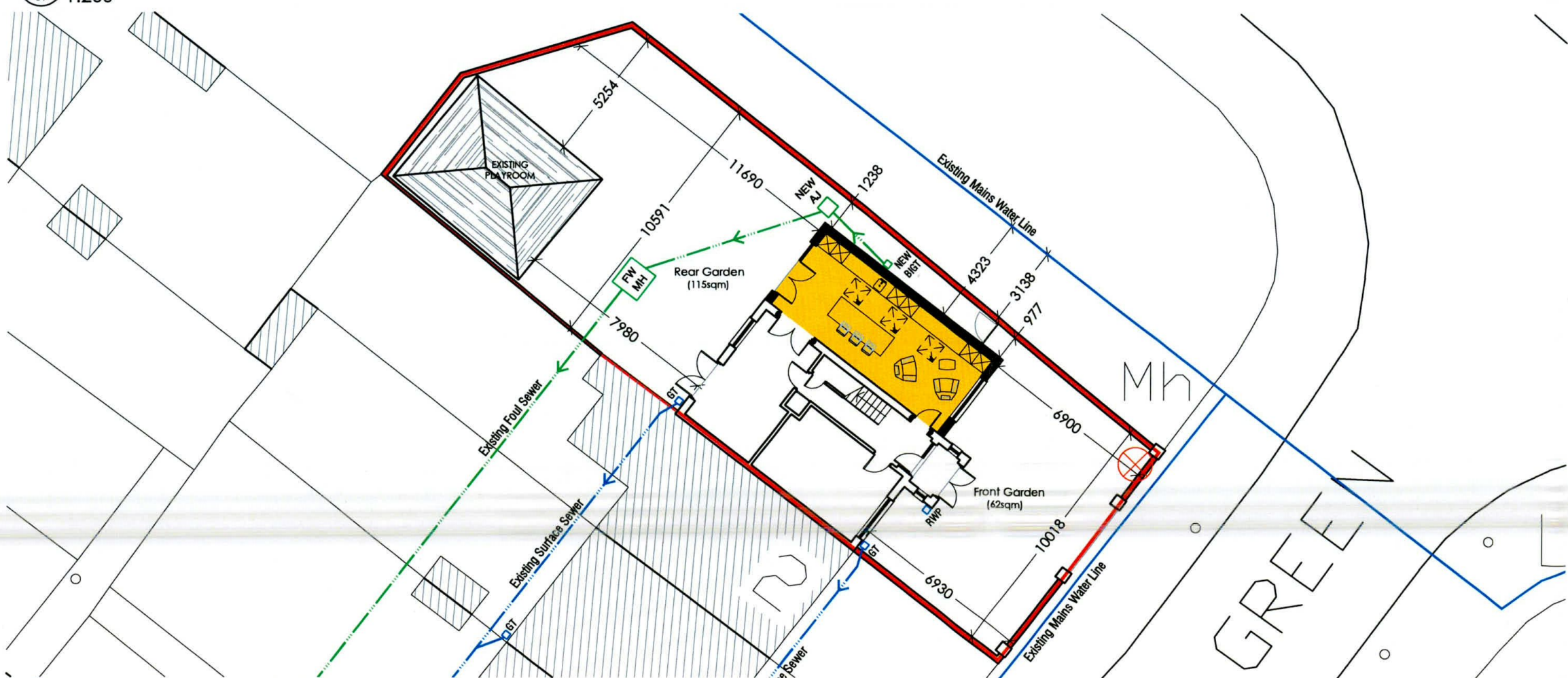

001 Site Layout Plan - PROPOSED
02 1:200

STATUS: Planning Application					
PROJECT: 1 Rowlagh Green, Clondalkin, Dublin 22					
DRAWING: Site Layout Plans: EXISTING & PROPOSED					
DRAWN BY: J.M.	CHECKED BY: J.M.	SIGNED: J.M.	SCALE: 1:200 @ A3	AMENDED BY:	ISSUED ON: 27/08/22
CAD REF: 2203-Planning	PROJ. NO. - STATUS - DRG. NO.: 2203 - PLA - 001			REVISION:	
THIS DRAWING IS COPYRIGHT. DO NOT SCALE. USE FIGURED DIMENSIONS ONLY.					
John Murray - 2 Neilstown Cottages, Ninth Lock Road, Clondalkin, Dublin 22.					
t. 353 (0) 1 467 0128		e. john@connerymurray.ie		t. 353 (087) 6 107 107	