

GENERAL NOTES:

- A. THIS DRAWING IS TO BE READ IN CONJUNCTION WITH ALL RELEVANT ARCHITECTURAL DRAWINGS, THE SPECIFICATION, AND ALL RELEVANT STANDARD DETAIL DRAWINGS.
- B. THIS DRAWING IS TO BE READ IN CONJUNCTION WITH ALL RELEVANT CIVIL, STRUCTURAL, MECHANICAL AND ELECTRICAL DRAWINGS TOGETHER WITH THE SPECIFICATIONS AND SCHEDULES.
- C. ALL DIMENSIONS IN MILLIMETRES. DO NOT SCALE FROM THIS DRAWING. USE FIGURED DIMENSIONS ONLY.
- D. CONTRACTOR MUST VERIFY ALL DIMENSIONS ON SITE BEFORE SETTING OUT, COMMENCING WORK, OR PRODUCING ANY SHOP DRAWINGS.

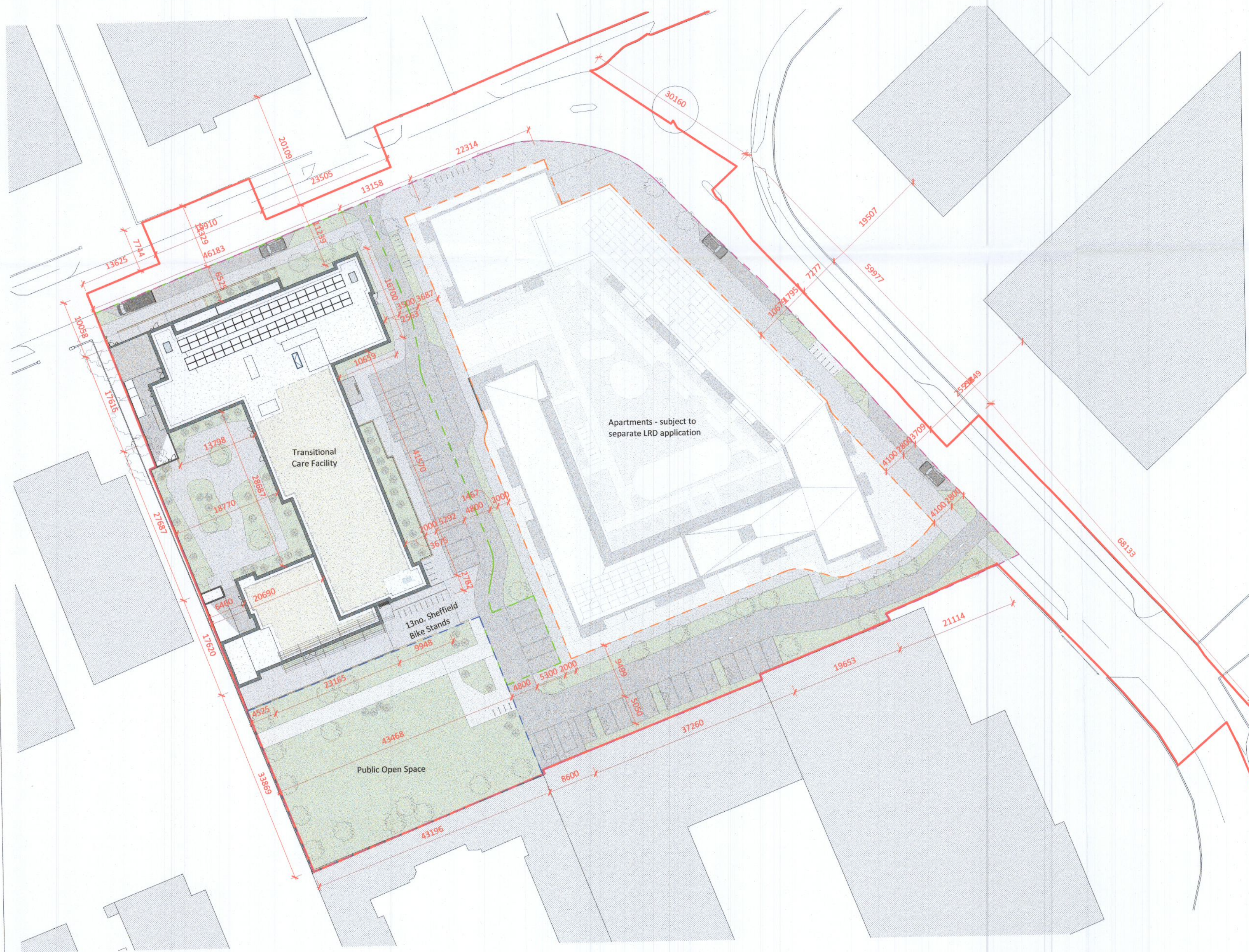

- Site boundary - subject site including drainage works and public realm upgrades (1.627ha)
- Plot outline (1.162ha)
- Development site area / building curtilage (0.3784ha)
- Public Open Space (1286m²)



Rev	Description	By	Ckd	Date

20 Cruises Street
 Limerick
 V94 R6P9
 Ireland
 (061) 312249
 limerick@emli.ie
 www.emli.ie

37 Fitzwilliam Pl.
 Dublin 2
 D02 YT52
 Ireland
 (01) 6707677
 dublin@emli.ie

Client		Bartra Property (Cookstown) Limited		Date	12/09/2022
Job		3514 - First Avenue		Scale @ A2	1 : 500
Sheet Title		Proposed Site Plan - Development Site Areas - Transitional Care Facility			
Job No.	Stage	Drawing No.	Suitability	Rev	
3514	PL	3514-EML-ZZ-ZZ-DR-A-0010			
Project - Originator - Zone - Level - Doc Type - Role - Number					