

LEGEND:

- PROPOSED CYCLE TRACK
- PROPOSED FOOTPATH
- PROPOSED ROAD PAVEMENT
- PROPOSED RAISED TABLE SURFACE
- PROPOSED SHARED SURFACE
- BUFF COLORED TACTILE PAVING AT UNCONTROLLED CROSSING
- BUFF COLORED CORDUROY PAVING
- IN SITU CONCRETE DROPPED KERBS TO BE MAINTAINED AT ENTRANCES

NOTE:
PROPOSED INTERIM PEDESTRIAN AND CYCLE INFRASTRUCTURE UPGRADE WITH EXISTING KERBS AND ENTRANCES MAINTAINED. WIDTH OF INTERIM CYCLE TRACK VARIES AS PER CROSS SECTION.

NOTE:
FOOTPATH TO TIE IN WITH EXISTING FOOTPATH AT THIS LOCATION

NOTE:
CYCLE TRACK TO BE TAKEN ON-ROAD AT THIS LOCATION

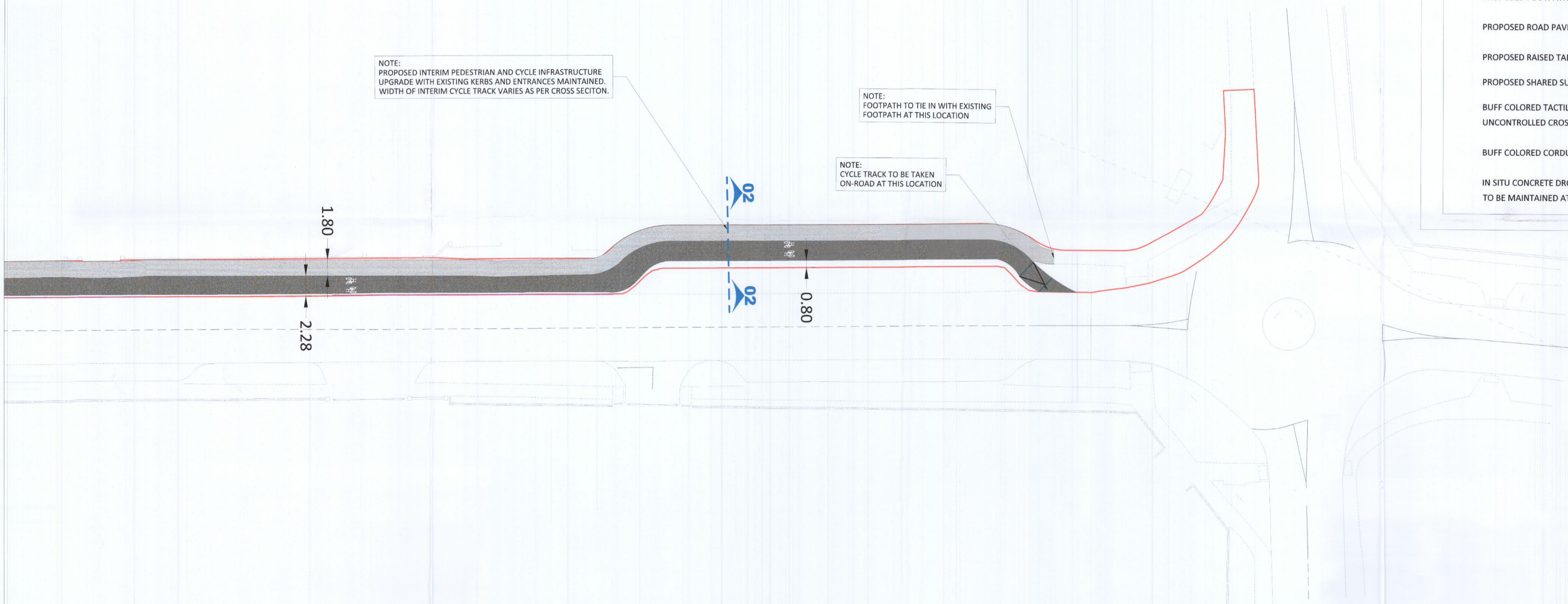

PLANNING DRAWING.
NOT FOR CONSTRUCTION.
ALL LEVELS GIVEN ARE
RELATIVE TO ORDNANCE DATUM.
THIS DRAWING HAS BEEN ISSUED FOR INFORMATION
PURPOSES ONLY AND MUST NOT BE USED
FOR CONSTRUCTION UNDER ANY CIRCUMSTANCES

ORDNANCE SURVEY OF IRELAND LICENCE NO. CYAL50213875 © GOVERNMENT OF IRELAND

- FOR SETTING OUT REFER TO ARCHITECT'S DRAWINGS.
- THIS DRAWING TO BE READ IN CONJUNCTION WITH ALL OTHER ARCHITECTURAL AND ENGINEERING DRAWINGS AND ALL OTHER RELEVANT DRAWINGS AND SPECIFICATIONS.
- DO NOT SCALE THIS DRAWING. USE FIGURED DIMENSIONS ONLY.
- NO PART OF THIS DOCUMENT MAY BE REPRODUCED OR TRANSMITTED IN ANY FORM OR STORED IN ANY RETRIEVAL SYSTEM OF ANY NATURE WITHOUT THE WRITTEN PERMISSION OF O'CONNOR SUTTON CRONIN AS COPYRIGHT HOLDER EXCEPT AS AGREED FOR USE ON THE PROJECT FOR WHICH THE DOCUMENT WAS ORIGINALLY ISSUED.

Rev No.	Date	Revision Note	Drn by	Chkd by	Rev No.	Date	Revision Note	Drn by	Chkd by
P01	07.09.22	SUITABLE FOR PLANNING	JC	PR					
P02	14.09.22	SUITABLE FOR PLANNING	JC	PR					

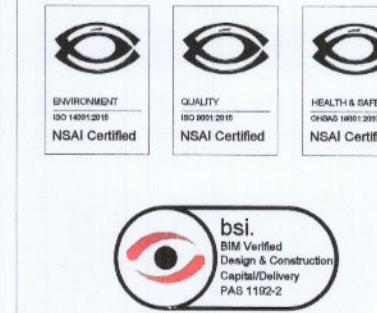

Head Office,
9 Prussia Street,
Dublin 7,
D07 KTS7



TEL +353 (0)1 8682000
e: contactus@ocsc.ie
w: www.ocsc.ie

Dublin | London | Belfast | Galway | Cork

Client: **BARTRA PROPERTY COOKSTOWN LIMITED**
Project: **TRANSITIONAL CARE FACILITY
COOKSTOWN INDUSTRIAL ESTATE, DUBLIN 24**

Title: **PROPOSED ROAD LAYOUT
SHEET 3 OF 6**

Code Originator Zone Level Type Role Number Status Revision
B981 · OCSC · XX · XX · DR · C · 0113 S4 P02
Date: SEP'22 Scale: 1:250 @ A1 Drn by: JC Chkd by: PR Aprvd by: AH